

Section Axis 1 (Sc.1:75)

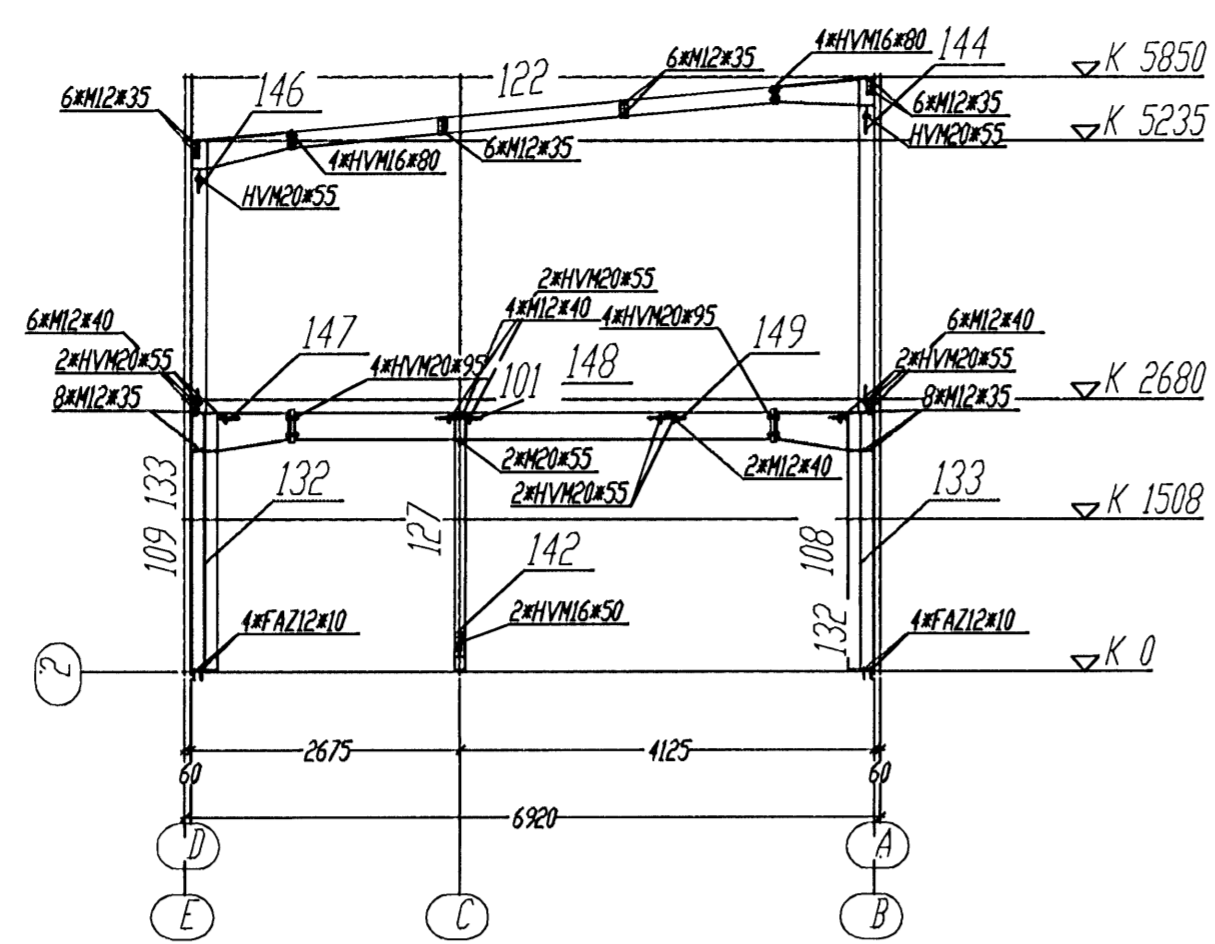

Section Axis 2 (Sc.1:75)

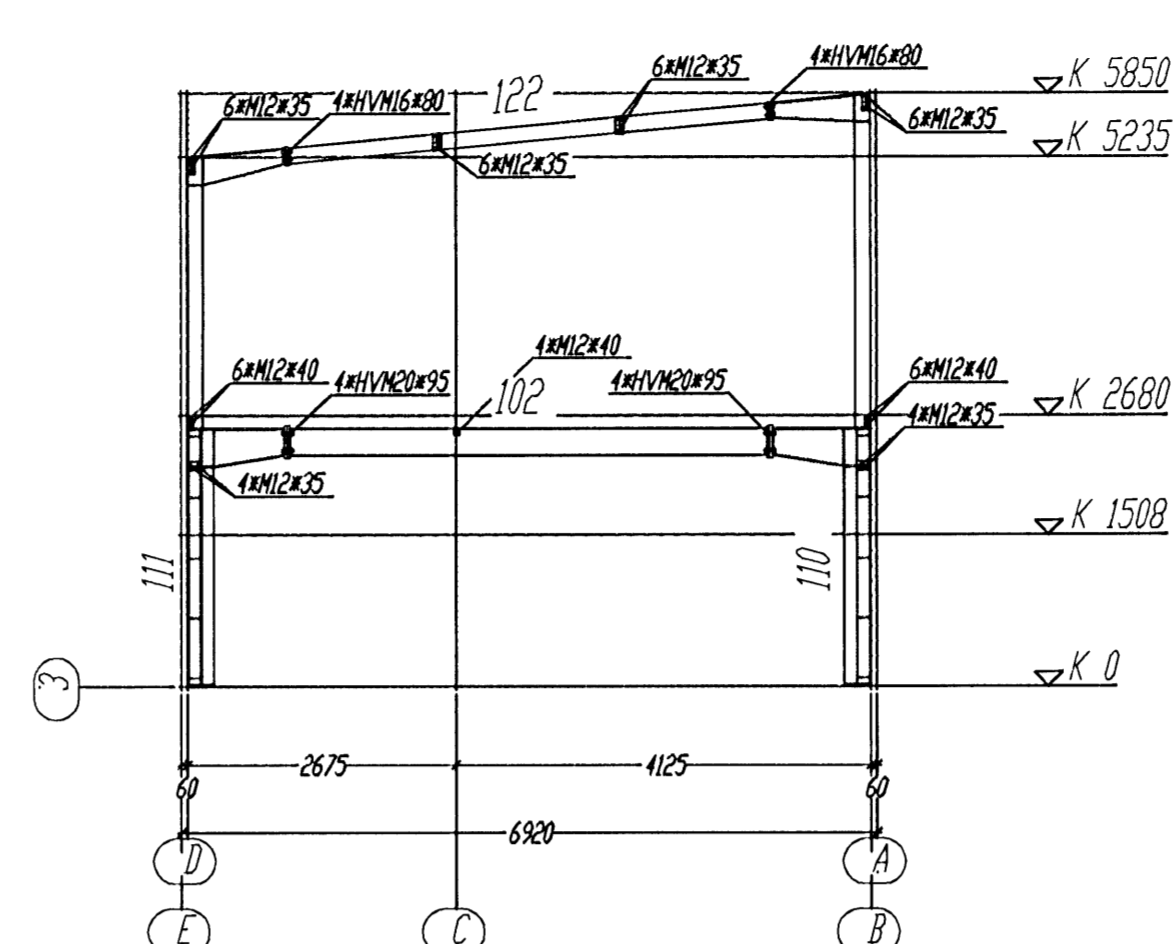

Section Axis 3 (Sc.1:75)

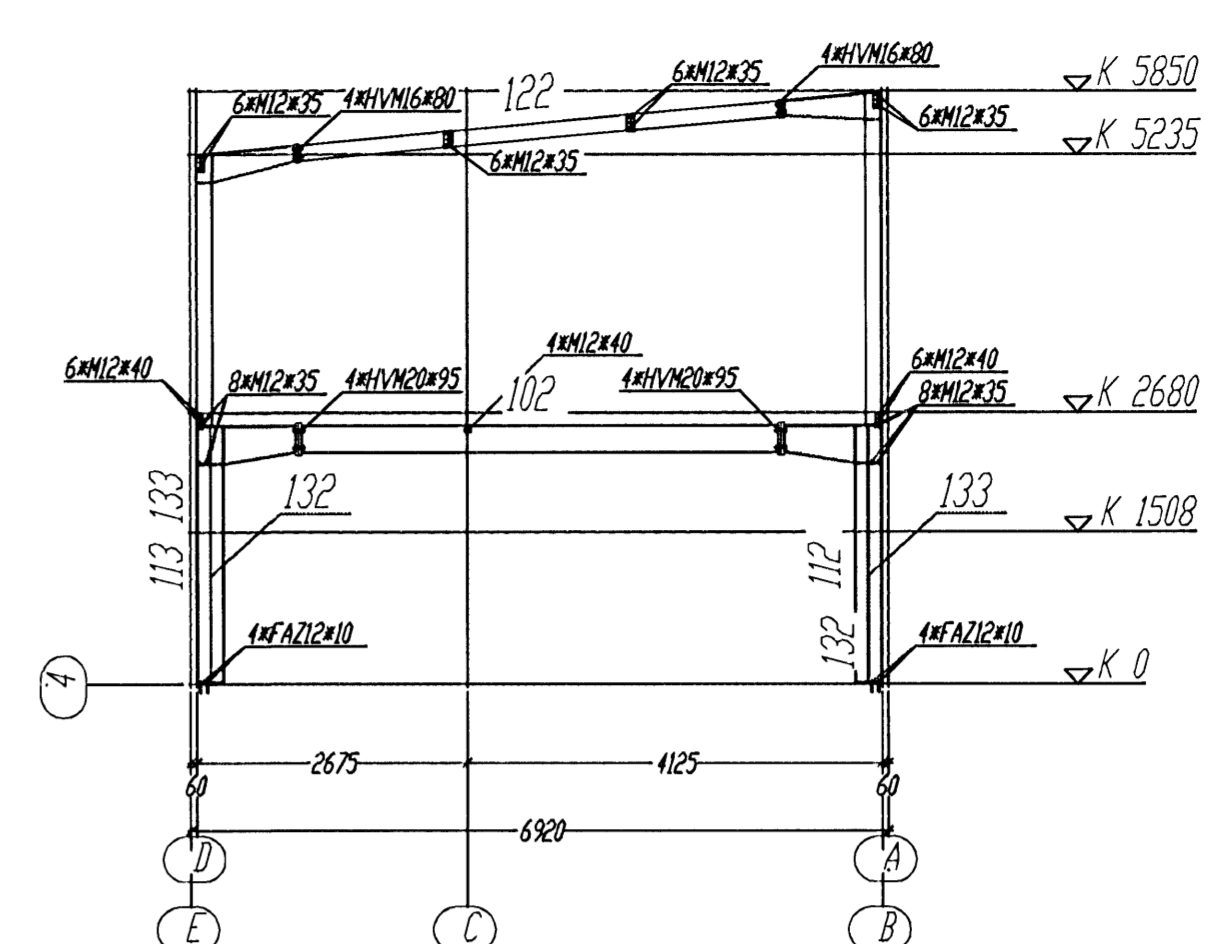

Section Axis 4 (Sc.1:75)

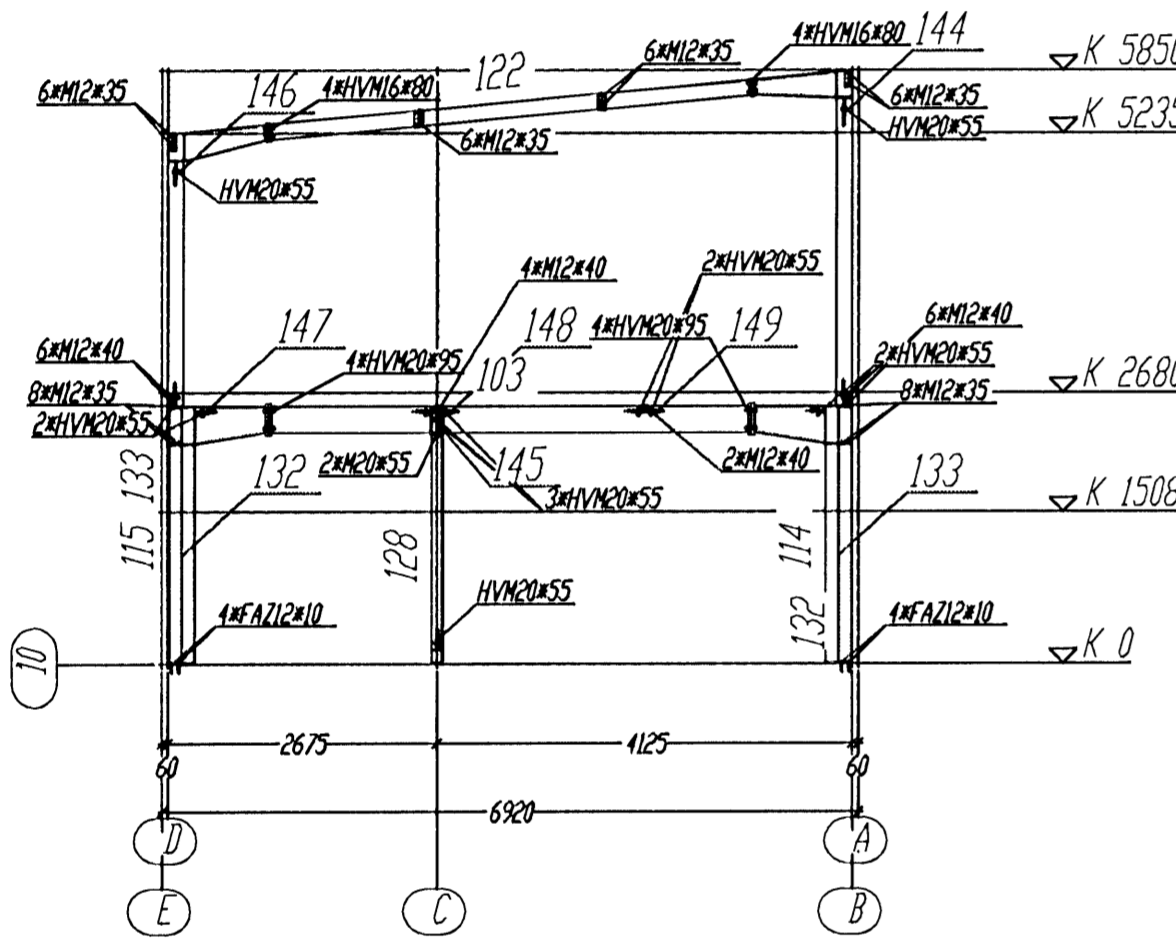

Section Axis 10 (Sc.1:75)

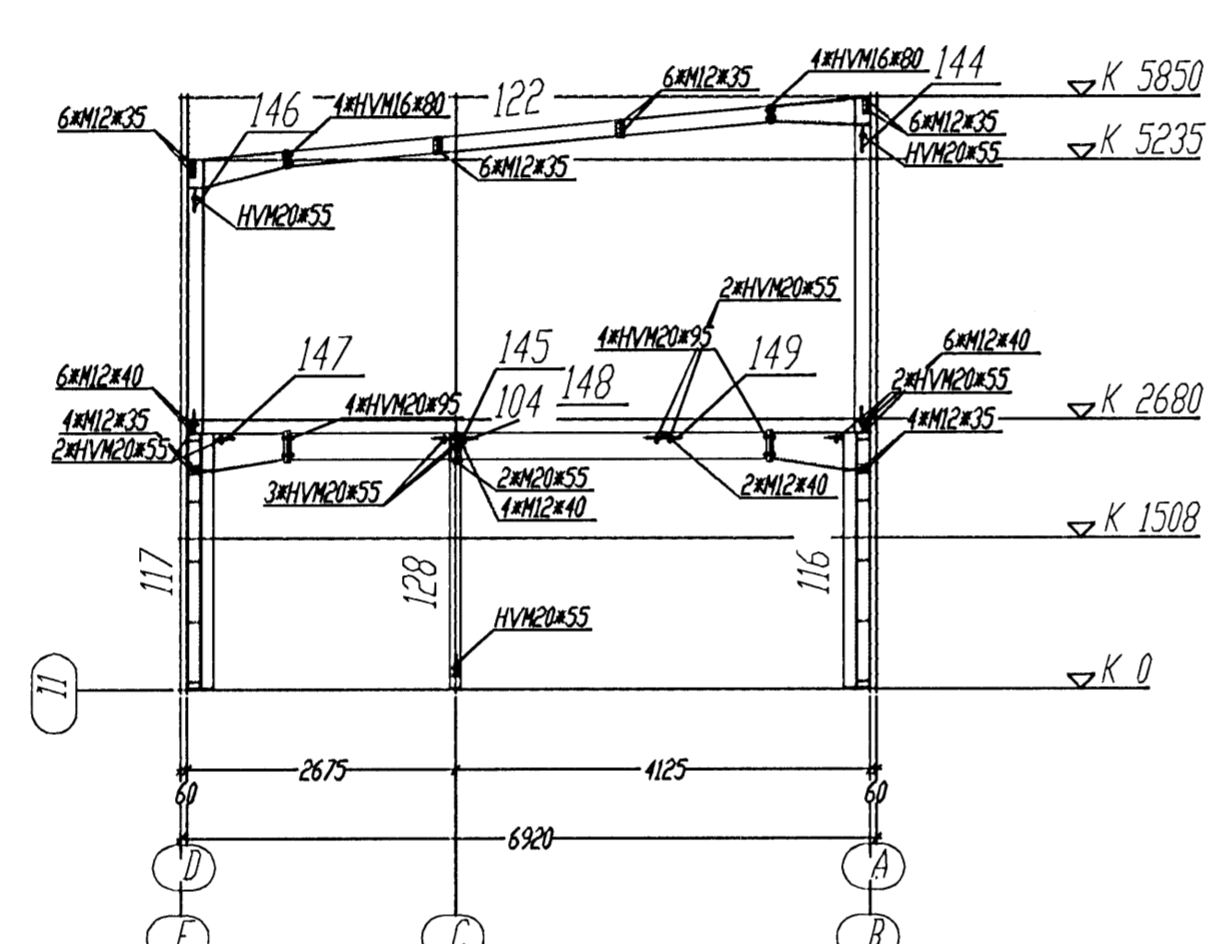

Section Axis 11 (Sc.1:75)

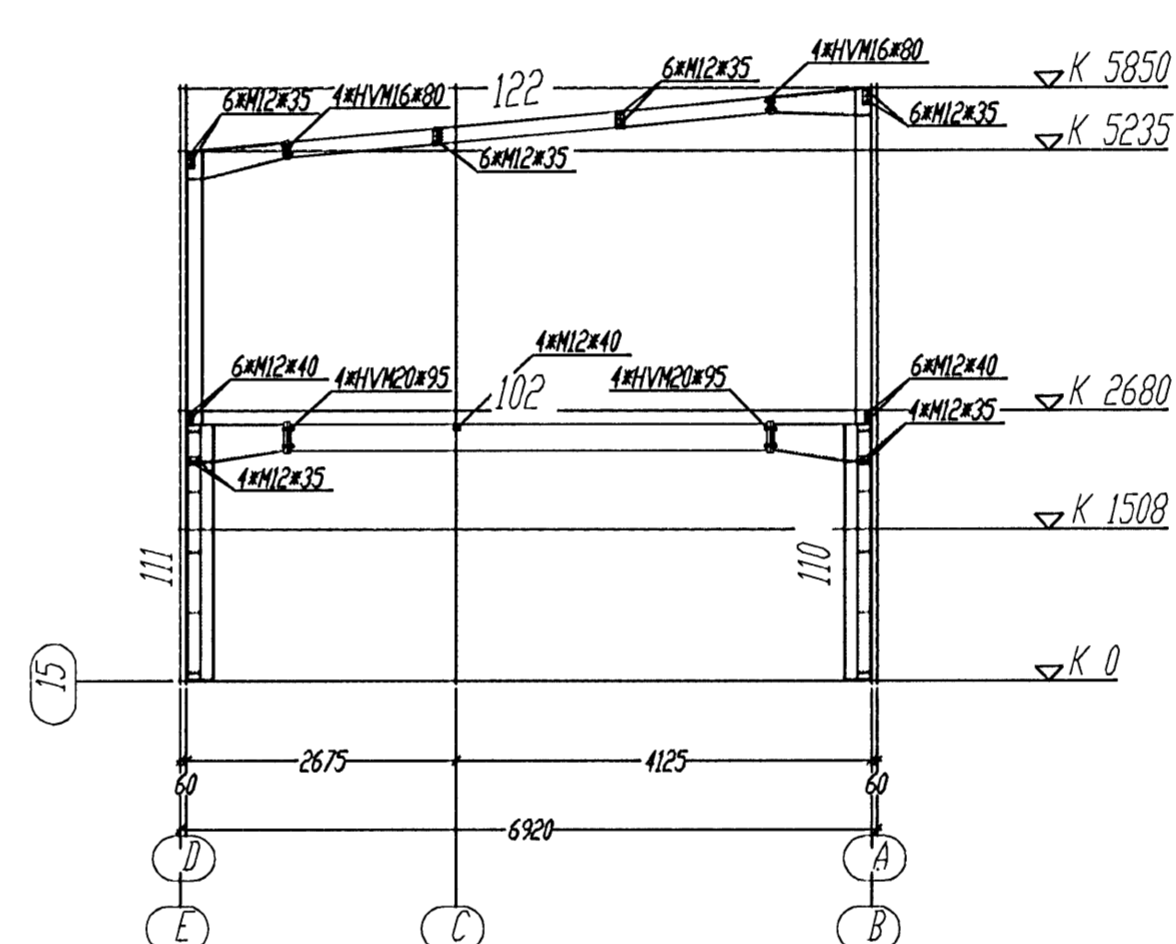

Section Axis 15 (Sc.1:75)

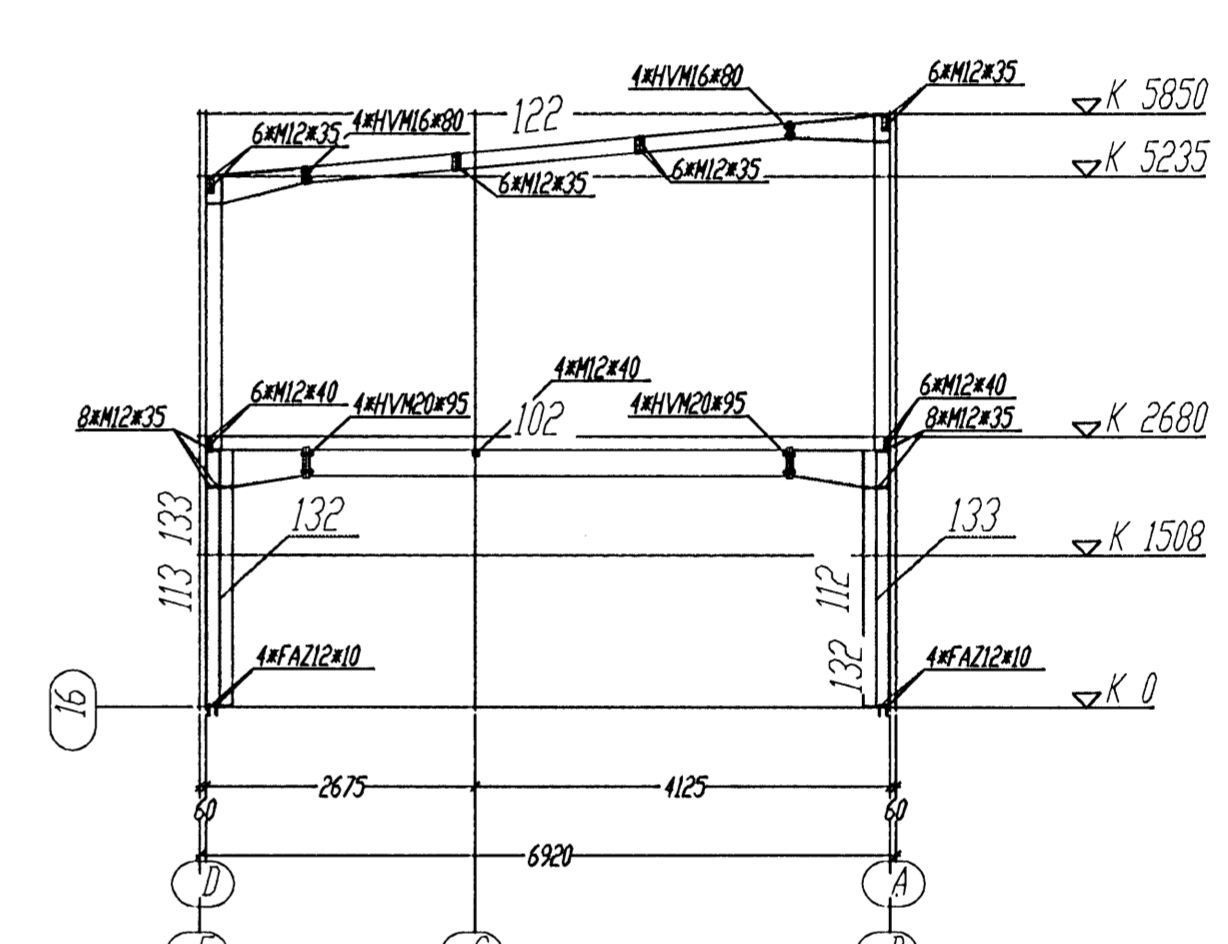

Section Axis 16 (Sc.1:75)

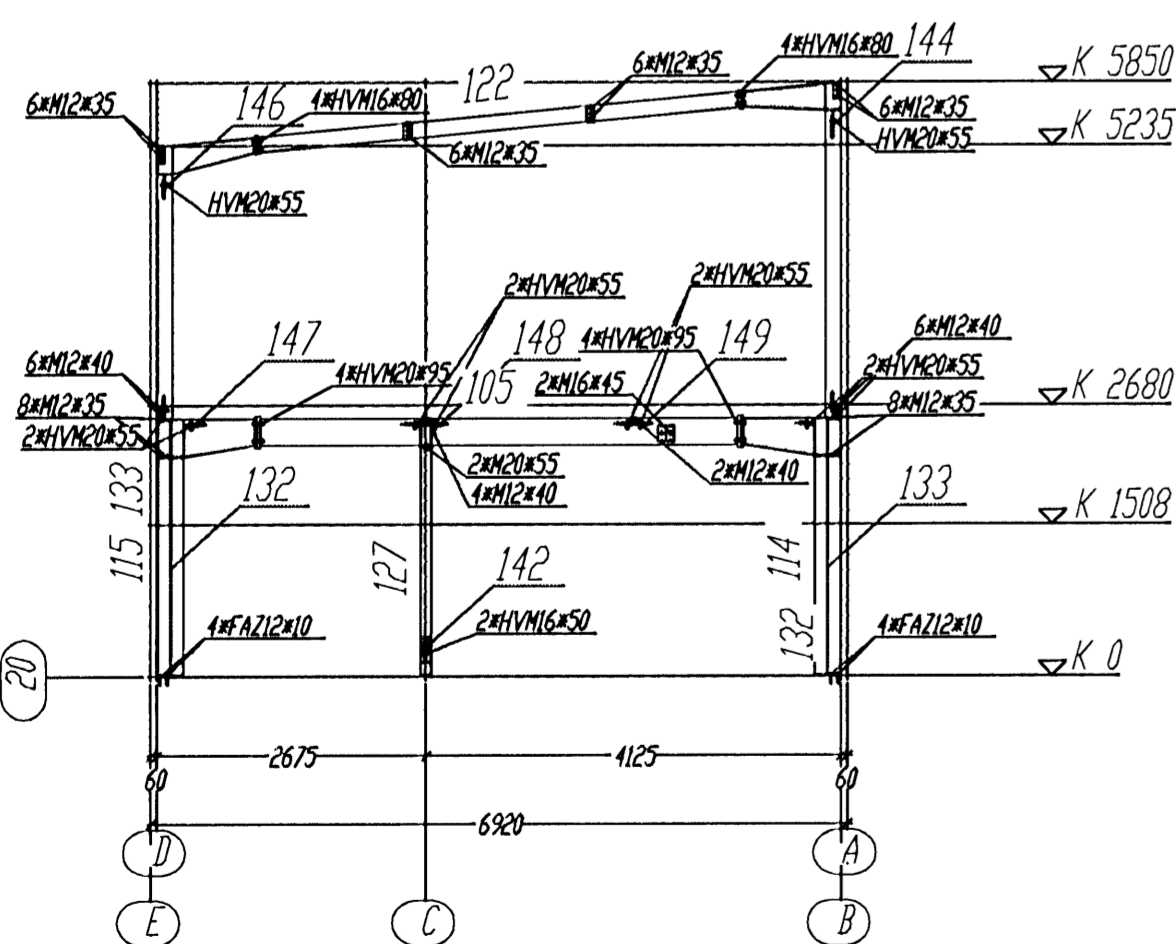

Section Axis 20 (Sc.1:75)

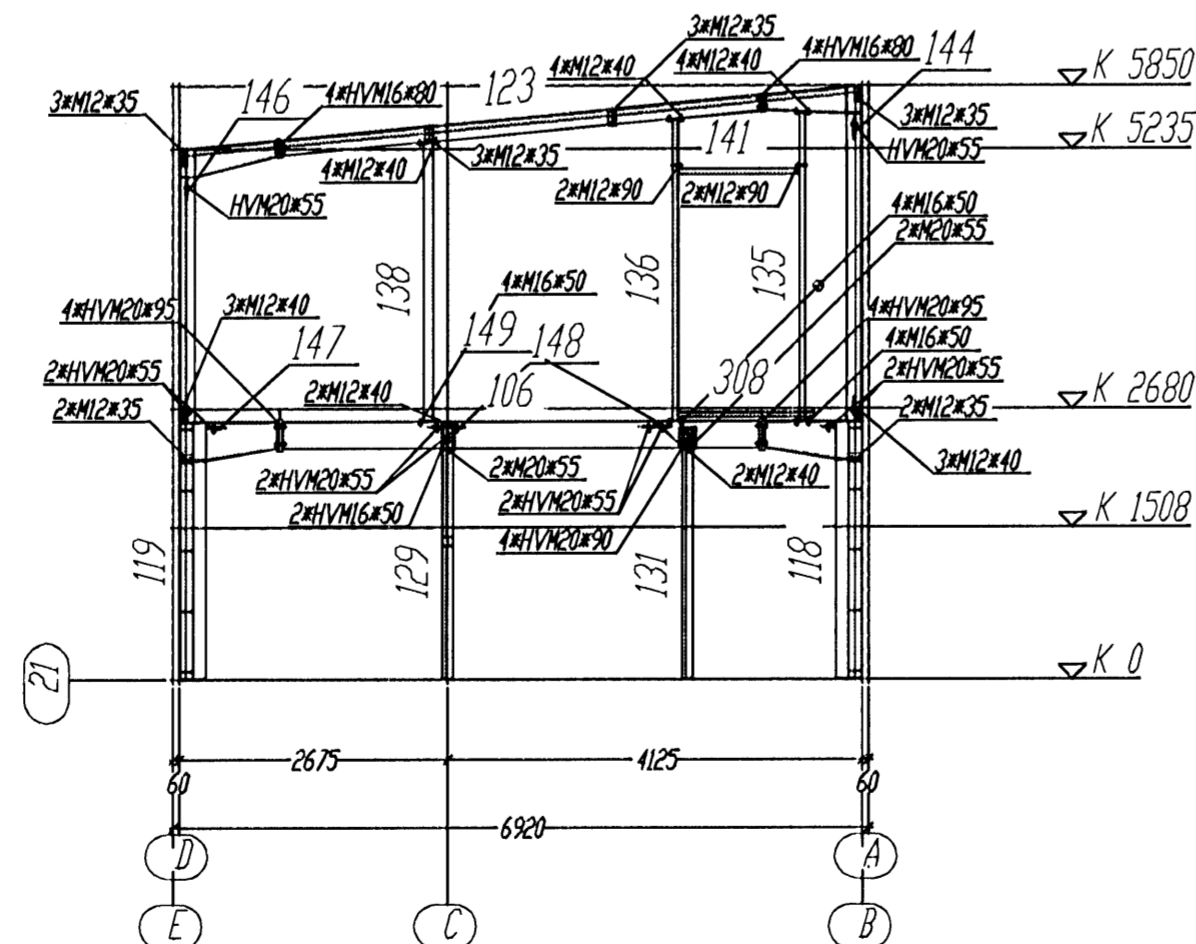

Section Axis 21 (Sc.1:75)

Samþykkt þann  
06. JULÍ 2008  
Byggingarfulltrúinn í Hafnarfirði  
F. Þ. Hrólfur S. Gunnlaugsson

107

**Stál**

Allt stál í burðarvirki skal vera Fe 360 samkv. ÍST- DS 412 nema annað sé tekið fram á teikningum.  
Allar súður skulu uppfylla flokk C samkv. íst EN 25817:1992  
Allt stál skal heitgalvanhúðað.  
Allt stál í festingum skal vera Fe 360 og allir boltar uppfylla styrkleikaflokk 4,6 samkv. DS 412.

Útgáfa	Breyting	Dagsetning	Hannað
Sveinbjörn Hinriksson Byggingatæknifræðingur Kl. 160851-2529 Brekkuvegur 8 Hafnarfirði Sími: 555-4008, 861-9851 Netfang: sveinh@netnet.is		Staður Gjáhella 15 Hafnarfirði Skipting Stálvirki, þversnið f. Co. tss	
Hannað / Teiknað	Kvartál	Dagsetning	Verkr.
	1:75	22. 6. 08	42-07
			Teikn. nr. 3-03