

# GLITVELLIR 8 HAFNARFIRÐI.

Samþykkt þann

22 DEC 2009

Byggingafrádrátturinn í Hafnarfirði  
F.h. Hrölfur S. Gunnlaugsson

**SKÝRINGAR:**  
 STEYPA S-250.  
 SEMENTINNHÁLD = 300 kg/m³.  
 LOFTINNHÁLD > 5 - 7%.  
 V/S-TALA < 0,55.  
 STEYPUHULA Í ÚTVEGGJUM = 30 mm.  
 STEYPUHULA Í PLÖTU = 20 mm.  
 BENDISTÁL K6410.  
 BENDING VEGGJA.  
 ÚTVEGGIR EINFÖLD GRIND Í ÚTBRÚN.  
 LÁRÉTT K10 c/c 200.  
 LÖÐRÉTT K10 c/c 300.  
 MILLIVEGGIR EINFÖLD GRIND Í MIÐJAN VEGG  
 K10 c/c 250.  
 2 K10 VÍÐ ÖLL OP, NEMA ANNAD KOMI FRAM Á TEKNINGU.

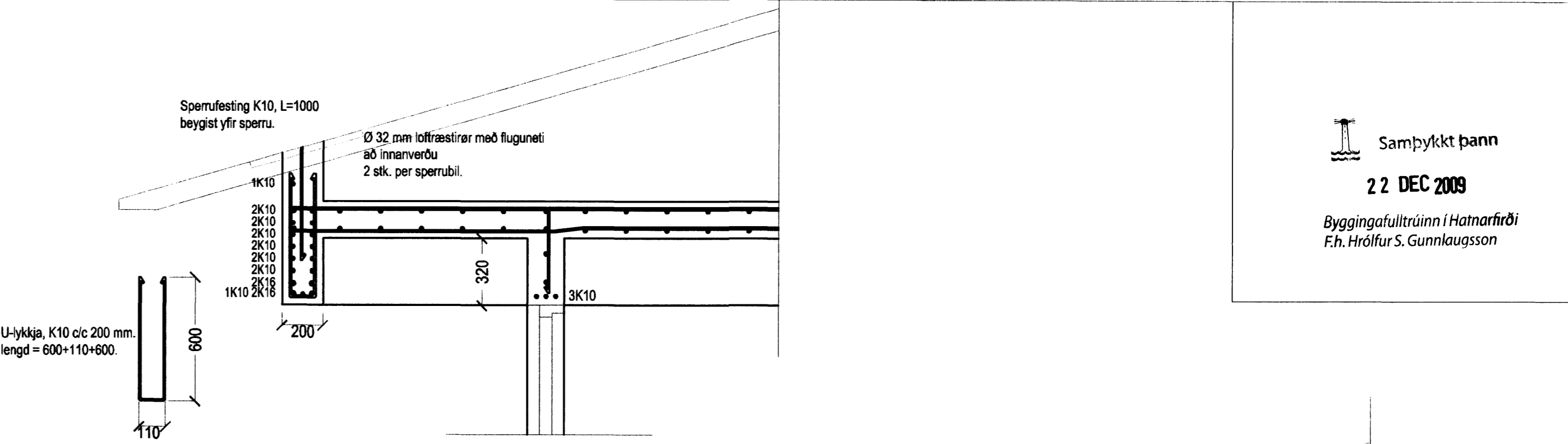
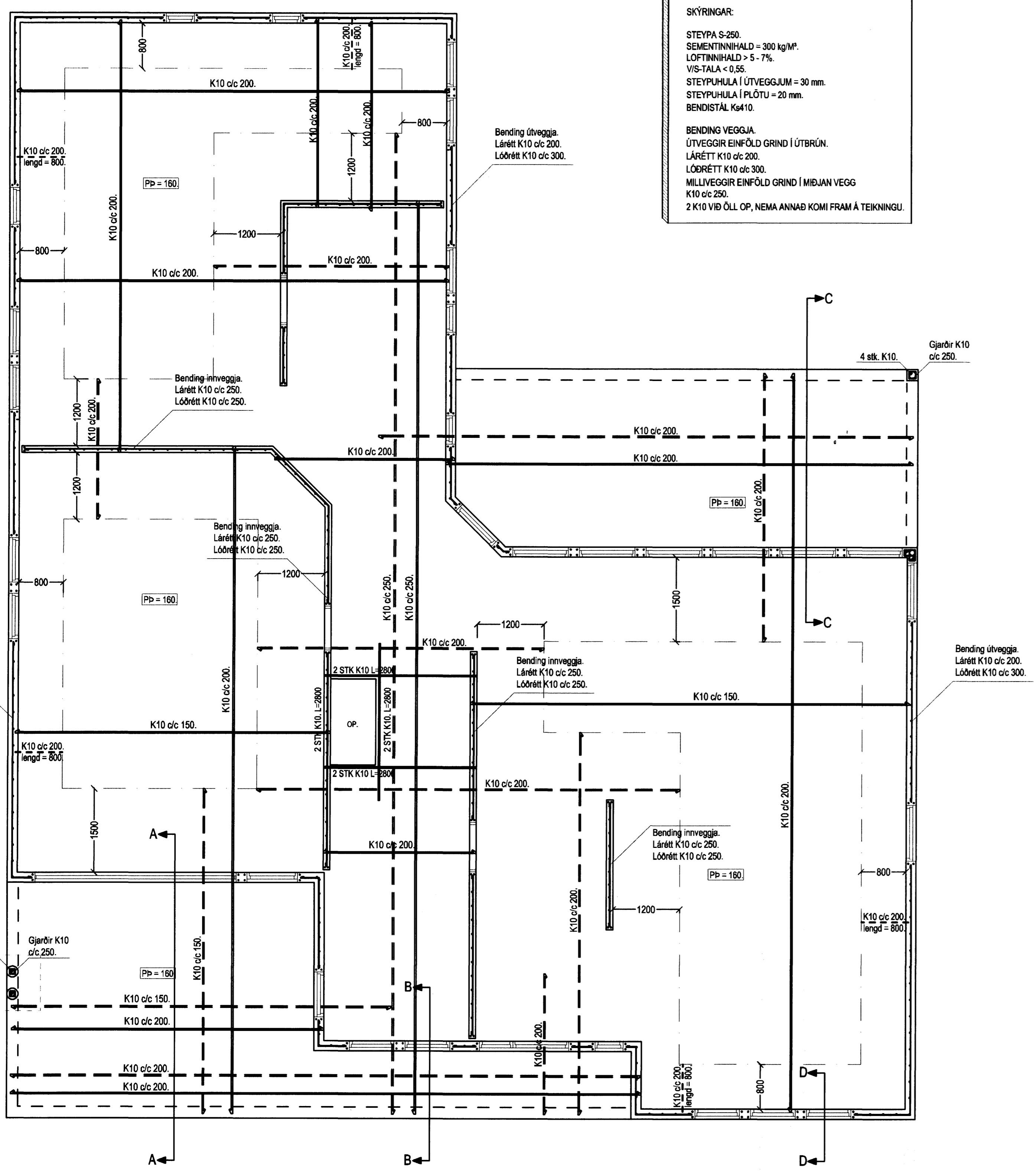

SNID B - B MKV. 1:20.

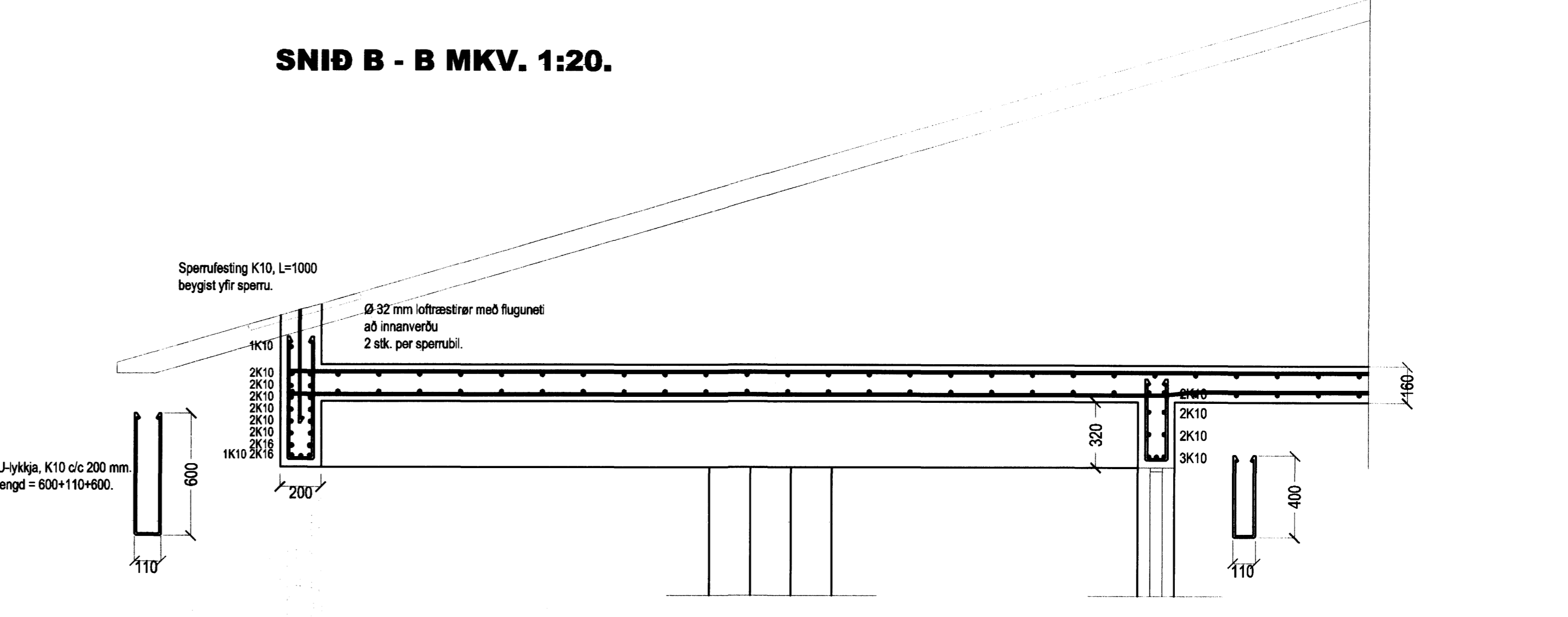

SNID A - A MKV. 1:20.

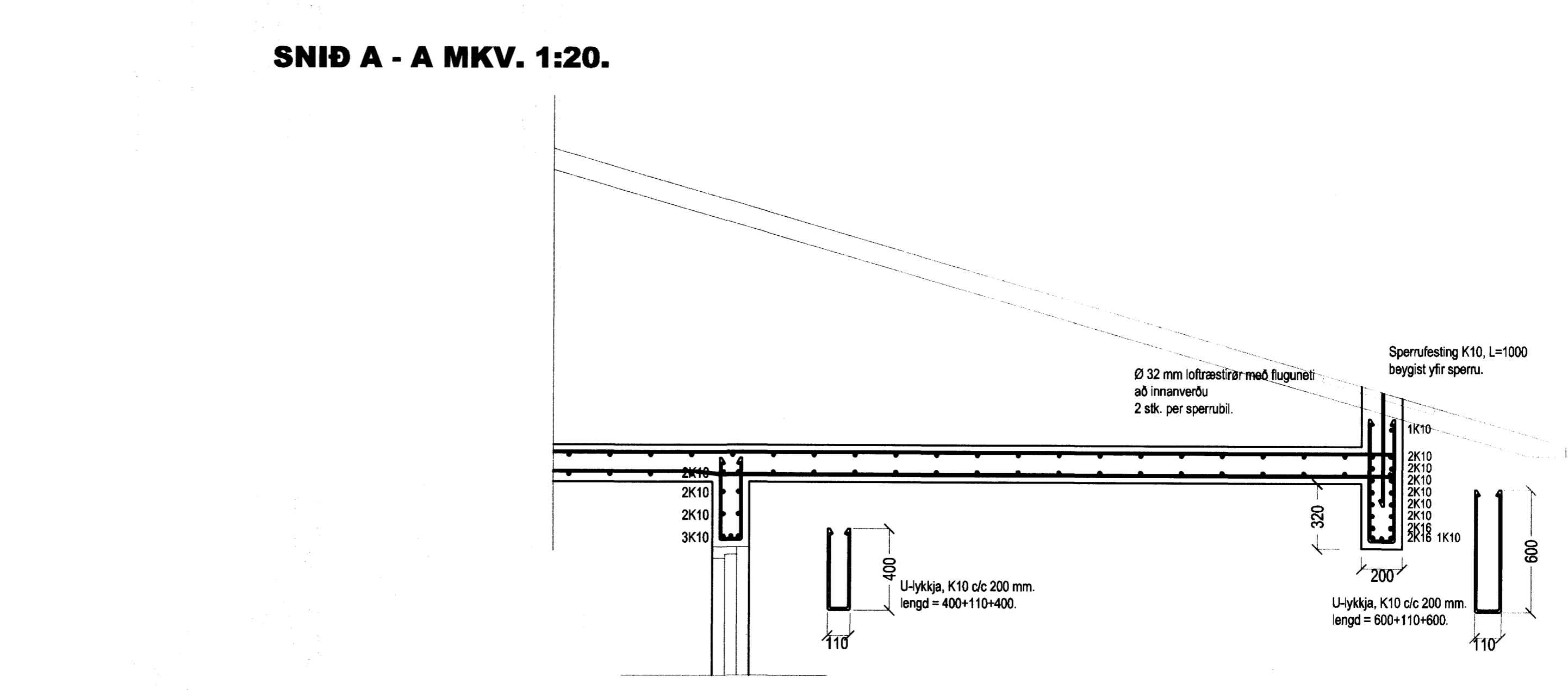

SNID C - C MKV. 1:20.

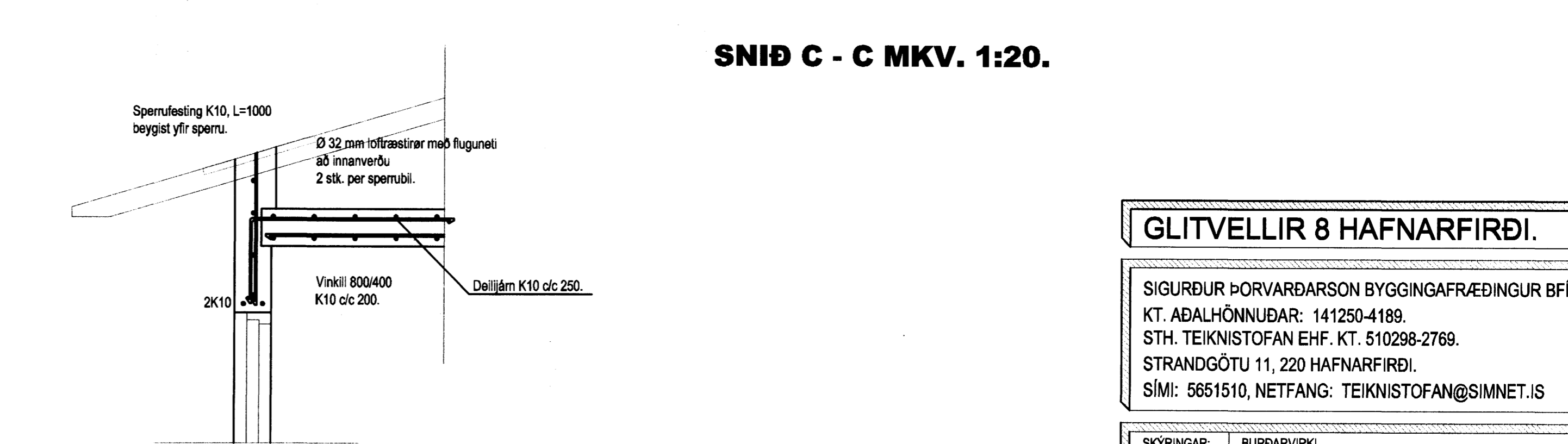

SNID D - D MKV. 1:20.

**GRUNNMYND  
BURÐARVIRKI VEGGIR & PLATA, MKV. 1:50.**

**GLITVELLIR 8 HAFNARFIRÐI.**  
 SIGURÐUR ÞORVARÐARSON BYGGINGAFRÆÐINGUR BFÍ.  
 KT. ADALHÖNNUÐAR: 141250-4189.  
 STH. TEIKNISTOFAN EHF. KT. 510298-2769.  
 STRANDGÖTU 11, 220 HAFNARFIRÐI.  
 SÍMI: 5651510, NETFANG: TEIKNISTOFAN@SIMNET.IS

SKÝRINGAR:	BURÐARVIRKI
TEIKNING:	VEGGIR & PLATA
MÆLIKVARDI:	1:20 / 1:50
UNDRISKRIFT:	<i>[Signature]</i>
BLAD NR:	DAGSETNING: 08 08 08
BREYTT:	PLATA TEIKNUD 14.12.2009.