

SÚLUR 1:10

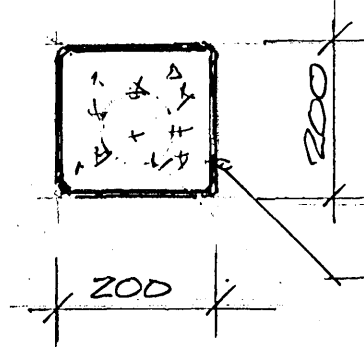

STÁLSÚLUR
RHS 200x200x6
Fylltar með steypu

BURÐARRAMMAR FYRIR ÞAKKANT 1:10

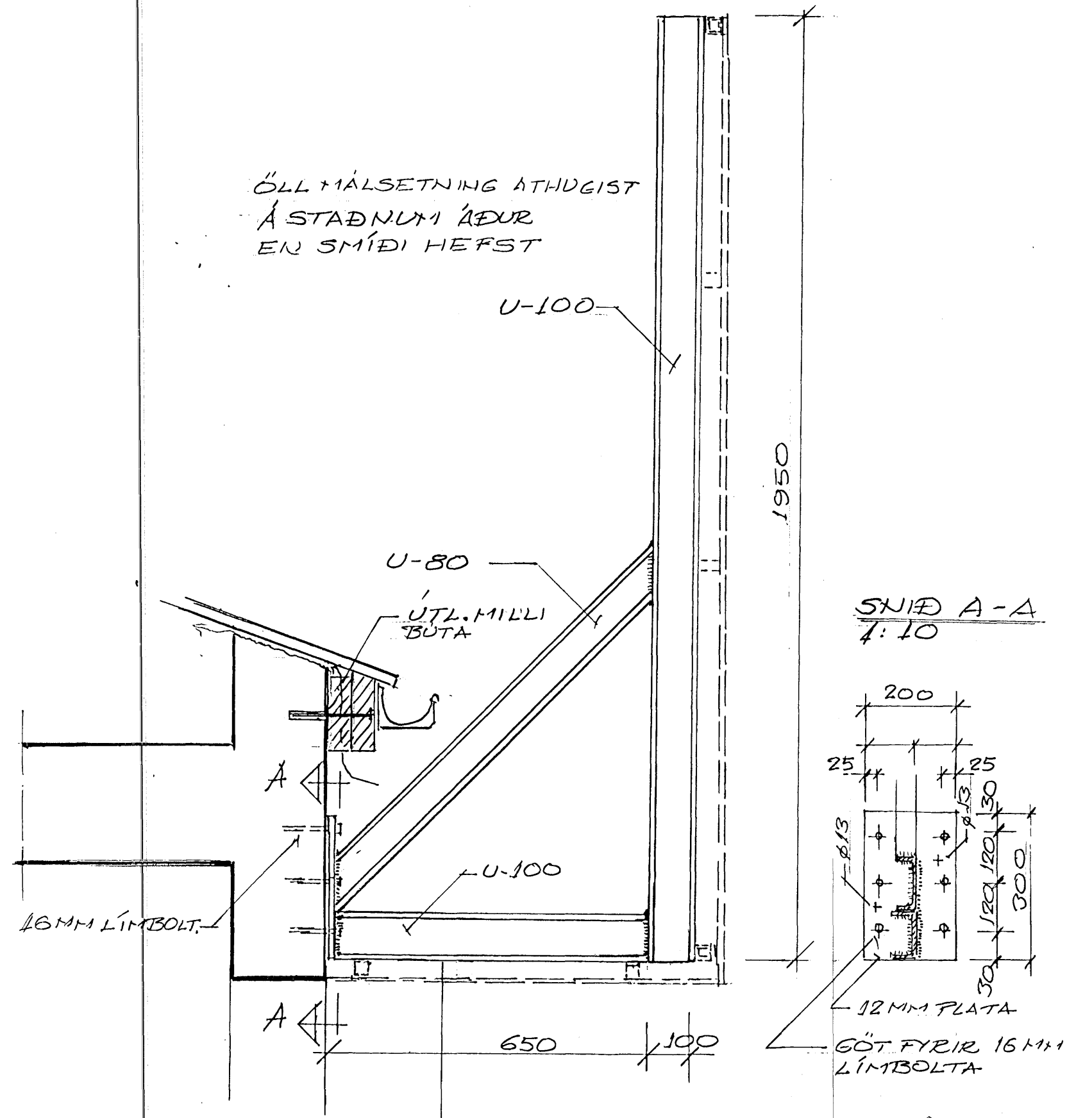

SNJED A-A
1:10

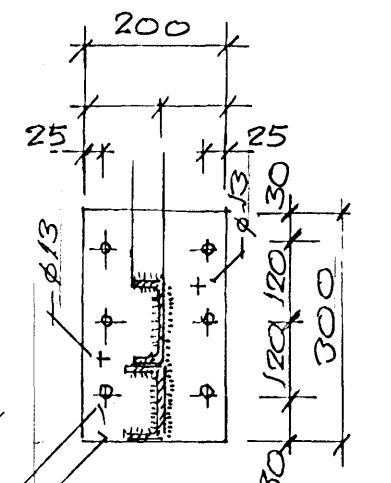

Samþykkt þann
16 NOV. 2006

Byggingafulltrúinn í Hafnarfirði
Fh. Sigurbjartur Halldórsson

ÞÁLMAR KRISTJÓNSSON ARKITEKTY
08 440 5350

TEKNIÞJÓNUSTAN SF
Lágmúla 5 - 108 Reykjavík
s. 581 3844 fax 581 4740
e-mail tth@tth.is
tth.is
220140-3429

HJALLAHIRAKI 15
HAFNAERTIRÐI
BURÐARSKIND F. ÞAKKANT
SÚLUR Í KJALLARA

Hannað:	Dags:
Teikn:	Yfirfarid:
Kvarði: 1:10	
Nr.: 2	Blad: Af:

Br. Dags. Breyting