

Gólfefnaryfirlit 2. hæðar — mkv. 1: 50.

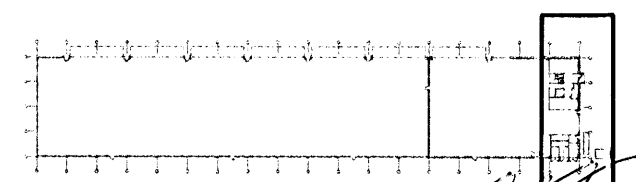
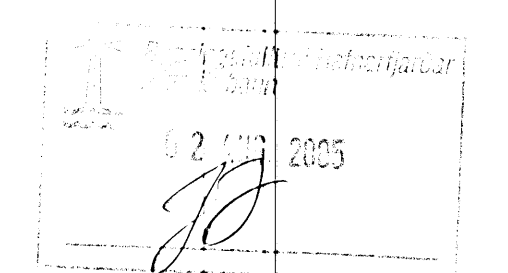

Skýringar:
Explanations:

ARK ÍS ehf
arkitektar ráðgjafar

Adalsteinn Snorason arkitekt fali 161161-2769
Egill Guðmundsson arkitekt fali 270152-6869
Gísli Gíslason arkitekt fali 160657-4809

Skólavörðustíg 11 101 Reykjavík
sími 511 2060
fax 511 2066
netfang arkis@ark.is

A	Reyndartekning	08.06.05	hi
1	Hæðar kóti í teknifými breitt	21.04.04	hk
Breyt. Rev.	Breyting Revision	Dags. Date	Samb. Approved

Tilv. teikningar nr. ISAL Ref. drawing no. of ISAL

Samsætn. teikningar nr. ISAL Assembly drawing no. of ISAL

This drawing is the property of the Alcan Iceland Ltd. and handed out for personal use only. It may neither be copied nor made available to others without permission of the Alcan Iceland Ltd. The receiver is liable for any misuse.

Fjöldi stykka Number of pieces	Hlutur Object	Átriði Item	Efni Material	eo. stk (kg)	Stöð í heild Dyngd	Athugasemdir Remarks
IV III II I	Mhl.01 Víkurgata 7 / ál-og tækjageymsla				Stöð í heild 7510	1: 50
	Gólfefnaryfirlit starfsmannarýma á 2.hæð. Grunnmynd.				Koastn. nr. / Síman. / Cóno.-Eq. no. 7510 12094	AKS no. US33
	Varkali / Supplier	ARKIS ehf			Tekn. nr. / Varkali / Draw no. of suppl.	(43)3.02 A
	Teknið Drawn	gg jg ms ee 26.09.03	Yfirfarið Checked	as	Sambýkt Appróved	as
	ALCAN PRIMARY METAL EUROPE ISAL Alcan Iceland Ltd	Straumsvík IS-222 Hálfarfordur	ALCAN		Drögn. of ISAL / Tekn. nr. ISAL	168524 A
	Teknið Drawn		Yfirfarið og skrifað Checked and filed		Notkun heita Released	