

Samþykkt þann
 03 MAY 2012
 Byggingafulltrúinn / Notendur
 Fh. Sigurður Steinarsson

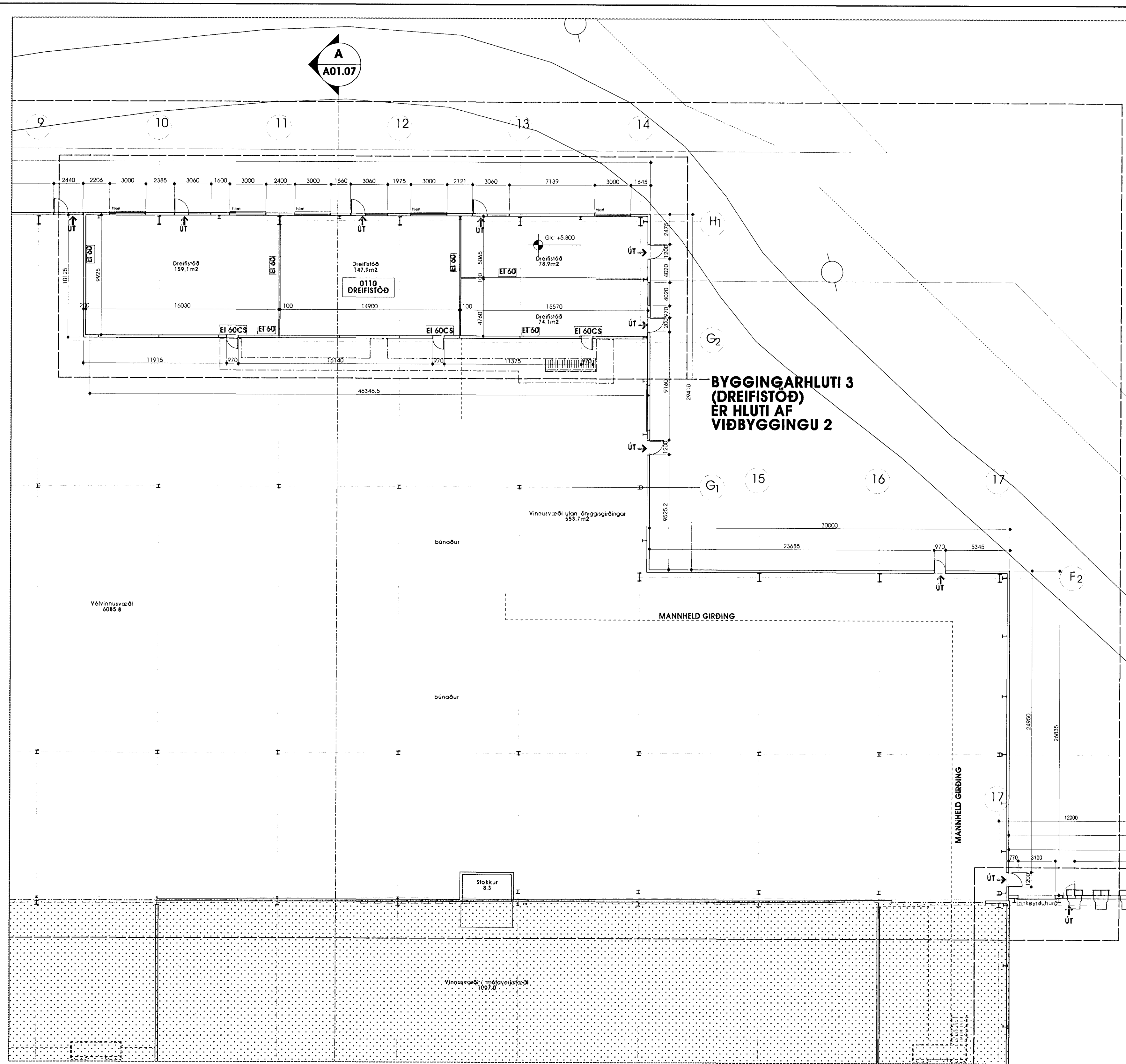

1 GRUNNMYND 1.HÆÐ - VIÐBYGGING 2 - HLUTI 2 / BYGGINGARHLUTI 3 - DREIFISTÖÐ
 mkv. 1:200

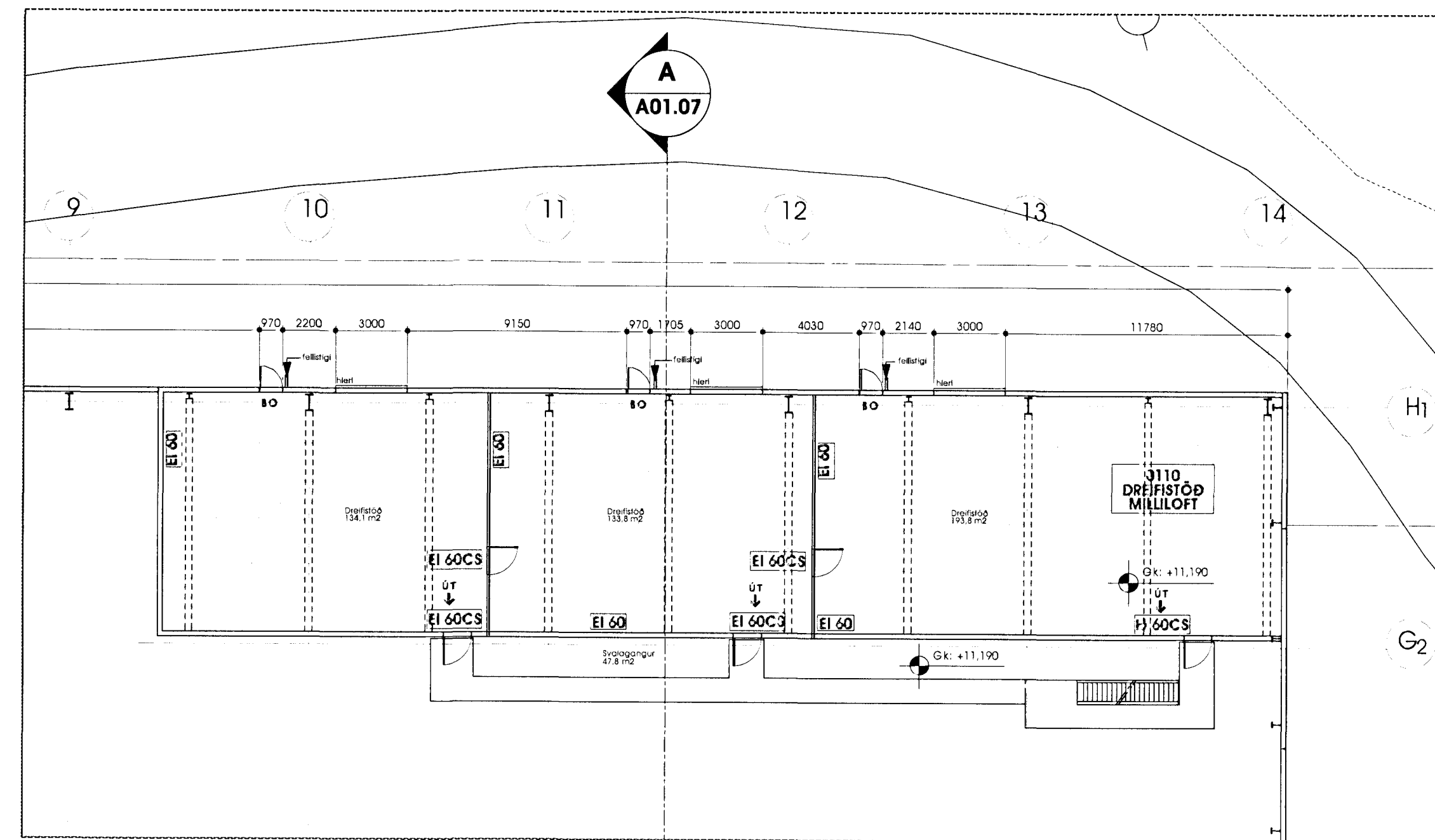

2 GRUNNMYND 2.HÆÐ - BYGGINGARHLUTI 3 - DREIFISTÖÐ
 mkv. 1:200

34.2012
 HEILBRIGGISEFTIRLIT 5
 HANSAEJAFAR-
 OG KONA OG GÆSSEÐIS
 Gardatorn 210 Gardabe
 K. Stefansson

28.05.2012
 (Signature)

Skýringar:
 Legend:

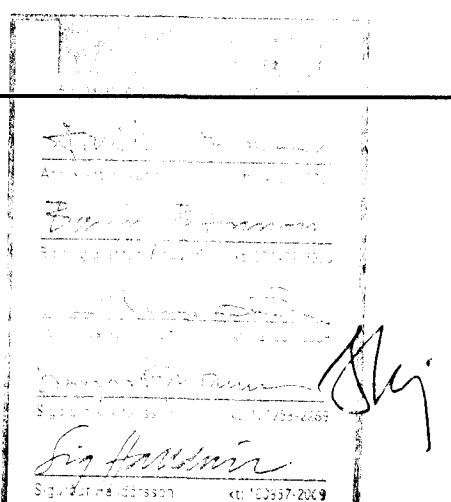

Utg nr / Rev no	Lýsing / Description	Dagsetning / Date	Han/Thn / Des/Drw	Yfir / Ckd	Notk heim / Suppl Rel	Notk heim / ISAL Rel
A	As built	09.03.2012	SK	SK		

This drawing is the property of Rio Tinto Alcan Iceland Ltd. and handed out for personal use only. It may neither be copied nor made available to others without permission of Rio Tinto Alcan Iceland Ltd. The receiver is liable for any misuse.
 Stærð: A1
 Mkv.: 1:200
 Dimensions without tolerances according to ISO 2768-1 medium.



Dagsetning / Date: 15.06.2010
 Hannað / Designed: SK / UDM
 Teikn / Drawn: UDM
 Verktaki / Supplier: GLAMA-KIM
 Teikn nr./verktaka / Supplier drw.no: A01.06
 Samþykkt / Approved: Yfir / Chkd: SK
 Hluti af / Part of:

STÆKKUN STEYPUKÁLANS
 GRUNNMYND 1.HÆÐ - VIÐBYGGING 2 - HLUTI 2 / GRUNNMYND 2.HÆÐ DREIFISTÖÐ
 Teg.teikningar / Dwg. type: AÐALUPPRÁTTUR
 Architectural Building Application
Rio Tinto Alcan

Flokkur nr.: 6010
 Blað nr.: 01226
 Nærsta bl.nr.:
 Kostn.nr.-Cono. / Bún.nr.-Eq.no:
 ISAL Teikn.nr. ISAL /Drw.no. of ISAL: 253306
 Breyt./Rev: A