

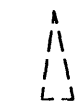



HNITASKRÁ:

PKT NR	X-HNIT	Y-HNIT
300	25144,47	7992,27
301	25141,58	7971,18
302	25137,28	7950,93
303	25135,30	7943,44
304	25128,74	7923,00
373	25183,87	7910,40
374	25171,58	7933,29
375	25173,75	7940,98
376	25179,20	7964,88
377	25182,62	7987,43
400	25130,61	7969,54
401	25121,99	7968,75
402	25101,94	7977,42
403	25079,86	7989,16
413	25084,12	7976,70
414	25108,19	7984,96
415	25124,40	7955,10
420	25114,59	7923,68
421	25090,93	7936,26
422	25092,11	7938,47
423	25070,03	7950,21
434	25094,89	8017,41
435	25116,96	8005,67
436	25134,31	7996,44

SKÝRINGAR:

TILMÆLI FRÁ SKIPULAGSHÖFUNDI UM AÐ LÓÐARHAFI VARÐVEITI SÉRKENNI Í HRAUNINU EINS OG KOSTUR ER.

-  KVÖÐ UM BÍLASTÆÐI INNAN LÓÐAMARKA
-  BINDANDI MÖRK BYGGINGARREITS
-  HÁMARKS BYGGINGARREITUR
-  MÆNISSTEFNA

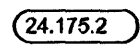
-  NÚMER LÓÐAR
-  NÚMER AÐLIGGJANDI LÓÐABLAÐA
- E1, P1, R1 HÚSAGERÐ, SJÁ SKILMÁLA



**HAFNARFJÖRÐUR
HVALEYRARHRAUN**

Lóðir: VALLARBYGGÐ 1, 2, 3, 4
HAMRABYGGÐ 2, 4, 6

MÆLIBLAÐ 24.176.1

MKV 1:500

Teikning nr.: 111,006

Dags.: 08.05.1997

Yfirf.: *G. Val*

VSÞ Verkfræðistofa ehf
Bæjarhrauni 20, 220 Hafnarfjörður
sími 565 1340, fax 565 1341
netfang vsb@vso.is
Útgefið af bæjarverkfræðingi:

20.10.98 873

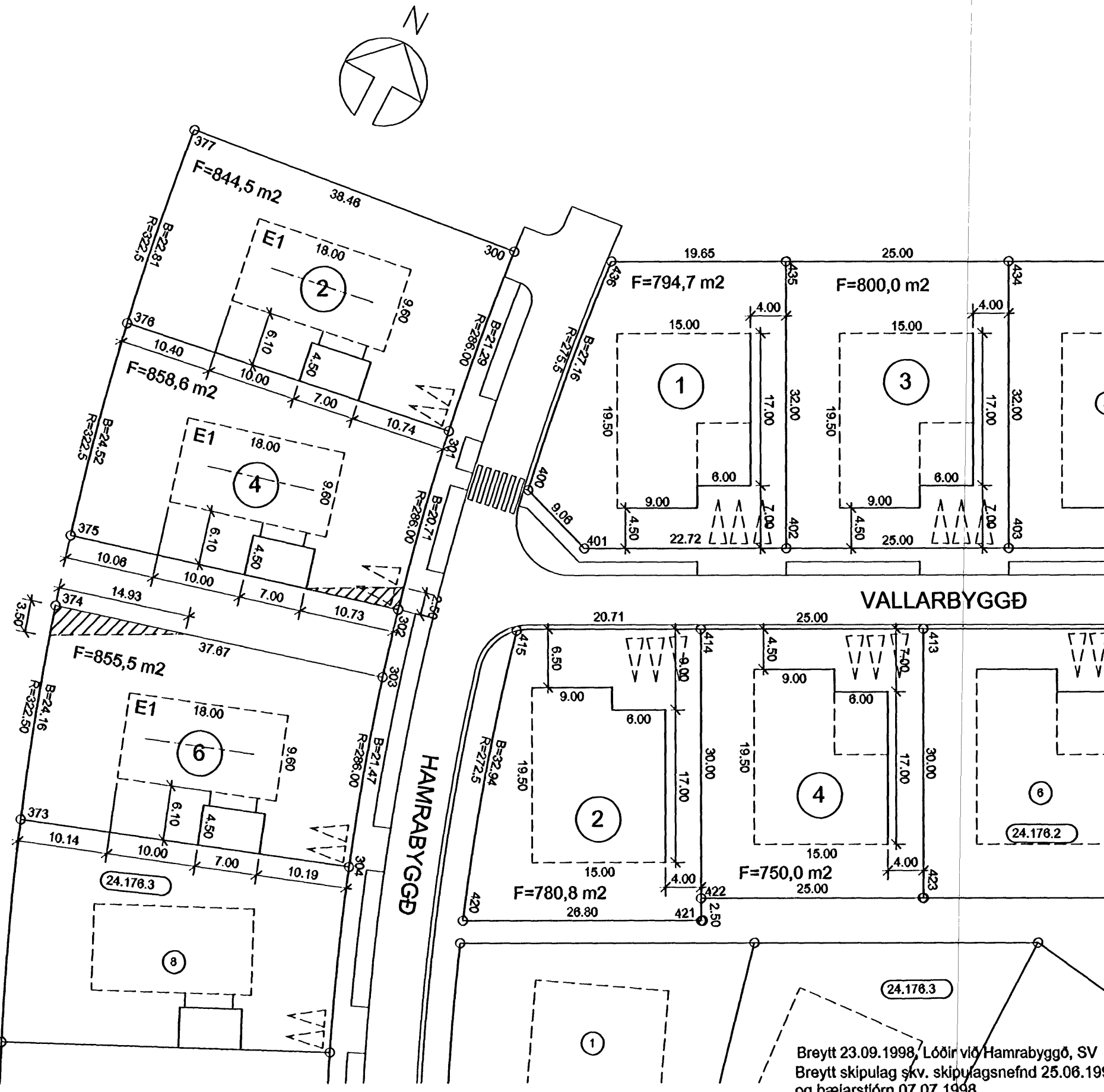

 KVÖÐ UM LAGNIR

Breytt 23.09.1998, Lóðir við Hamrabbyggð, SV
Breytt skipulag skv. skipulagsnefnd 25.06.1998
og bæjarstjórn 07.07.1998