

LB1 - langband 90x367 Mkv.: 1:20  
Samtals 12 stk.

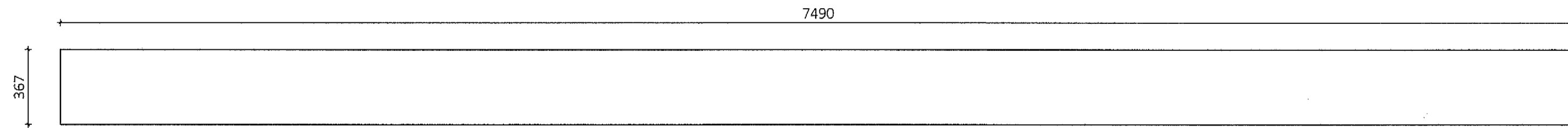

LB2 - langband 90x367 Mkv.: 1:20  
Samtals 18 stk.

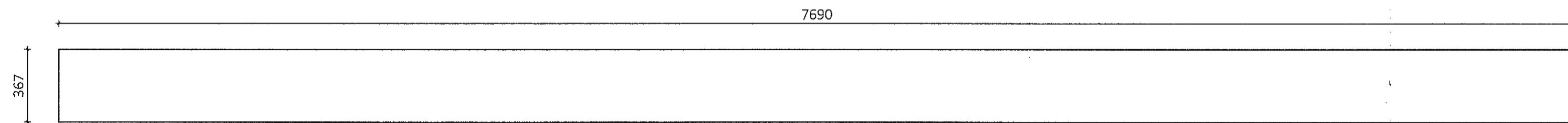

PG1 - langband 65x367 Mkv.: 1:20  
Samtals 10 stk.

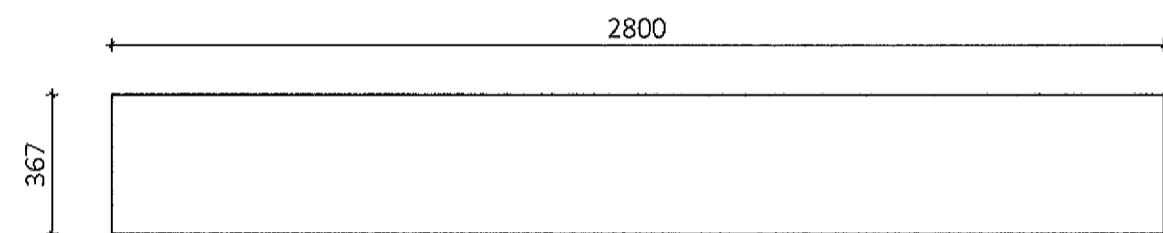

PG2 - langband 65x487 Mkv.: 1:20  
Samtals 10 stk.

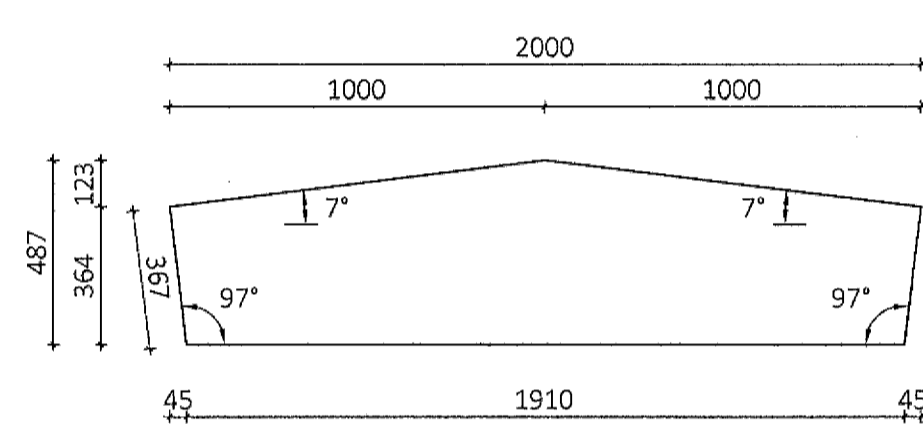

PG3 - langband 90x100 Mkv.: 1:20  
Samtals 20 stk.

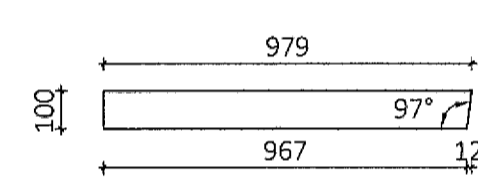

SP1 - Sperra 55x700 Mkv.: 1:20  
Samtals 10 stk + 10 stk speglaðar

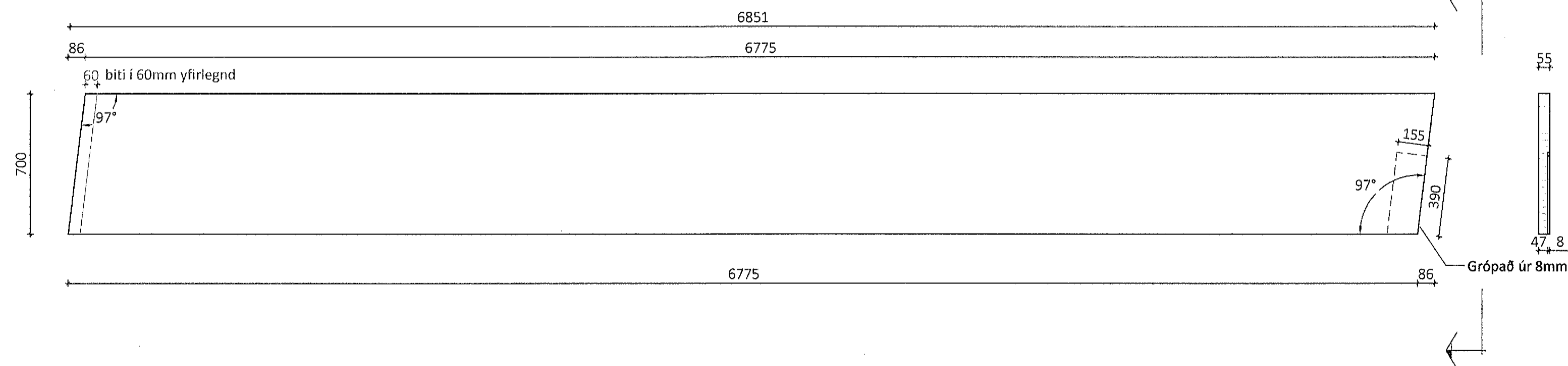

VR1 - Veggreim 65x200 Mkv.: 1:20  
Samtals 20 stk.

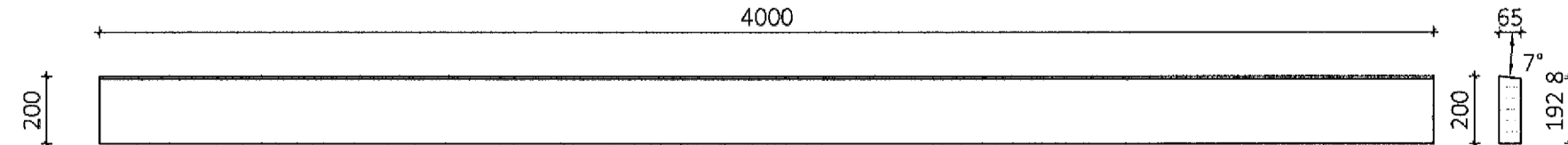

ÖLL AÐNOT OG AFRITUN TEIKNINGAR AÐ HLUTA EÐA Í HEILD ER HÁÐ SKRIFLEGU LEYFI LÍMTRÉ VÍRNET EHF.

Númer	Dags.	Skýring breytingar	Dr. af
<b>LímtreVrnet</b>	MKV. 1:20	DAGS. 05.07.2013	VERKNR. DL13 022
Byggingafræðingur - Vesturvír 23 - 200 Kópavogur kt. 440510-1160 - Sími: 412 5300	TEIKN. KB	REIKN. KB	ÚTGAFANR. 1
HEITI VERKS: <b>Stapahraun 9</b>	NAFN HÖNNUÐAR Bjarni Ingibergsson byggingafræðingur B.Sc. kt. 030861-2729 - bjarni@limtrevrnet.is		NR. TEIKNINGAR <b>381</b>
HEITI TEIKNINGAR Endurnýjun á þakvirki Límtre framleiðsluteikningar	ÁRITUN HÖNNUÐAR <i>Bjarni Ingibergsson</i>	DAGS. ÁRITUNAR 3/7 2013	
	ÁRITUN SAMRÆM. HÖNNUÐAR <i>Fl. Höllur S. Gunnlaugsson</i>	DAGS. ÁRITUNAR 12.09.2013	