

- 1 STÁLKLÆDNING
- 2 ÁBRÆDDUR UNDIRPAPPI
- 3 ÁBRÆDDUR YFIRPAPPI 1000 mm VÍÐ KVIST
- 4 15 MM KROSSVIÐUR SKV VERKFR.TEIKN
- 5 TIMBURLEKTUR 34 X 50 mm
- 6 VINDPAPPI
- 7 HE 200 M-PROFIL
- 8 HE 220 B-PROFIL
- 9 ÞAKBITAR 50 X 200 mm
- 10 200 mm STEINULLAREINANGRUN HALDID UPPI MED 2 mm STÁLÞRÁÐ C/C 300 mm
- 11 RAKASPERRA, ÞOLPLAST 0.2 mm
- 12 TIMBURLEKTUR 58 X 45 mm c/c 600mm
- 13 LOFTKLÆDNING 2 X 13 mm GIPSPLOTUR

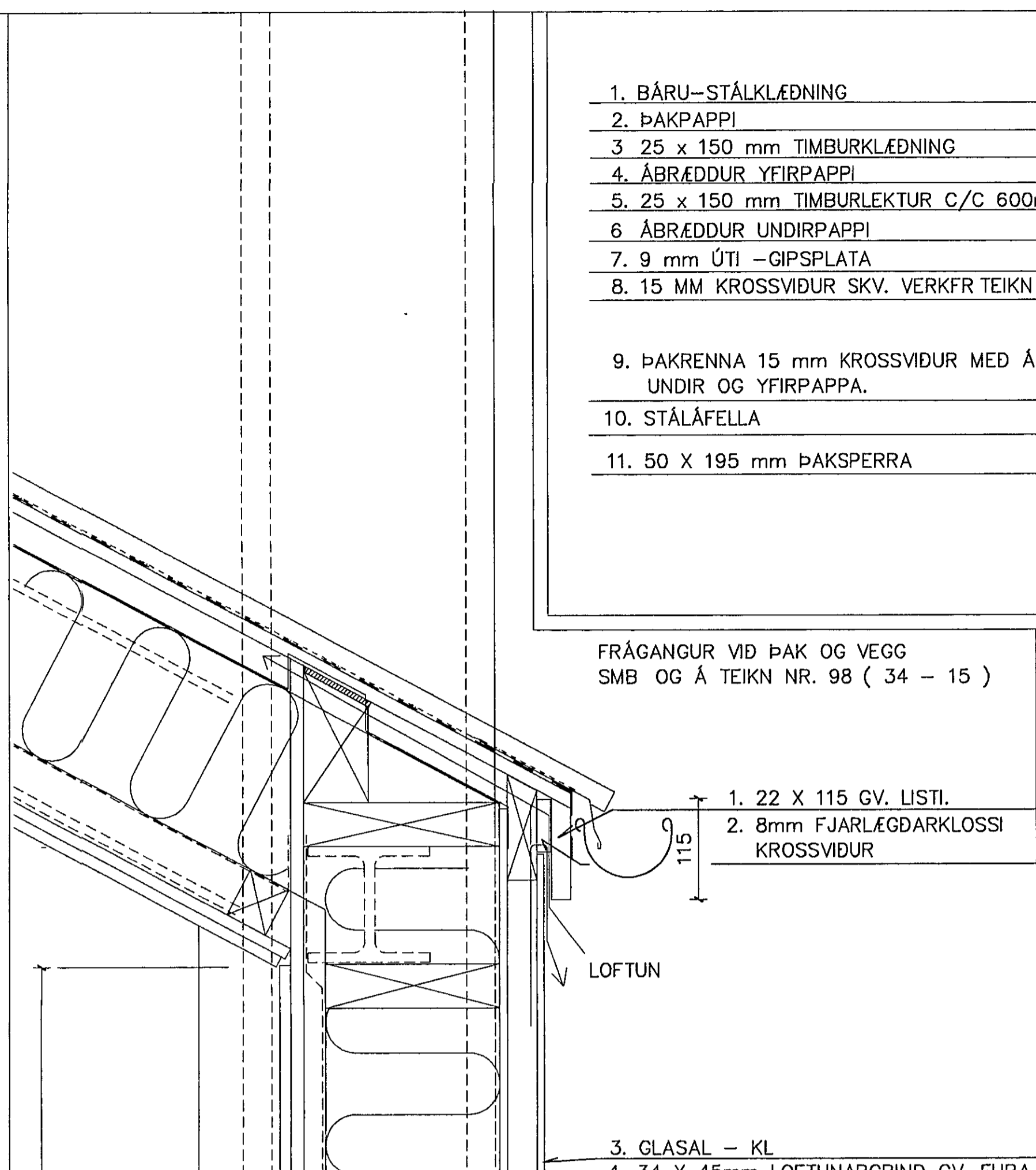

1. BÁRU-STÁLKLÆDNING
2. ÞAKPAPPI
- 3 25 x 150 mm TIMBURKLÆDNING
4. ÁBRÆDDUR YFIRPAPPI
5. 25 x 150 mm TIMBURLEKTUR C/C 600mm
6. ÁBRÆDDUR UNDIRPAPPI
7. 9 mm ÚTI -GIPSPLATA
8. 15 MM KROSSVIÐUR SKV. VERKFR TEIKN

9. ÞAKRENNNA 15 mm KROSSVIÐUR MED ÁBRÆDDUM UNDIR OG YFIRPAPPA.
10. STÁLAFELLA
11. 50 X 195 mm ÞAKSPERRA

FRÁGANGUR VÍÐ ÞAK OG VEGG
SMB OG Á TEIKN NR. 98 (34 - 15)

1. 22 X 115 GV. LISTI.
2. 8mm FJARLÆGDARKLOSSI KROSSVIÐUR

3. GLASAL - KL
- 4 34 X 45mm LOFTUNARGRIND GV. FURA
5. 9mm ÚTIGIFSPATA
6. 50 X 200mm TIMBURGRIND SKV. VERKFR.TEIKN.
7. 200 mm STEINULL (ÞÉTTULL)
8. RAKAVARNARLAG 0.2mm
9. 22 x 45mm GRIND
- 10 15mm KROSSVIÐUR SKV VERKFR.TEIKN
11. 13mm GIFSPATA

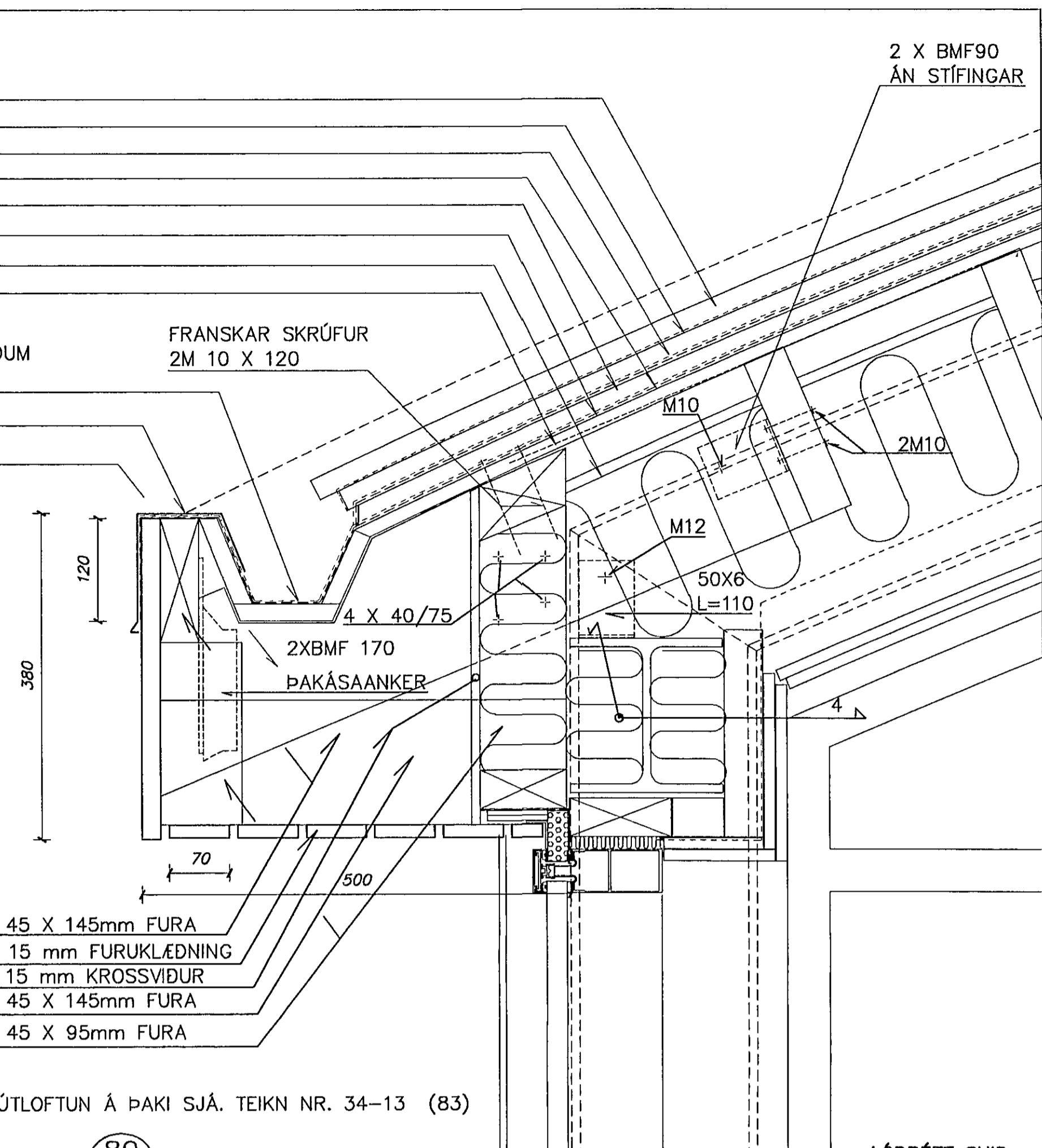

- 12 45 X 145mm FURA
13. 15 mm FURUKLÆDNING
14. 15 mm KROSSVIÐUR
- 15 45 X 145mm FURA
16. 45 X 95mm FURA

ÚTLOFTUN Á ÞAKI SJÁ. TEIKN NR. 34-13 (83)

89
27/02

LÓDRÉTT SNID
1:20

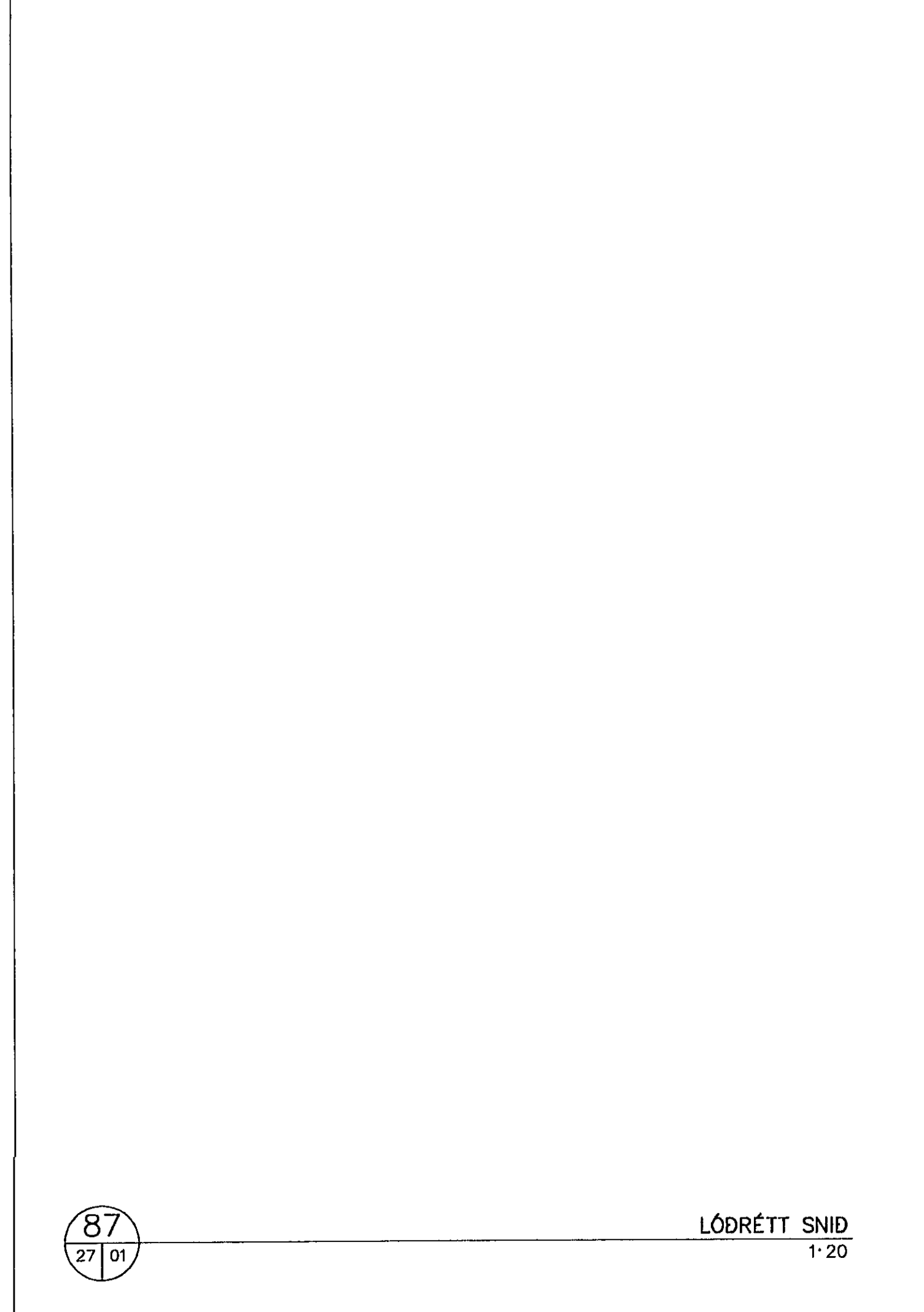

87
27/01

LÓDRÉTT SNID
1:20

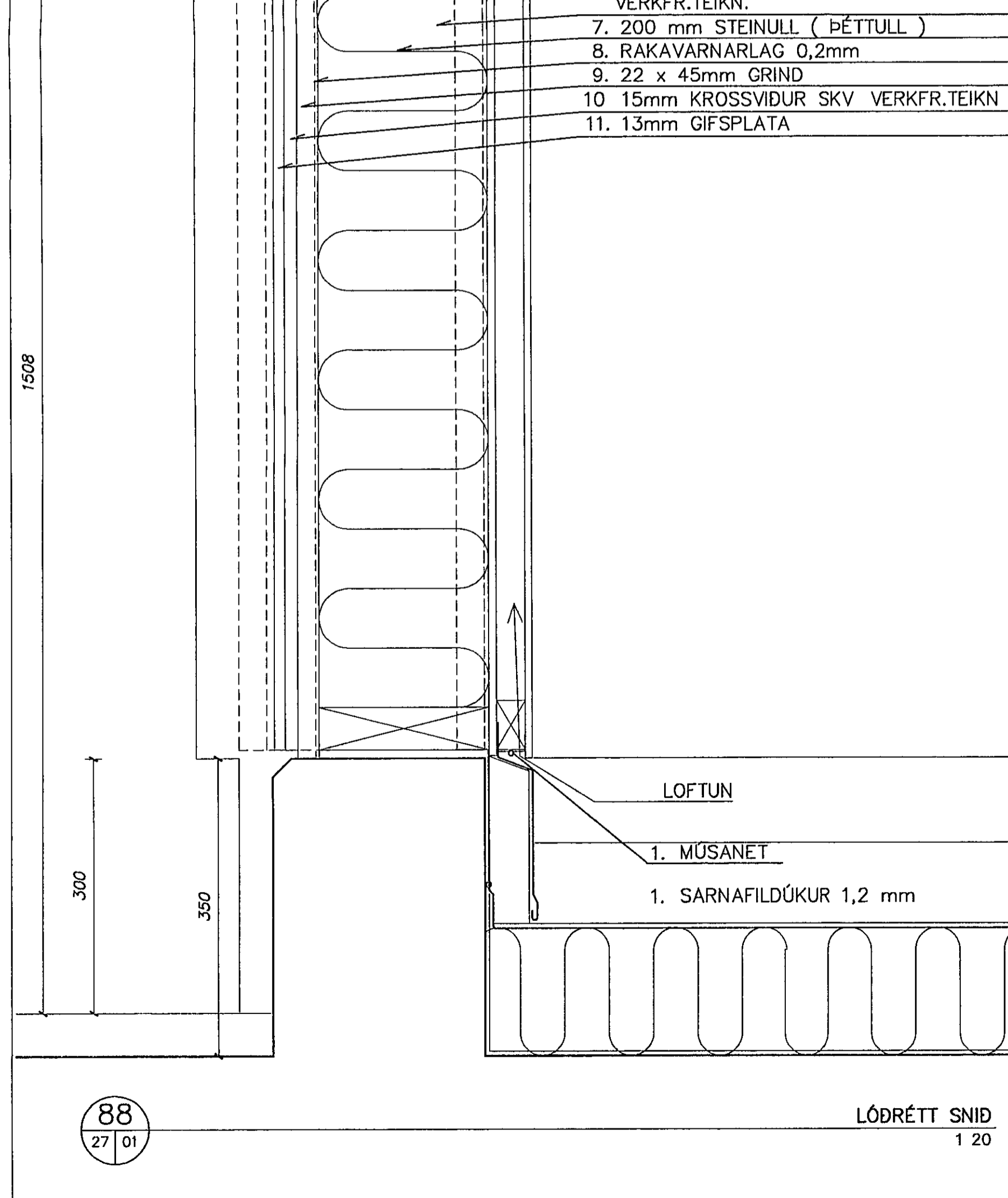

88
27/01

LÓDRÉTT SNID
1:20

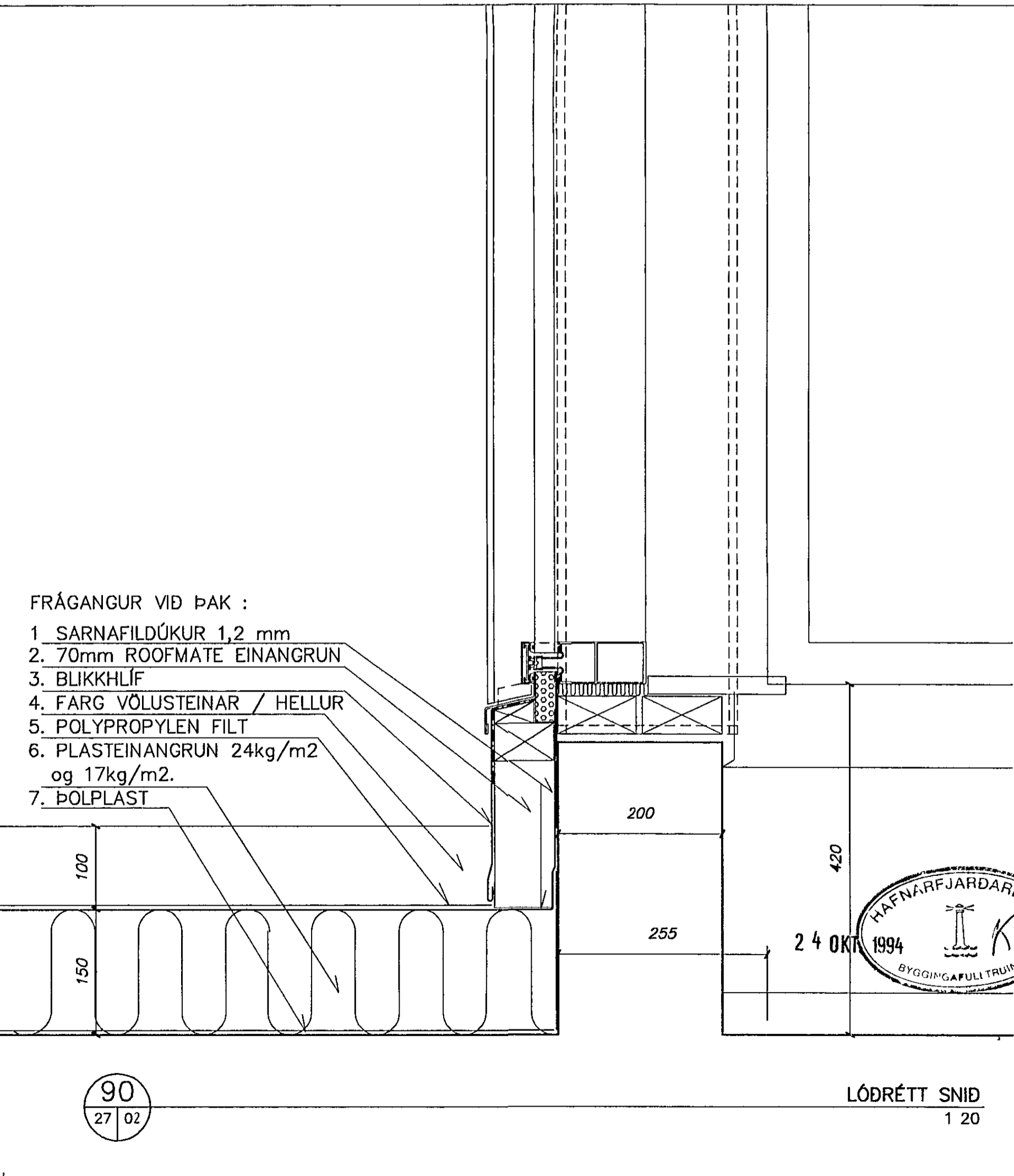

FRÁGANGUR VÍÐ ÞAK :

1. SARNAFILDÚKUR 1,2 mm
2. 70mm ROOFMATE EINANGRUN
3. BLIKKHILF
4. FARG VÖLUSTEINAR / HELLUR
5. POLYPROPYLEN FILT
6. PLASTEINANGRUN 24kg/m² og 17kg/m².
7. ÞOLPLAST

90
27/02

LÓDRÉTT SNID
1:20

B	BETT INN TEXTA OFL.	09/08/94
A	FESTINGAR OG ÝMIS FRÁG	01/08/94
NR	FJÖLDI	BREYTINGAR
		DAGS
		SAMÞ

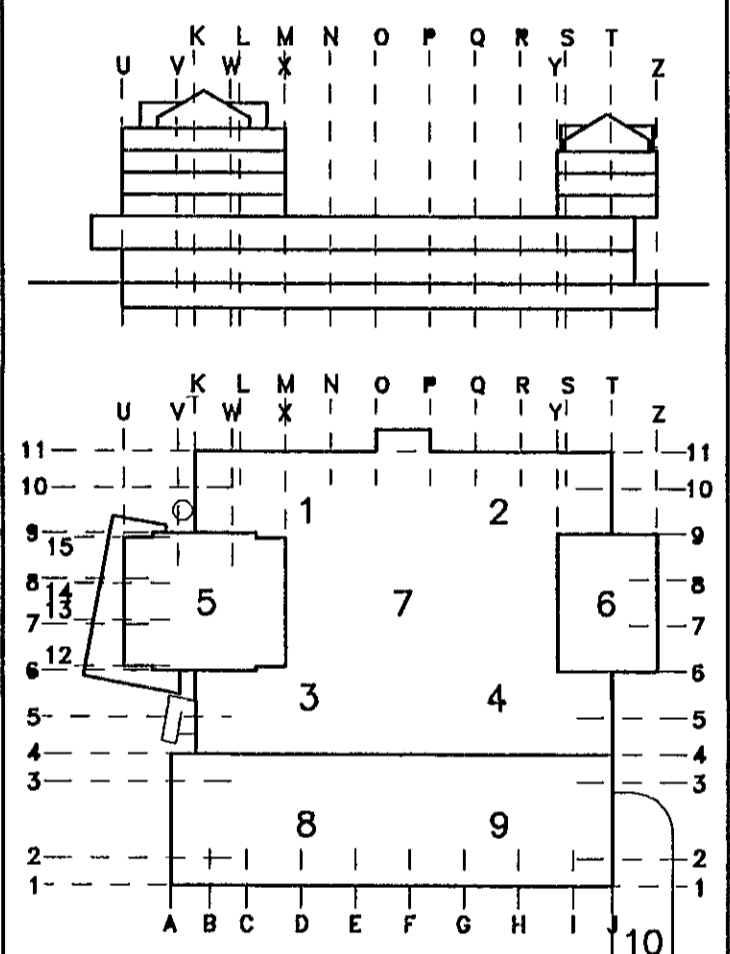

MIDBÆR
HAFNARFJARÐAR
FJARDARGATA 13-15

TEIKNISTOFA ERLINGS G PEDERSEN
ARKITEKT FAI
STÓRHÖFDI 17 - 112 REYKJAVÍK
SÍMI 680088

HEITI
DEILI
ÞAKDEILI
7. HÆÐ. HÓTEL

WÁL	1	5			
HANNAÐ	EGP	hó	TEIKNAD	EGP/hó	YFIRFAR
DAGS	09/05	1994			
TEIKNING NR.	ARK : 34-14		BREYTING NR.	B	