

SKJEDUR B, M:1:20 SKJEDUR C, M:1:20 SKJEDUR A, M:1:20

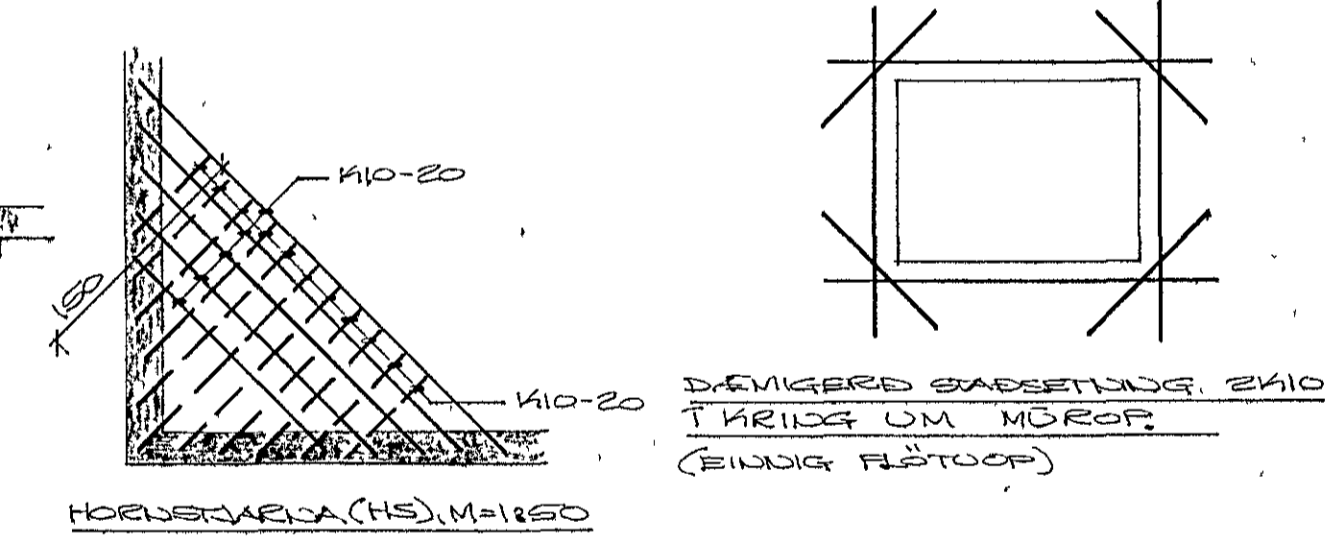

SKJEDUR (HS) M:1:50

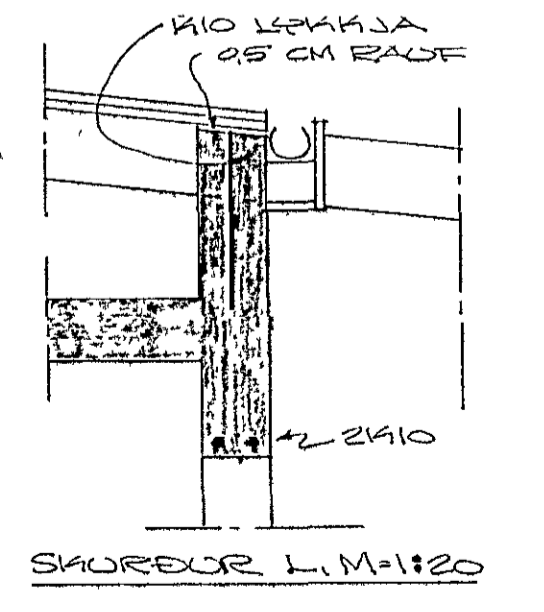
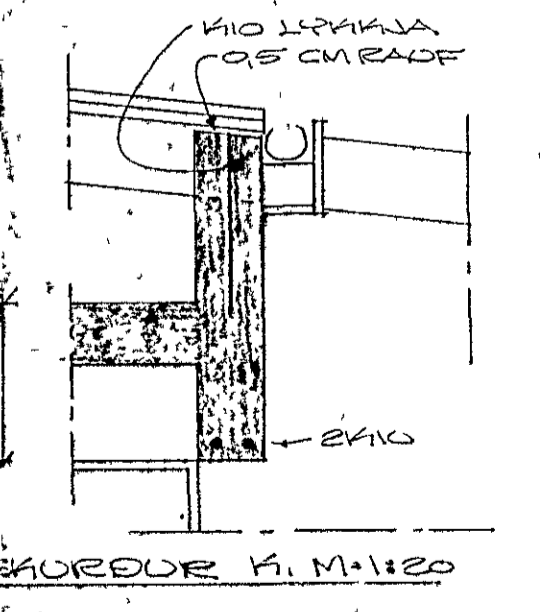
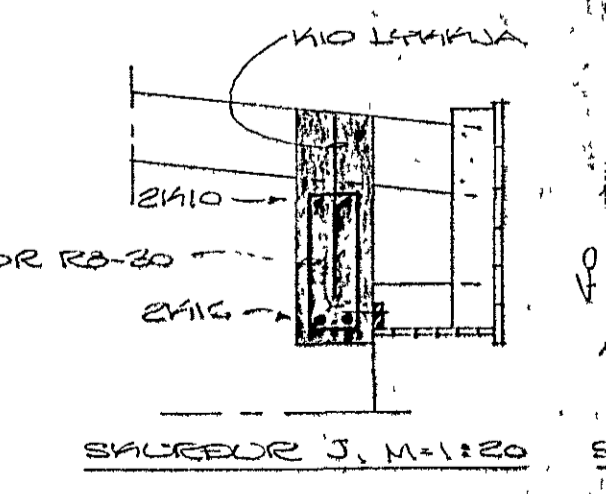
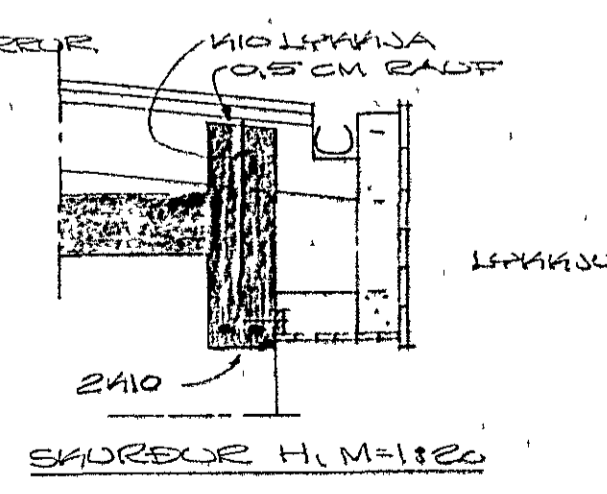
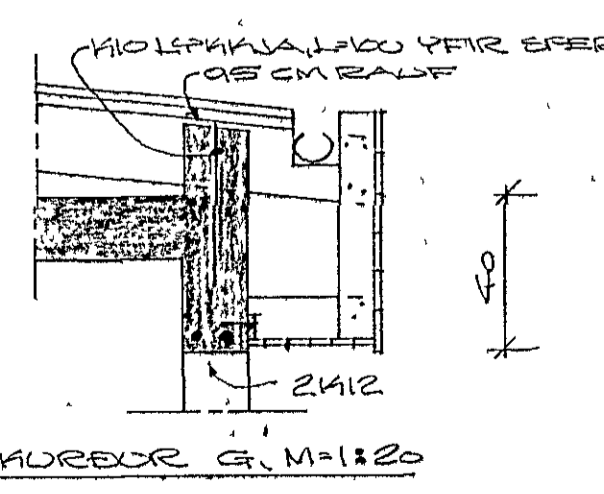
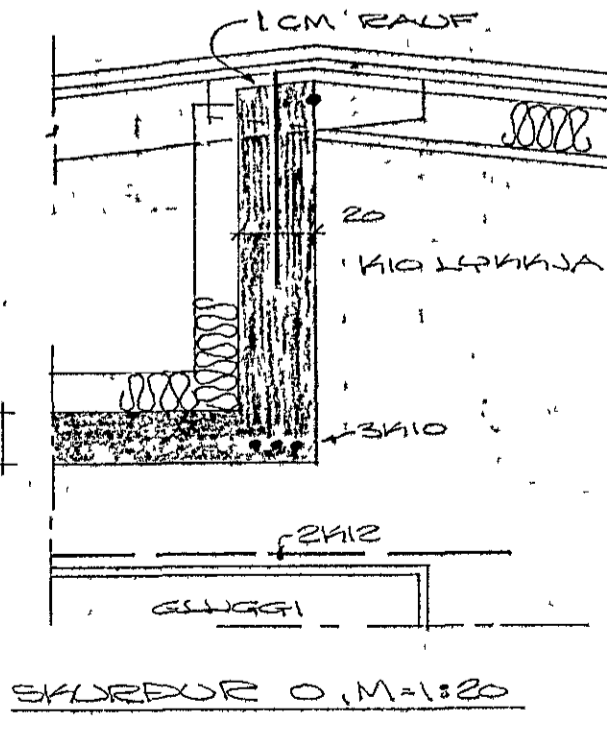
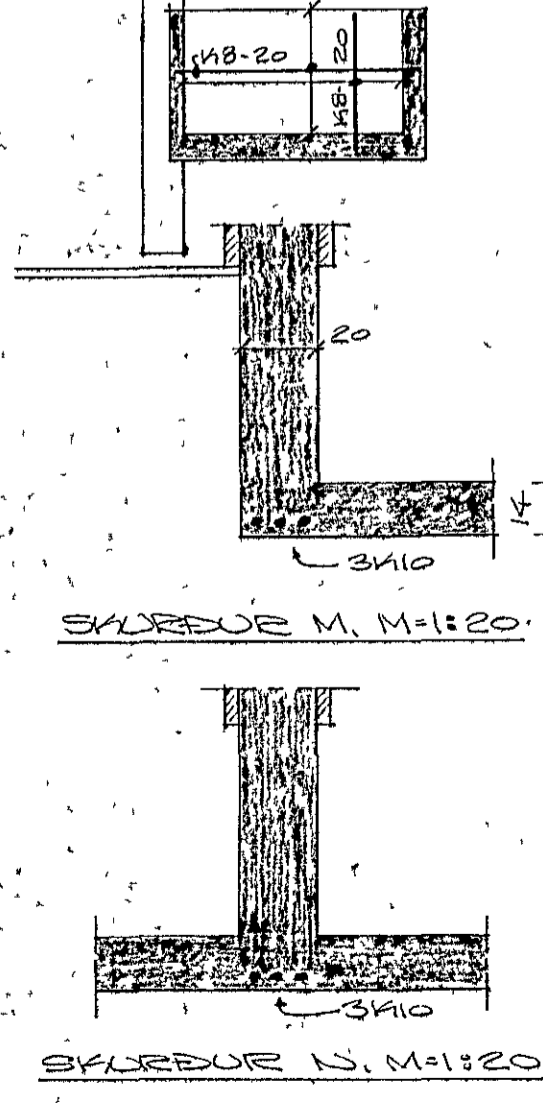

GRUNDMUND, M:1:50

FLÖÐERHVAÐ = 14
 STAINSTEPPA: 5200, FL. B, D MAX = 30 T RÖTUM OG BITUM.
 BEGGISTÁL: 8 · SLÉTT STÁL
 H = 1550 KAMBSTÁL
 FJALLAÐ JARNA FRÁ PFIRBODI STEPPU SKAL VERA
 1,5 CM T RÖTUM OG 20 CM T BITUM.
 HÖ SKERTIST UM 40 CM, H10 + H12 UM 60 CM OG H16 HVERGI,
 Í HÖNDUM UM MÖRUP KOMI 2X10, Í NEMA ANJARS ER GETIÐ.
 Í STEPPUBEL VEGJA KOMI H8-30, L = 80.
 JARNAVERMÁL ERU MM, SÍÐUR MÁL ERU CM.
 JARN Í EYFRA BODI.
 JARN Í DÖÐRA BODI.
 EKKI MÁ SKETA FLERÍ EÐ SÍU HVERJA SÍÐUR Á SAMAN STAD Í RÖTUM.