

SNEIDING B-B I:100

PRÁKSAR (KANTÉ 1, 2, 6, 7 SJÁ BL 103)

BIL	B	H	L (CM)	STK	ATH
R-D	115	600	12,39	12	RETTIRYNDUR
D-E	90	400	8,25	12	
E-F	90	400	8,25	12	
F-G	90	400	8,25	12	
G-H	90	400	8,25	12	
H-I	90	400	8,25	12	
I-J	90	400	8,25	12	
J-K	90	400	8,27	12	

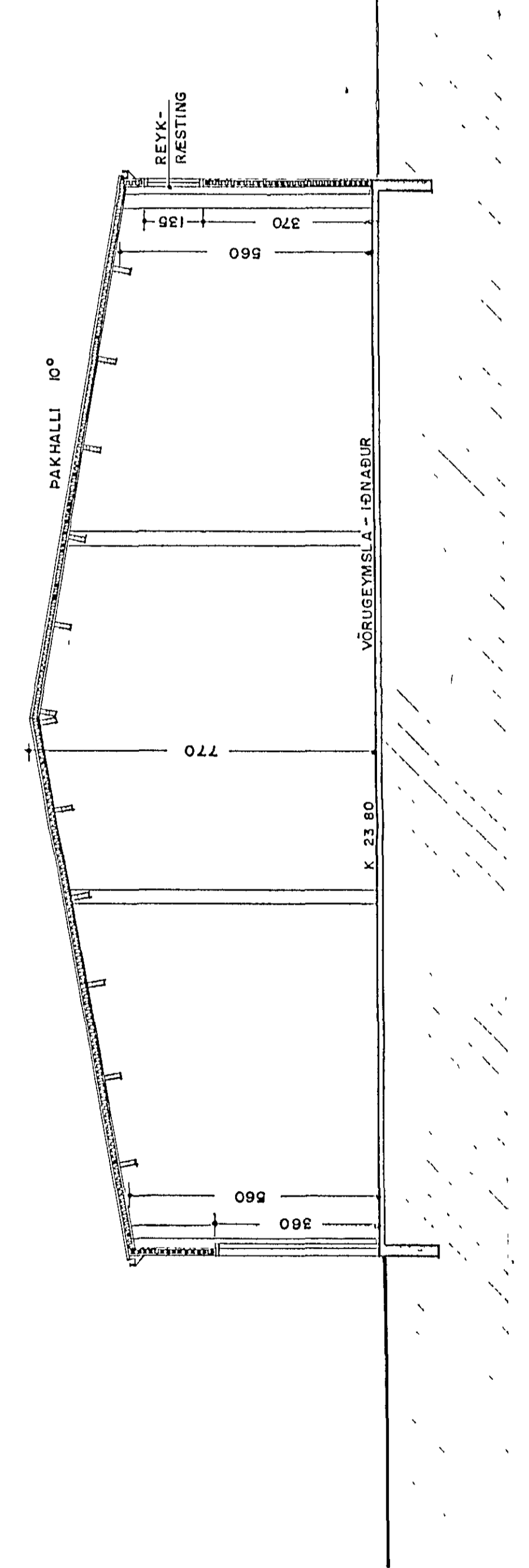

SNEIDING A-A I:100

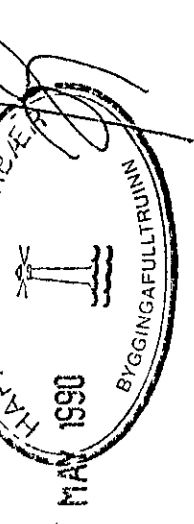
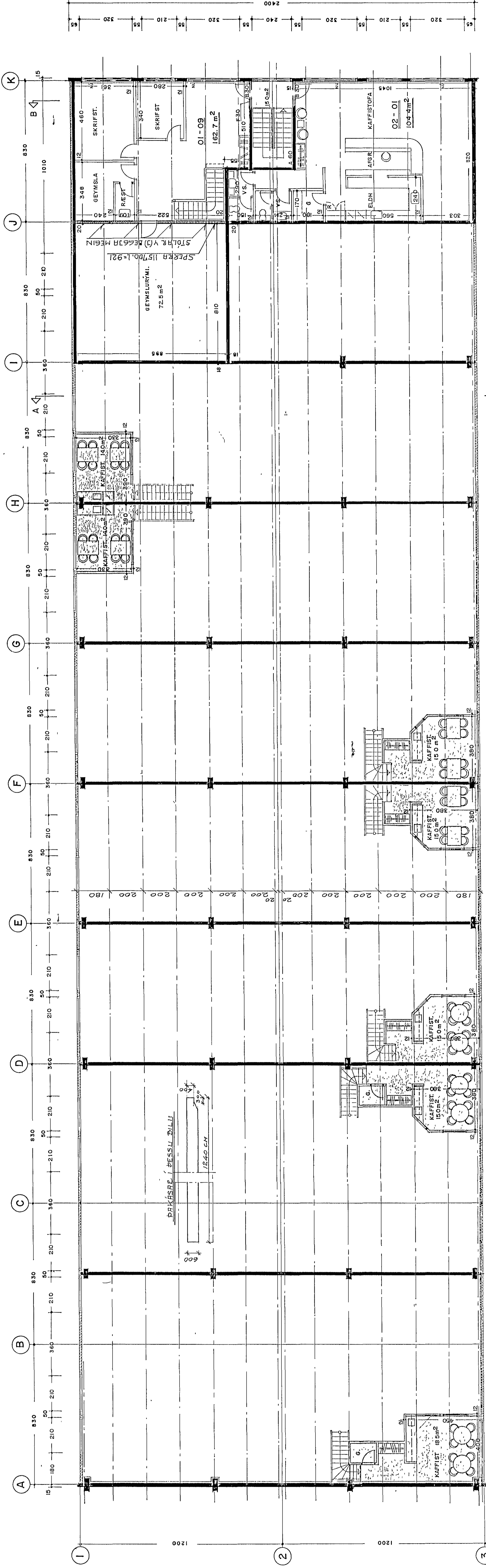

7 JAN 1990
 HAFNARFIRÐI
 SKYRNINGAR

STEYPTIR HEFAN OG STÁLAR F ÁSA
 SJÁ BL 66, 105, 106, 107, 108 OG 109

HJALLAHRUN 4	FORB. ÞORBEGGSSON
HAFNARFIRÐI	HRUNNIBE 58, 58TIO27
PRÁKSAR OG STEYPTIR HEFAN	ZEKKA 1226
SKYRNINGAR	TEIÐA 2266
1:100	BL 104
1990	NF 8811