

Samþykkt þann
21 OCT 2010
Byggingarútlitnir í Hafnarfirði
F.A. Höfður S. Gunnleugsdóttir

FÁLMAR KRISTMUNDSSON ARKITEKT

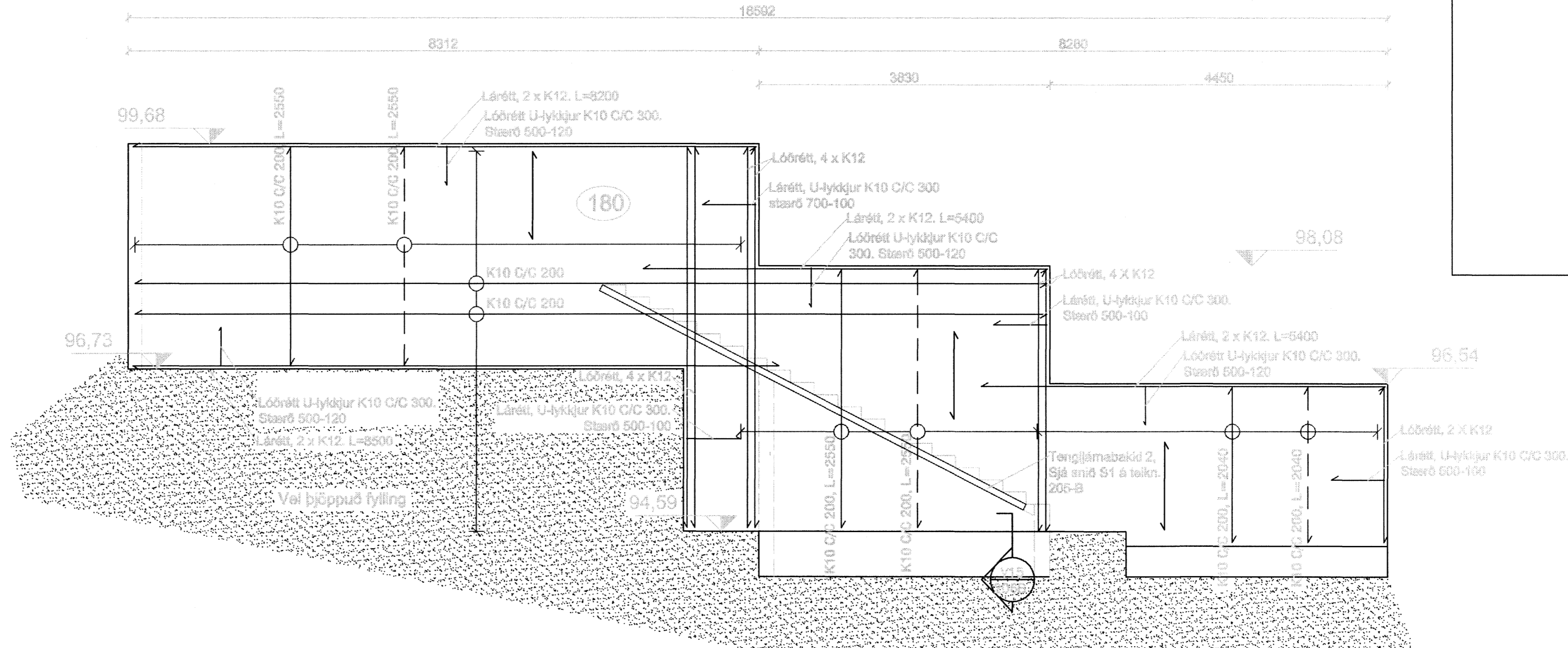

Skurðmynd A-A, Mkv 1:50 / Jámbending
stoðveggs

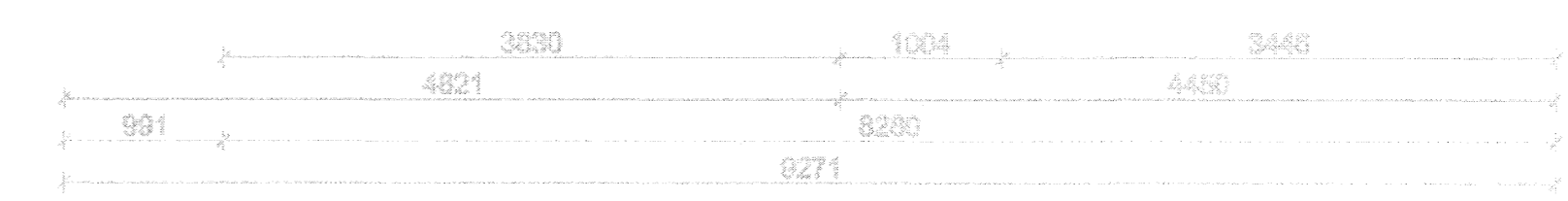

Lárétt 2 x K12
Lóðrétt K10 C/C 200
Lóðrétt U-Lykkjur K10 C/C 300
Stærð 500-120
Lárétt K10 C/C 200

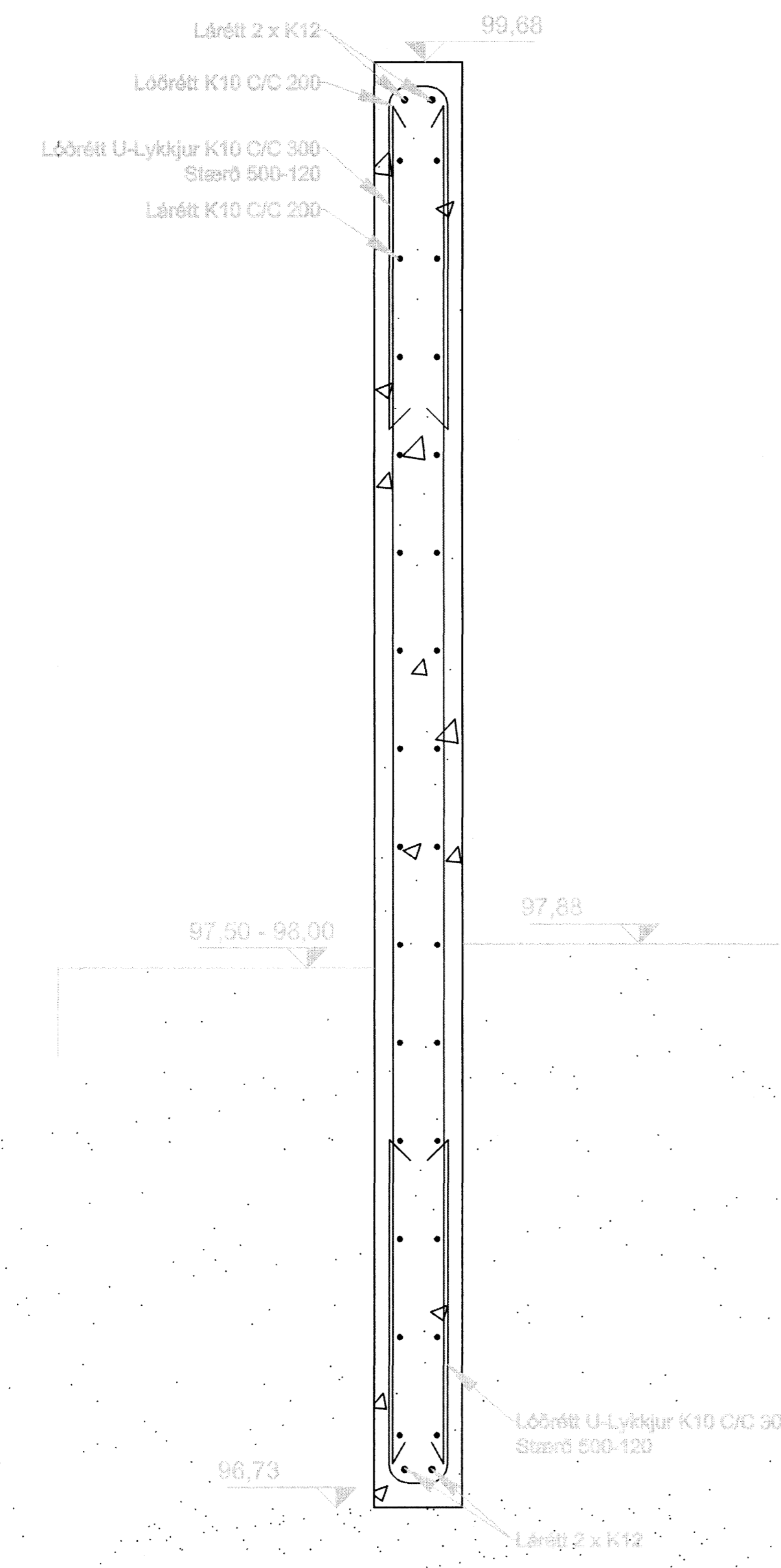

V14 Snið, Stoðveggur
201B 1:10

Sjá má frágang eftir brúna vegg
á skurðmynd A-A á teikningu nr
206-B.

Lóðrétt K10 C/C 200
Lárétt K10 C/C 200

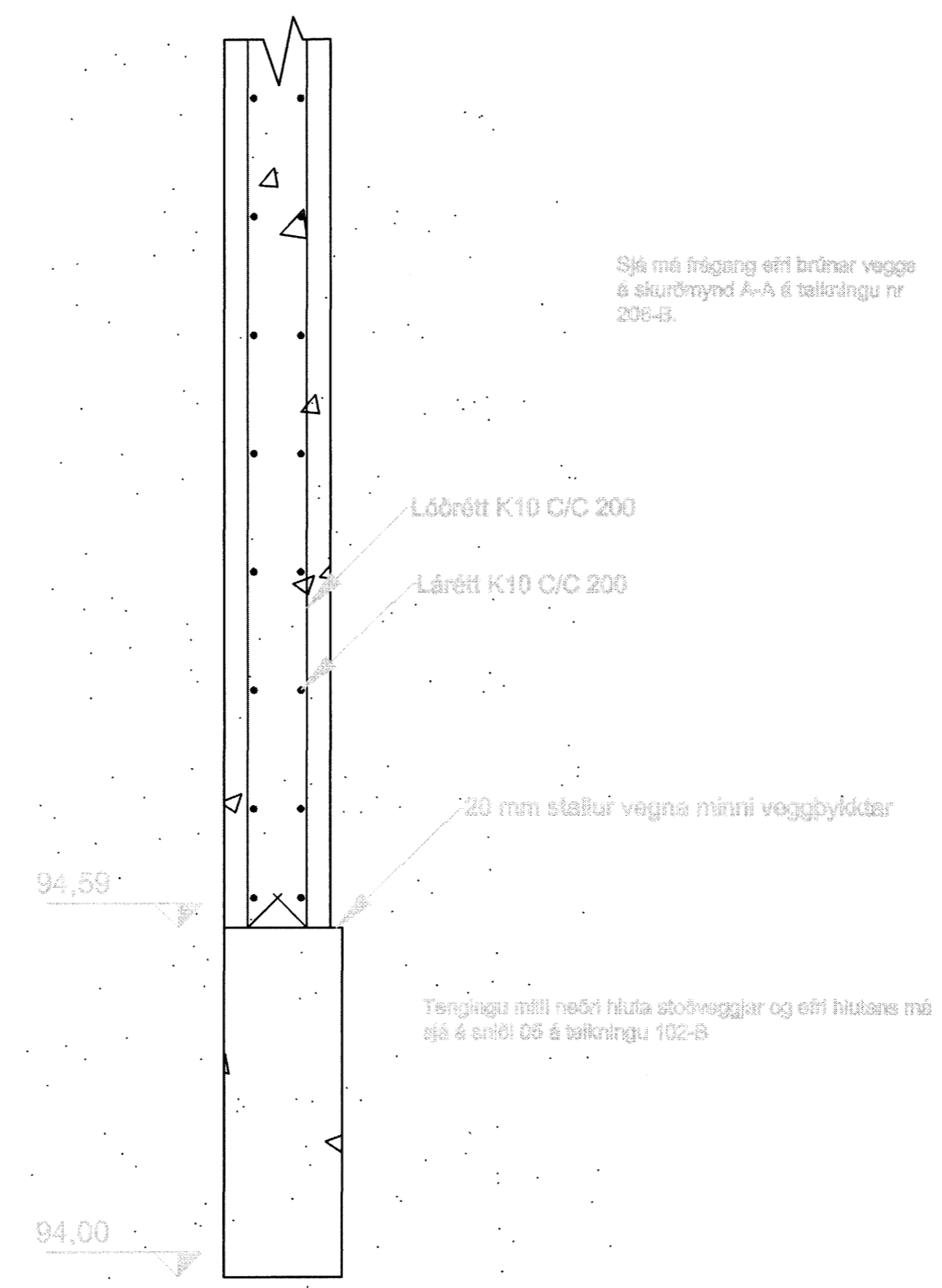

V15 Snið, Stoðveggur
206B 1:10

| | | | | |
|-------------------|--------------------|-------------|------------|-----------|
| Hannað | GÓ | Talnað | TG | Yfirleitt |
| Nafn hönnuðar | Guðmundur Ólafsson | | | |
| Kennitala: | 061254-3239 | Dagur: | 21.07.2010 | |
| Undirskrift: | <i>[Signature]</i> | | | |
| Skógarás 8 | | | | |
| Stoðveggir | | | | |
| Verkr. | S8 | Talning nr. | Úp. | |
| Frumsí. bl. | A1 | 206B | | |
| Málsvæði: | 1:10/50 | | | |