

Samþykkt þann
10 FEB 2009
 Byggingafráttirinn í Hálförðri
 Fh. Hrólfur S. Gunnlaugsson

Níels Indriðason
 N1 h.o. 181144-2948

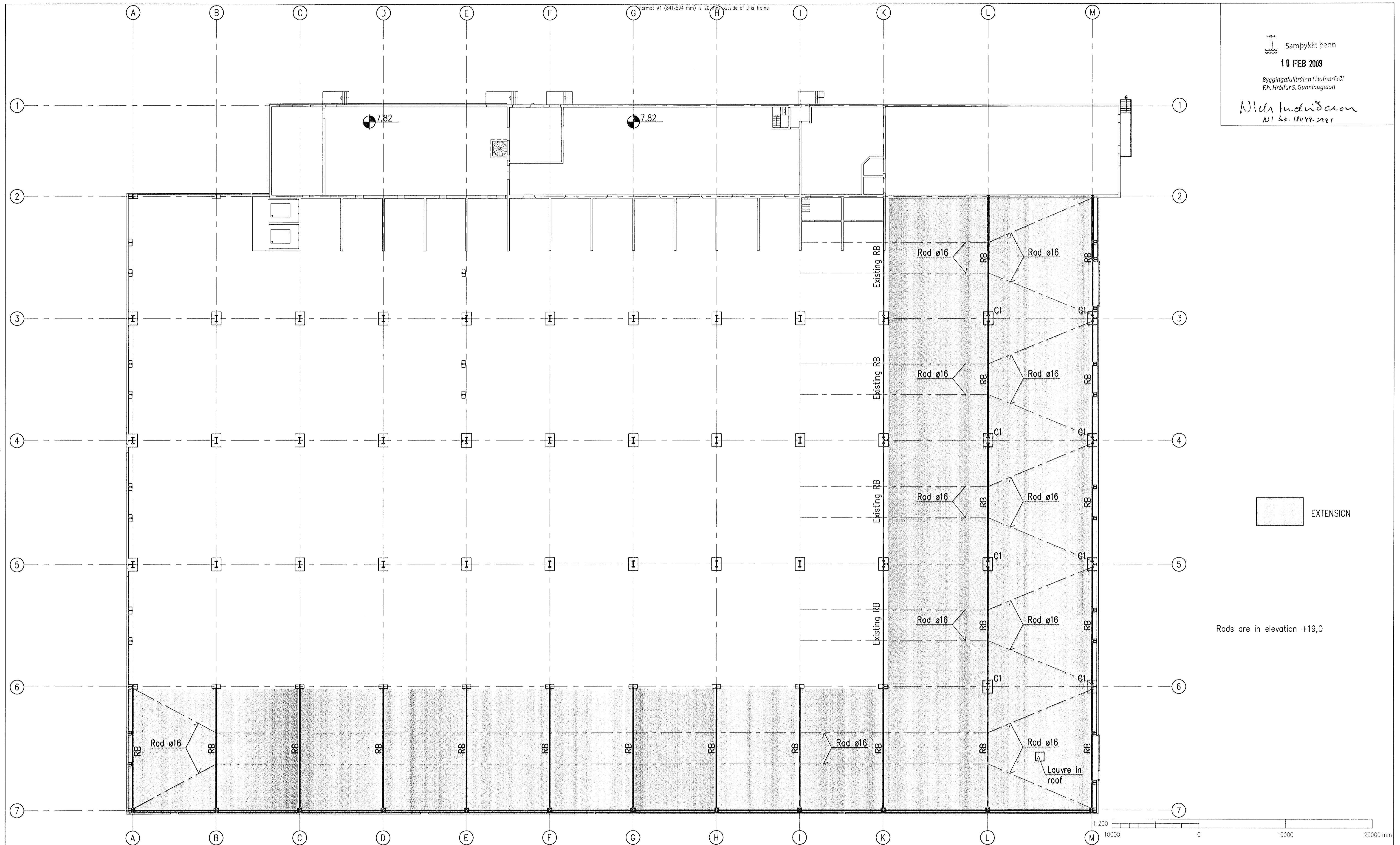

EXTENSION

Rods are in elevation +19,0

Skýringar:
 Explanations:

| | | | | |
|-------------|----------------------|--------------|------------------|-------------------------|
| 2 | Issued for use | 08.12.18 | | |
| 1 | Issued for tendering | 08.10.01 | OS | |
| Breyt. Rev. | Breyting / Revision | Dags. / Date | Samþ. / Approved | Notk. heiml. / Released |



This drawing is the property of the Rio Tinto Alcan Iceland Ltd and handed out for personal use only. It may neither be copied nor made available to others without permission of the Rio Tinto Alcan Iceland Ltd. The receiver is liable for any misuse.

| | | | | | | |
|---|-----------------|----------------|---|------------------------------------|-------------------------------|------------------------|
| Fjöldi stykja / Number of pieces | Hlutur / Object | Alnúmer / Item | Efni / Material | eo.stk / Weight | total t. heild / Total weight | Athugasemdir / Remarks |
| IV | III | II | I | | | |
| IDP 410 - SUBSTATION 220 kV SWITCHYARD BLD. STRUCTURAL STEEL ROOF BEAM LOWERGIRT BRACING | | | | | | |
| Formát / Format: A1 Skala / Scale: 1:200 | | | Kostnaður - búnaður / Cost - Equipment: 4011 AKS númer / AKS no.: | | | |
| Verktaki / Supplier: HRV | | | Tækniráðgjafi / Draughtsman: IDP-410-ZA-000-062 2 | | | |
| Tæknidrátt / Drawn: HS/LDB | | 2008.10.01 | | Yfirforðgjafi / Checked: NI | | Samþykkt / Approved: |
| RioTinto Alcan | | | ISAL Alcan Iceland Ltd 19-222 Hálförður | | | |
| Tæknidrátt / Drawn: | | | Vafarð og skrifað / Checked and signed: | | Töluheimlið / Released: | |