

CROSS SECTION SCHEDULE (MONOSLOPE)					
BOLT SCHEDULE				FLANGE BRACE	
CONN	QTY	SIZE	LENGTH	MARK	PART MARK
(B1)	4	M20	80	(P2)	07-4501
(B2)	4	M20	80	(P3)	07-4501
(K1)	4	M24	90	(P4)	07-4501
(K2)	4	M20	80	(P6)	07-4501

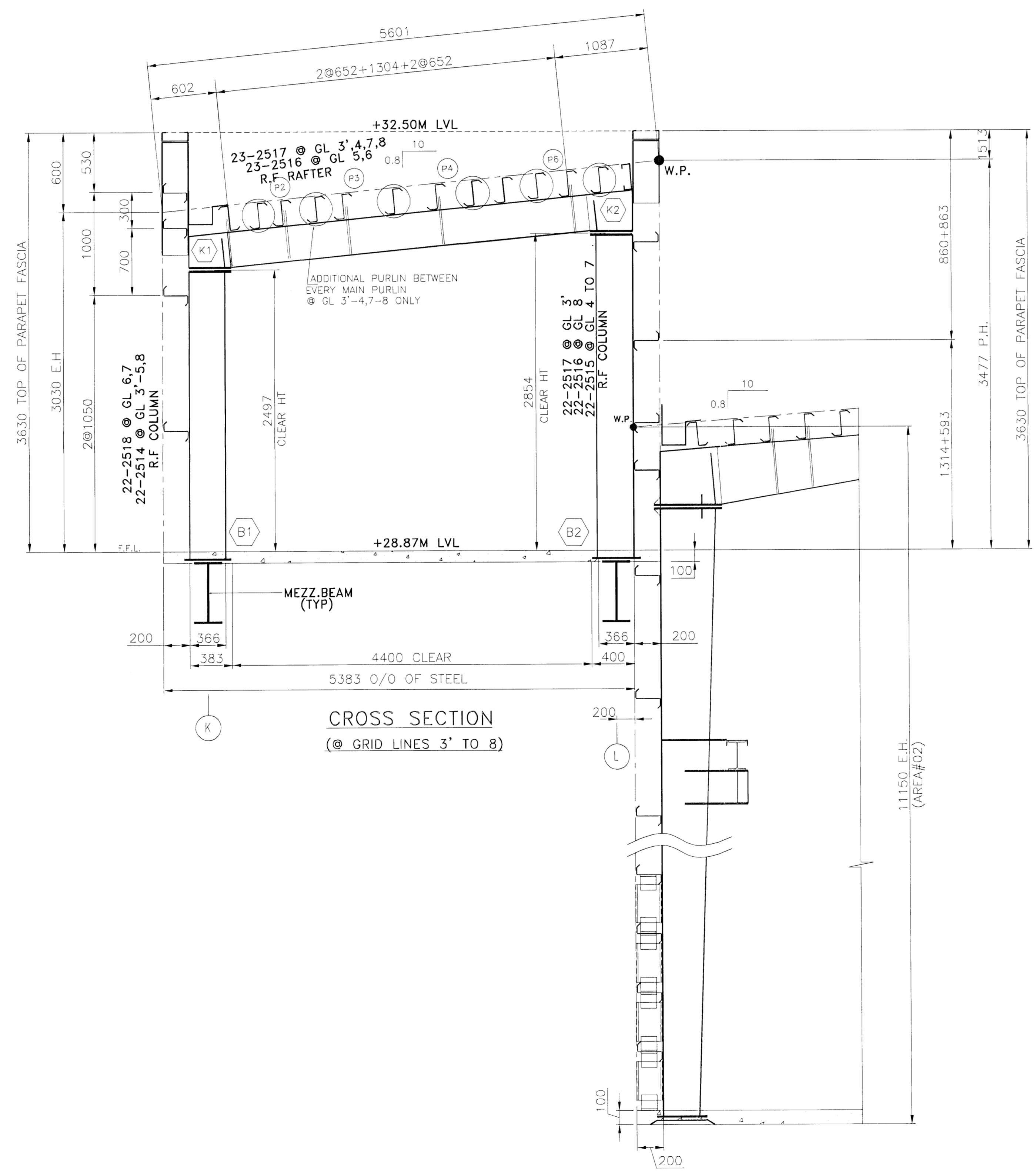

IMPORTANT NOTES

- 1 - High strength bolts (HSB) are galvanized while mild steel bolts (MSB) are electro plated (yellow chromate conversion). These bolts are marked on the heads so that they can be easily identified.
- 2 - The correct type of bolts must be used as called for on the details. Using wrong type of bolts may cause building failure at the erector's responsibility.
- 3 - Continuous machine submerged arc weldings (S.A.W.) meet the applicable requirements of the American Welding Society (A.W.S.) D1.1-2004.
- 4 - Web-to-flange welds are single side fillet welds in accordance with the ninth edition of the AISC Table J2.4 Page 5-67 unless noted otherwise.
- 5 - Web-butt welds are complete penetration using flux back-up (16mm plate max.)
- 6 - Flange butt welds are on both sides with copper back-up. Flanges 19mm or thicker are beveled prior to assembly.
- 7 - Gusset plates for flange braces are welded on both sides of the column and rafter, however flange braces are required at one side (unless noted otherwise). For aesthetic reasons, it is preferable to install them all at the same side of column and rafter. The side chosen depending on erection sequence.

Sampykkt þann
24 JUNI 2008
Byggingarfulltrúinn í Hafnafirni
F.h. Hrólfur S. Gunnlaugsson

ASK
26. maí 2008
Verkfæðistofa
Sigurðar Thoroddsen hf.
F.h. VST hf., Hjörtur Hansson 1509464929

NO.	DATE	DESCRIPTION	DRN	CHK	DSN
2	20.03.2008	ISSUED FOR CONSTRUCTION	NSK	TPS	IPC
1	24.11.2007	RE-ISSUED FOR APPROVAL	MGK	VRA	IPC
0	25.10.2007	ISSUED FOR APPROVAL	KRT	VRA	IPC

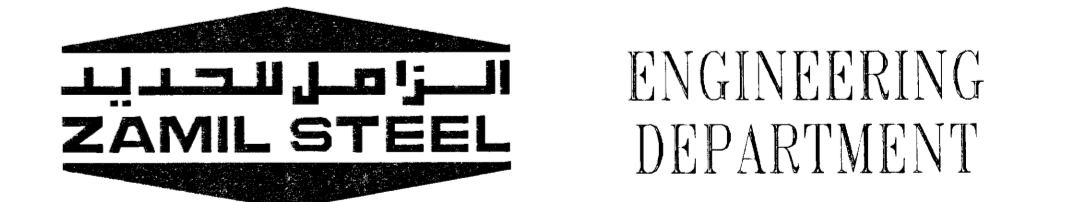

ZS JOB NO. : V7-D567 BUILDING NO.: 01
PROJECT NAME : HEDINN HOUSE
CUSTOMER : HEDINN
JOBSITE LOCATION : HAFNAFIRDI, ICELAND
DRAWING TITLE : CROSS SECTION DRAWING NO. : E13