

REYK- OG SPÓNAÚTSOG

SNID A-A

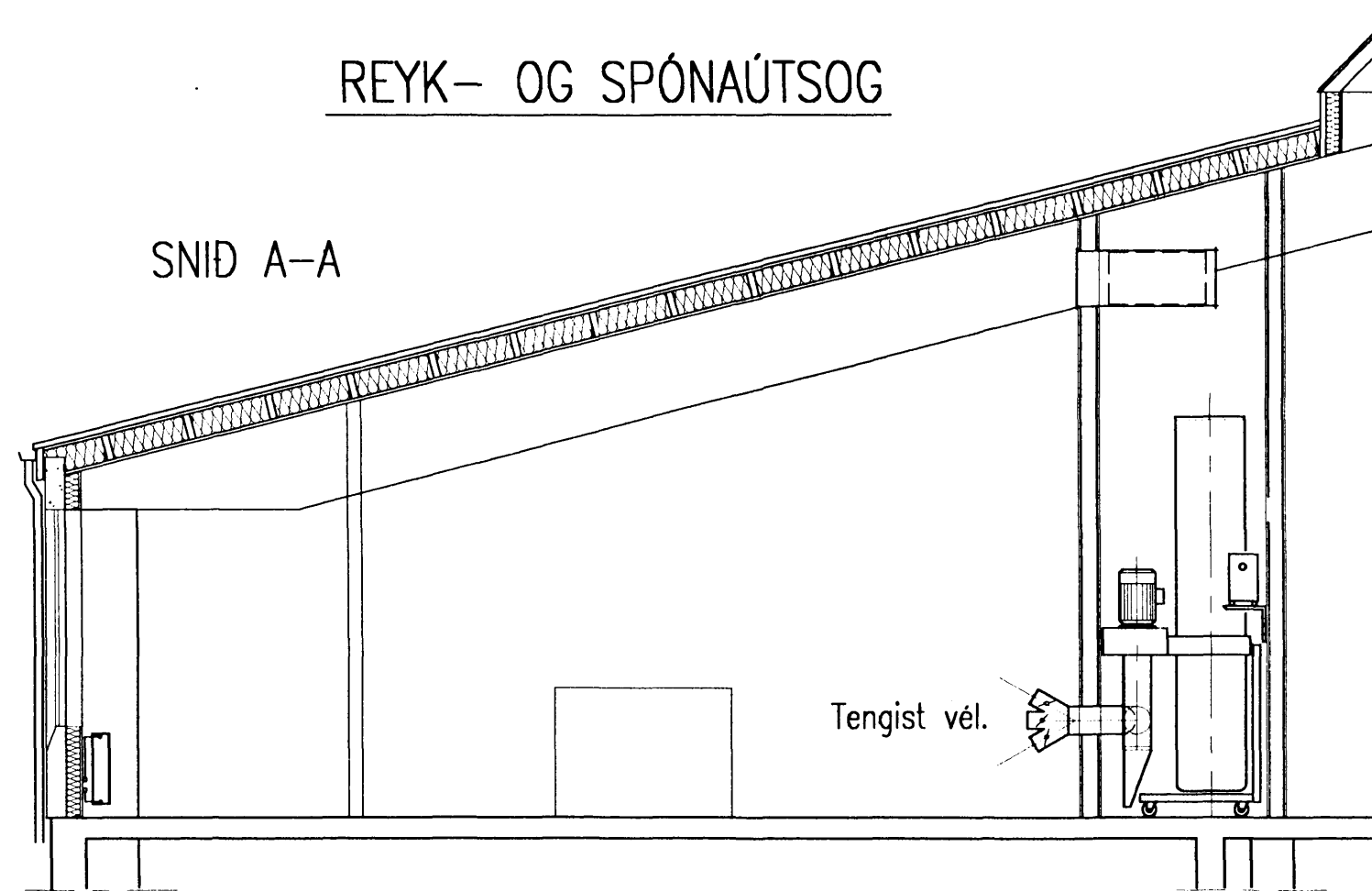

Tengist vél.

SNID B-B

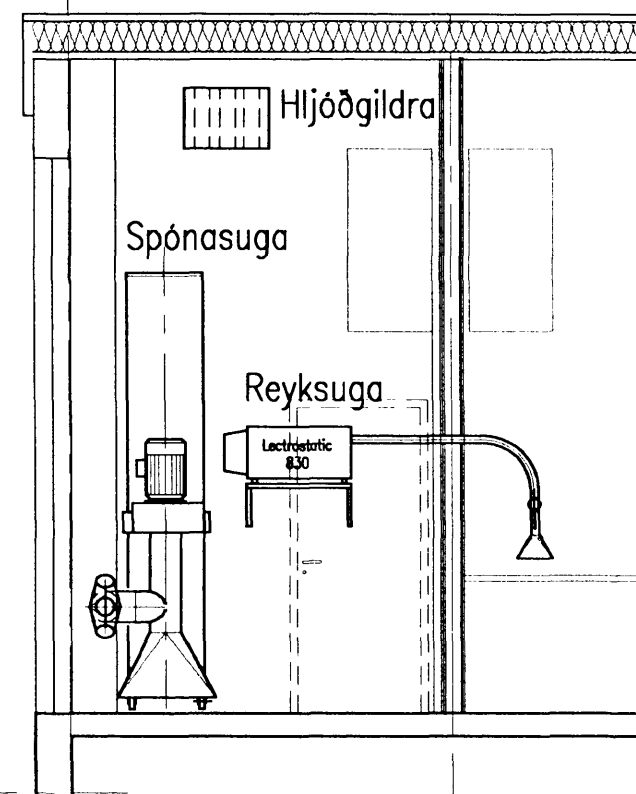

Hljóðgildra

Spónasuga

Reyksuga

Spónaútsog er CORAL CMS/1C sem afkastar 1800 m<sup>3</sup>/h. Pokasía og spónapoki. Þrír 120 mm stútar með lokum. Hljóðstig 78 dB(A).

Reykútgöng er LECTROSTATIC Fume eliminator 830 sem afkastar 163 m<sup>3</sup>/h og er með 99.7% síu. Hljóðstig er 75 dB(A).

Hljóðgildra 500x400x900 með  $l_a=35$  dB.

ÚTSOG FRÁ LEIRBRENNSLUOFNI

SNID C-C

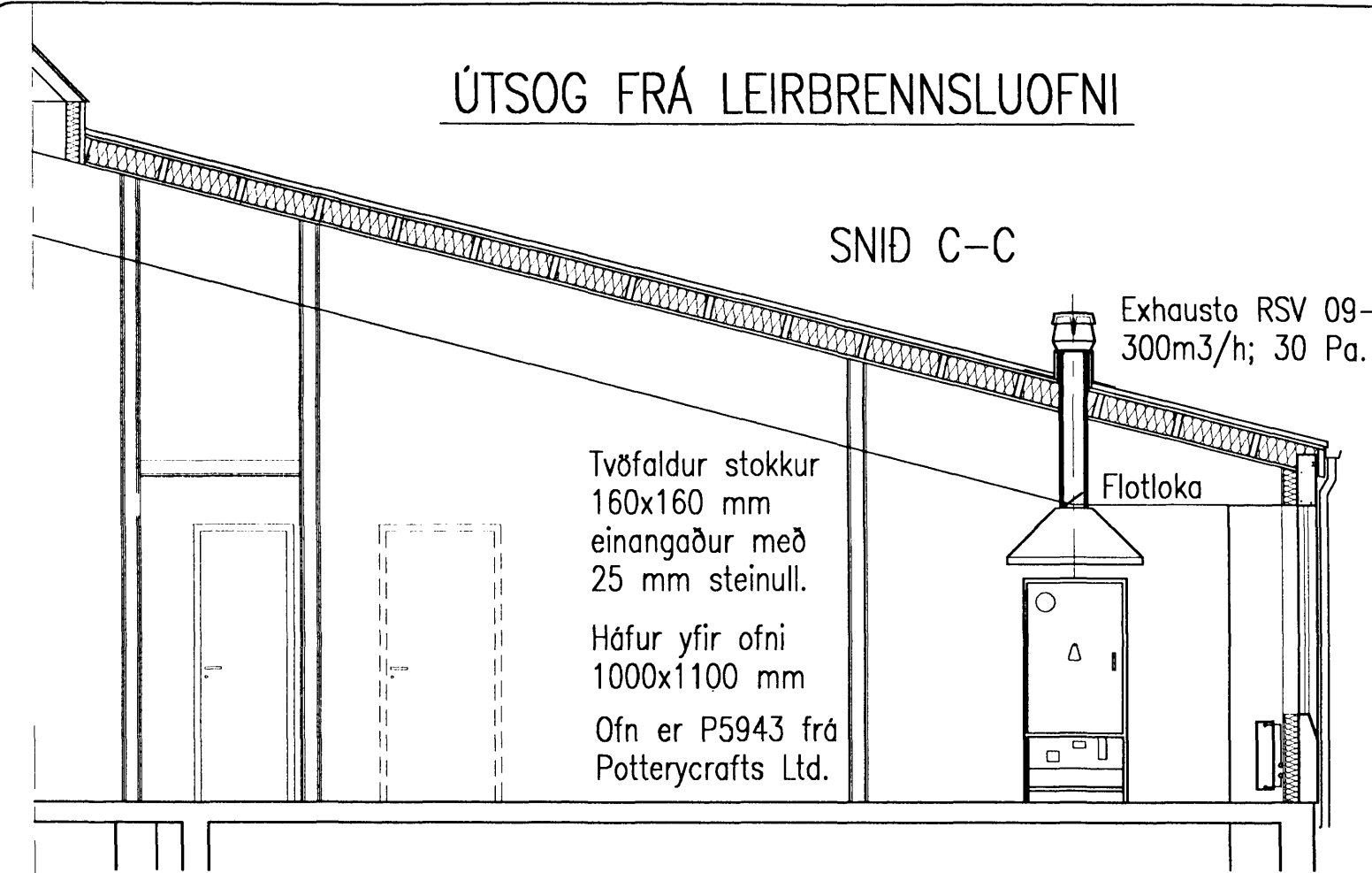

Exhausto RSV 09-4  
300m<sup>3</sup>/h; 30 Pa.

Flotloka

Tvöfaldur stokkur  
160x160 mm  
einangaður með  
25 mm steinull.

Háfur yfir ofni  
1000x1100 mm  
Ofn er P5943 frá  
Potterycrafts Ltd.

GRUNNMYND

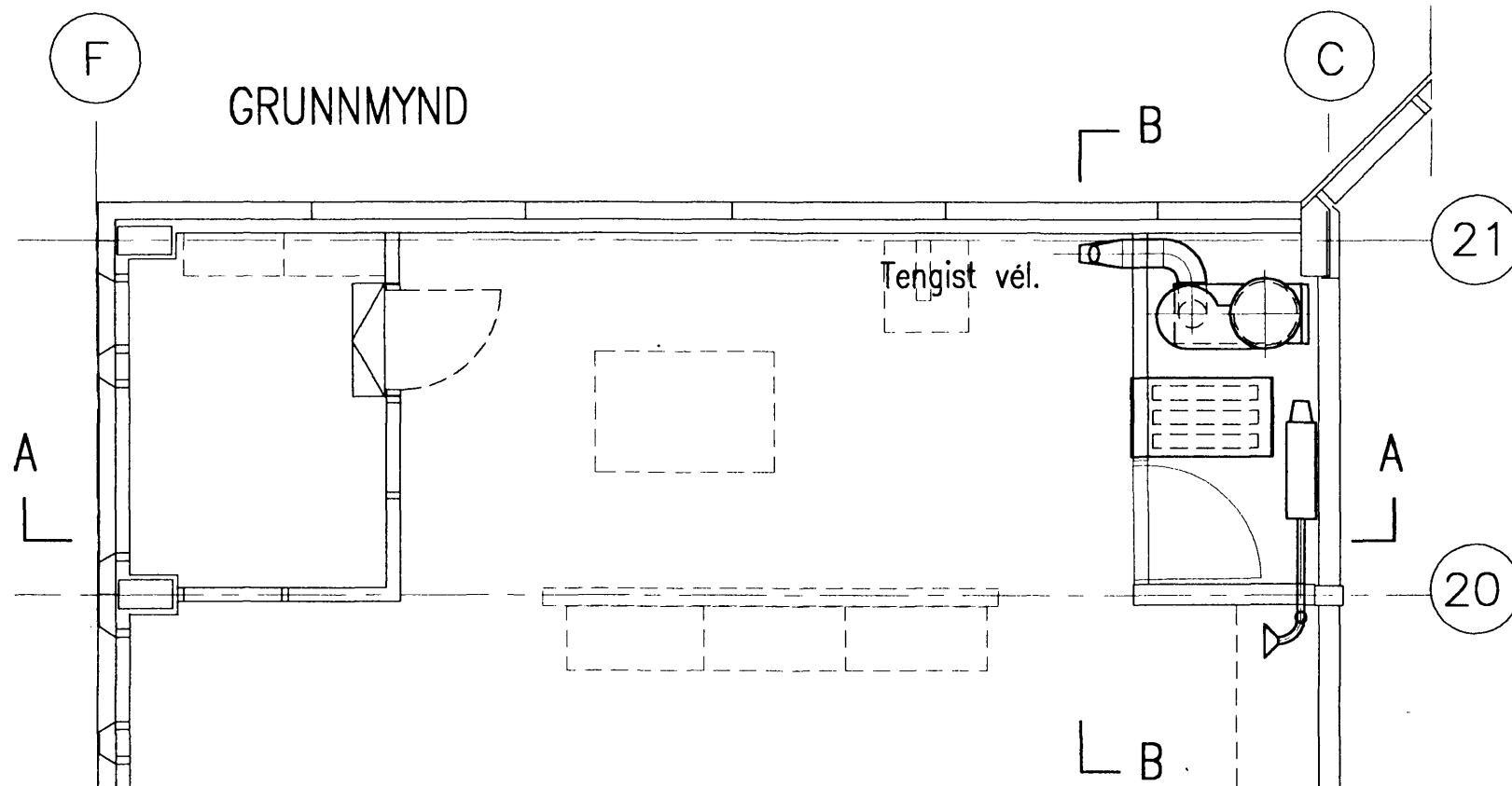

Tengist vél.

21

20

LAKKÚTSOG

SNID D-D

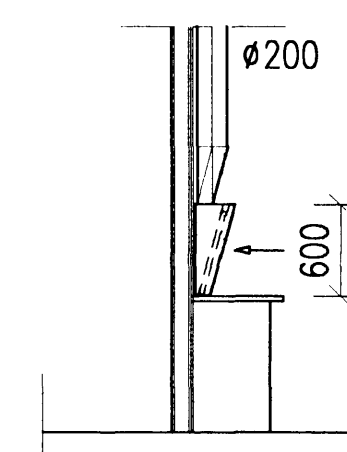

Kassi 1000x600 mm  
með Andrea-síu frá  
Iselco.  
Útsog um 700 m<sup>3</sup>/h.

GRUNNMYND

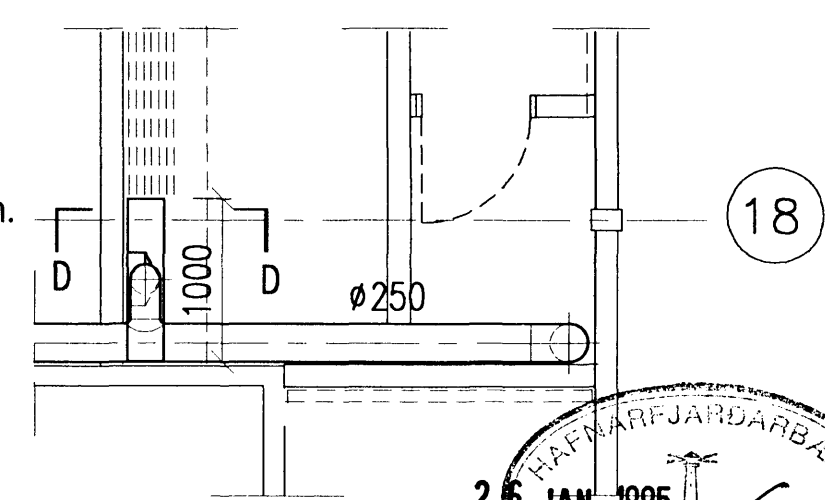

18

*Dampheld*  
14.06.94  
S.P.



26 JAN. 1995  
ÁSKRIFAÐI  
TEIKNINGA  
Sigtórunn Halldóttir

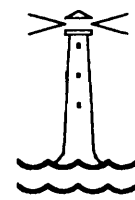
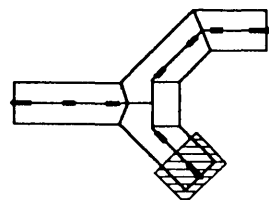
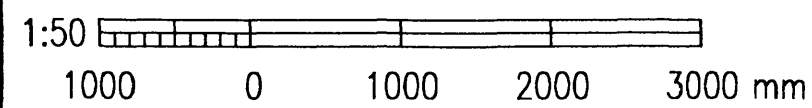

Teikn. nr.	Tilvisun á teikningu	Br.	Dags.	Eðli breytingar	Yf.	Sp.

**AJM-Lagnahönnun**  
Arnar J. Magnússon,  
Löngumyrri 26, 210 Garðabæ,  
s. 65 73 12 - fax. 65 73 12.

HVALEYRARSKÓLI, 2. ÁFANGI			
LAGNIR LOFTRÆSING REYK-, LAKK- OG SPÓNSOG Í SMÍÐASTOFU			
Dagsetning 08.06.1994	Verk nr. 94.01	Teikn. nr. 2.41	Melikvarði 1:50