

Sambýkt þann
23. feb. 2018
Byggingafróðgæmi í Akureyri

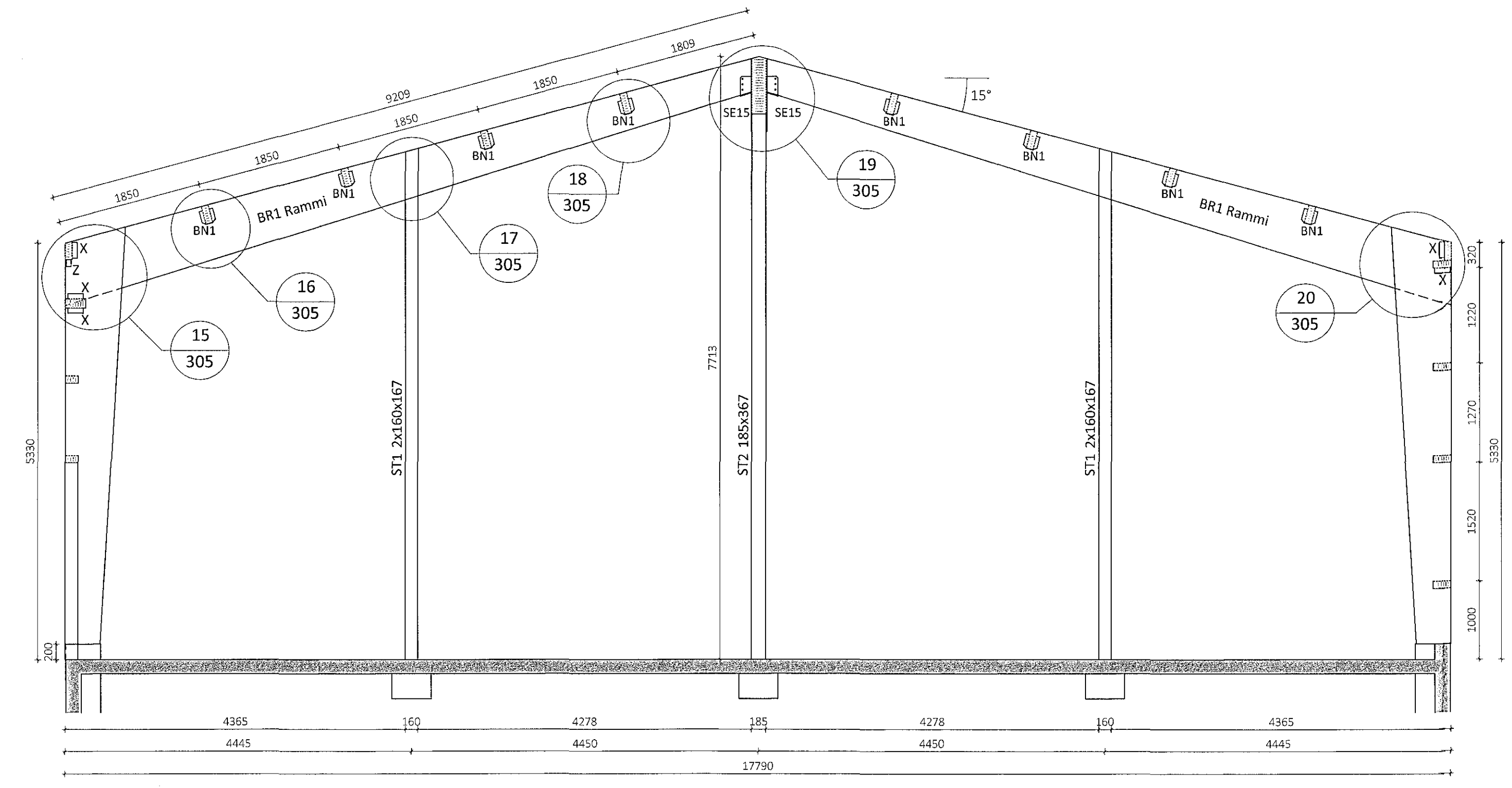

pversnið A-A Mkv. 1:50

Sérmynd 20 Mkv. 1:10

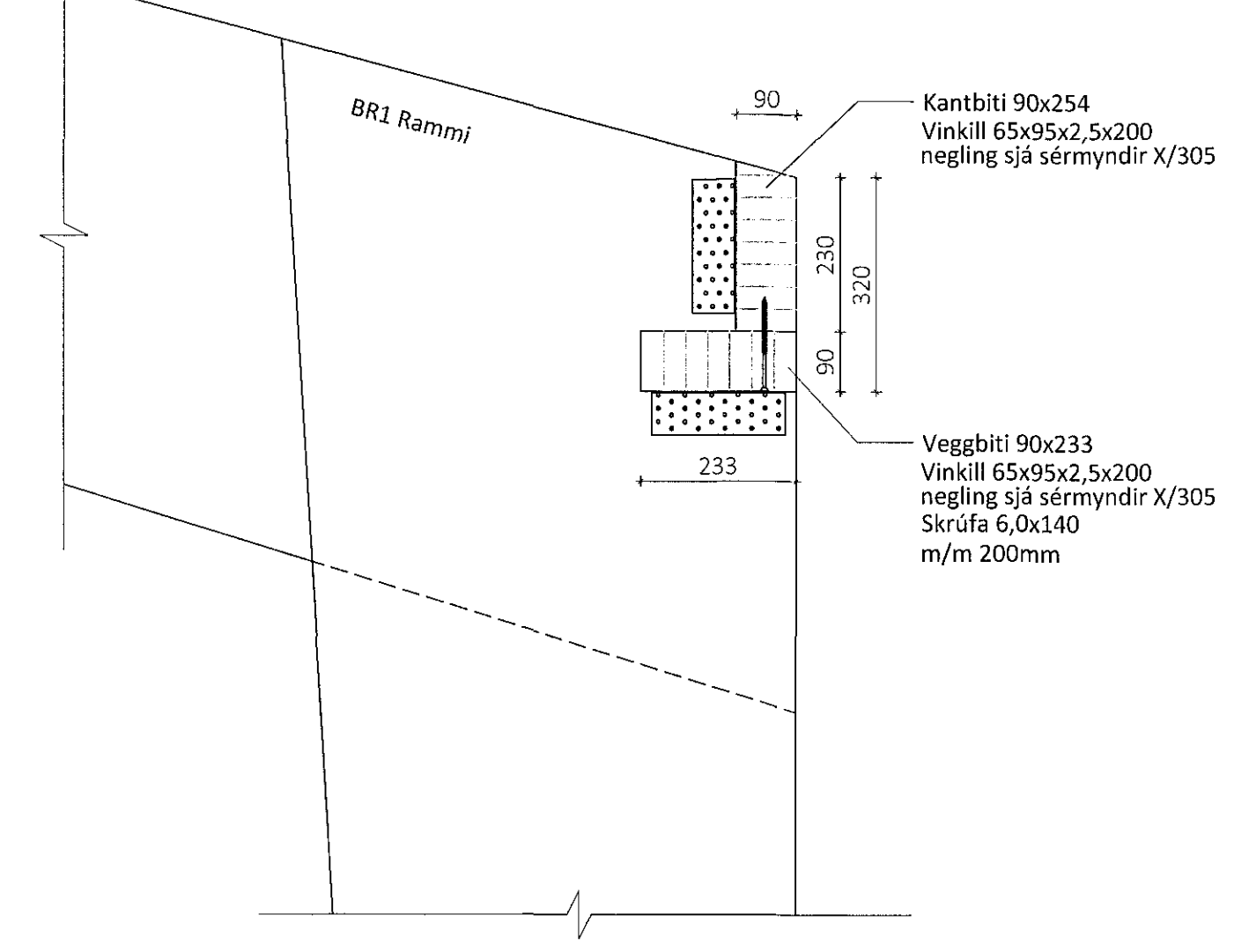

Teikningaskrá - arkitektateikningar					
Nr.	Heiti	Ábyrgðarráttur	Zeggelin arkitektar	Kvarði	Útgáfud.
1.1.1	Afstaðmynd	Byggingafróðgæmi	1:500	18.08.2017	
1.1.2	Grömming	Byggingafróðgæmi	1:100	18.08.2017	
1.1.3	Önnur	Byggingafróðgæmi	1:100	18.08.2017	

Sérmynd 19 Mkv. 1:10

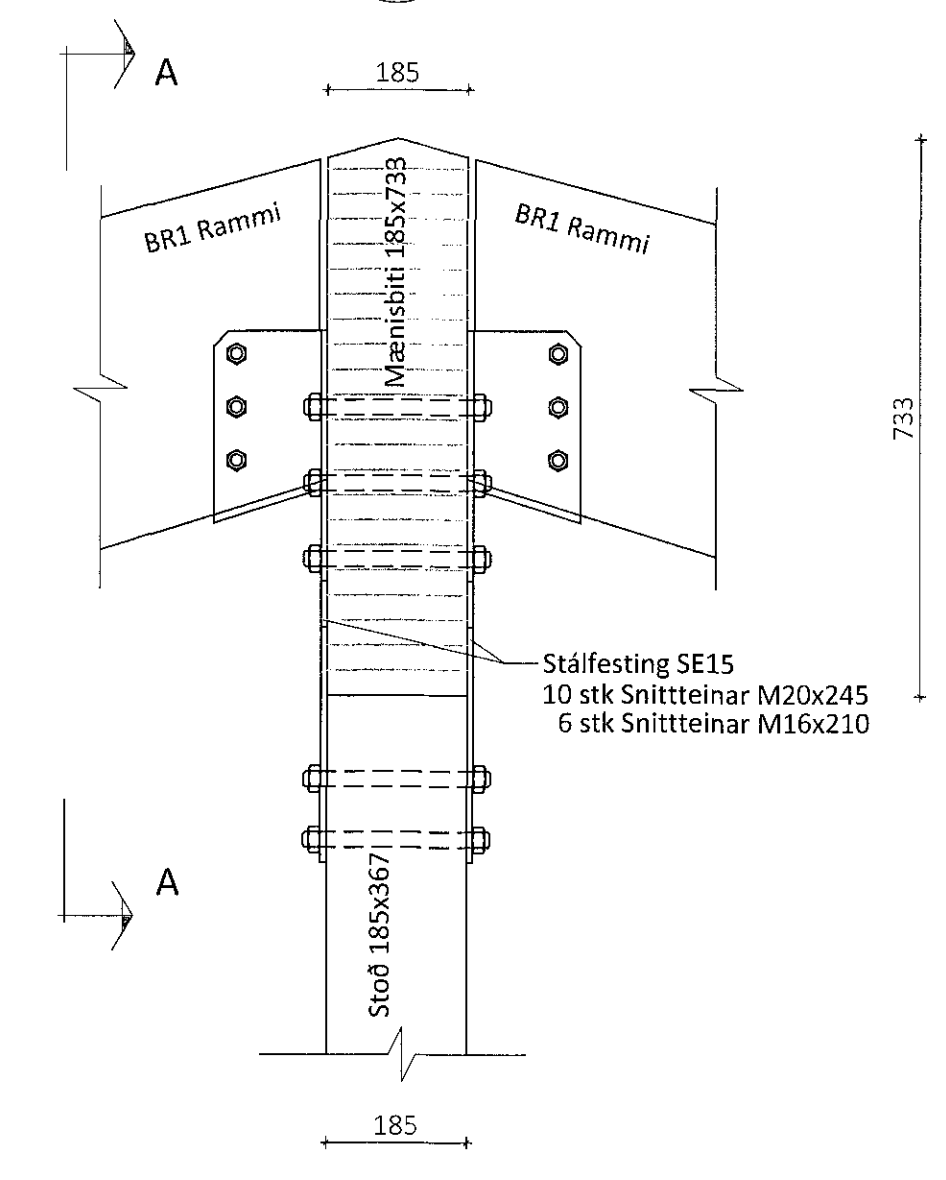

Snið A-A

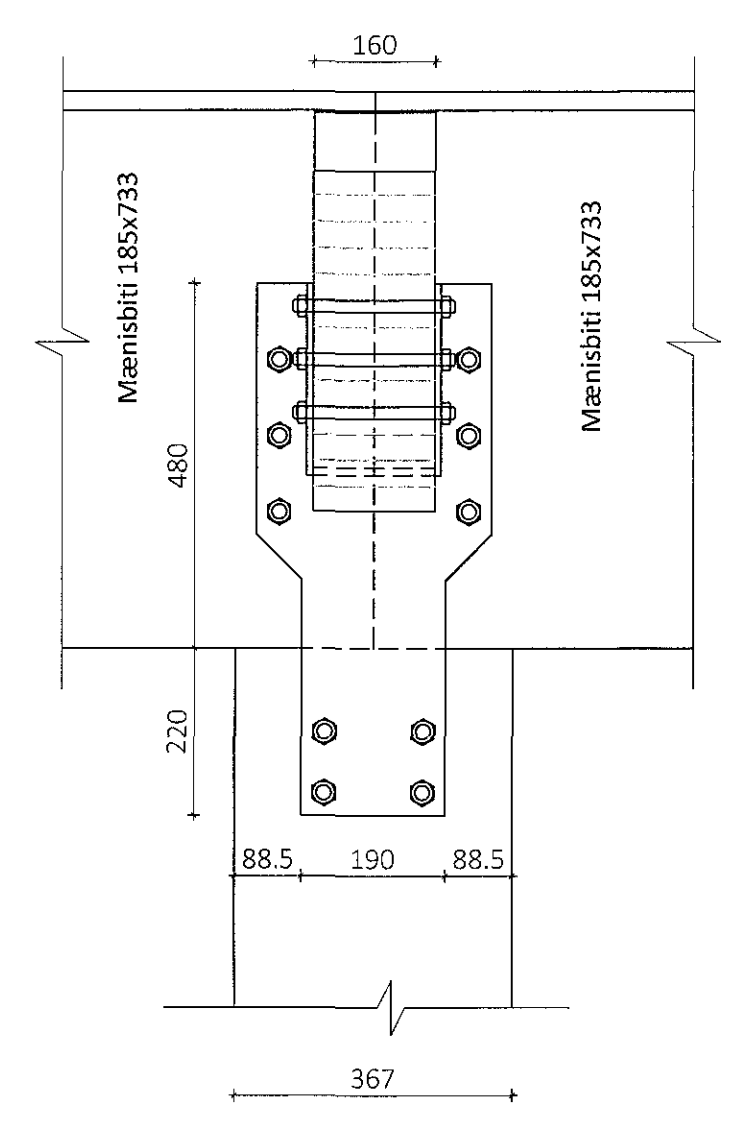

Sérmynd 18 Mkv. 1:10

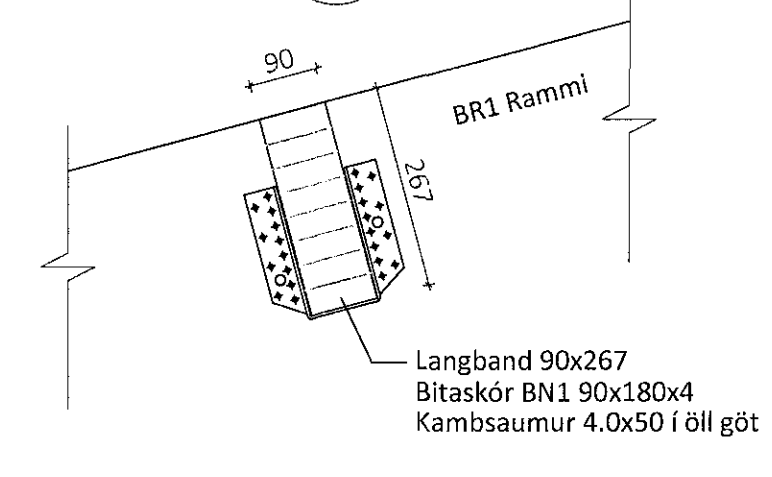

Sérmynd 17 Mkv. 1:10

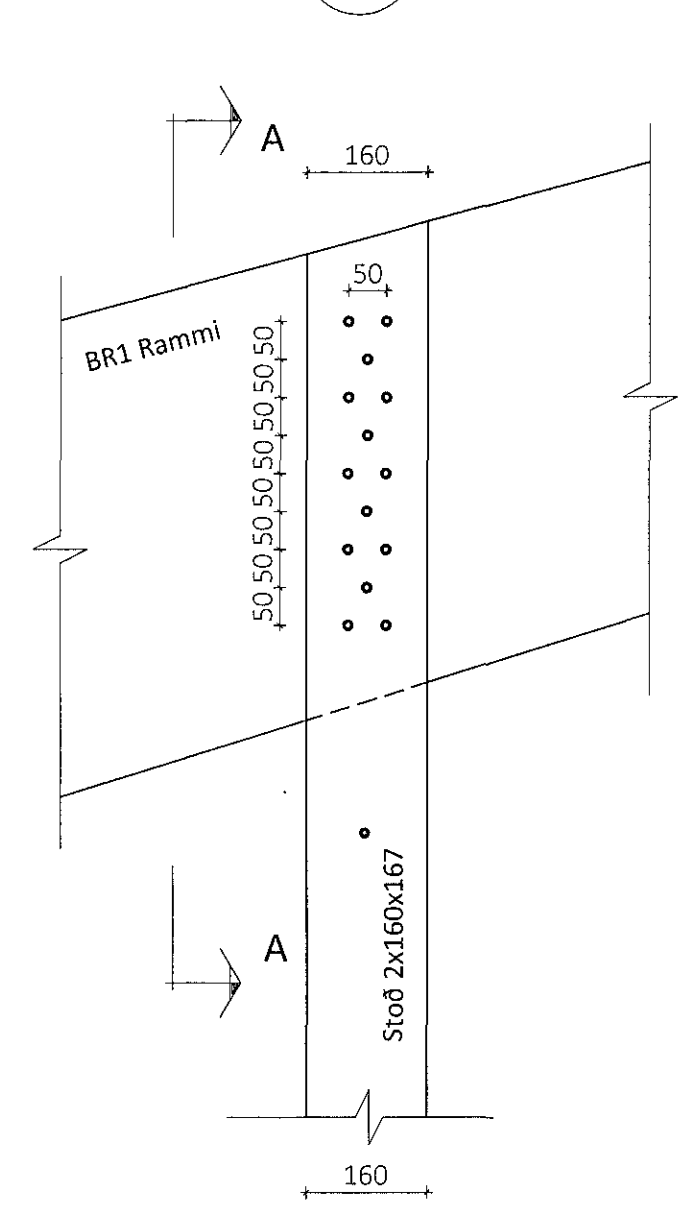

Sérmynd 16 Mkv. 1:10

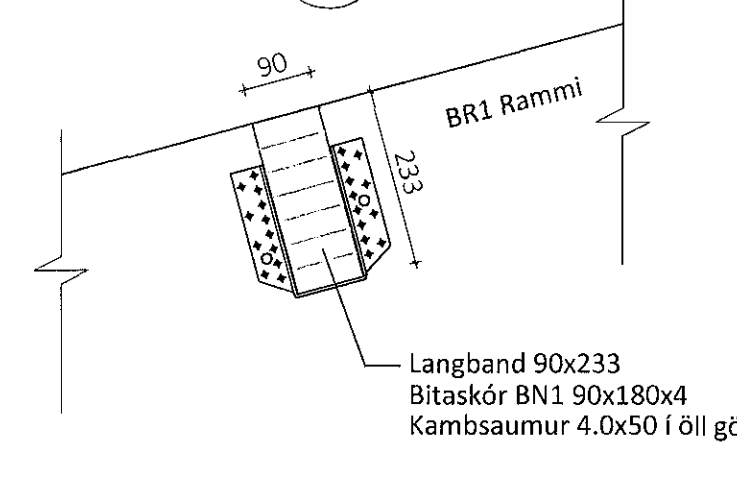

Sérmynd 15 Mkv. 1:10

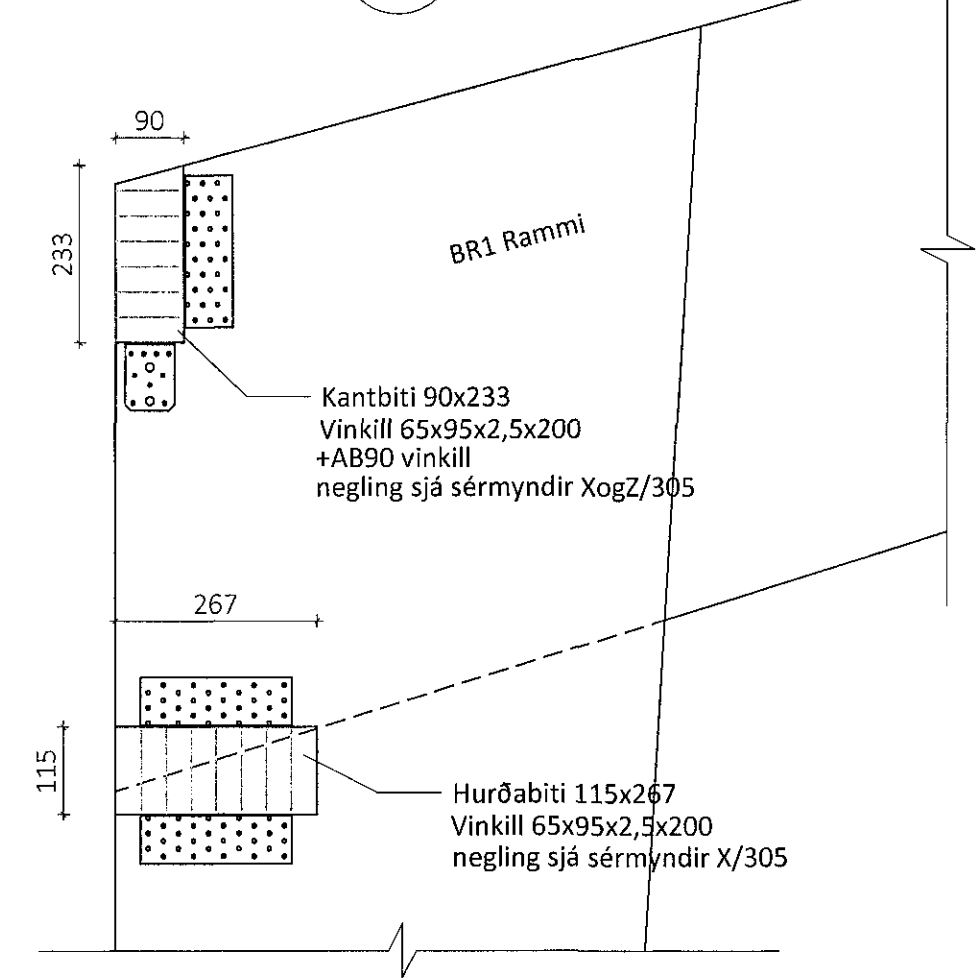

Snið A-A

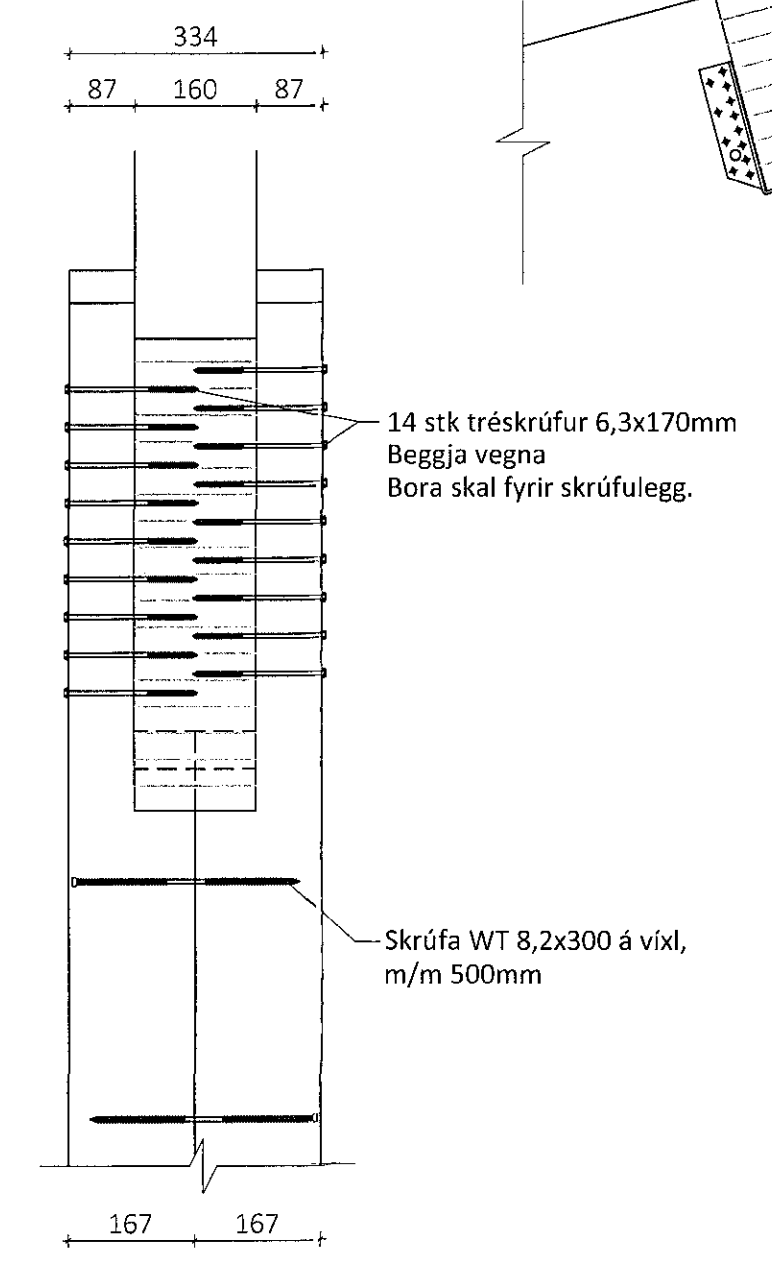

Y - BMF-65x95x2.5x160 vinklar

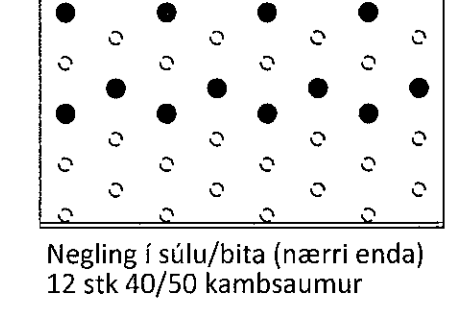

Negling í súlu/bita (nærri enda)
12 stk 40/50 kamsaumur

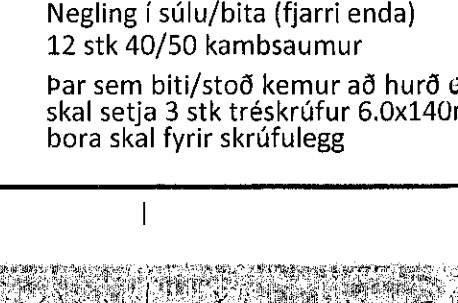

Negling í súlu/bita (fjarri enda)
12 stk 40/50 kamsaumur
þar sem bit/stoð kemur að hurð eða glugga skal setja 3 stk tréskrúfur 6.0x140mm bora skal fyrir skrufulegg

X - BMF-65x95x2.5x200 vinklar

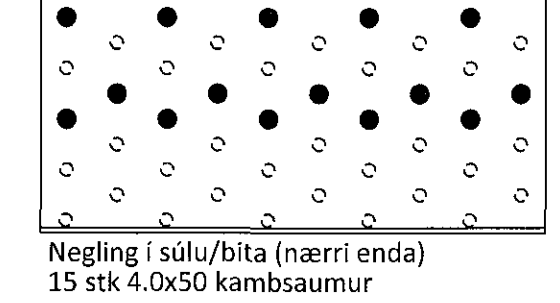

Negling í súlu/bita (nærri enda)
15 stk 4.0x50 kamsaumur

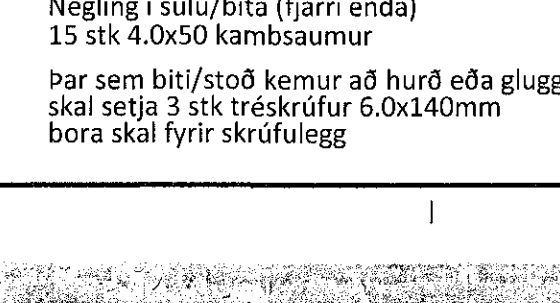

Negling í súlu/bita (fjarri enda)
15 stk 4.0x50 kamsaumur
þar sem bit/stoð kemur að hurð eða glugga skal setja 3 stk tréskrúfur 6.0x140mm bora skal fyrir skrufulegg

Z - AB90 vinklar

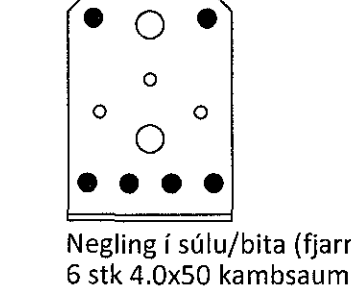

Negling í súlu/bita (fjarri enda)
6 stk 4.0x50 kamsaumur

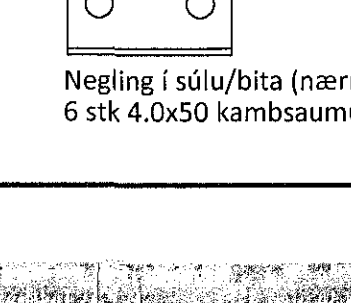

Negling í súlu/bita (nærri enda)
6 stk 4.0x50 kamsaumur

ÖLL AFNOT OG AFRITUN TEIKNINGAR AD HLUTA EDA Í HEILD ER HÁÐ SKRIFLEGU LEYFI LÍMTRÉ VÍRNET EHF.				
Númer	Dags.	Skýring breytingar	Br. af	
		MKV. 1:50, 1:10	DAGS. 12.2.2018	VERKNR. DL17 019
HEITI VERKS: Einhella 6, Hafnarfirði		TEIKN. KB	REIKN. KB	YFRF. YFRF.
HEITI TEIKNINGAR: Iðnaðarhús pversnið A-A og sérmyndir		NAFN HÖNNUNAR: Bjarni Ingibergsson Byggingatæknifræðingur B.Sc. kt. 030861-2729 - bjarni@limtrevirnet.is		ÚTGÁFA NR. 1 NA. TEIKNINGAR 305
HEITI HÖNNUNAR: Iðnaðarhús pversnið A-A og sérmyndir		DAGS. ÁRITUNAR: 12.2.2018		DAGS. ÁRITUNAR: