

Snid A-A.

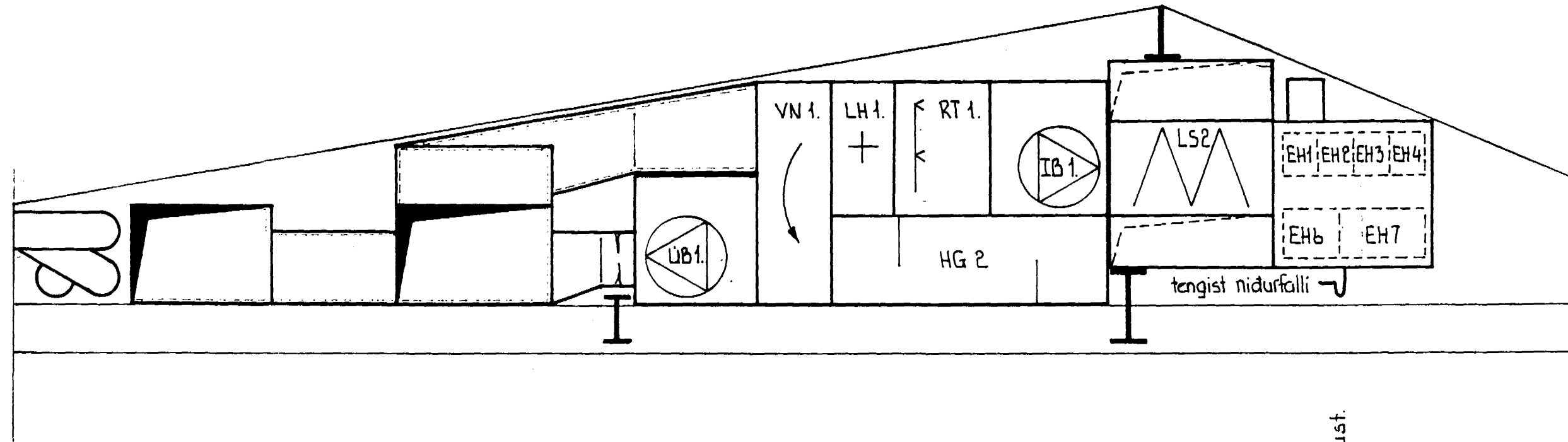

- IB1. Innblástursblásari 3.000 / 2.000 m³/t 2. hradar.
- UB1. Útblástursblásari 3.000 / 2.000 m³/t 2. hradar.
- VN1. Varmanytir 78% nýtni
- LH1. Lofthitari Lofthradi 2.5 m/sek 15 Kw.
- RT1. Rakataeki 60% metnun.
- LS1. Loftsia á inntaki EU7
- LS2. Loftsia á útkasti EU5
- HG1. Hljóðgyldra dempun 10 dbA.
- HG2. Hljóðgyldra dempun 10 dbA.
- EH1. Eftirhitari stofu 300 m³/t 1.5 Kw.
- EH2. Eftirhitari barnaherb. að góngustíg 250 m³/t 1.5 Kw.
- EH3. Eftirhitari barnaherb. horni 250 m³/t 1.5 Kw.
- EH4. Eftirhitari barnaherb. gótu 250 m³/t 1.5 Kw.
- EH5. Eftirhitari hjónaherb 250 m³/t 1.5 Kw.
- EH6. Eftirhitari gærdstofa 2 x 350 m³/t 4 Kw.
- EH7. Eftirhitari eldhús og holi 2 x 500 m³/t 6 Kw.

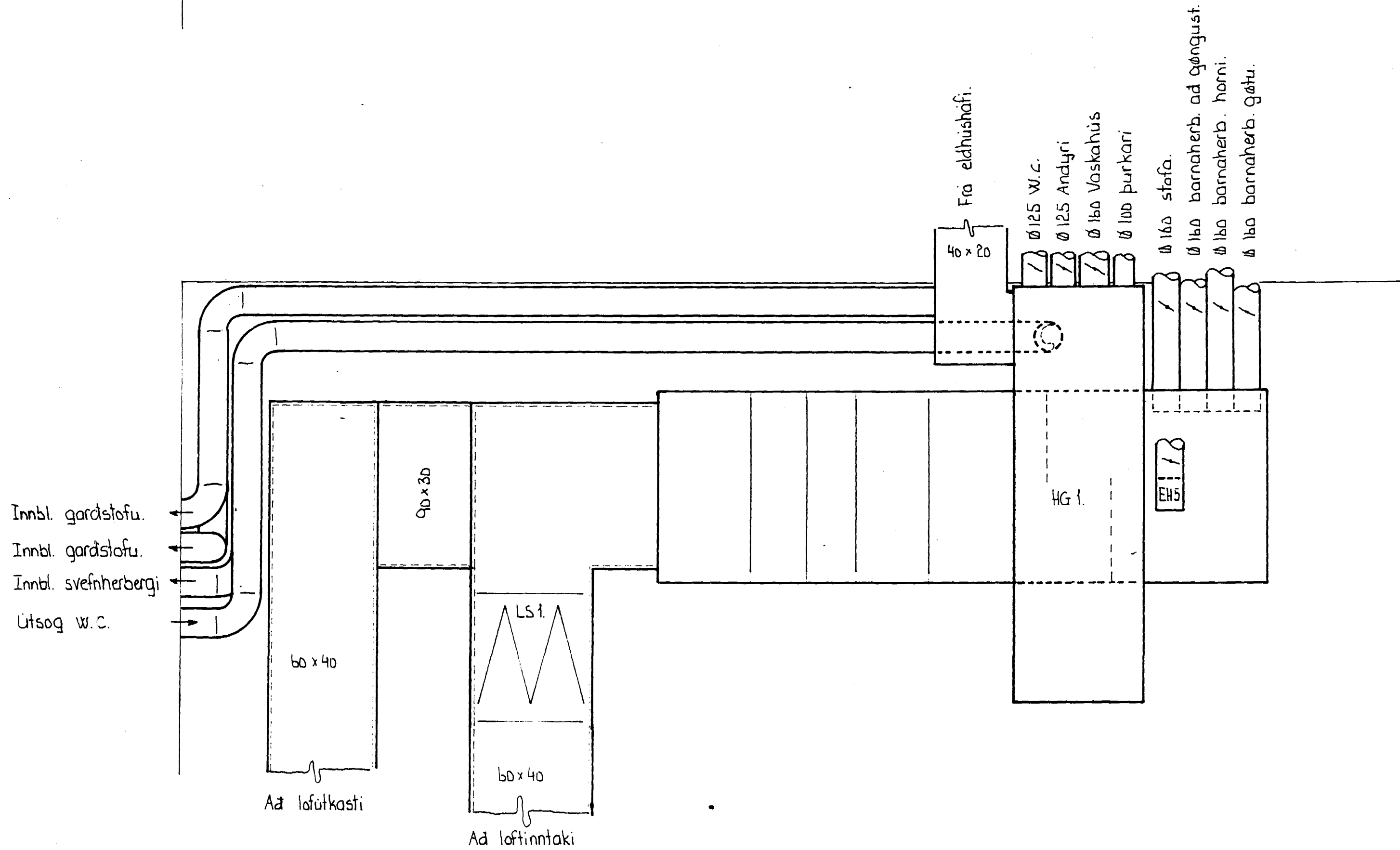

Tengimynd hitara.

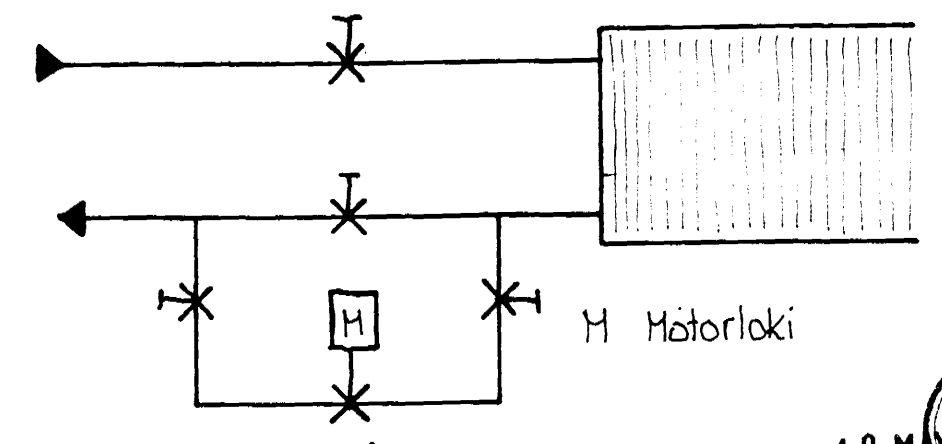

Tenaimund rakataekis.

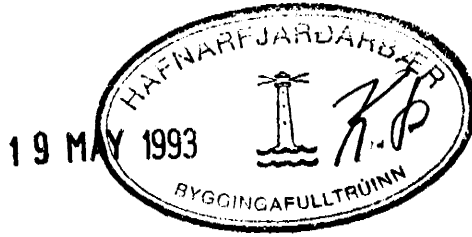
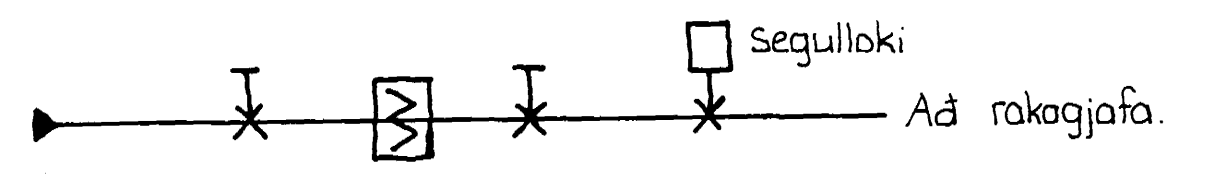

2. Birkiberg 12 Hafnarfirdi

Hitalagnir loftræsting M 1:20
Snid og tengimyndir dags. maí 93.

VARI ROSENKJÆR FTFJ.
Hönnun: Karl Rosenkjær FTFJ
Greenukinn 28 s. 654819.