

LAGNIR I GRUNNI

Frárennsli frá hitaveitu skal vera úr P.E.H (Polyethylen).
 Aðrar lagnir í grunnu skulu vera úr P.V.C (Polyvinylclorid).
 Allar lagnir í grunnu séu \varnothing 100 mm.
 Allar lagnir skulu lagðar í vél þjappaðan sand og huldar með minnst 15 cm sandlagi.
 Allar lagnir í grunnu skal leggja með minnst 20% halla. Mesti halli 300%.
 Efni og vinna skal vera í samræmi við gildandi reglugerðir og staðla um frárennslislagnir.

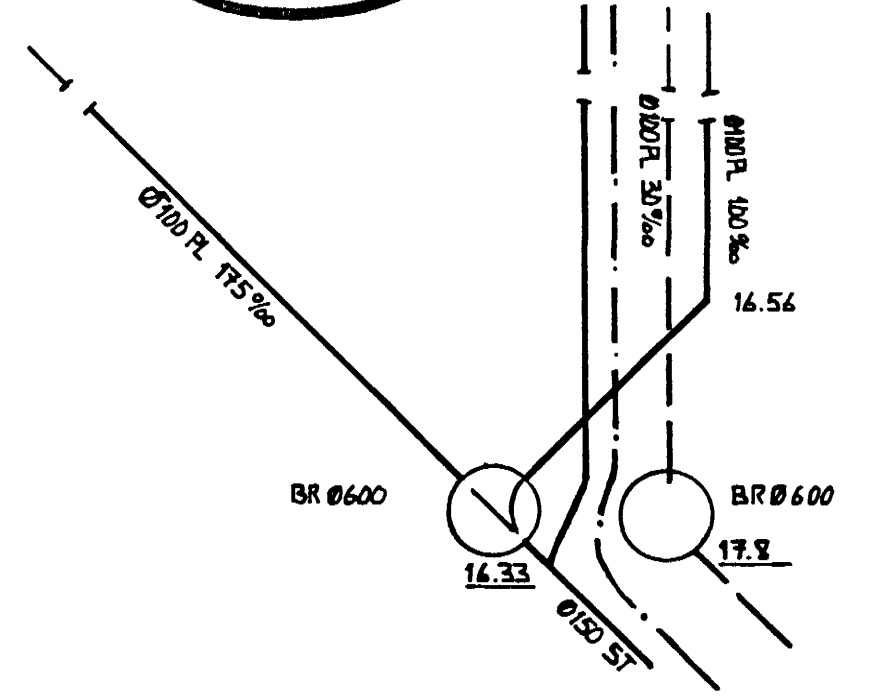
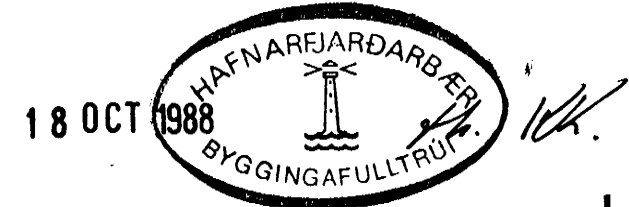
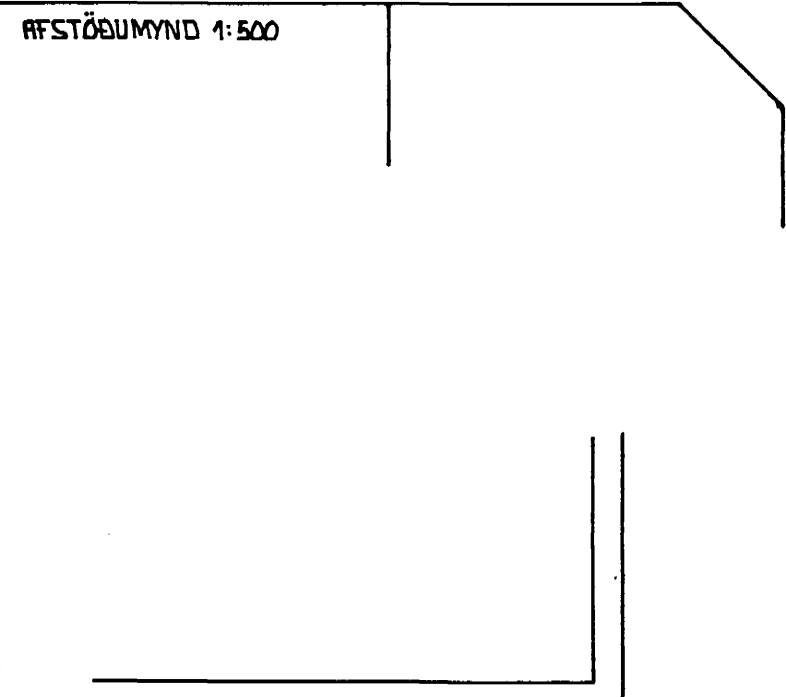
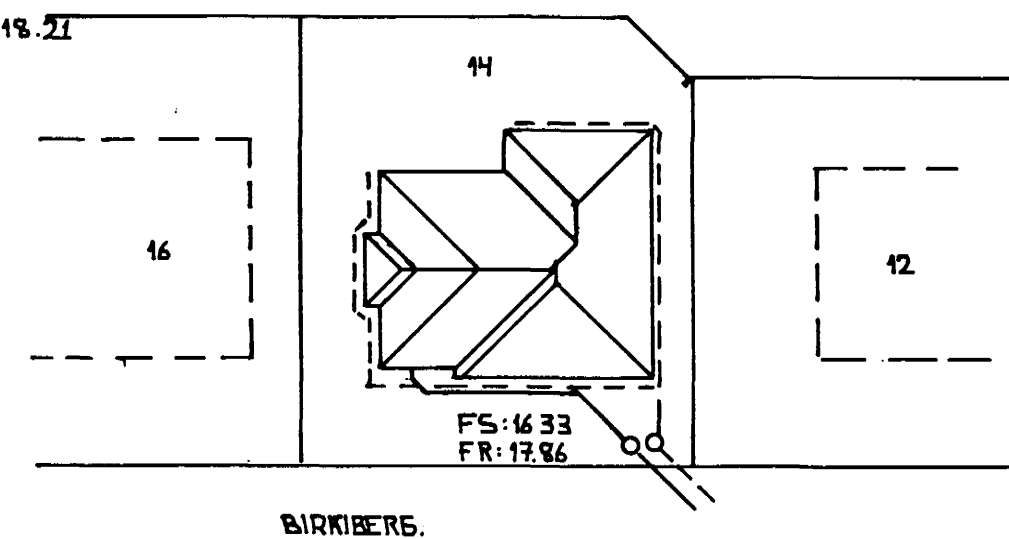
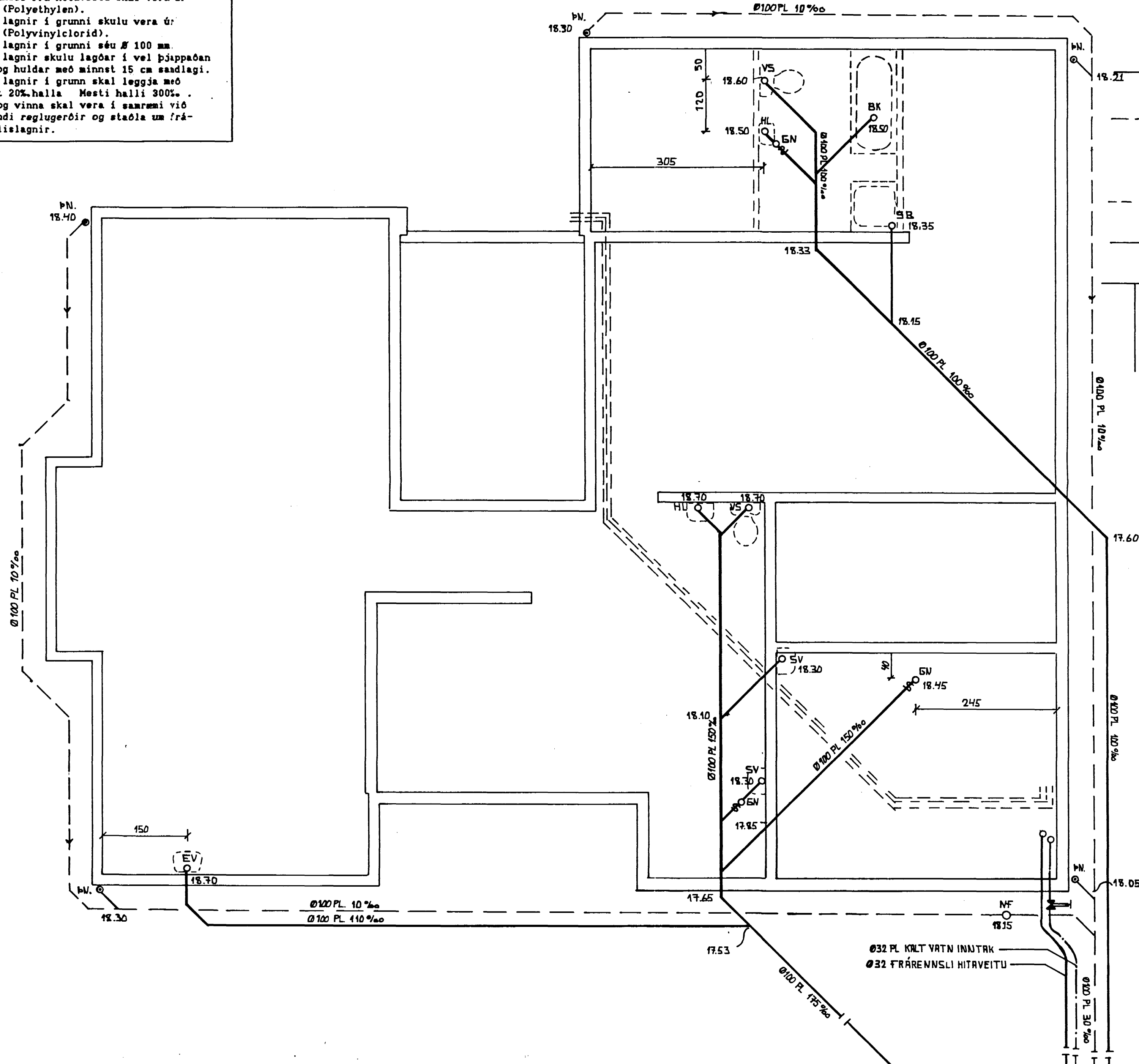

Eyjólfur Valgarðsson
 Byggingateknifreðingur

BIRKIBERG 14	DRÆS. OKT '88
Frárennslislagnir	MKV: 1:50
	REIKN: EV
	TEIKN: EV

Eyjólfur Valgarðsson