

NÚVERANDI AFSTÖÐUMYND 1:500

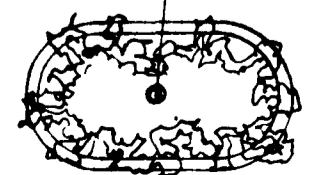

GRUNNMYND 1:100 AF STEYPTUM BLÓMAKASS UTANUM LJÓSASTAURA. HÆÐ Á KASSA 60 cm.

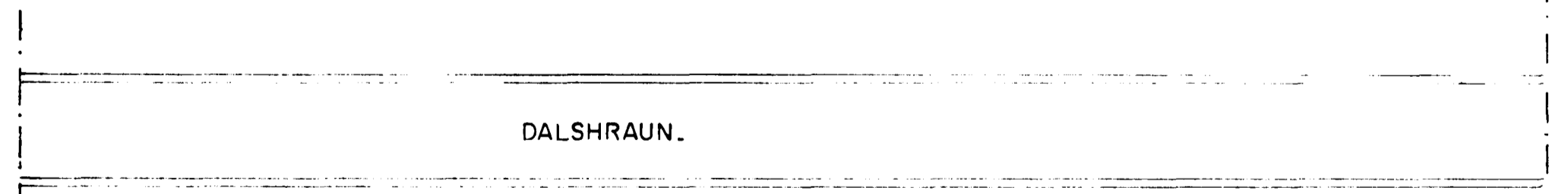
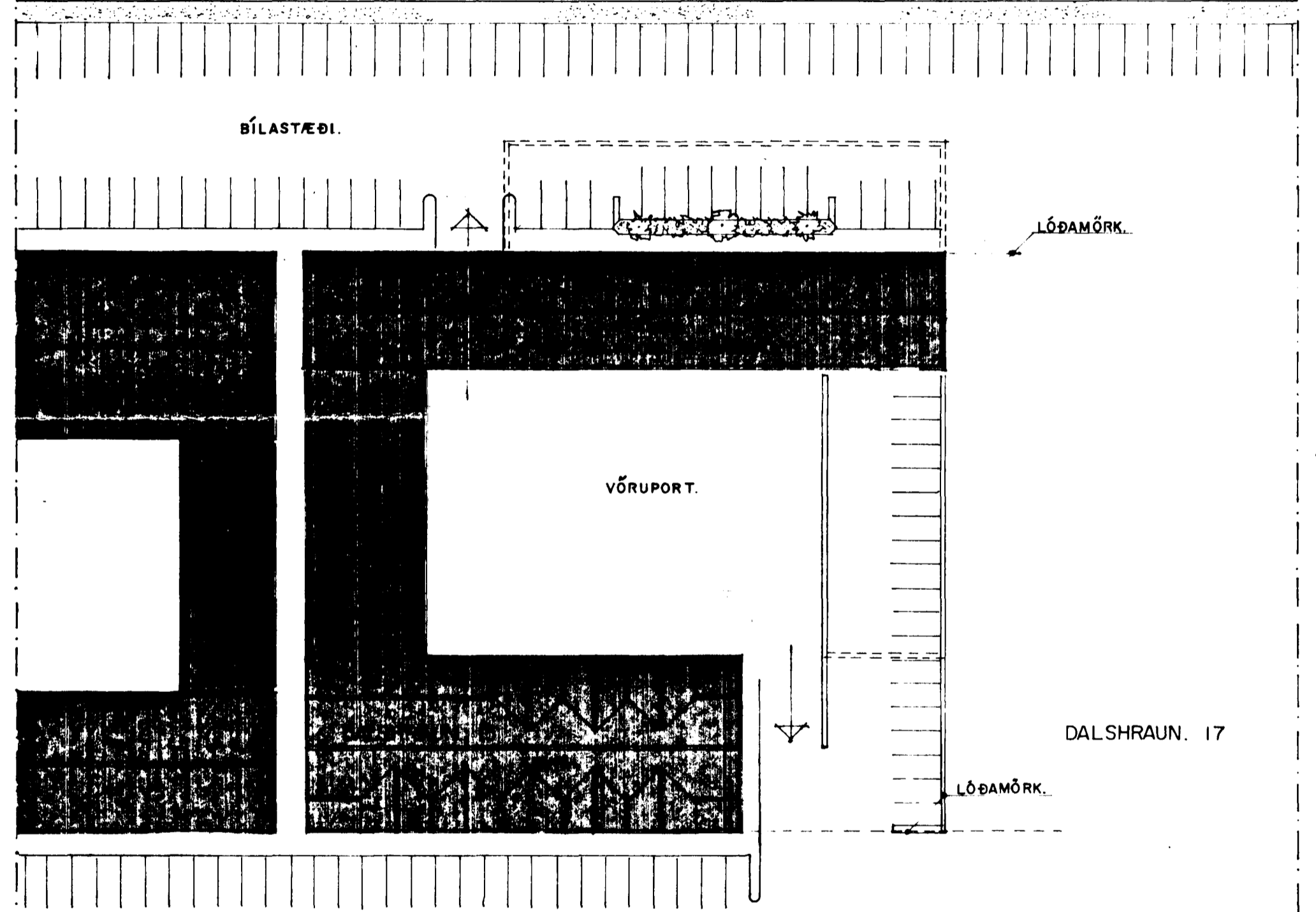
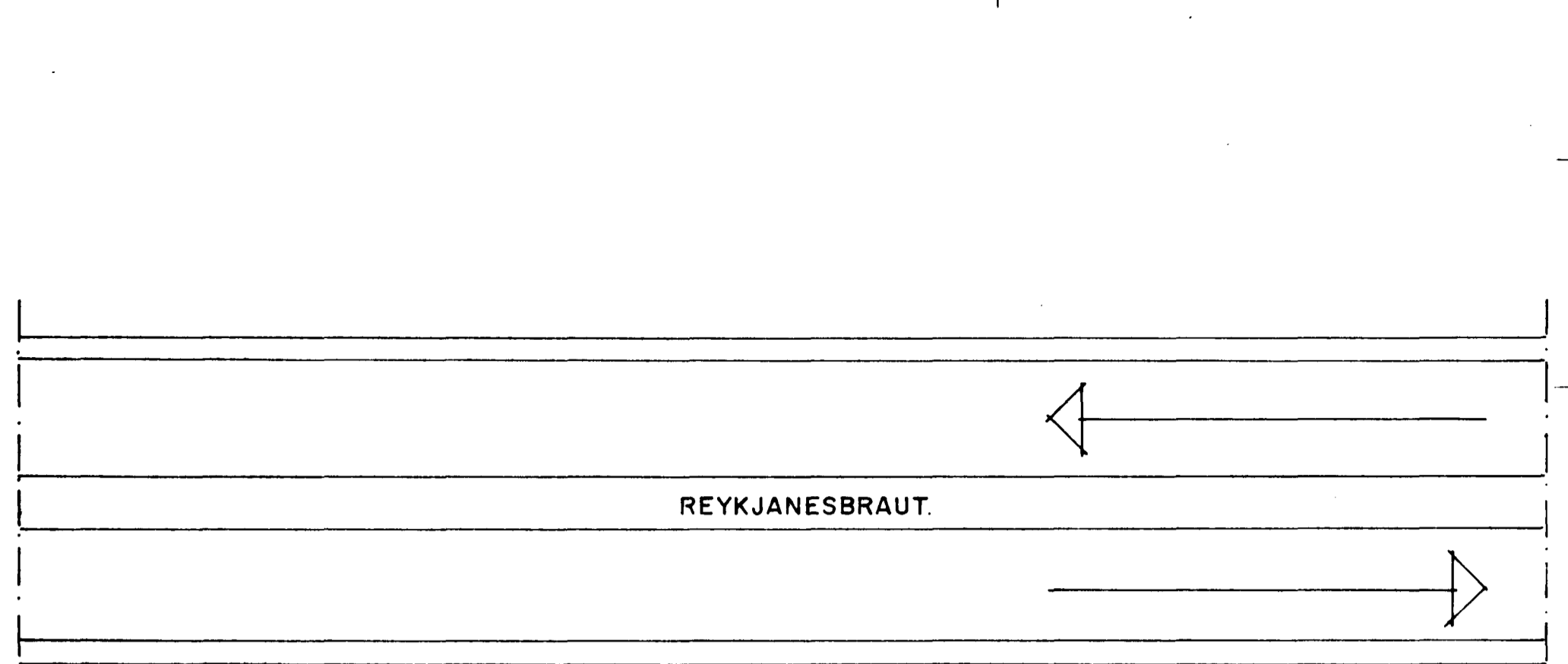

AFSTÖÐUMYND 1:500 EFTIR AÐ 3. ÁFANGI HEFUR VERIÐ BYGGÐUR.

REYKJAVÍK. 6.-9.-84.
Dón Rasmundsson ARKITEKT.