

SNID A-A I INNTAK R.H.
 M. 1:100

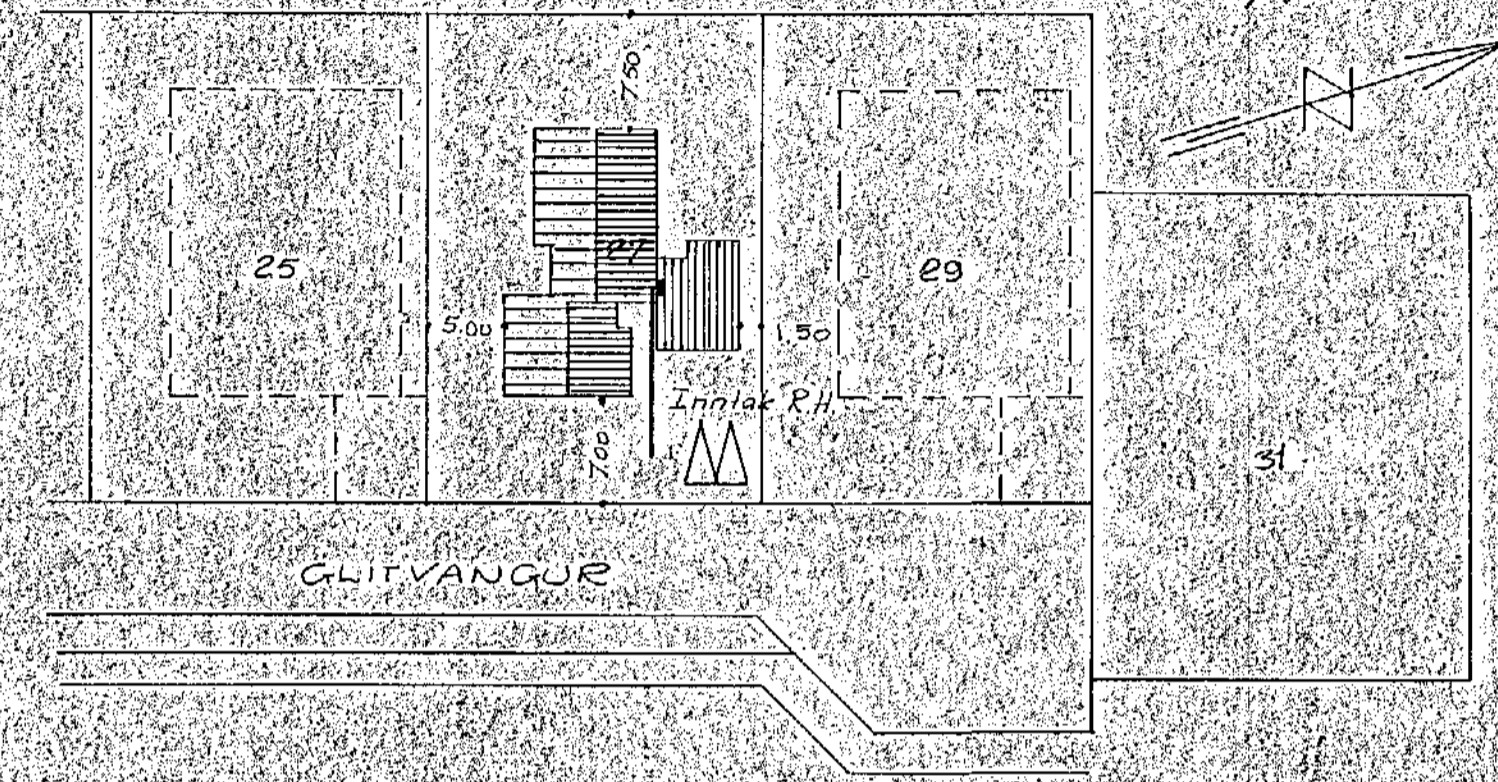

AFSTÖÐUMYND M. 1:500

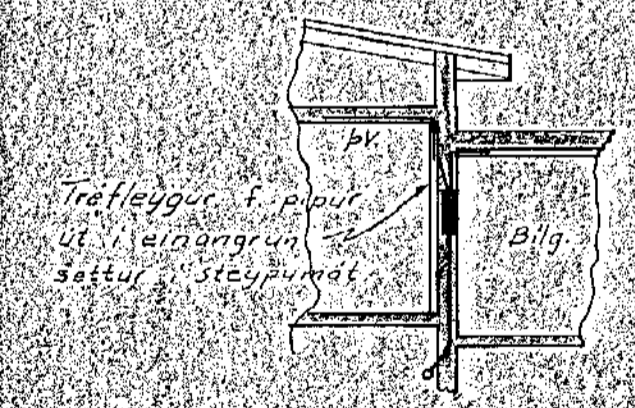
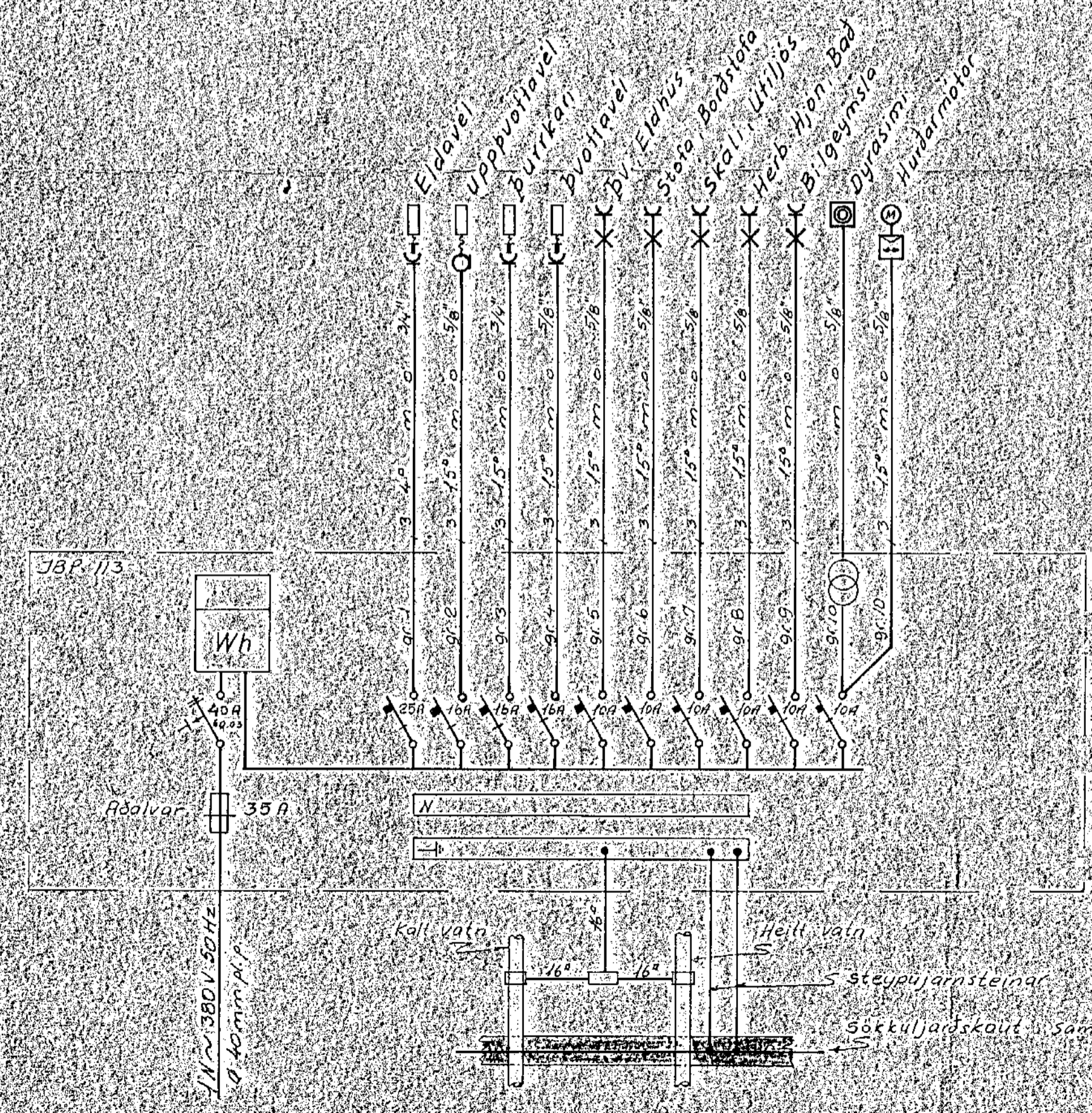

SNID B-B M. 1:100

SKYRINGAR
 Lagnir eru huldar 5/8 pipulagnir og
 taugar 3x1,5. Hæð rofa sé 105sm.
 Hæð tengla sé 20sm.
 F=Bæjar sími, L=Löftnet, DS=Dyrasími
 Malstraumur rofa og tengla sé 10A.
 } Nærna önnur
 } sé gætið

GLITVANGUR 27 HAFNARF.	mælikv. 1:100 1:500 ✓
	dags. SEPT. 1977
AFSTADA SNID SKYRINGAR EINLINUMYND	teikn. TS. bl. 1 af 2
	samb. <i>Tausli Steingís</i>
	teikn. nr. 23-A57