

HÁABERG 17

2. HÆÐ 195 m²

1. HÆÐ 110 m²

SAMTALS 305 m²

NÝTINGARHLUTFALL: $\frac{305}{1140,2} = 0,27$

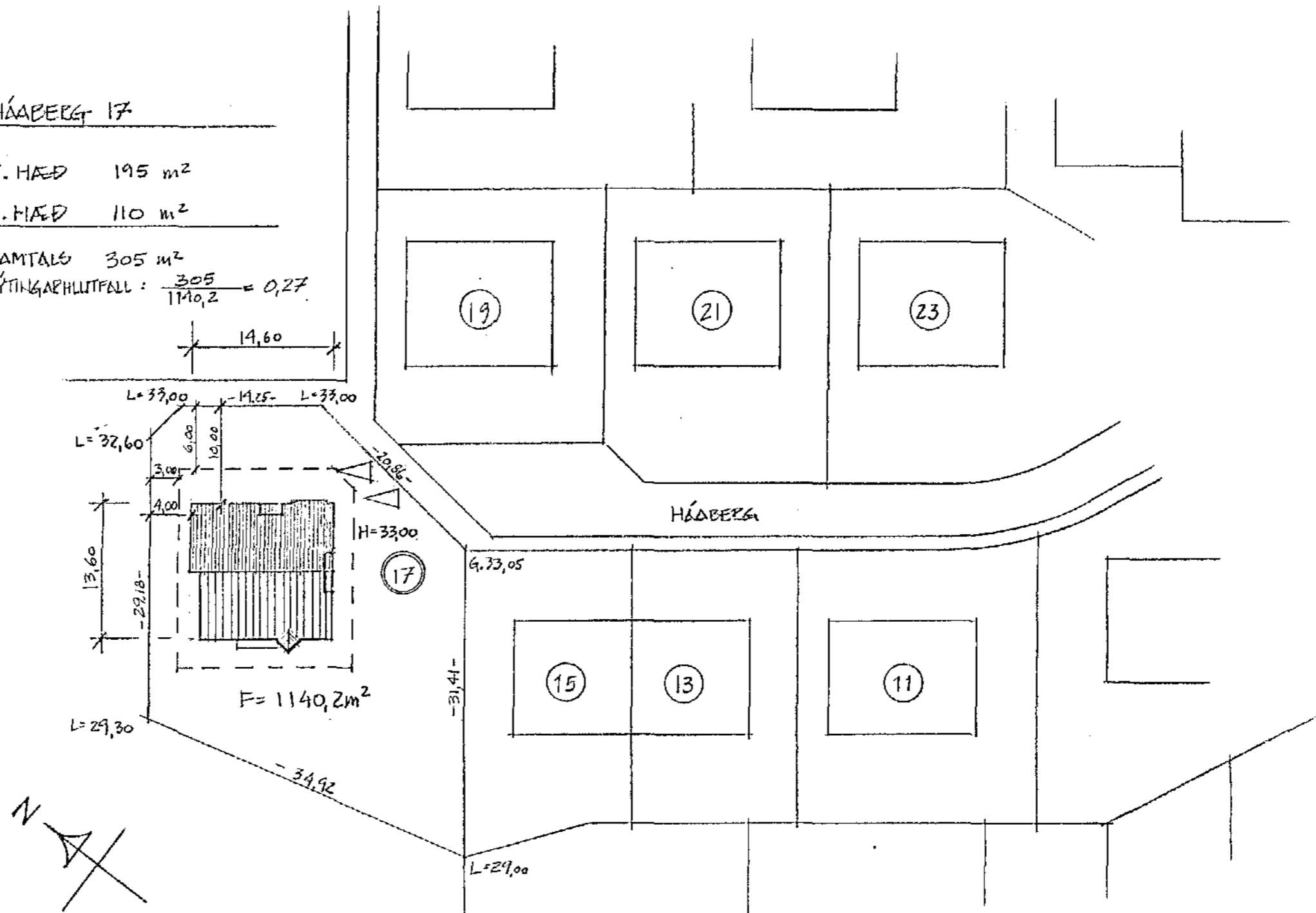

HÁABERG 17

TILLAGA AD AFSTÖÐUMYND

MAL 1:500

20. JÚLÍ 1990 ERLING G. PEDERSEN FA.I.