

SNED AA 1:20

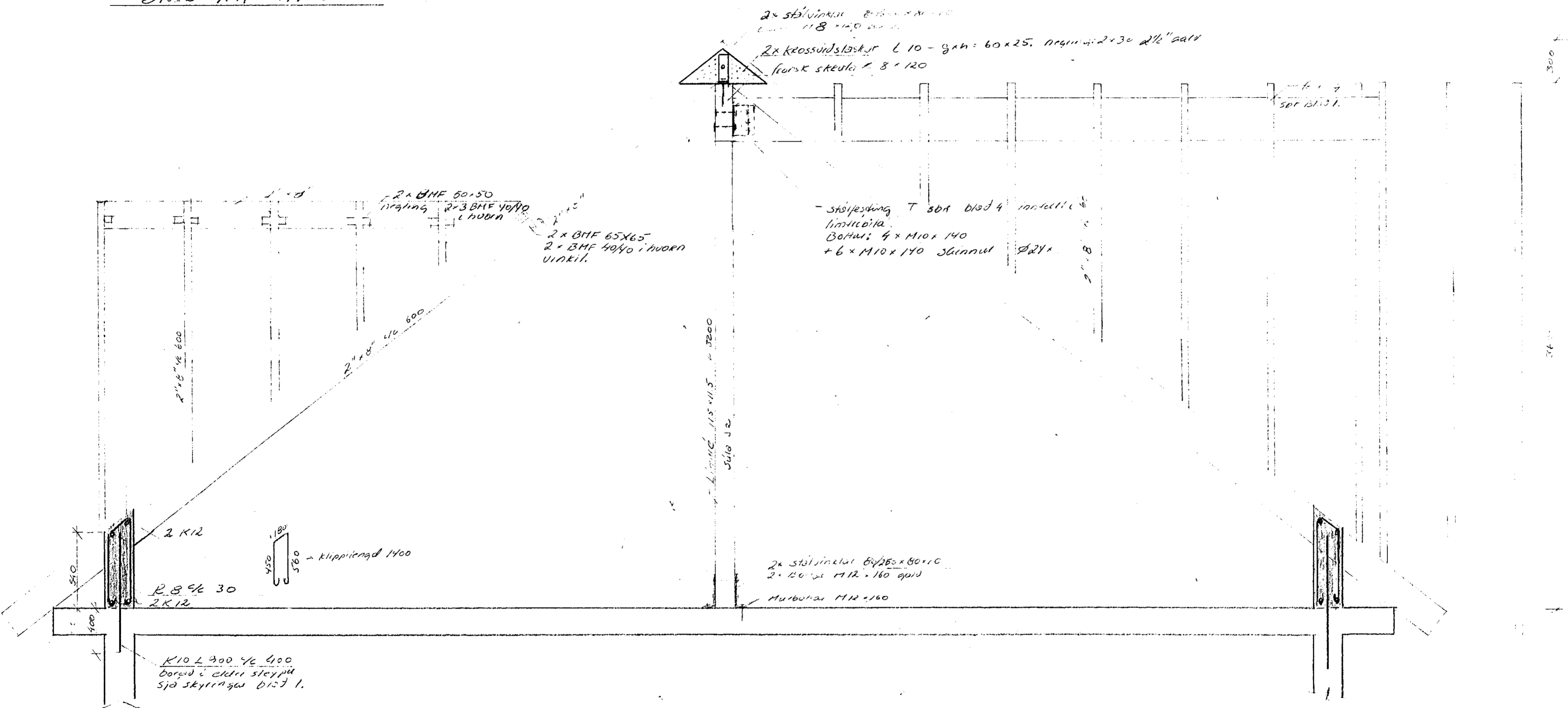

2x stálvinkli 80x80x10
 2x krossvídslöskur L 10 - g x h = 60 x 25. nequnni 2+30 2 1/2" gaur
 feorsk skreula 8' 120

2x BHF 50x50
 2x3 BHF 40x40
 2x BHF 65x65
 2x BHF 40x40 i huorn
 vinkel.

Stólfesting T sða blöð 4 innfellir
 limir/bita
 Bolur: 4 x M10 x 140
 + 6 x M10 x 140 slinnur

2x stálvinkli 80x80x10
 2x Bolur M12 x 160 gaur
 Hurður M12 x 160

K10 L 300 x 400
 Dorsur í einni stöppu
 Sjá skýringu bl. 3 l.

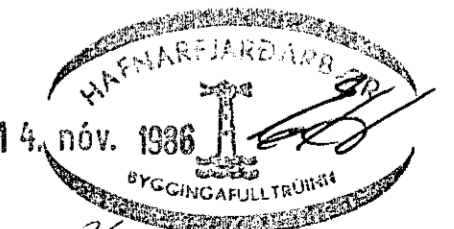

Guðmundur Harðarson TFI S: 684197

HRINGBRAUT 5 Holmhlíði	
M 1:20	SNED A-A
REKNAÐ Guðm. C.	
OKT 1986	Bl. 2 af 4