

Snið A4-A4 M1:2

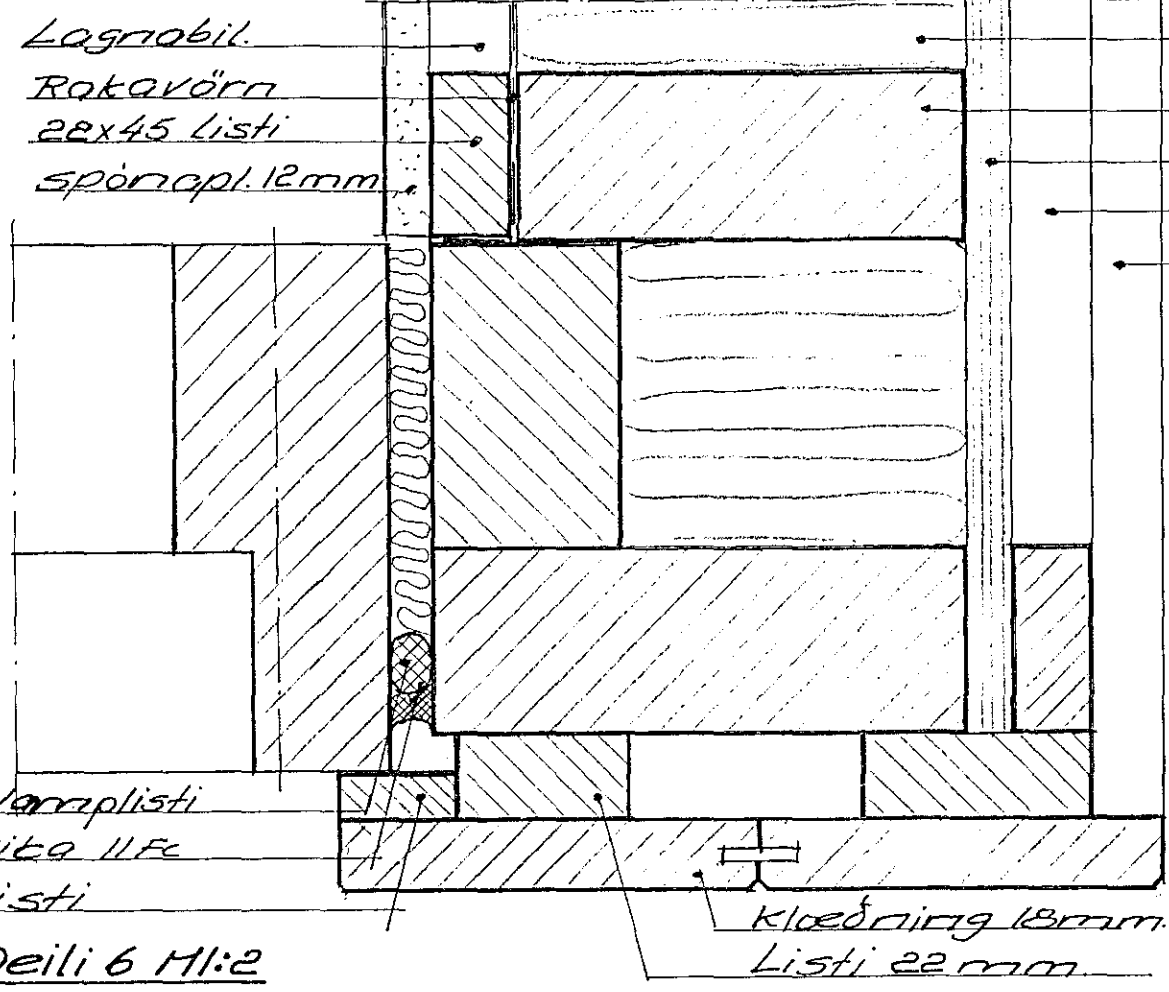

Deili 6 M1:2

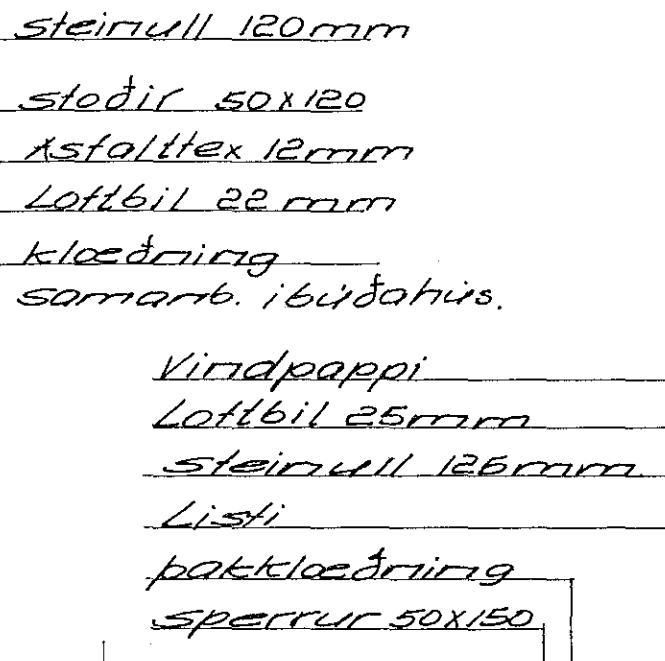

Snið A2-A2 M1:2

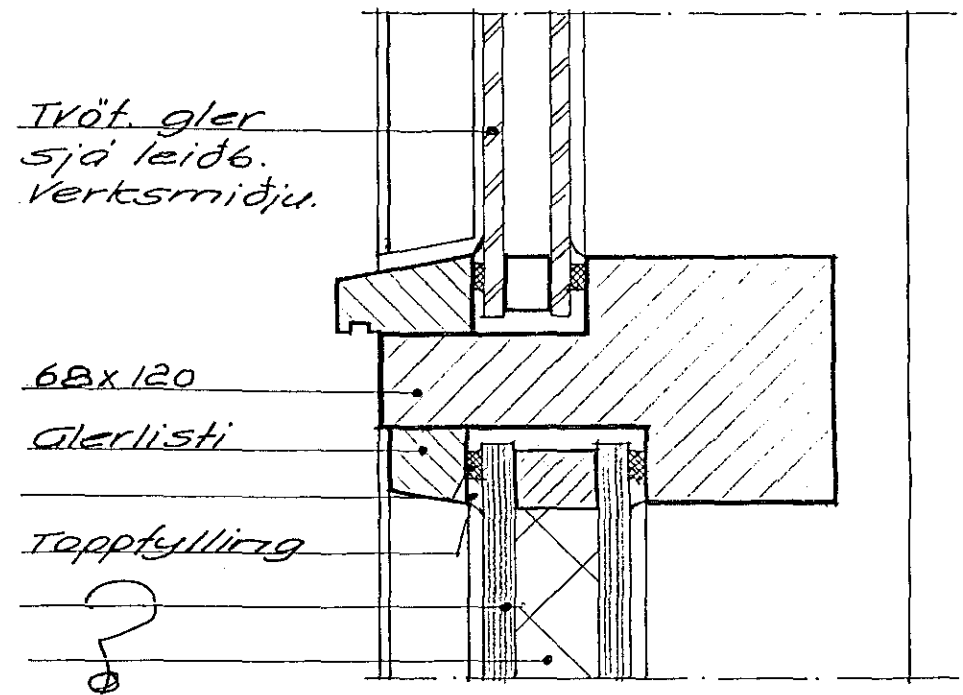

Snið A5-A5 M1:2

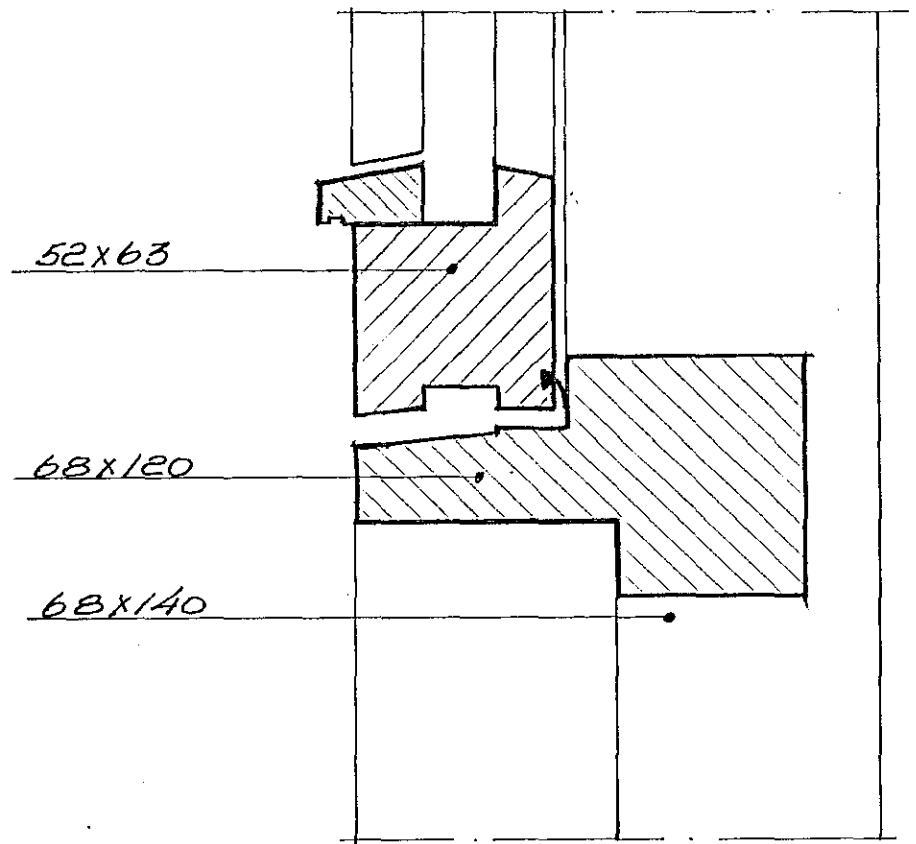

Snið A3-A3 M1:2

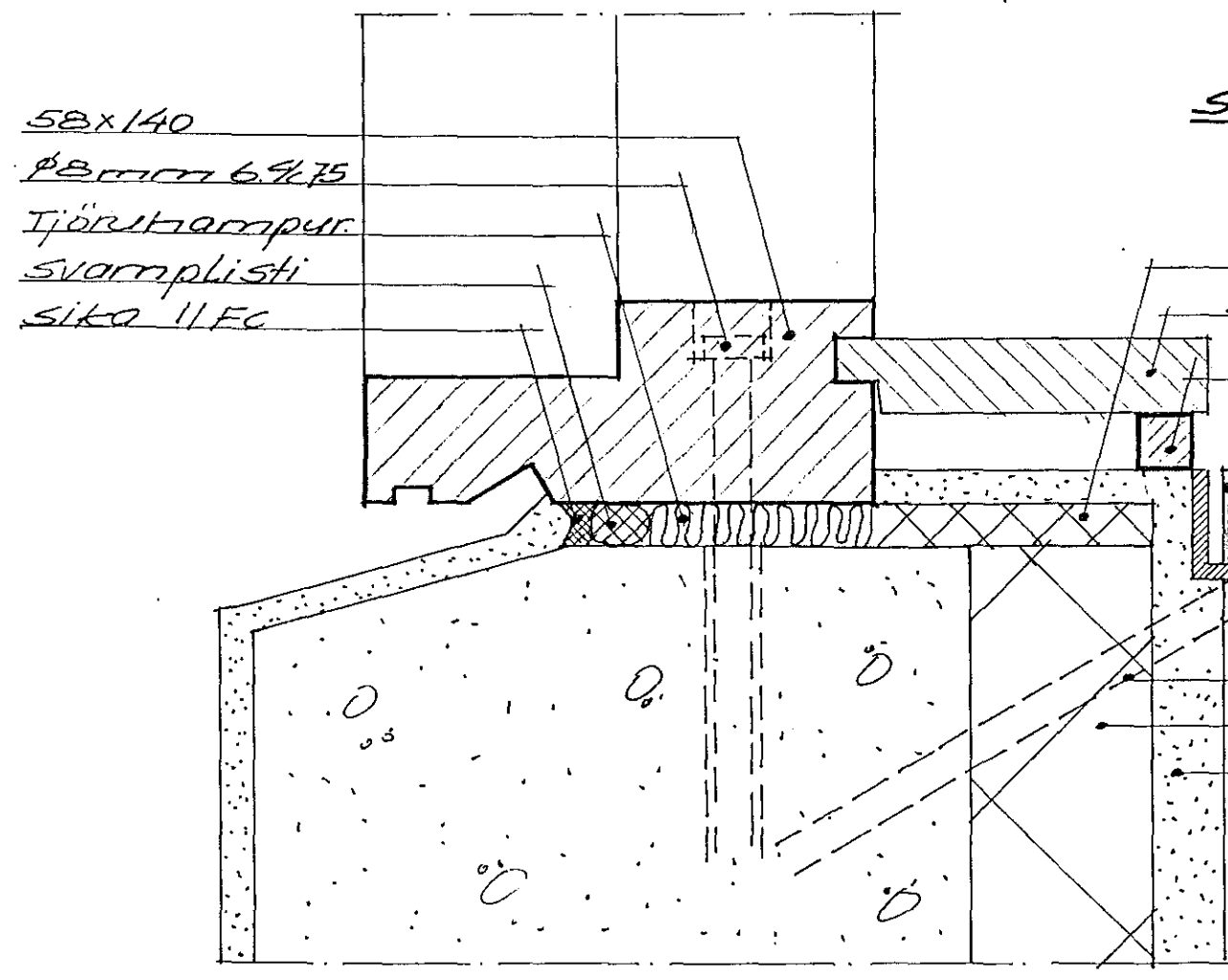

Snið A6-A6 M1:2

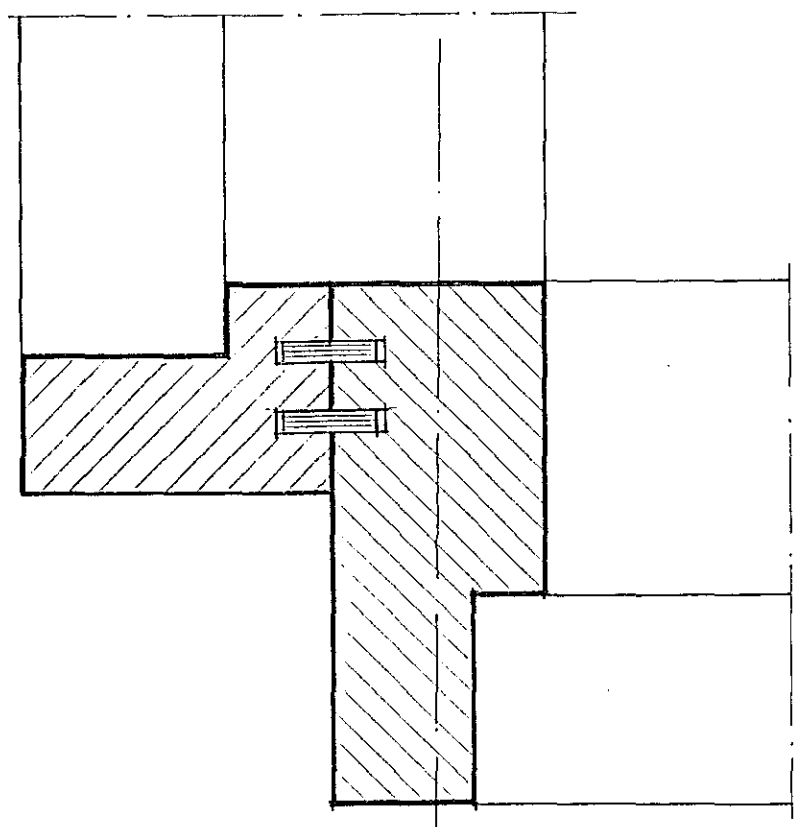

Snið A1-A1 M1:2

Skýringar:

Allar efriisstaðir eru mm en önnur á trefnd mál sm. Ks. merkir kambsaumur, sem skal vera af gerðinni BHF eða samsvarandi. 40/40 merkir lengd 40mm, þvammál 4mm. Allar múrtestingar skulu vera múrboltar af gerðinni UPAT eða samsvarandi.

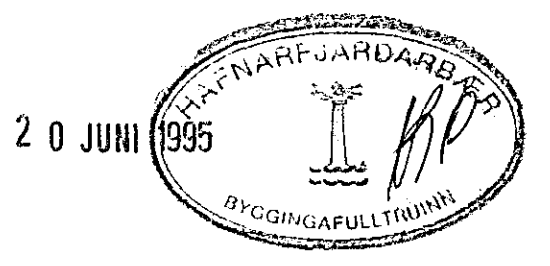

Unnar Jónsson byggj. fr. S: 654439	
Kirkjuvegur nr. 9	K.nr. 10148-13
Hafrarfirði.	M.kk. 1:2
Snið og deili	Dags. 2.05.95
	Teikn. U.J.
	<i>Unnar Jónsson</i>