

SÚLA 51 x 1 x 20

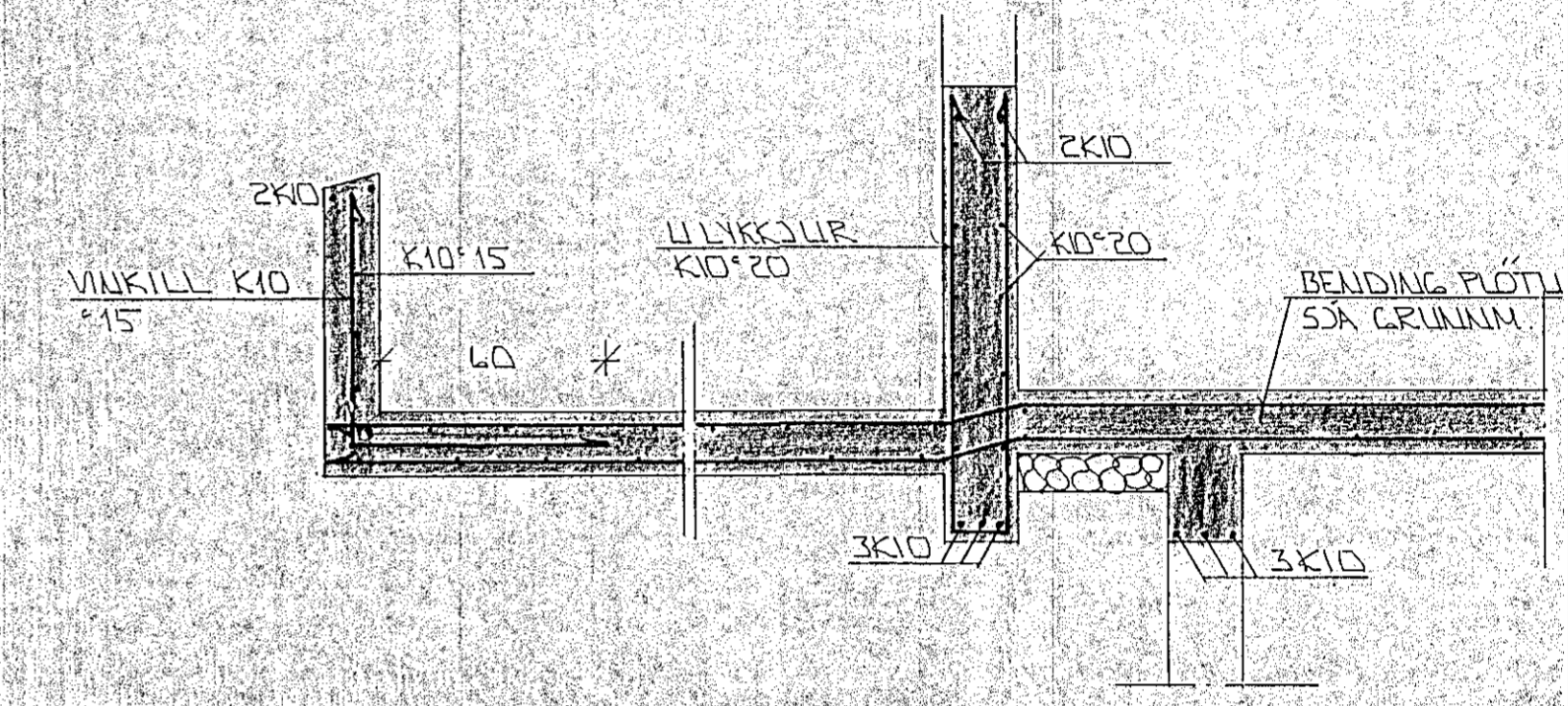

SNIP 6-6 x 1 x 20

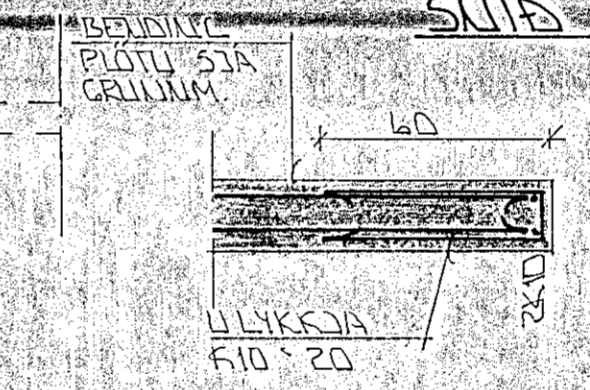

SNIP 8 x 1 x 20

SKIRINGAR

ALMENNAR SKIRINGAR SJA BL. NR. 1-01.

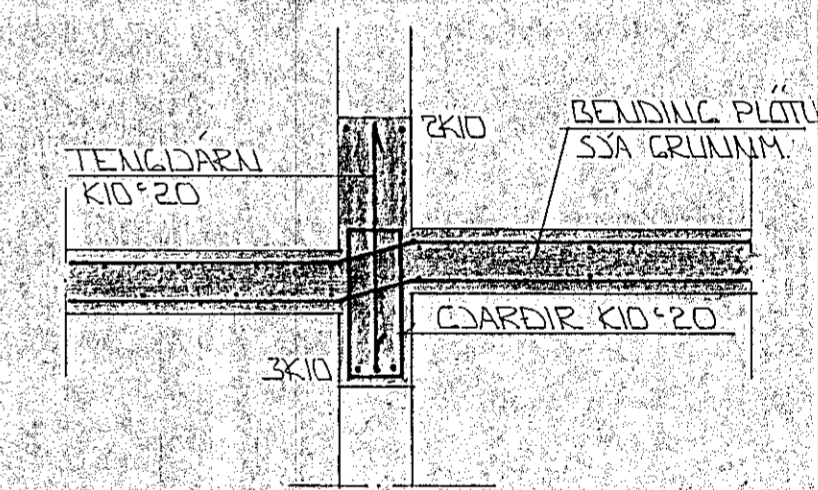

SNIP 7 x 1 x 20

GRUNNMUND x 1 x 50

EINFÖLD GRIND I  
MIRJAN VEGG K10°15#

STEIPA:  
 $S > 250$   
 $VS \leq 0.5$   
 $LOFT \geq 6\%$   
 $SEMENT \geq 300 \text{ KG/M}^3$

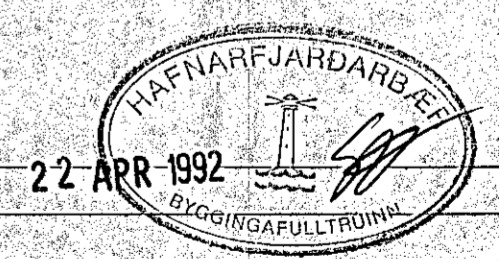

BR.NR.	DAGS	EÐLI Breytingar	SIGN.
01	21.4 '92	Þótils Þóris Þekki Ógill	GH
LINDARBERG 74 HAFNARFJÖRÐI			
BENDING VEGGJA 1. HÆÐAR			
BENDING PLOTU YFIR 1. HÆÐ			
MÆLIKV. x 1.50 x 1.20			
SIGURÐUR ÞORLEIFSSON			TEKNIFRÆÐINGUR P.T.F.I.
STRANDGÖTU 11 HAFNARFJÖRÐI			SÍMI 54751/54255
DAGS. APRIL '92			HANNAÐ
TEIKNINGUR			VERK NR. 9125
BLAD NR.			1-04