

Rauf fyrir hitalagnir | Rauf fyrir hita- og neysluvatnslagnir

V1

F=18,76 m<sup>2</sup>  
P=5900 kg  
R=2,35 m<sup>3</sup>

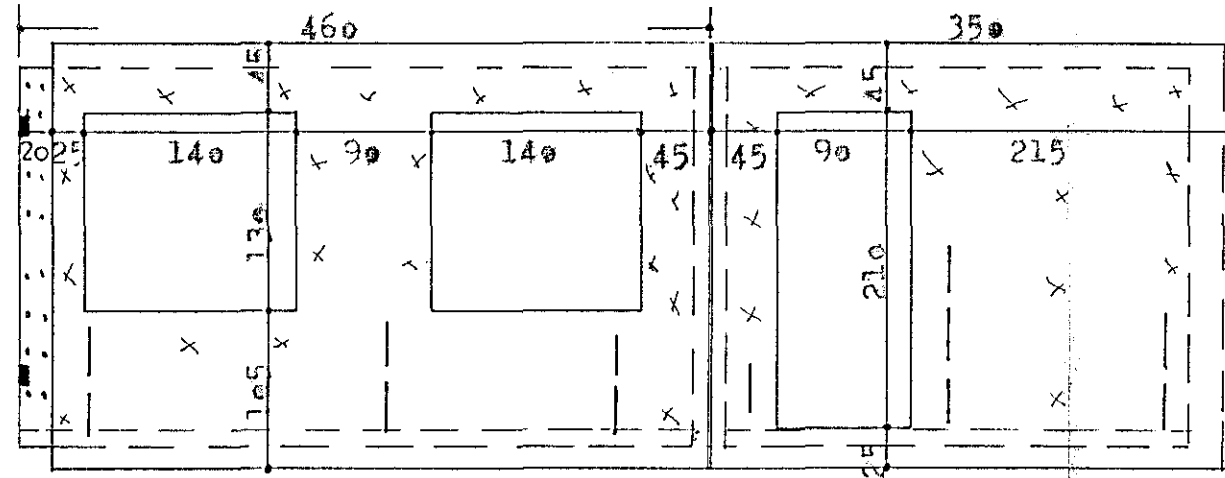

Rauf fyrir hita og neysluvatn | Rauf fyrir hitalagnir

V2

F=12,88 m<sup>2</sup>  
P=4000 kg  
R=1,60 m<sup>3</sup>

V3

F=9,80 m<sup>2</sup>  
P=3400 kg  
R=1,35 m<sup>3</sup>

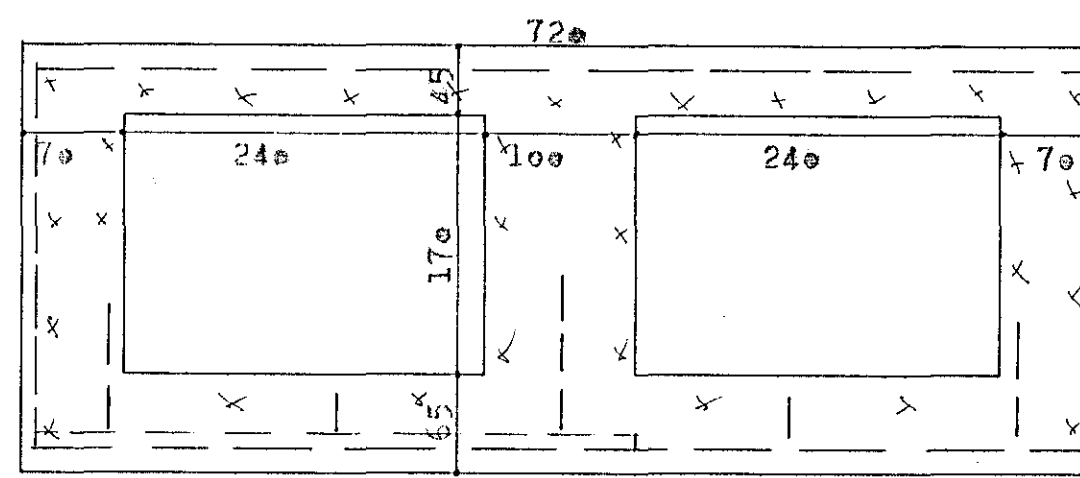

Rauf fyrir hitalagnir.

V4

F=20,16 m<sup>2</sup>  
P=5150 kg  
R=2,05 m<sup>3</sup>

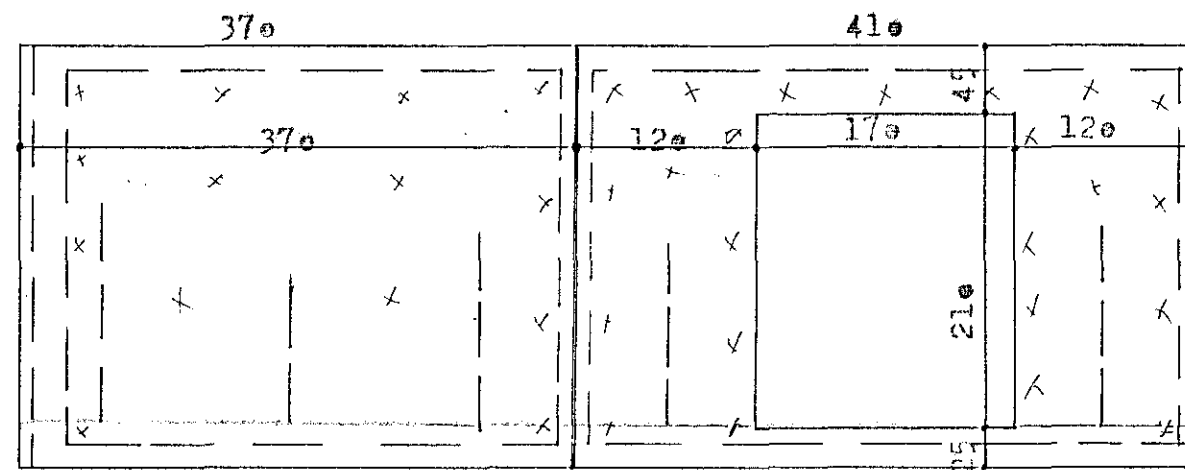
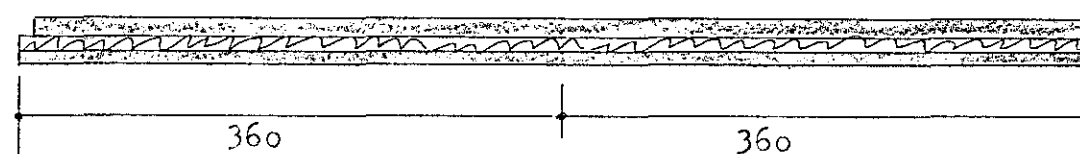
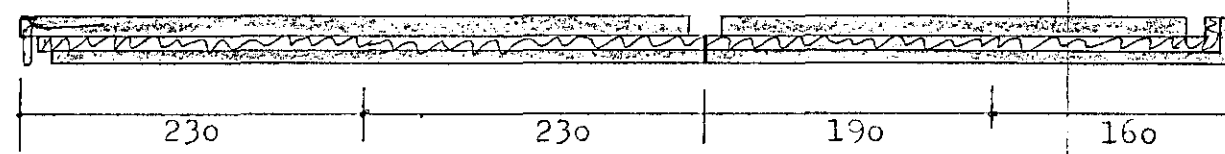
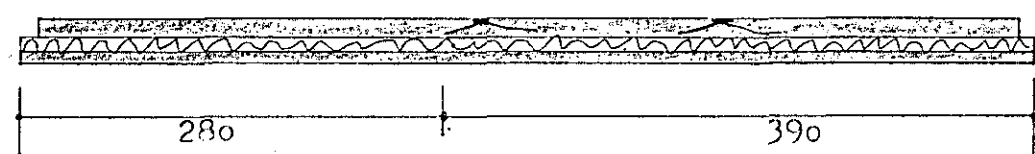

V5

F=10,36 m<sup>2</sup>  
P=4600 kg  
R=1,84 m<sup>3</sup>

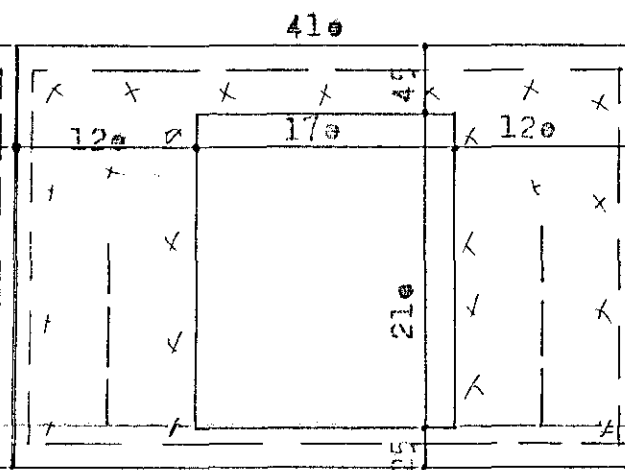

V6

F=11,78 m<sup>2</sup>  
P=3400 kg  
R=1,36 m<sup>3</sup>

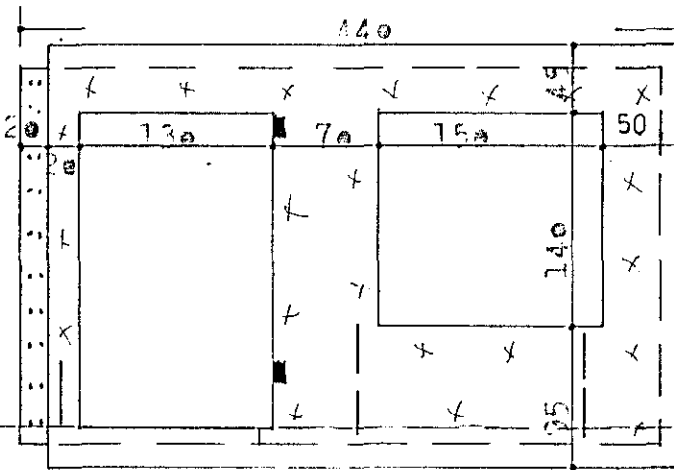

V7

F=12,32 m<sup>2</sup>  
P=3150 kg  
R=1,25 m<sup>3</sup>

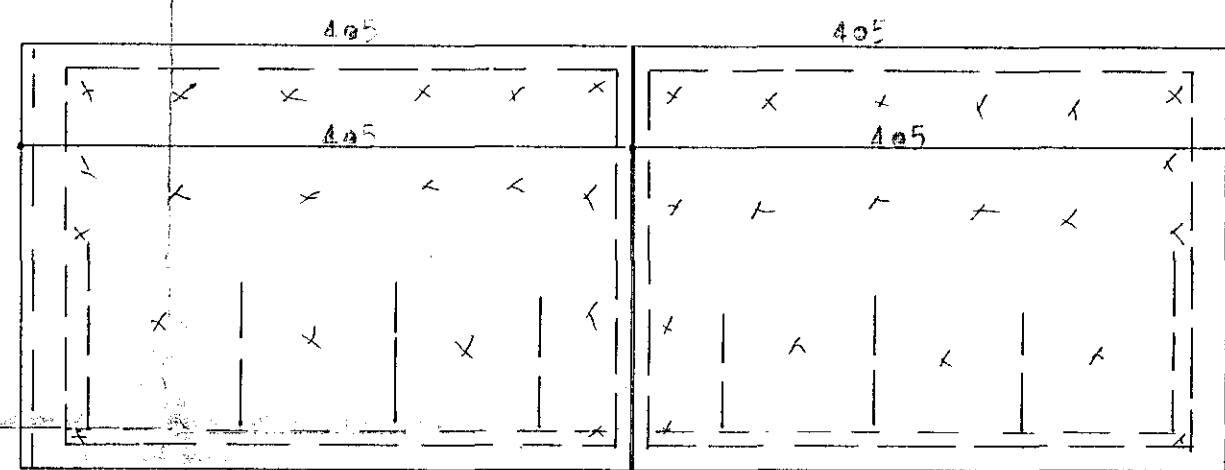

V8

F=11,34 m<sup>2</sup>  
P=5050 kg  
R=2,02 m<sup>3</sup>

V9

F=11,34 m<sup>2</sup>  
P=5050 kg  
R=2,02 m<sup>3</sup>

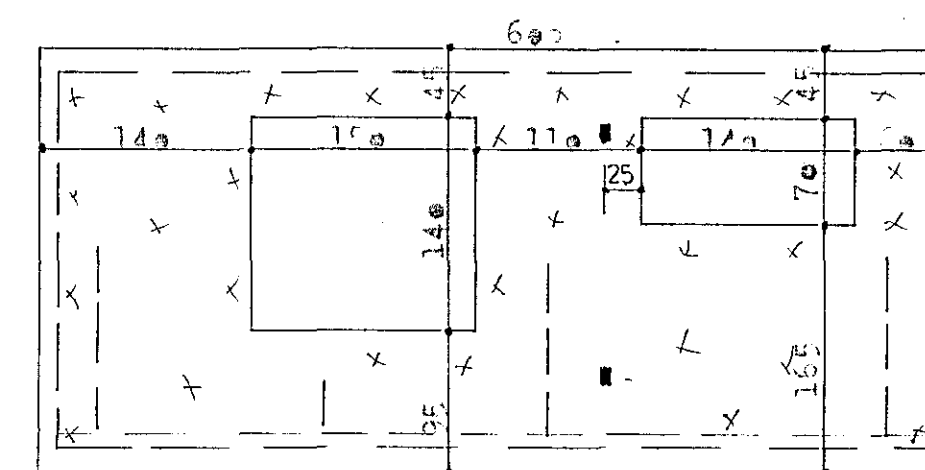

V10

F=16,80 m<sup>2</sup>  
P=6100 kg  
R=2,44 m<sup>3</sup>

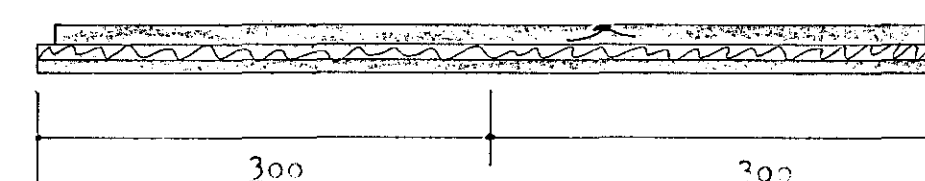
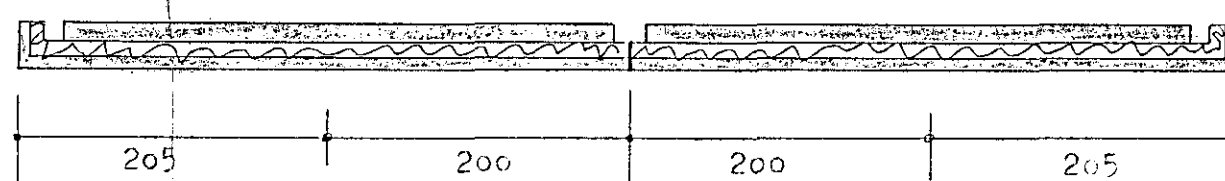
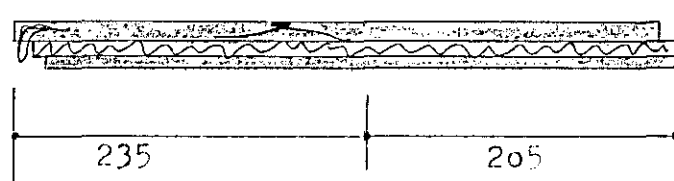
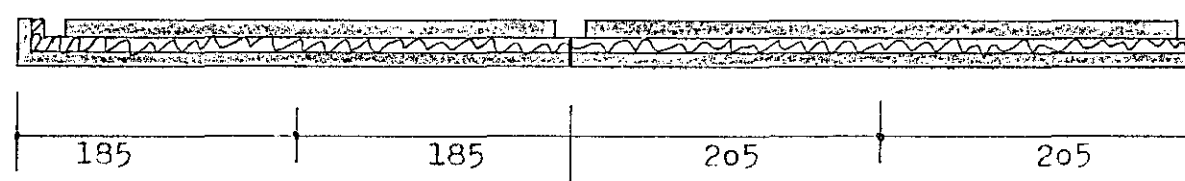

Járnbanding veggja:

Utveggir: Ytra byrði : Net K189 , kringum op þ.e. glugga og hurðir komi 2 K8 í útkant eininga komi K10 allan hringinn.

Innra byrði: Net K189 , kringum op þ.e. glugga og hurðir komi K12 eða 2 K8.

Far sem járnbanding er örurvísi eru sýnt sérstök snið.

Innveggir: I miðjan vegg komi K189. Yfir dyraopum komi 4 K10 í báðar hliðar. Upp með opum komi K10.

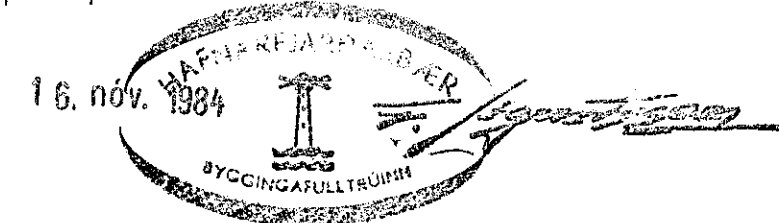

VERKHÖNNUN

VERKFRÆÐI- OG TEIKNISTOFA



BRAUTAHOULT 20, REYKJAVÍK. Sími: 01-16920

Verknr. 223 Teiknad: G.B.G.

Teiknr. 104 Hannad:

Mælikv.: 1:50 Samþykkt: Svein Sigbjörn

Dags. ÁGÚST 1984. Breytt:

Verkefni: LITÓRABORG 46, REYKJAVÍK.

Heiti teikn.: ÖFTV-ORJAFRÆÐINGAR V1-V10.