

Steyfing sperra i mæni

1:10

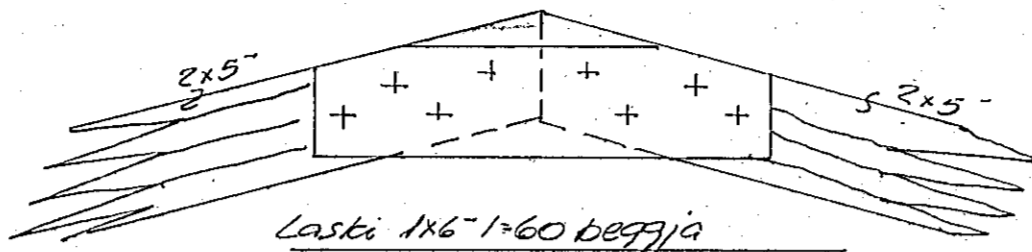
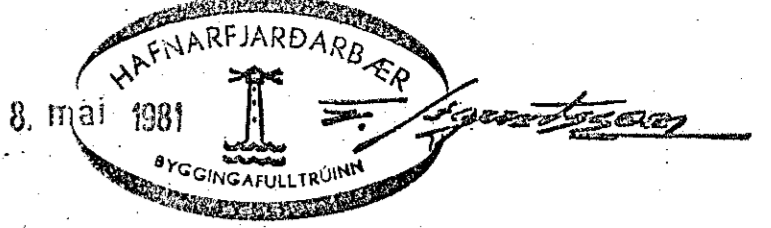

Lasti 1x6-1-60 beggja vegna sperru neqlist með 4 stk 3" hvorn megin.

Plt. ① 1:10

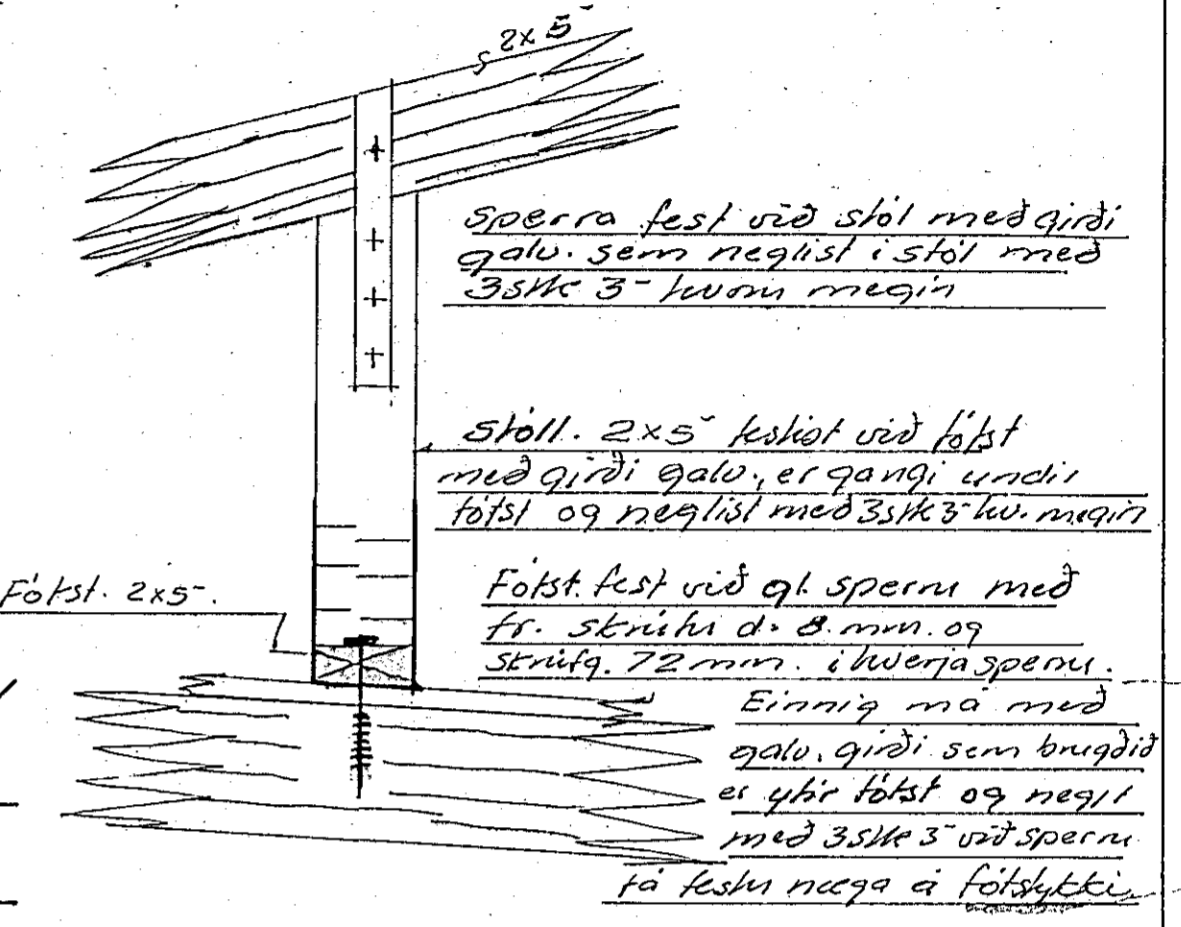
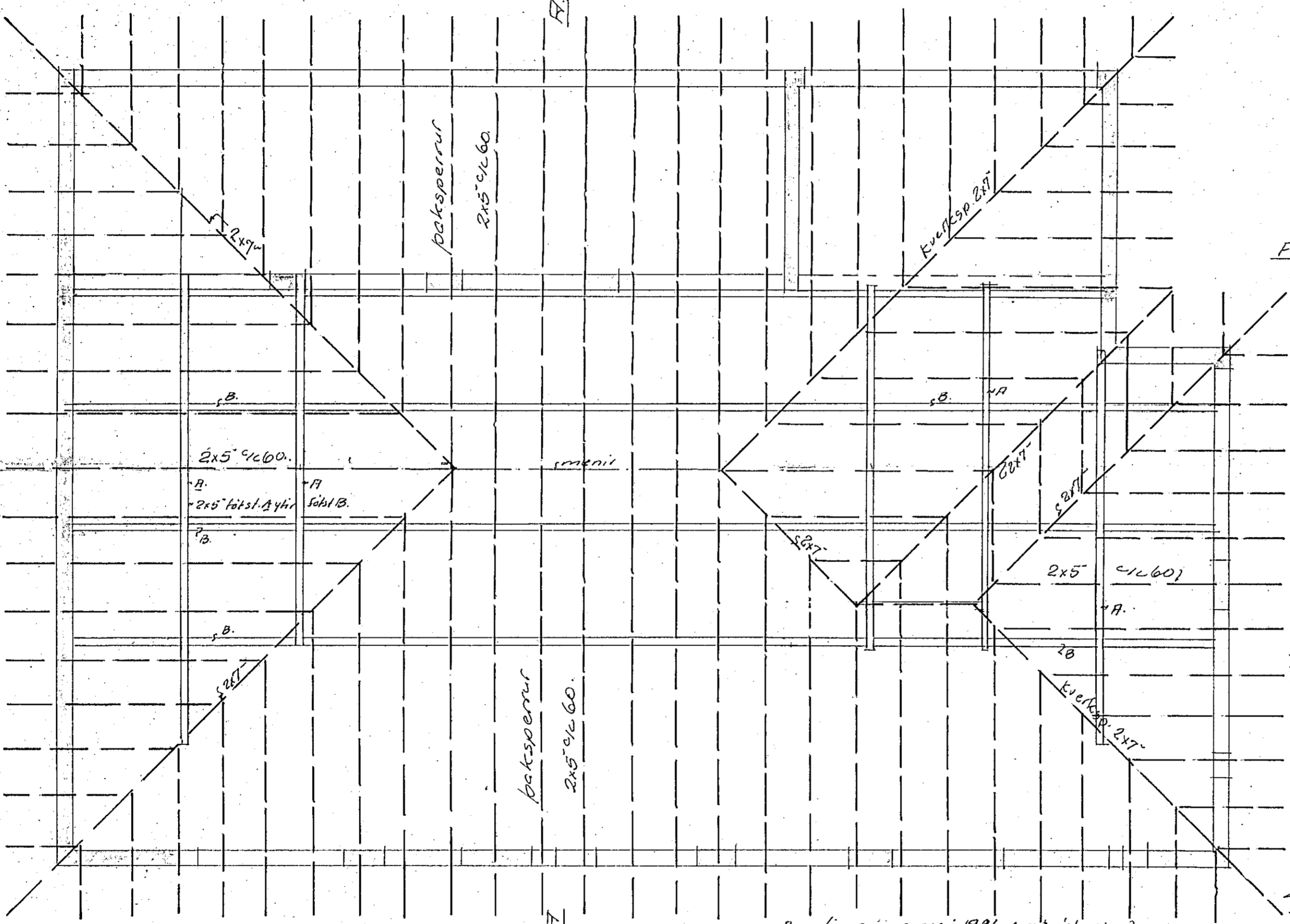
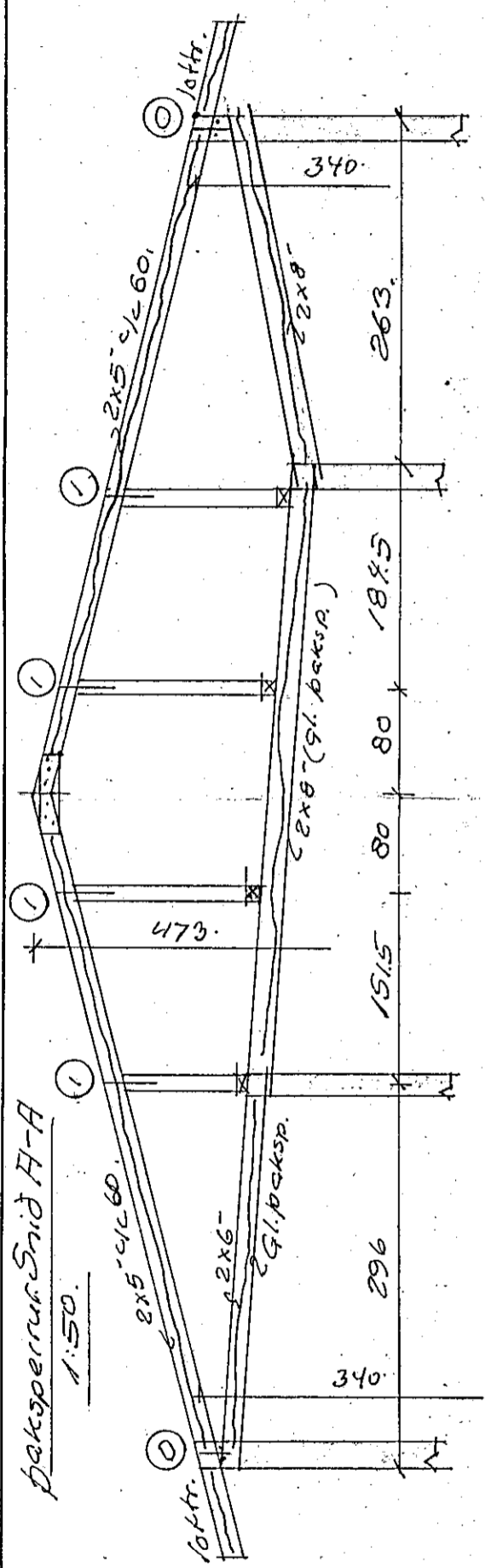

Festing sperra við skoppu.

Plt. ① 1:10
Till. I

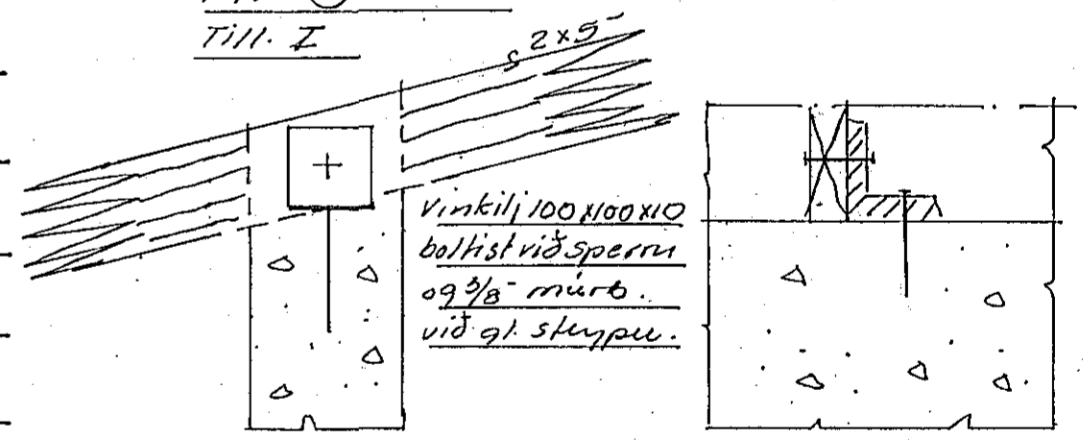

Festing sperra við skoppu. 1:10

Plt. ① Till. II

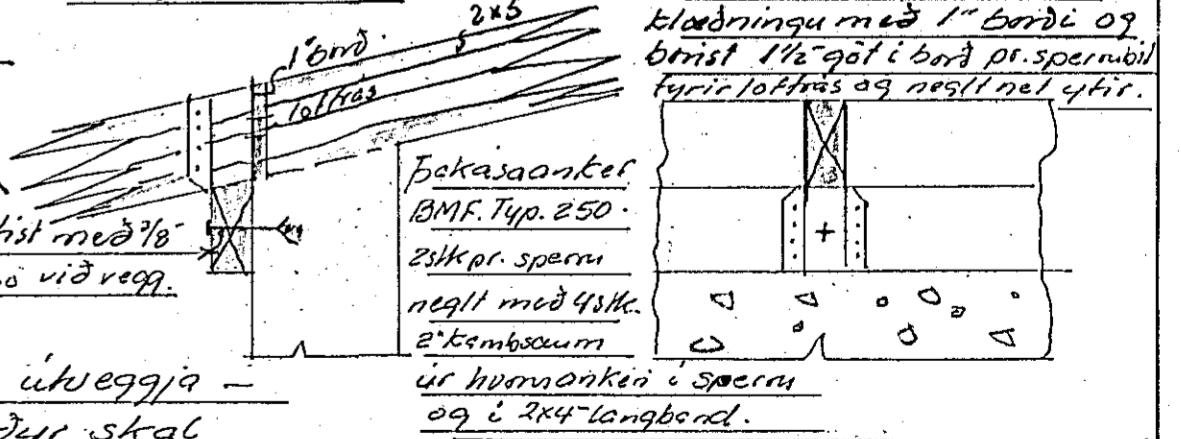

Breyfing, apr. maí 1981. (Að öst eig.)
Sperrur festar skv. till. II. Etaki skoppit milli sperra en bil lokist með 1" bændi B.B.S.

Brijóla skal múrhúðun ofan af skoppum útvægja - karkum, þar sem hættka þarf kanta. Aður skal seha 3/8" múrbolta með 25cm bili i kantana. Skoppa þröð notist milli sperra. Þínchist með l.d. semplashi við ql skoppu. I kverra kornu kants skal seha k10 lár. samtúci undir sperru, þar sem hægt er. Frágangur þakbrúna, þakrenna oth annars stu. fyrir mælum tj. Sveinssonar.

Lofttræsting þaks sé minnst 8cm³ pr. m² þakflatar, sem svarar til ~ 1stk 1 1/2" plasttré pr. sperruból til lofttræstingarl. Fremst i rör sett fint eirnet til að hindra snjó- hjúk inn um rautar.

Benedikt B. Sigurðsson Verkt.	
Mávatnau 16, Hafnarfirði	
M.	1:50 Nýtt þak á hús.
D.	1:80 Þaksperrur.
Nr.	6j. Þinn B. Sigurðsson