

HEILBRIGGISEFTIRLIT  
 HAFNARFJARÐARSVEIGIS  
 Heilsugæslustöðinni Sólvangi  
 Pósthólf 440 - 222 Hafnarfjörður  
 Símtöl 662600  
 17.09.1992  
 Guðmundur St. Einarsson

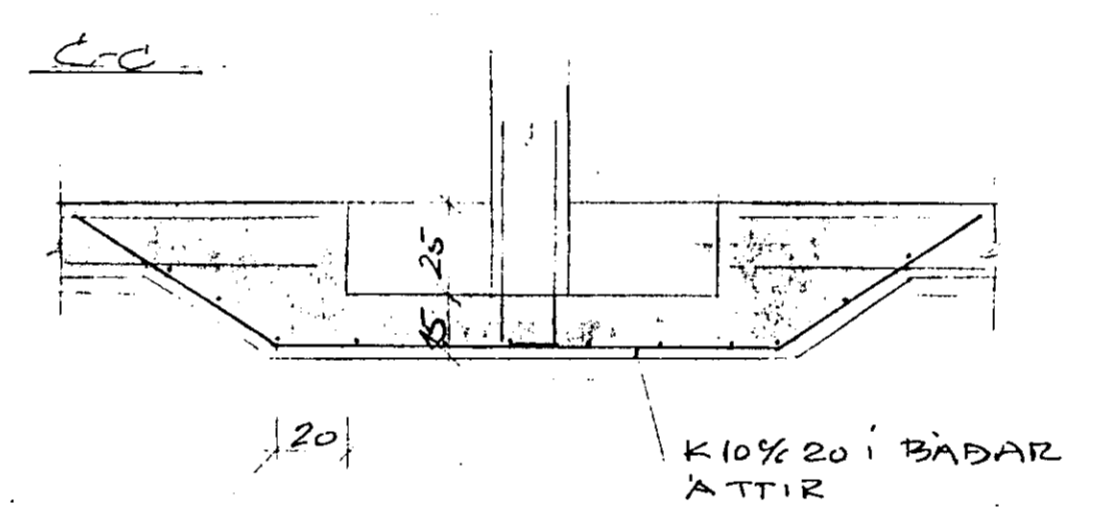
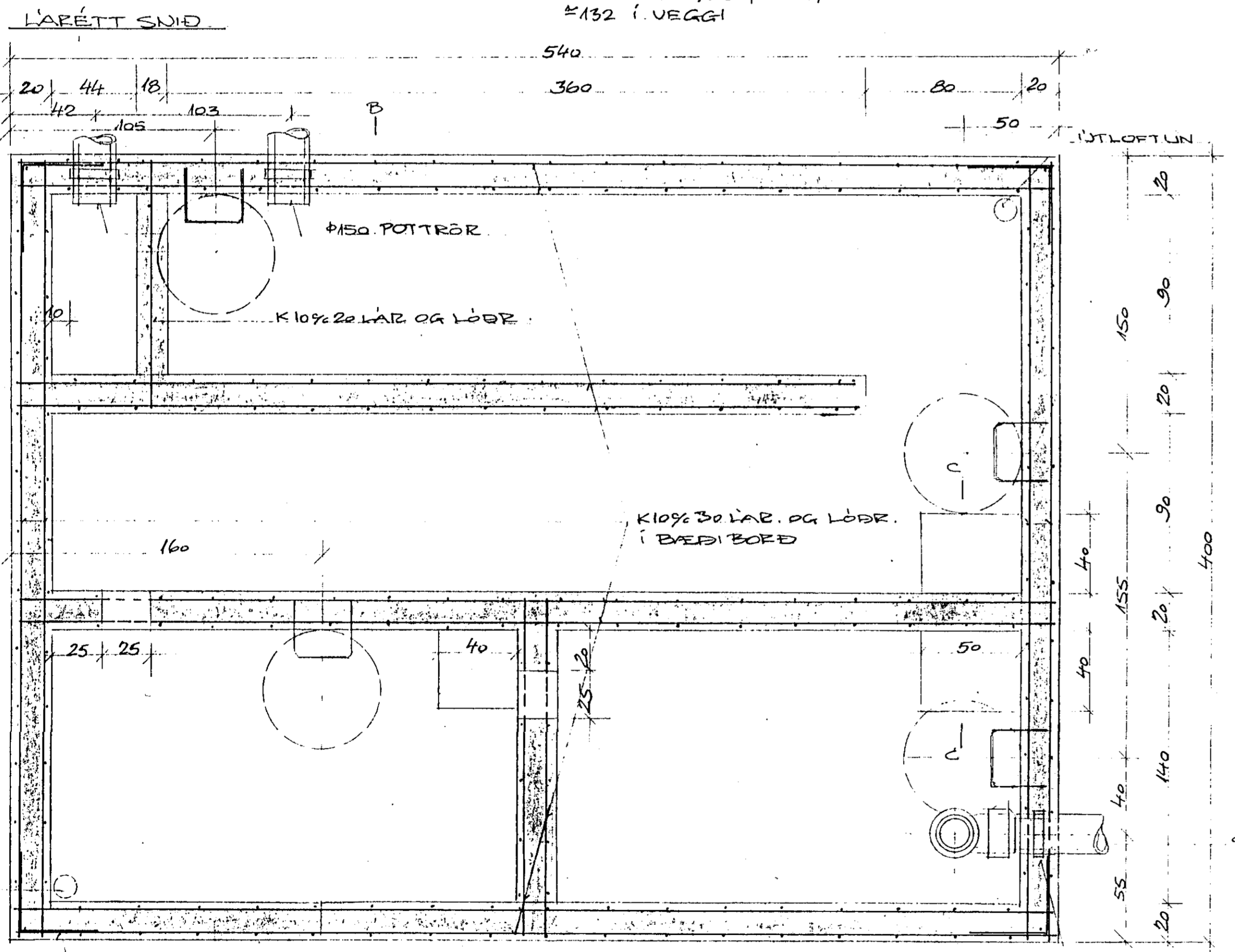
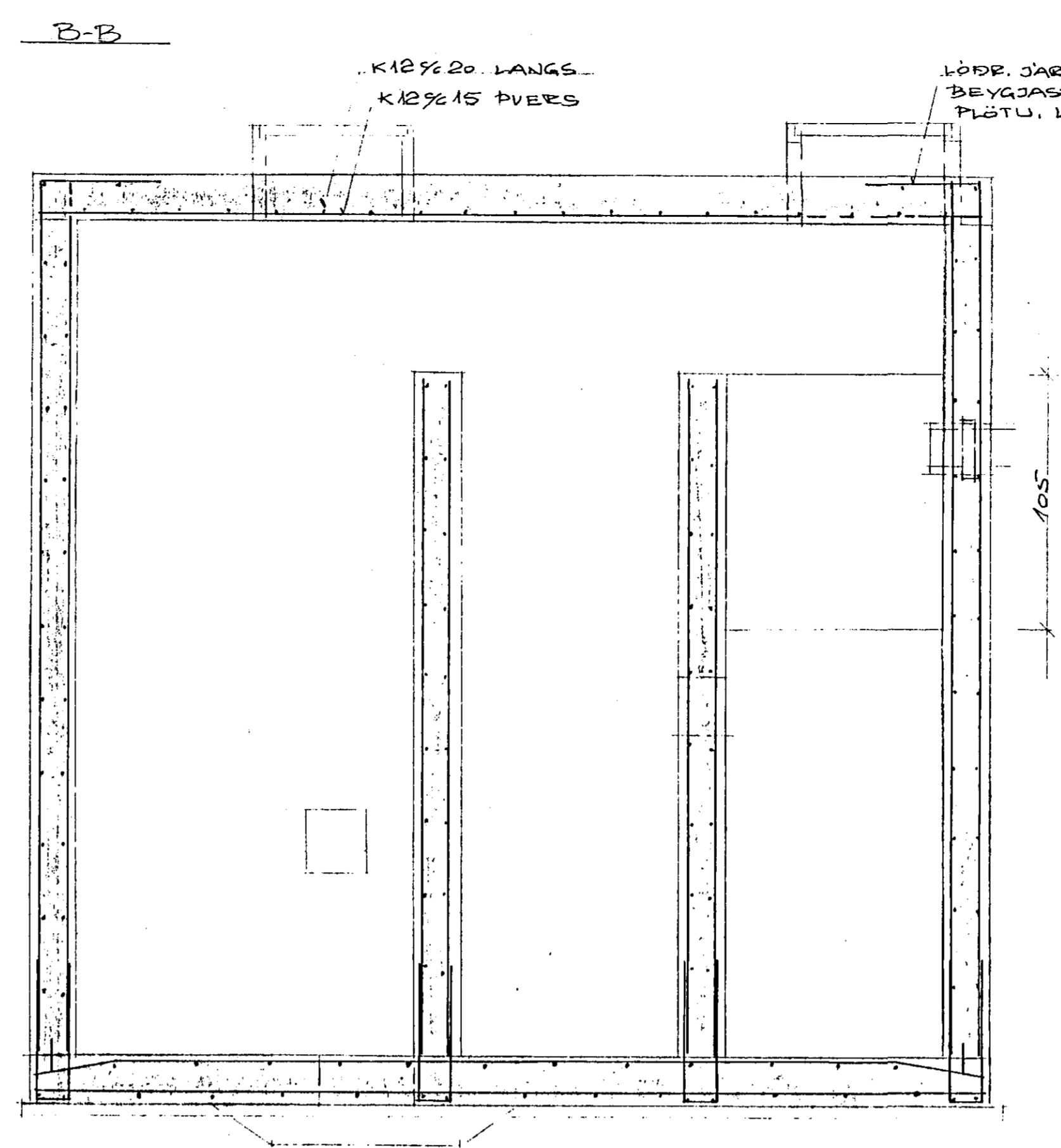
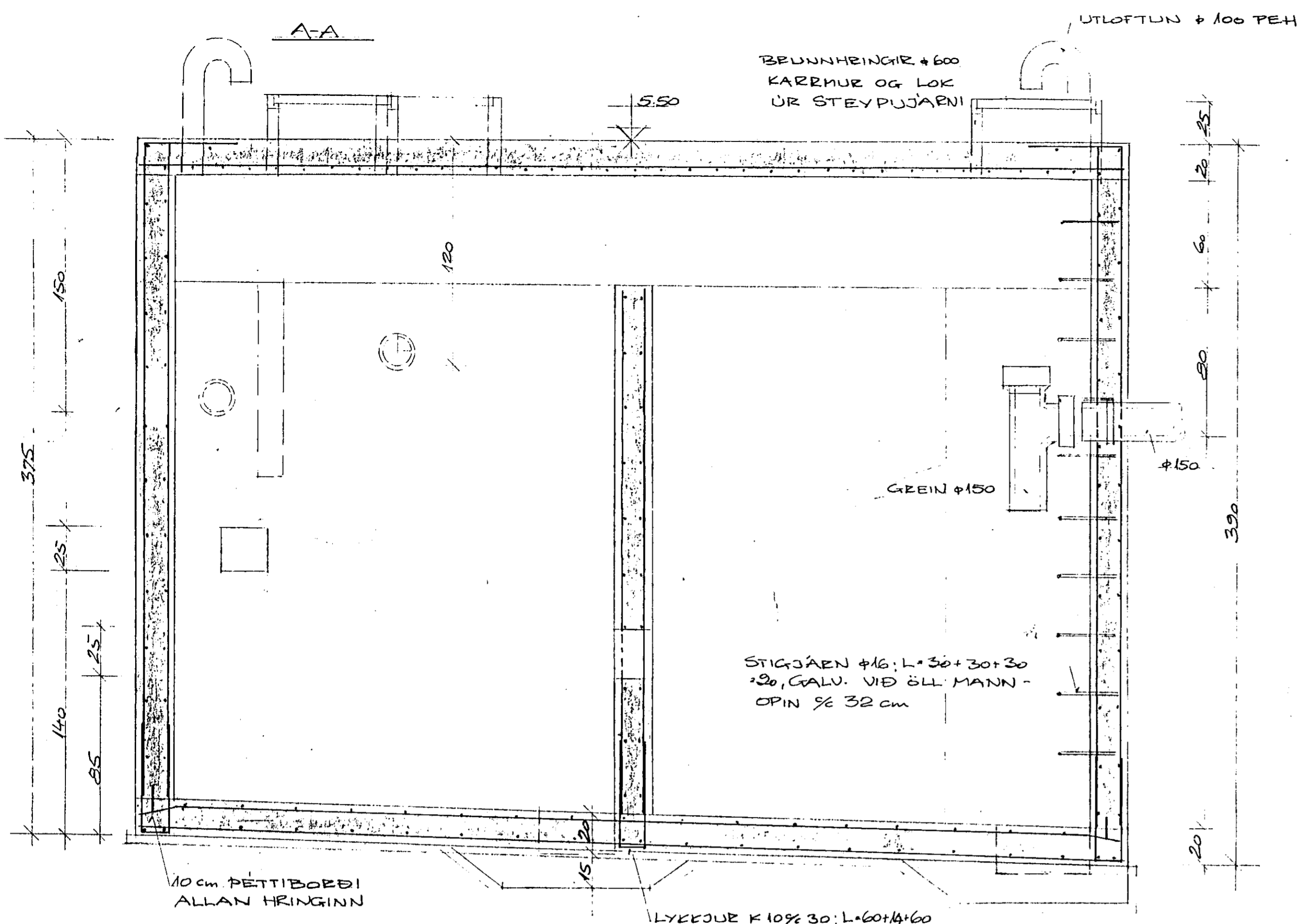

STÆRD ROTPRÖAR  
 Akvörðun á jafngildi íbúa  
 280 manns í mótuneyti  
 40 manns í skrifstofu  
 280\*0,5+40\*0,4 = 156 íbúar  
 Lámárgsstærð = R = 156\*200+40\*0,4+2000 = 33.200L á Rotbró  
 Raunstærð Rotbróar 2,1\*5,0\*3,6 = 37,8 m<sup>3</sup> = 37.8001

10 NOV. 1992  
 84.863  
 4130-010

ISAL MÖTUNEYTI	
BUEÐARVIEKI	
ROTBRÓ	
BR.	DAGS.
BREYTING	
TÆKNIPJÓNUSTAN SF	
LÁGMÓLAS - DV REYKJAVÍK - SÍMIRIÐMÁ - FAX 51470	
HANNAÐ	OP
KVARDI	1.20
TEIKNAD	OP
DAGS.	14.8.92
YFIRFARID	NR. 9211
BL.	B-4
AF.	