

Sérmynd A M. 1:10

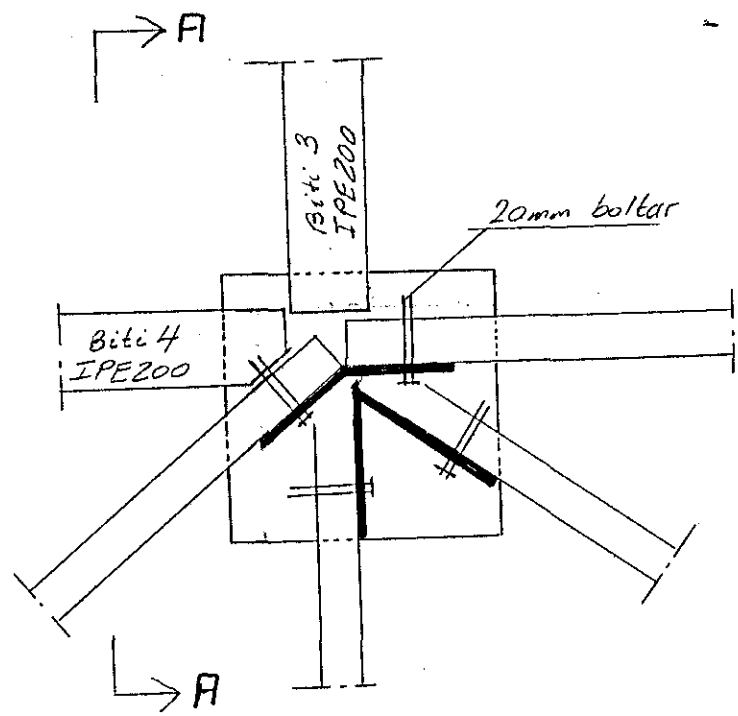

Snið A-A M. 1:10

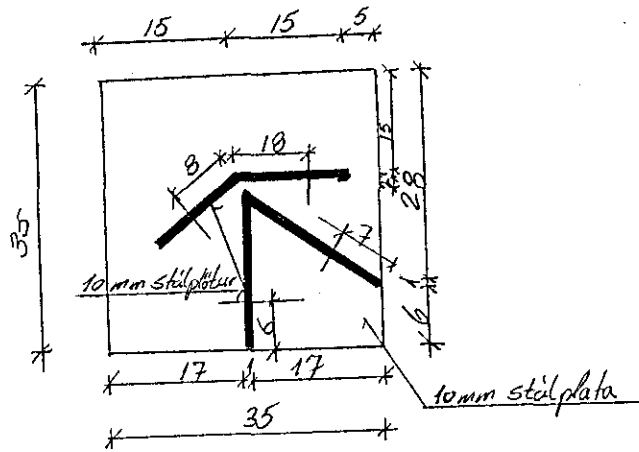

Stálplötuna, sem kemur ofan á 4" rör, skal sjóða við rör á allum hringinn og enn fremur skal sjóða 4 styrkfarvinkla Δ 12x12 cm úr 10mm stáli á plötu og rör. Rör á skal vera undir miðri plötu, en á plötuna skal síðan sjóða, byggja megin, 10mm stálplötu, 33 cm á hæð eins og hér á ofan er sént. A þessar plötur skal bora 20mm göt í 17cm hæð eins og á ofan er sént.

Sérmynd D M. 1:10

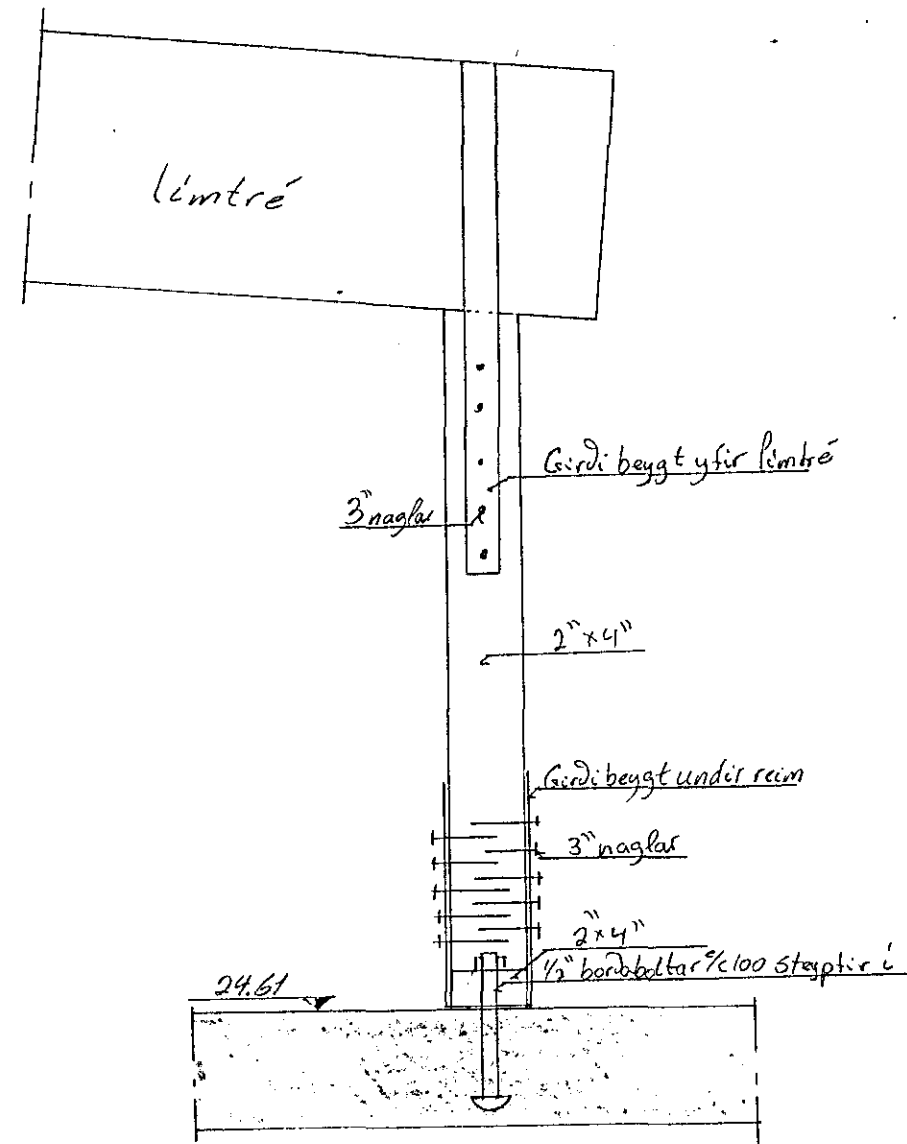

Sérmynd E M. 1:10

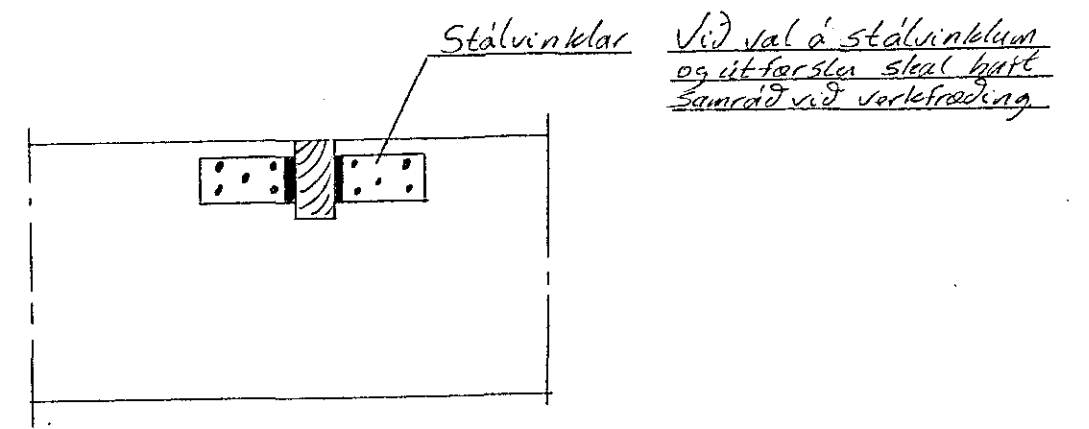

Sérmynd af stöla- og reima festingum M. 1:10

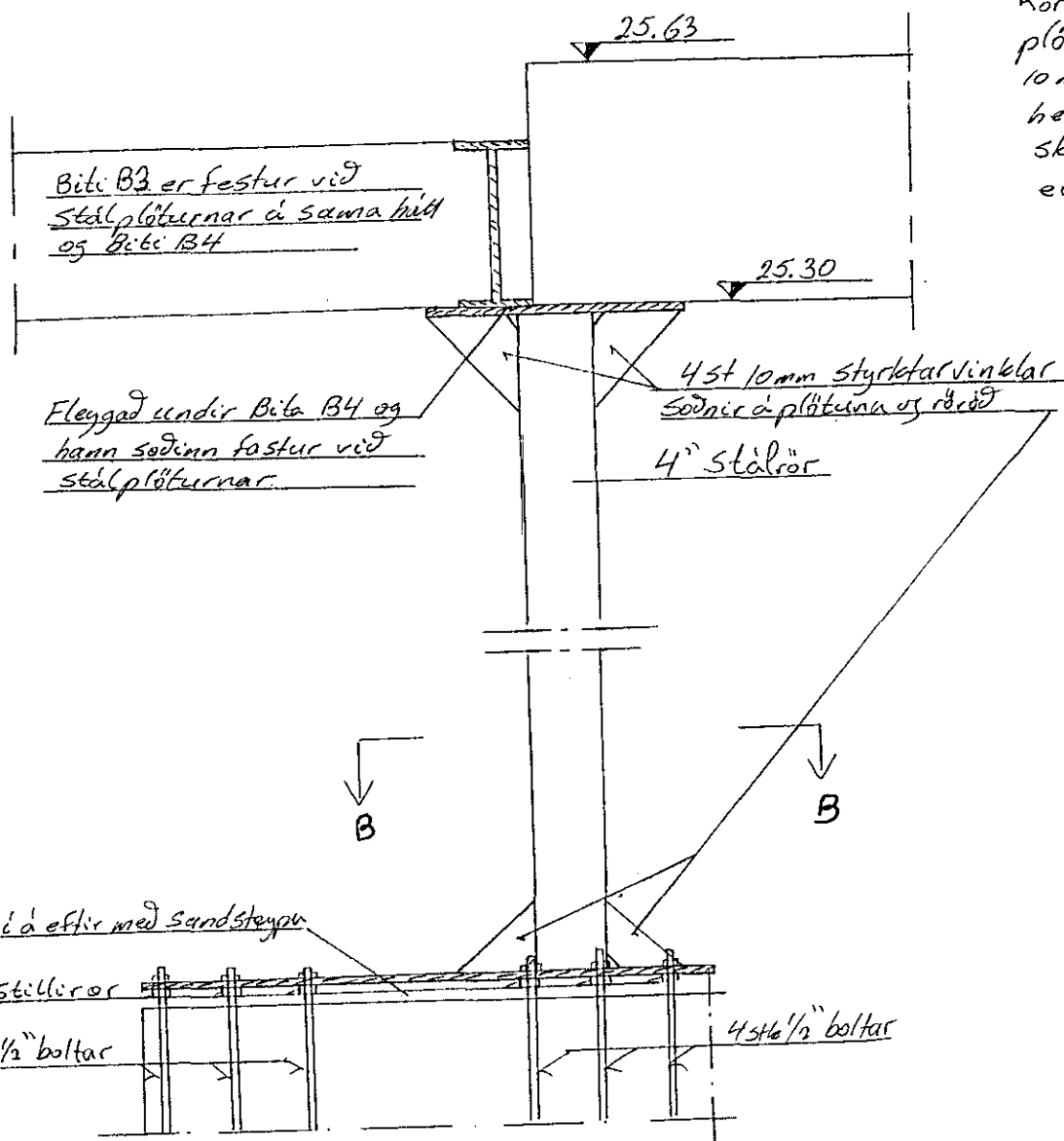
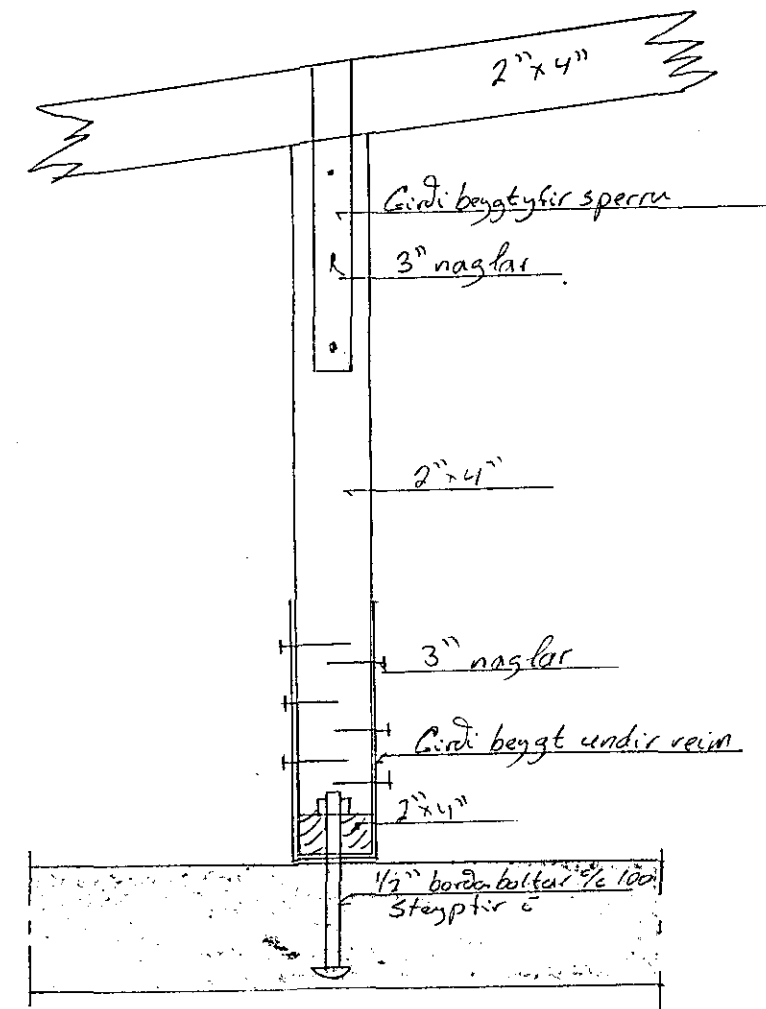

Snið B-B M. 1:10

Sérmyndir B og C M. 1:10

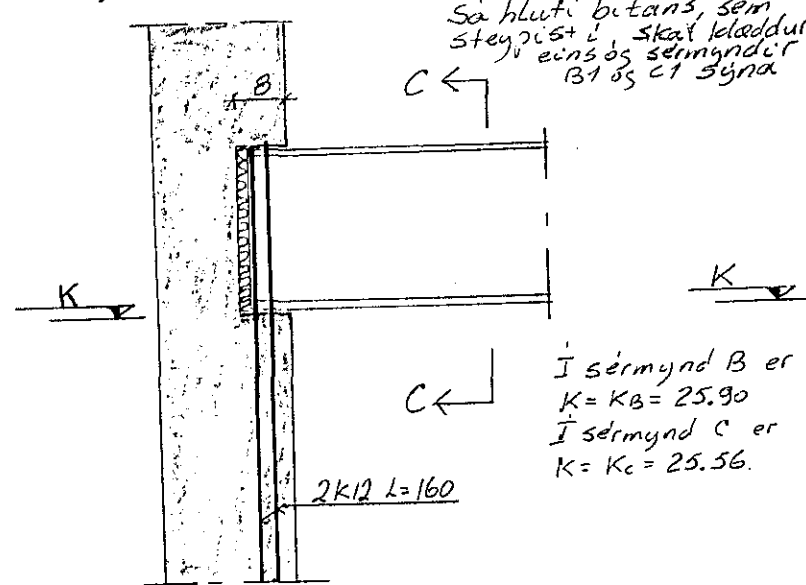

Snið C-C M. 1:10

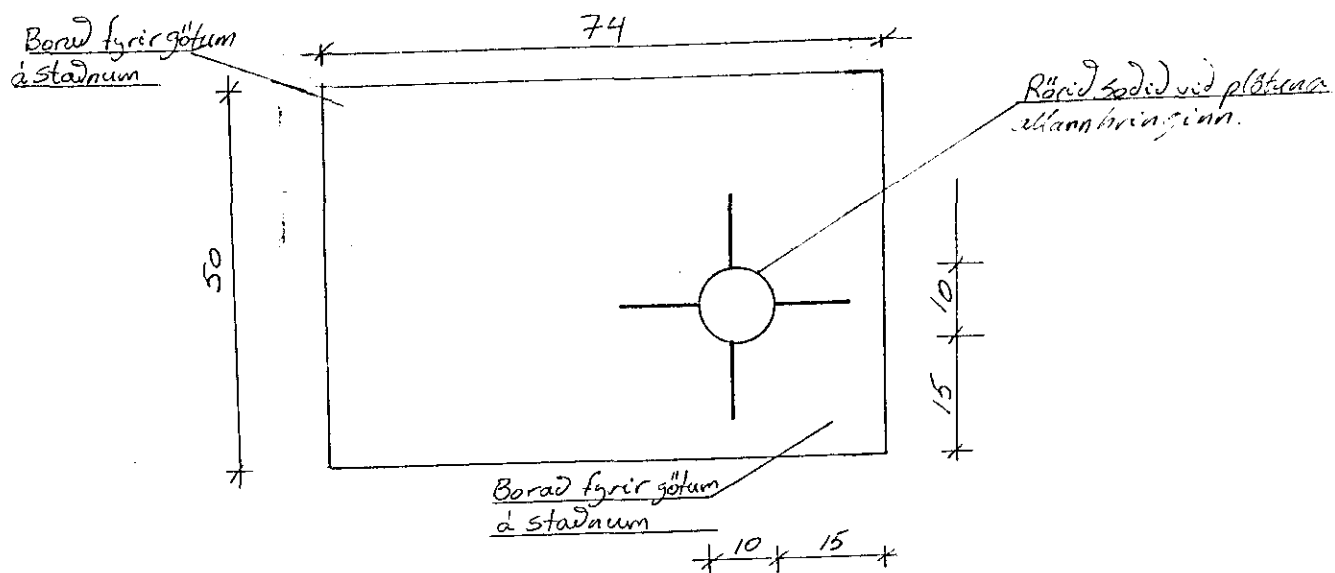
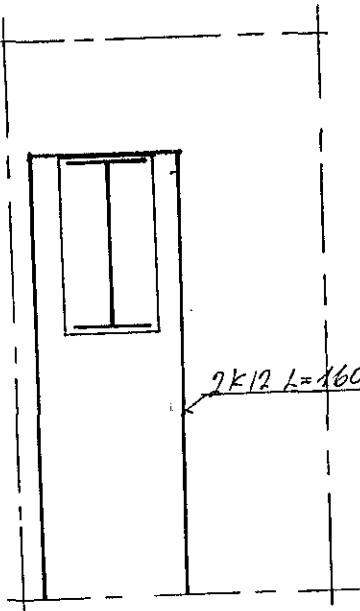

Snið B-B M. 1:10

Sérmyndir B1, C1 M. 1:5

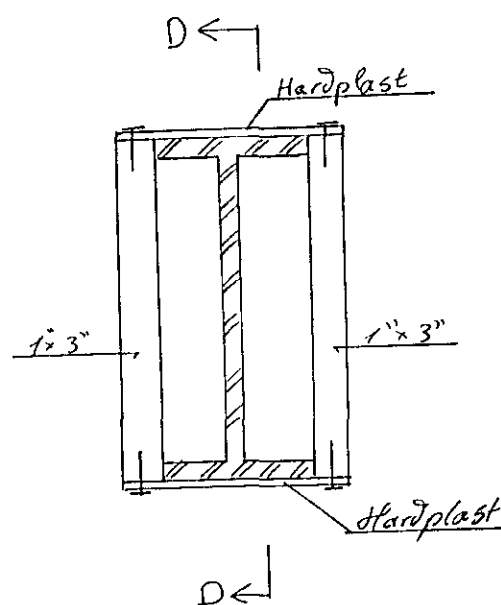

Snið D-D M. 1:5

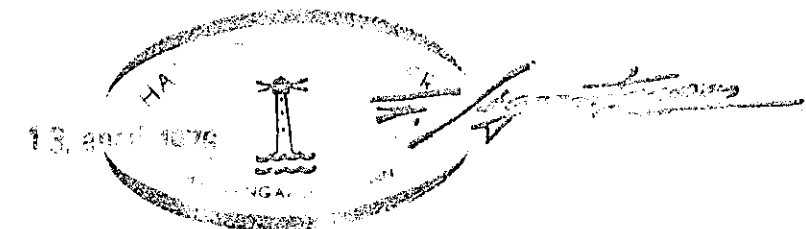
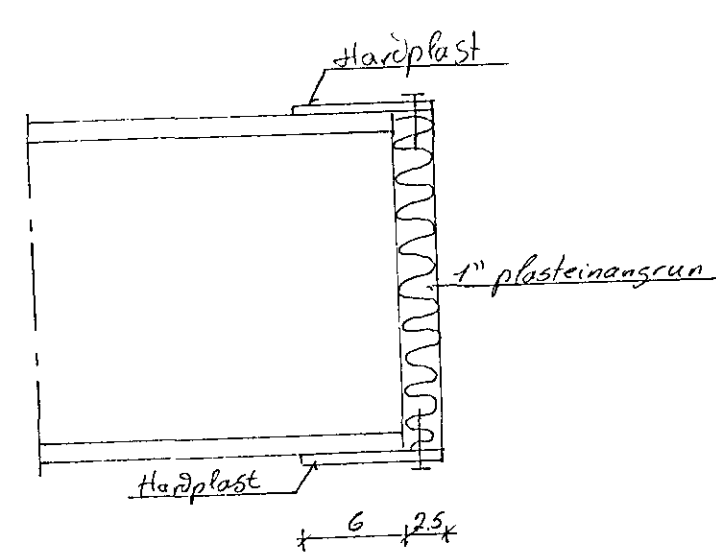

Vesturvangur 35 Hafnarfirði	
M. 1:10	þak
Teikn. GSK	
Dags 6-4-76	
Nr. 08	
Gunnar S. Thorsteinsson M.V.F.I.	