

BITI B.2 1:20.

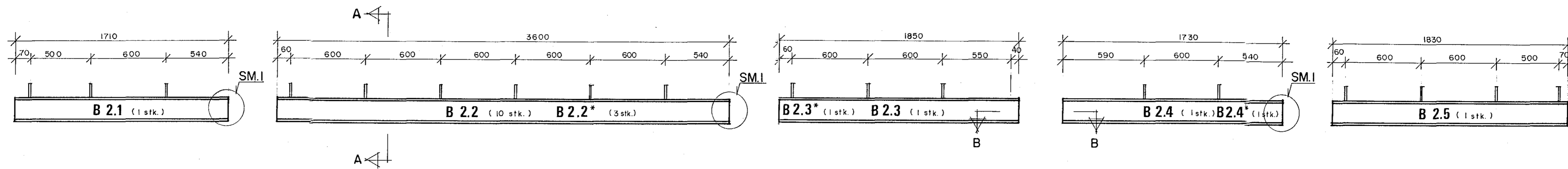

SNID A-A 1:5.

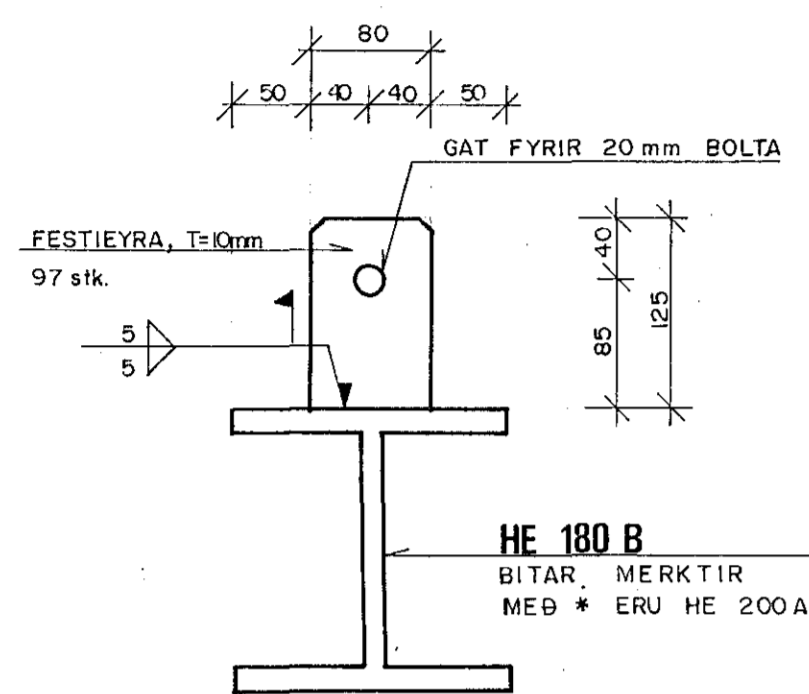

SÉRMYND SM.1 1:5.

SNID I.1-I.1 1:5.

SNID B-B 1:5.

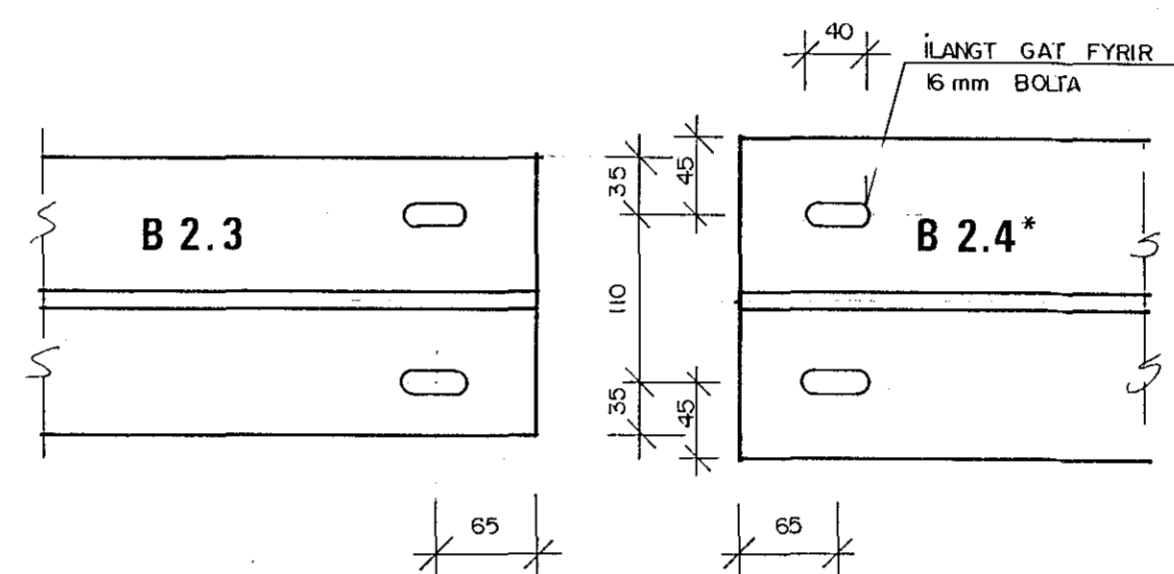
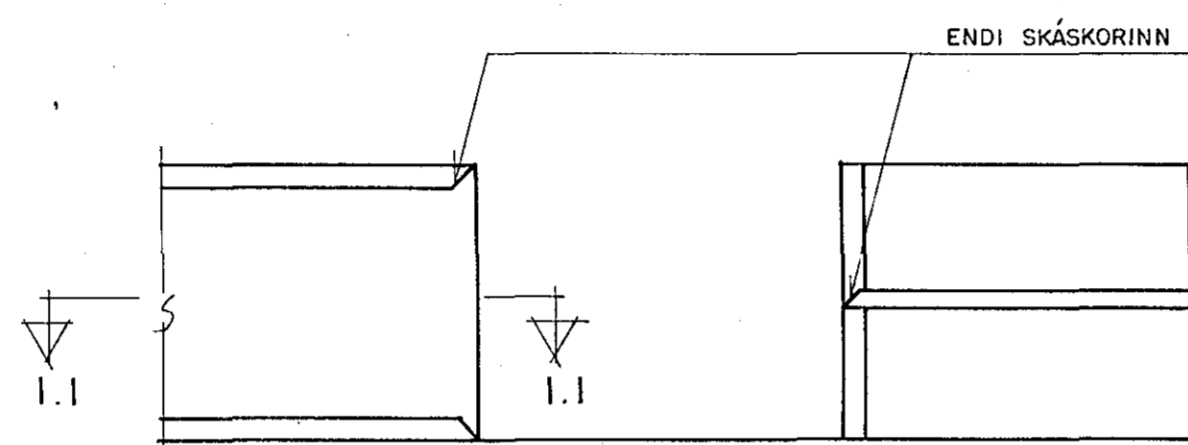

BITI B3

HEITI	LENGD	FJÖLDI	ATH.
B3.1	5000 mm	1 stk.	ANNAR ENDI SKÁSKORINN
B3.2	7000 mm	3 stk.	ANNAR ENDI SKÁSKORINN
B3.3	2900 mm	1 stk.	BÁÐIR ENDAR SLÉTTIR
B3.4	6000 mm	4 stk.	ANNAR ENDI SKÁSKORINN, HINN MEÐ PENSLURAUF
B3.5	2380 mm	1 stk.	BÁÐIR ENDAR SLÉTTIR
B3.6	2400	1 stk.	BÁÐIR ENDAR SLÉTTIR

BITAR B3 ERU IPE 240

~~BITI B.3 1:20.
IPE 240~~

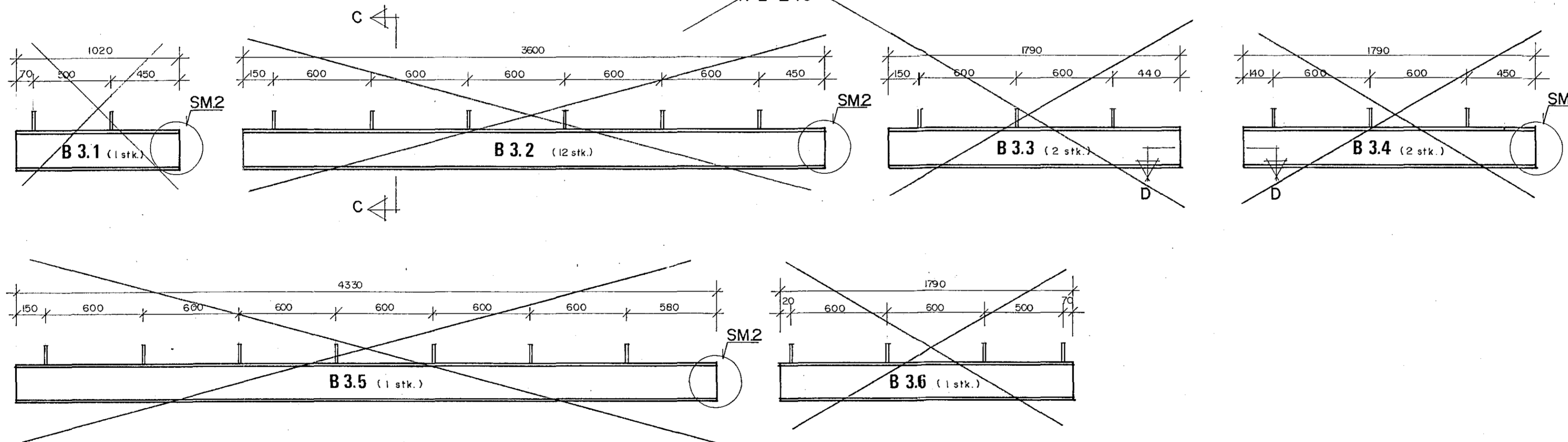

SNID Í B3 1:5.

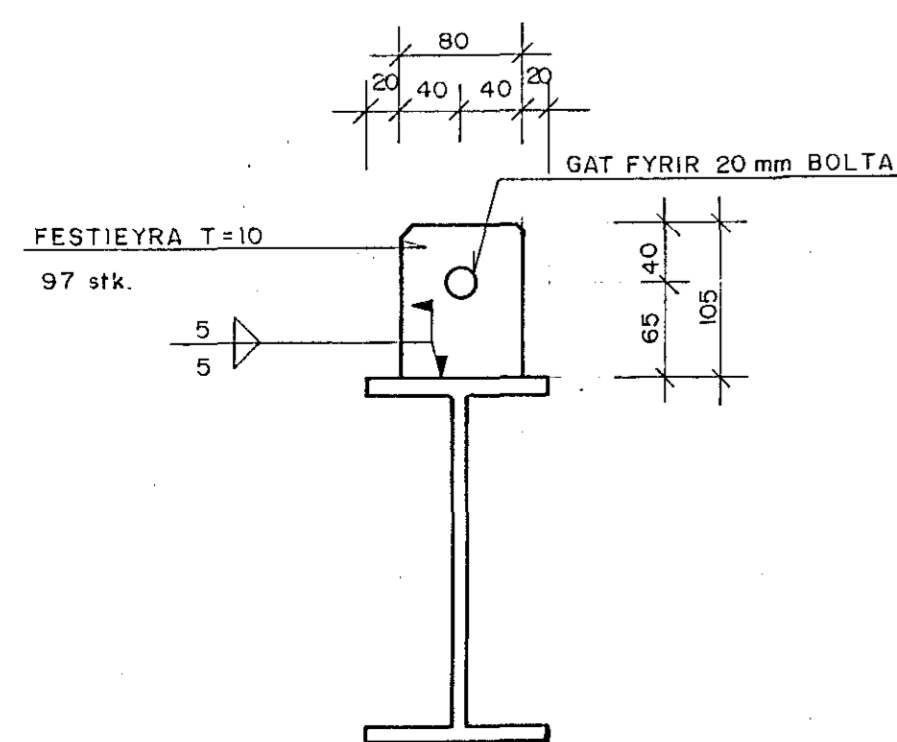

SKÁSKORINN ENDI 1:5.

PENSLURAUF 1:5.

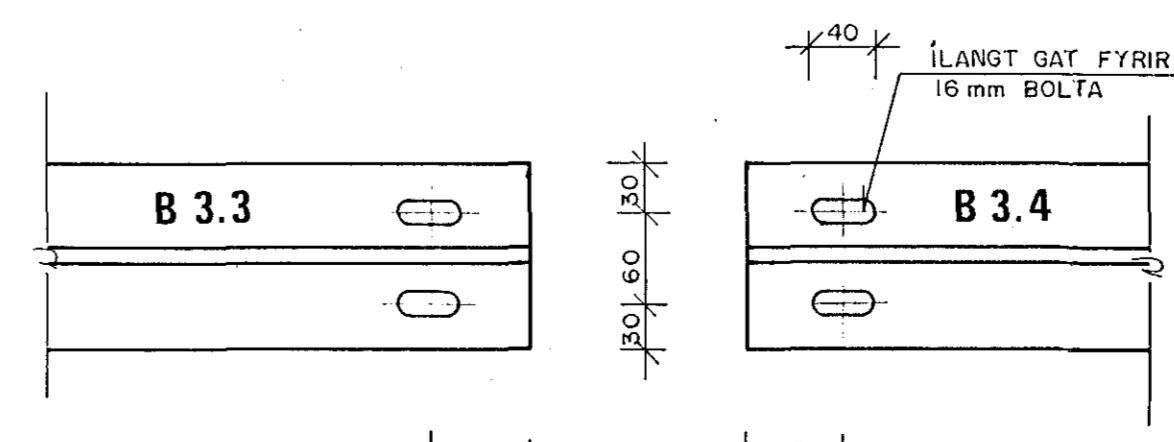
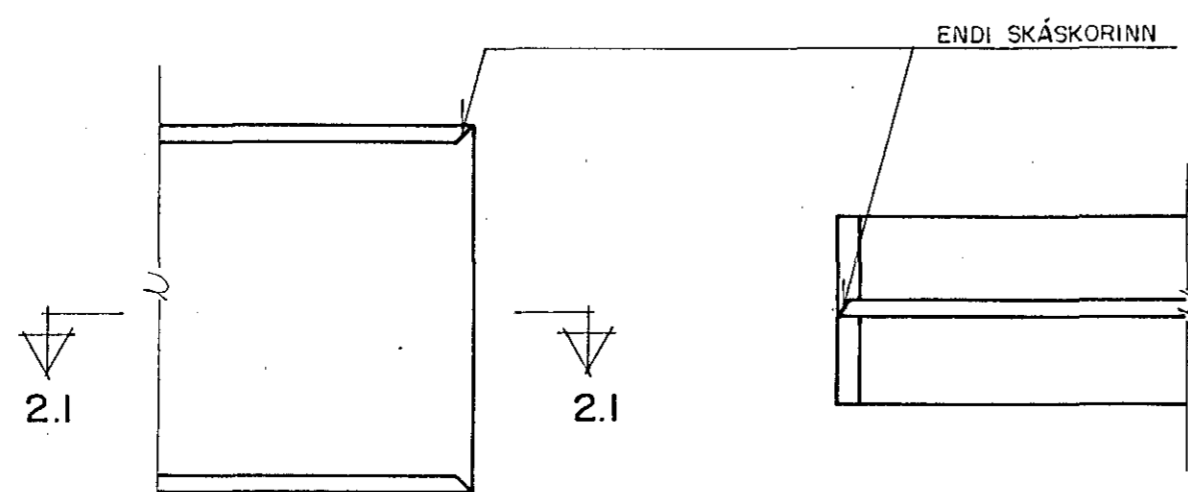

SKÝRINGAR

ÓNEFND MÁL ERU mm.
MÁLSETNING EYRNA Á BITA ER EINUNGIS LEIÐBEINANDI.
BIL MILLI ALLRA SPERRA ÞARF AÐ MÆLA Á STADNUM
OG SJÓÐA EYRU Á STADNUM.

STÁLGÆÐI

ALLT STÁL SÉ ST 37-2 SKV. DIN 17.100

20. Jan. 1988
Stefán Ólafsson

DAS HRAFNISTA HAFNARFIRÐI			
BR.	DAG.	BREYTING	
A	21.11.88	BITI B.3	S.J. G.J.
			5. HÆÐ - STÁLVIRKI SMÍÐATEIKNING BITAR B.2 OG B.3
VERKFRÆÐISTOFA STEFÁNS ÓLAFSSONAR HF. F.R.V. CONSULTING ENGINEERS		REYKJAVÍK, Þ. 7. 10. 85 TEIKN. REIKN. G.G. G.S.J. (G.J.)	KVARDI 1:20, 1:5 VERK BL. NR. BR. 2574 3.106 A
BORGARTÚNI 20 105 REYKJAVÍK SIMI 29940 & 29941		ATH. <i>[Signature]</i>	