

Járn í veggum  $\epsilon 10 \frac{1}{2} 25$  lóðn og lárétt eða stálnet  $\epsilon 189$  (+6% 15#)

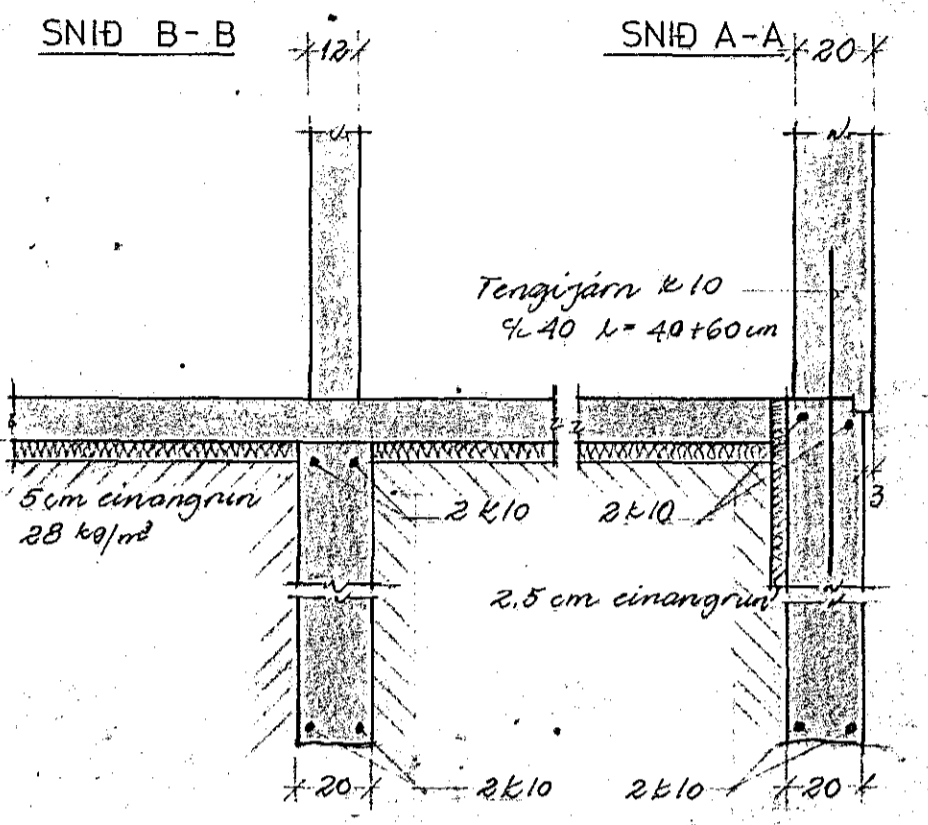

SNID E-E

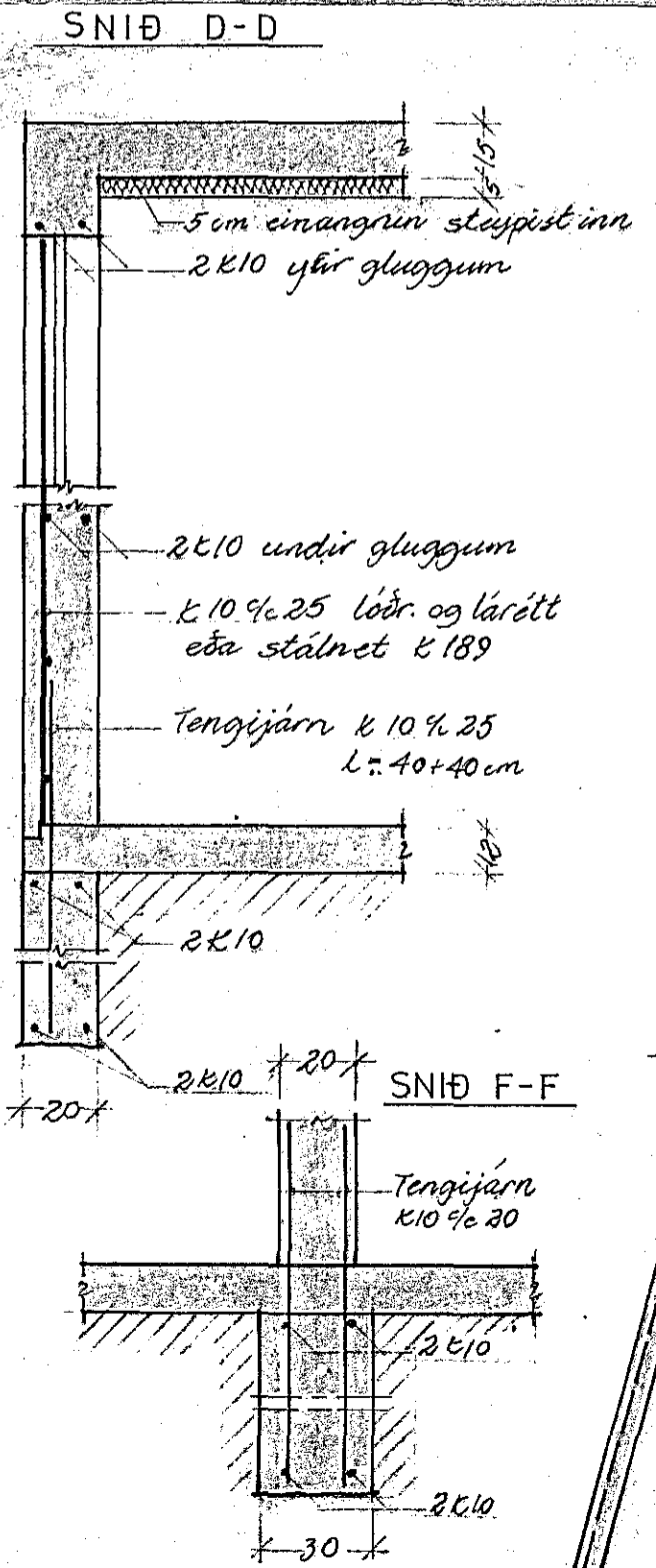
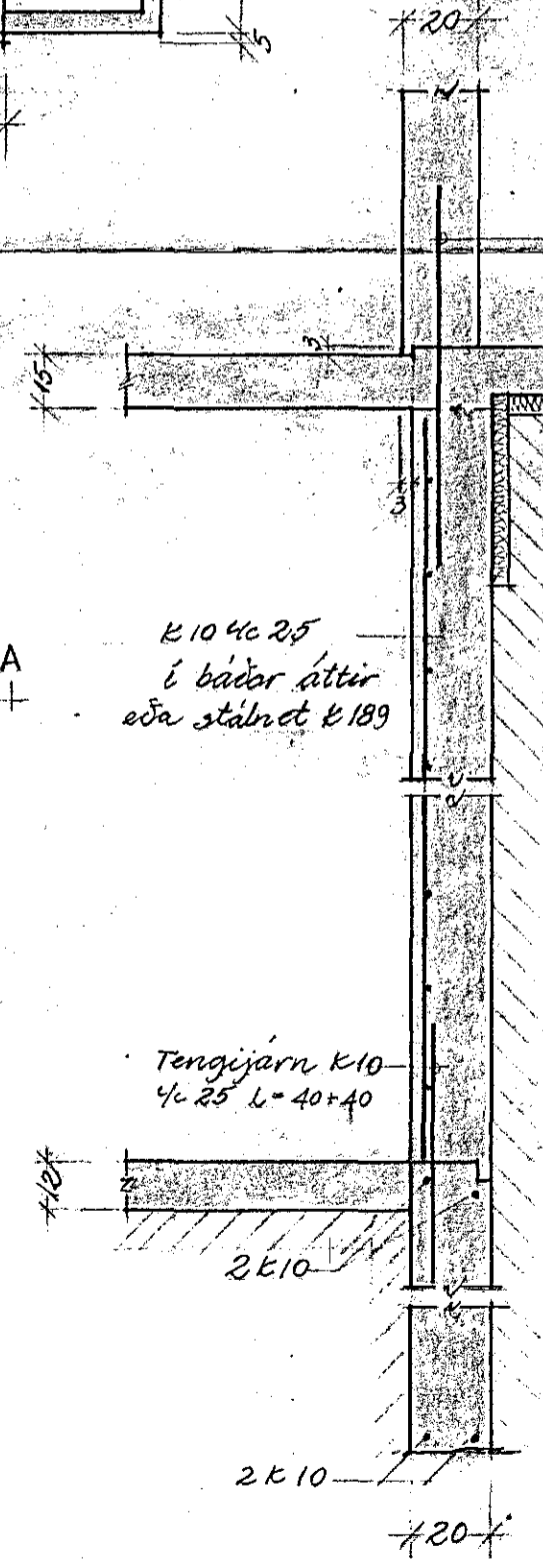

SNID C-C

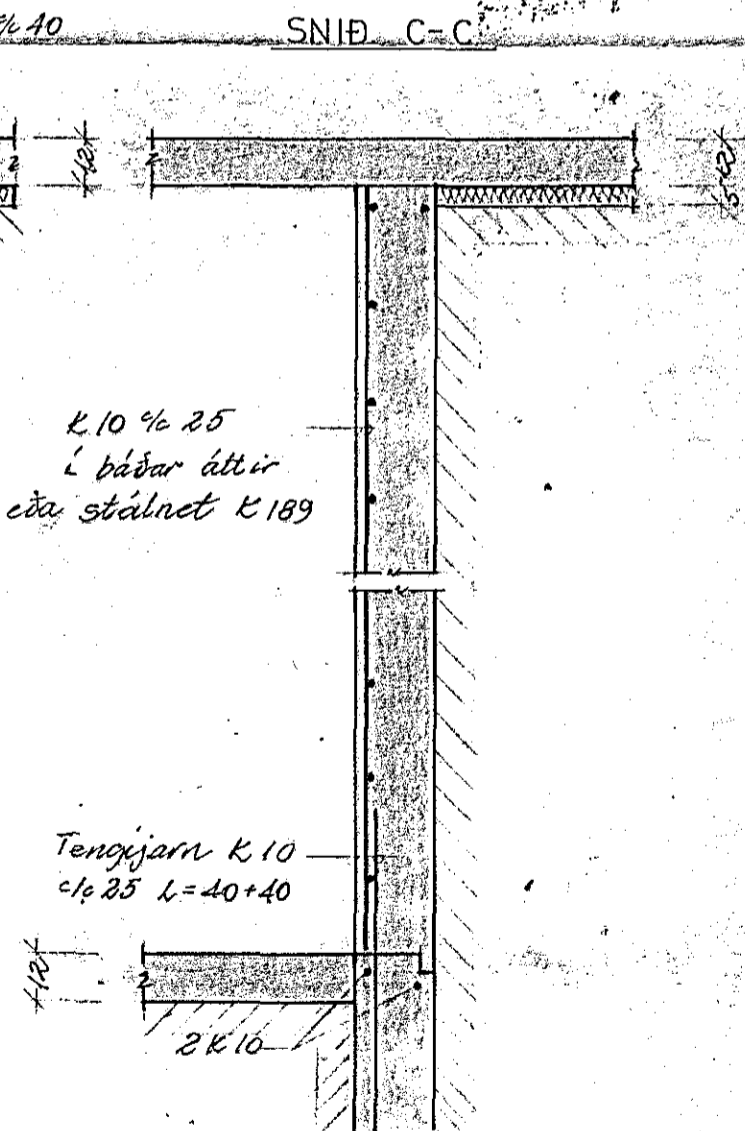

Húsið stendur að mestu á klépp.  
 Mesta álag er 6.0 kg/cm²  
 Steypa 3-160 4-5% loftinnihald  
 Gjallfylling undir botnplötu.

SVEINBJÖRN SIGURÐSSON TÆKNIFR.		
MÍÐVANGI 116	SÍMI 52256	MTFÍ
SÆVANGUR 15	MKV. 1:50	DAGSETN. 9.9.79
	1:20	
UNDIRSTÖÐUR	BREYTING	DAGS.
	HANNAÐ	DREGIÐ
Sveinbjörn Sigurðsson		7904-1