

SMARAHVAMMUR 2 Hafnarfirði

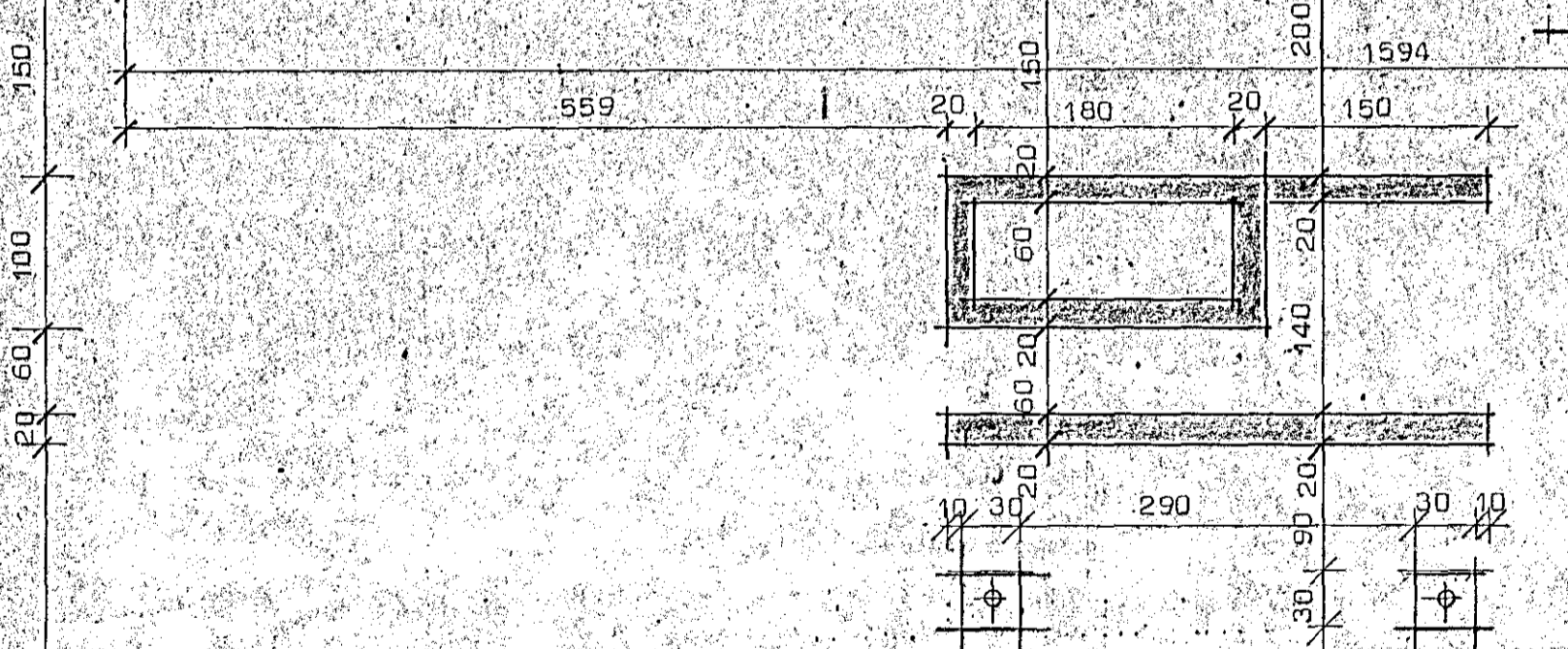

Grafa skal fyrir undirstöðuveggjum niður á fastan botn og hreinsa vel undan veggjum áður en mót eru smíðuð.
 Grafa skal allan lausan jarðveg úr grunni og fylla í staðinn með moldarlausri mál, þjappa hana í 30 cm þykkum lögum með titrarþjöppu og vata hvert lag áður en þjöppun hefst.
 Bendistál er kambstál K640 auðkennt með K.
 Steypa er 8200 skv 18T 10.

Reiknað er með að í botni sé klöpp eða mólhella.

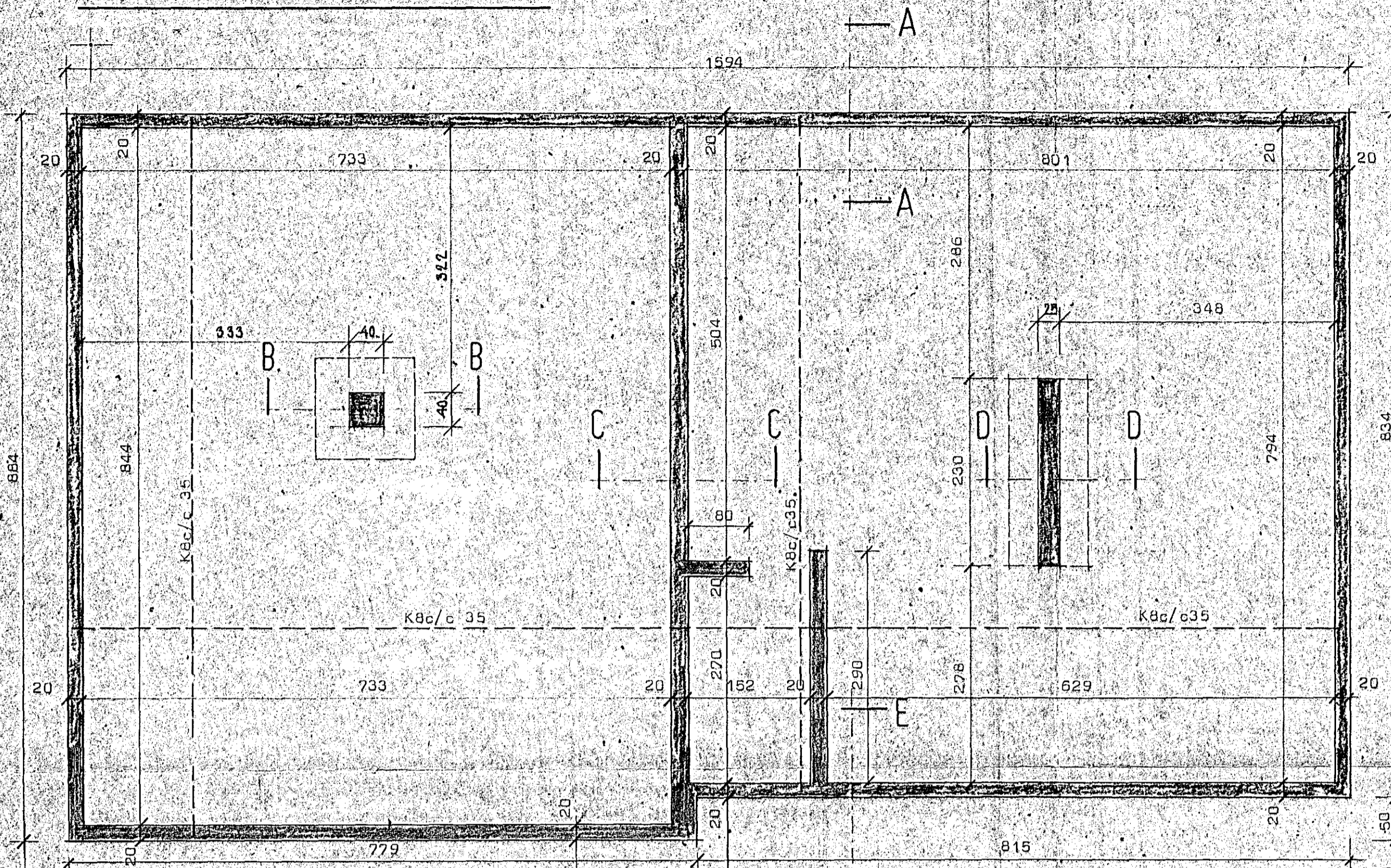
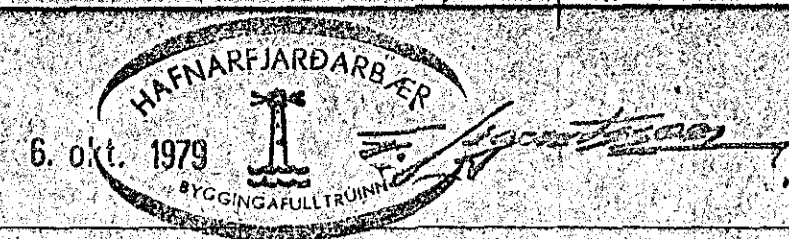
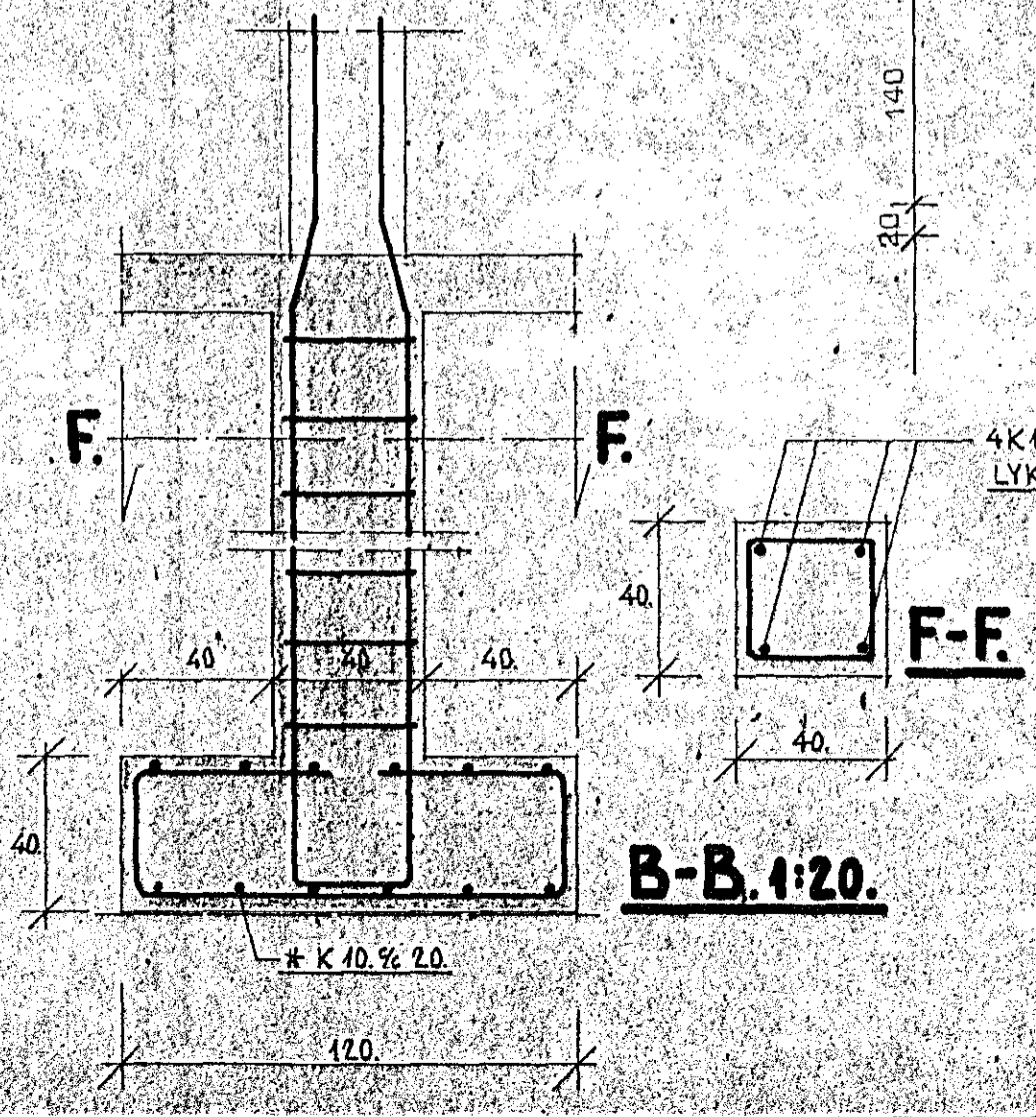
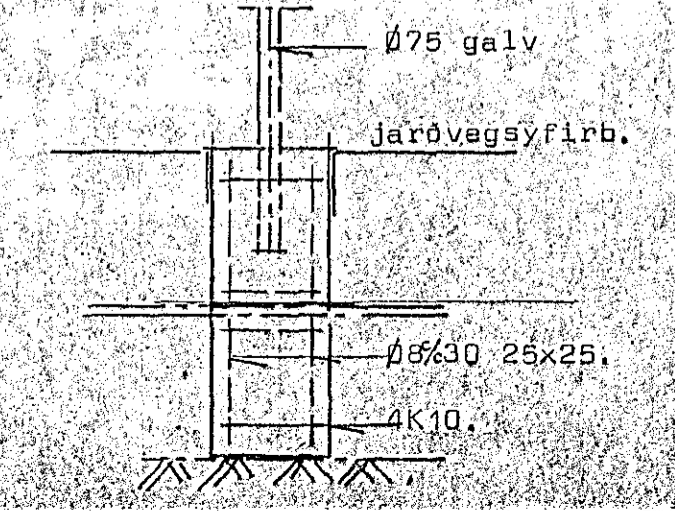

4K16
LYKKJUR +8% 20

F-F

B-B. 1:20.

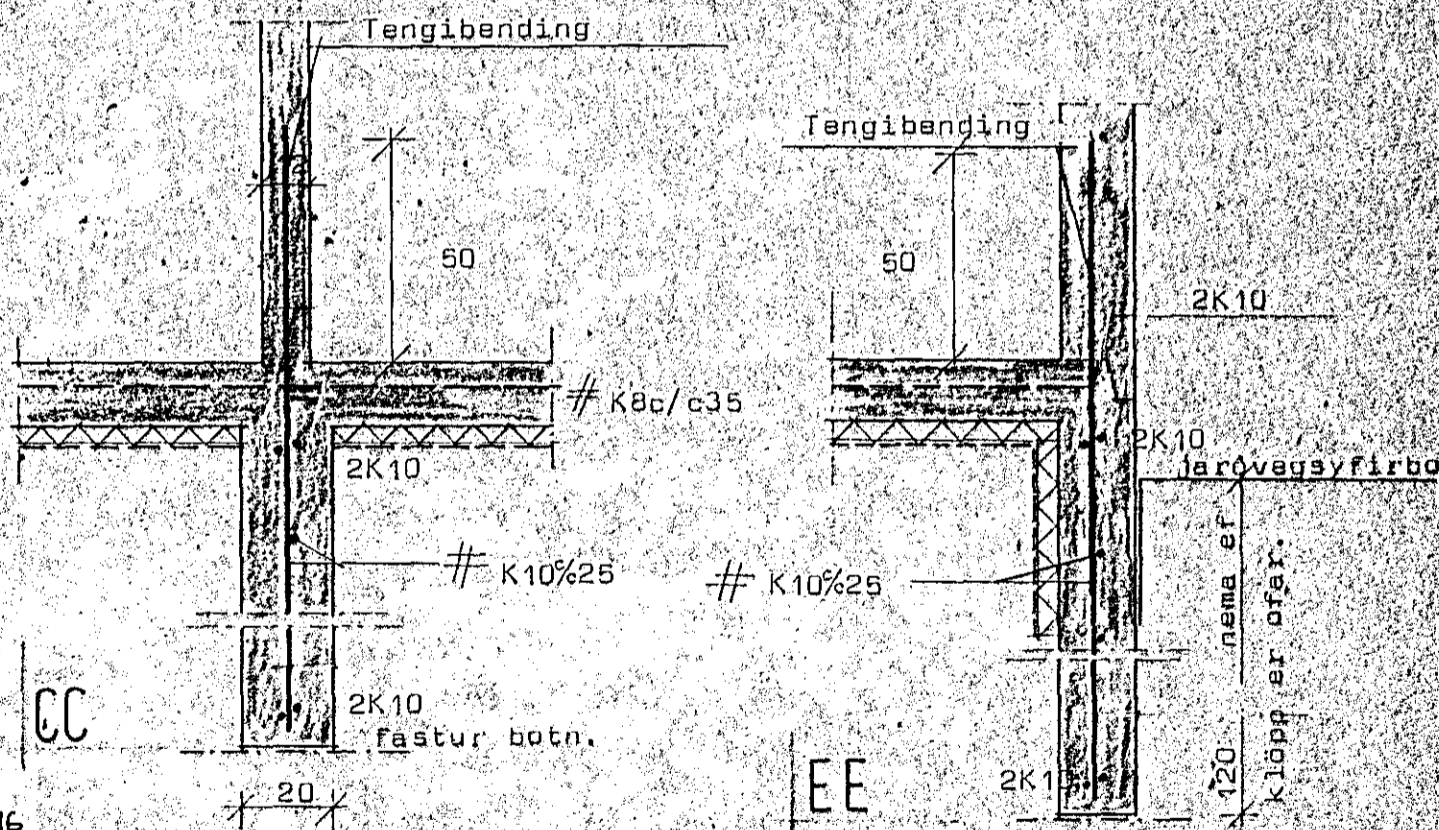
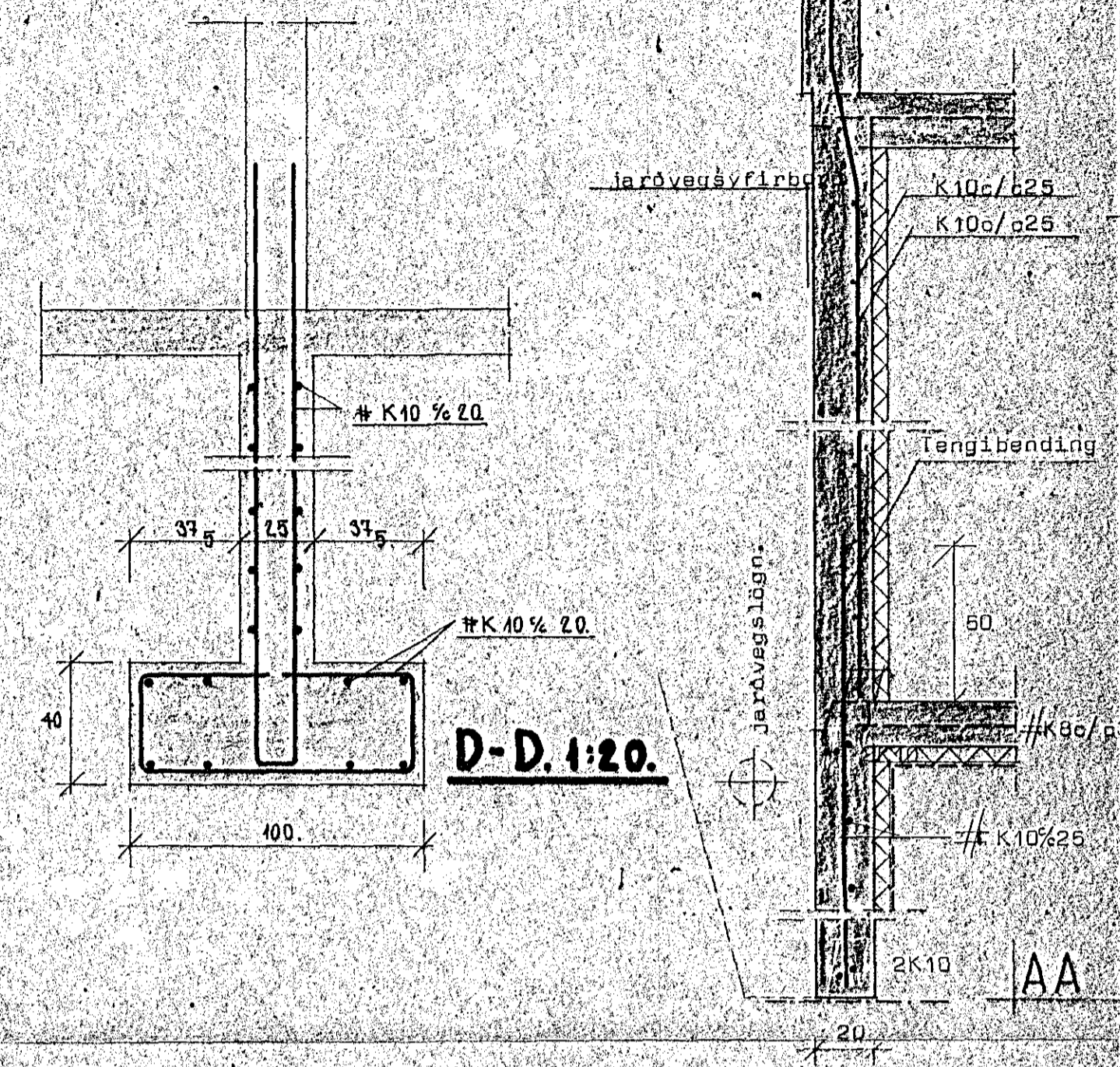

2K10
fastur botn.

CC

EE

EE

EE

EE

EE

STADALHÚS S.F.
 TEIKNISTOFA SIDUMOLA 31 sími 83141

VERKEFNI	DAGS.	1979	VERK NR
Undirstöður.	MKV.	1:50 1:20	H1
Smarahvammur 2 Hafnarfirði	BR.		
	BLAD NR	2.01	

SIGURDUR GUDMUNDSSON, SIGURDUR P. KRISTJANSSON EFTI.