

1:100

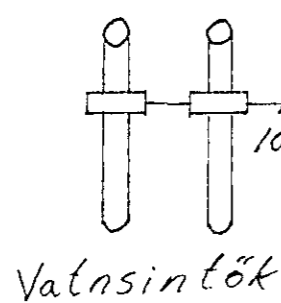

Vatnsintök

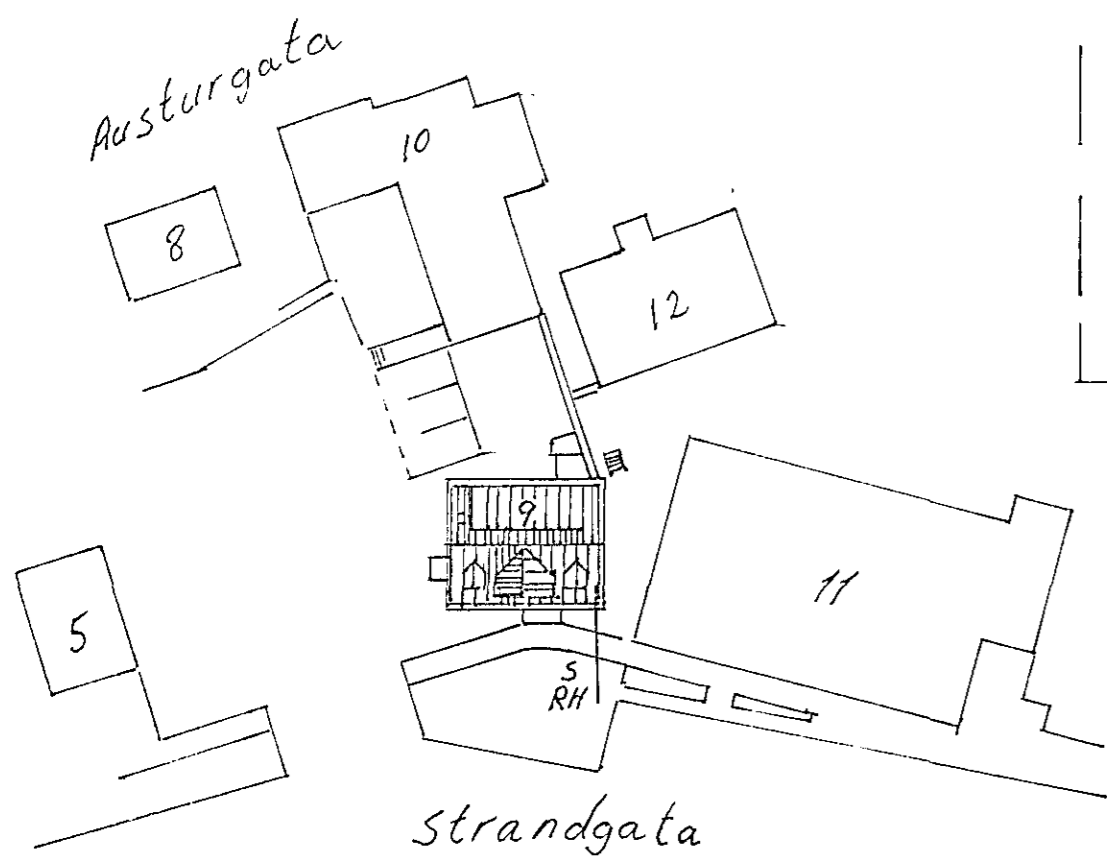

Strandgata

1:500

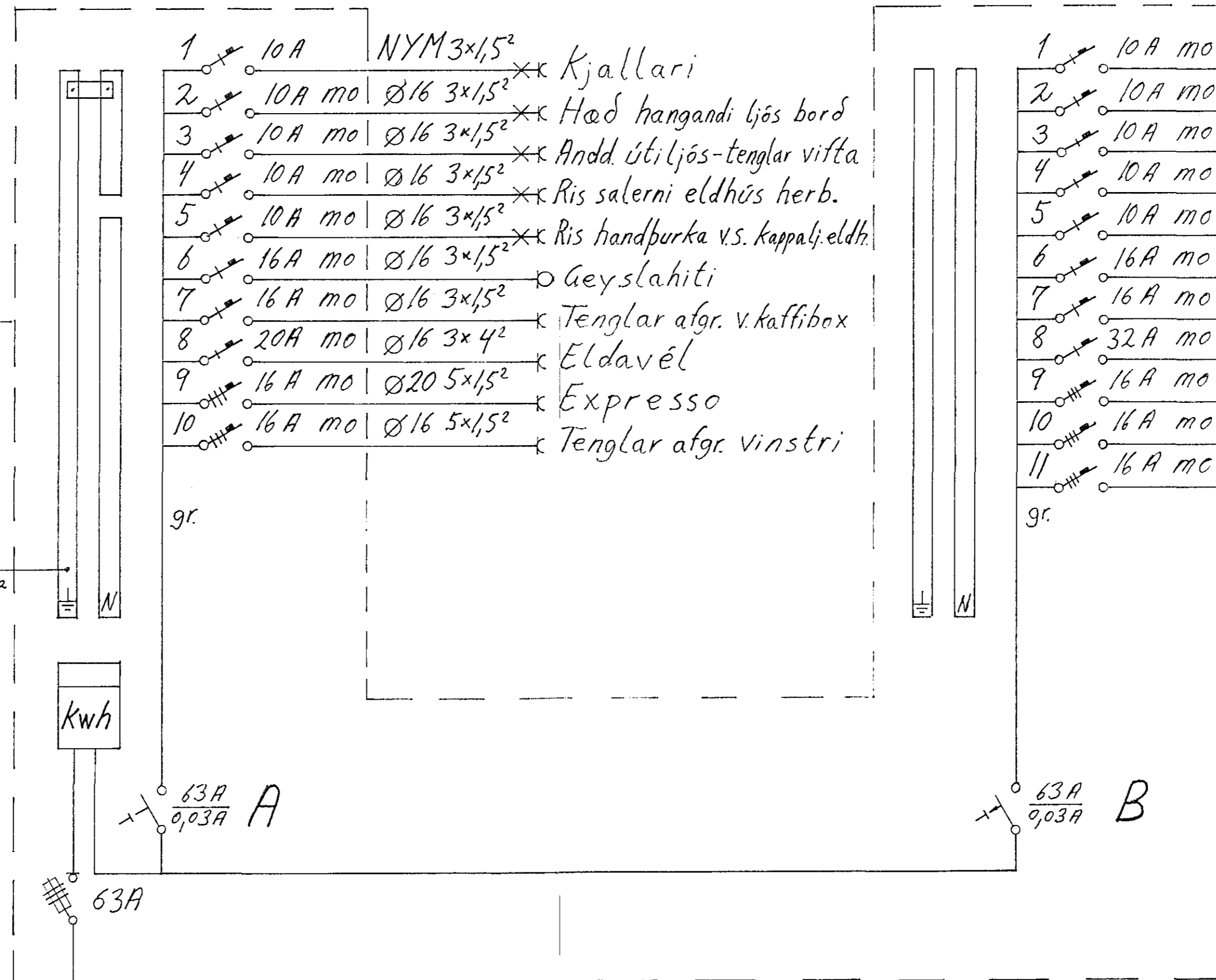

- 1 10A NYM 3x1,5<sup>2</sup> x Kjallari
- 2 10A mo Ø16 3x1,5<sup>2</sup> x Hæð hangandi ljós borð
- 3 10A mo Ø16 3x1,5<sup>2</sup> x Andd. útiljós-tenglar vifta
- 4 10A mo Ø16 3x1,5<sup>2</sup> x Ris salerni eldhús herb.
- 5 10A mo Ø16 3x1,5<sup>2</sup> x Ris handþurka v.s. kappalj. eldh.
- 6 16A mo Ø16 3x1,5<sup>2</sup> x Geyslahti
- 7 16A mo Ø16 3x1,5<sup>2</sup> x Tenglar afgr. v. kaffibox
- 8 20A mo Ø16 3x4<sup>2</sup> x Eldavél
- 9 16A mo Ø20 5x1,5<sup>2</sup> x Espresso
- 10 16A mo Ø16 5x1,5<sup>2</sup> x Tenglar afgr. vinstri

gr.

- 1 10A mo Ø16 3x1,5<sup>2</sup> x Kj. lj.v. töflu stigagangur
- 2 10A mo Ø16 3x1,5<sup>2</sup> x Hæð lj.v. kaffirist miðja
- 3 10A mo Ø16 3x1,5<sup>2</sup> x Hæð innfeld halogenljós afgr.
- 4 10A mo Ø16 3x1,5<sup>2</sup> x Ris skrifstofa setustofa
- 5 10A mo Ø16 3x1,5<sup>2</sup> x Ris handþurka v.s. litla
- 6 16A mo Ø16 3x1,5<sup>2</sup> x Kaffirist
- 7 16A mo Ø16 3x1,5<sup>2</sup> x Vara
- 8 32A mo Ø20 3x6<sup>2</sup> x Ris kaffivél herb.
- 9 16A mo Ø16 5x1,5<sup>2</sup> x Uppvottavél
- 10 16A mo Ø16 5x1,5<sup>2</sup> x Tenglar afgr. miðja
- 11 16A mo Ø16 5x1,5<sup>2</sup> x Tenglar kjalir afgr. hægri

gr.

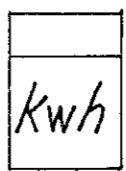

63A / 0,03A A

63A / 0,03A B

63A

Intakskassi

Intak RH  
400/230V

Strandgata 9 Hafnarfirdi			
Snid afstöðumynd einlínnumynd	Kvardi	1:100	1:500
Eiríkur Rúnar Þorvarðarson lögilltur rafverktaki v.s. 653245 H.S. 651245 B.ö. 984-58543	Blað	2af2	
Hannas - Einir Rúnar Þorvarðarson	Neysluv.	Rafv. Hafnarf.	Dags 6-9-94
Nr. Breyting	Dags br.		