

GRUNNMYND - 1. HÆÐ

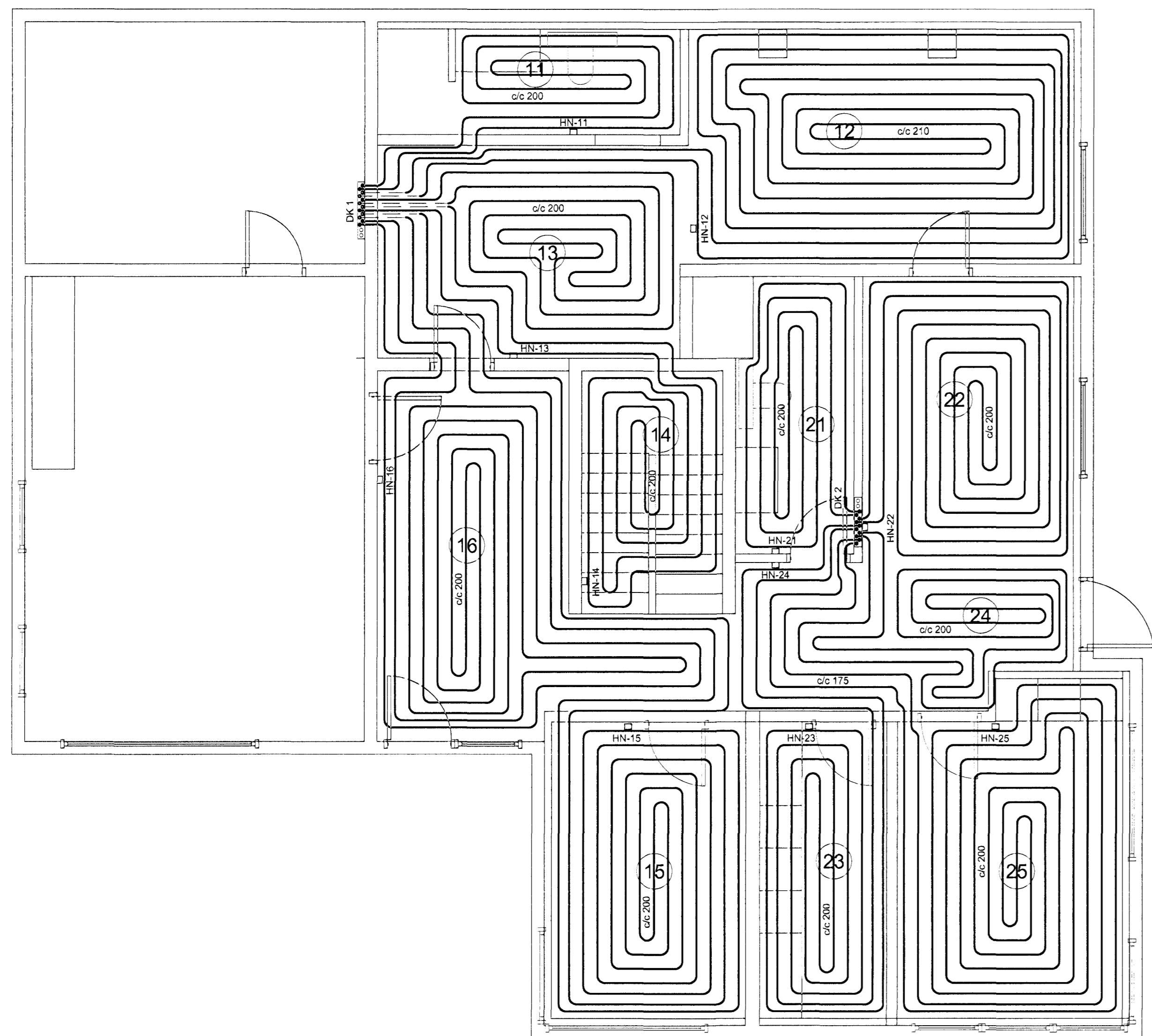

GRUNNMYND - 2. HÆÐ

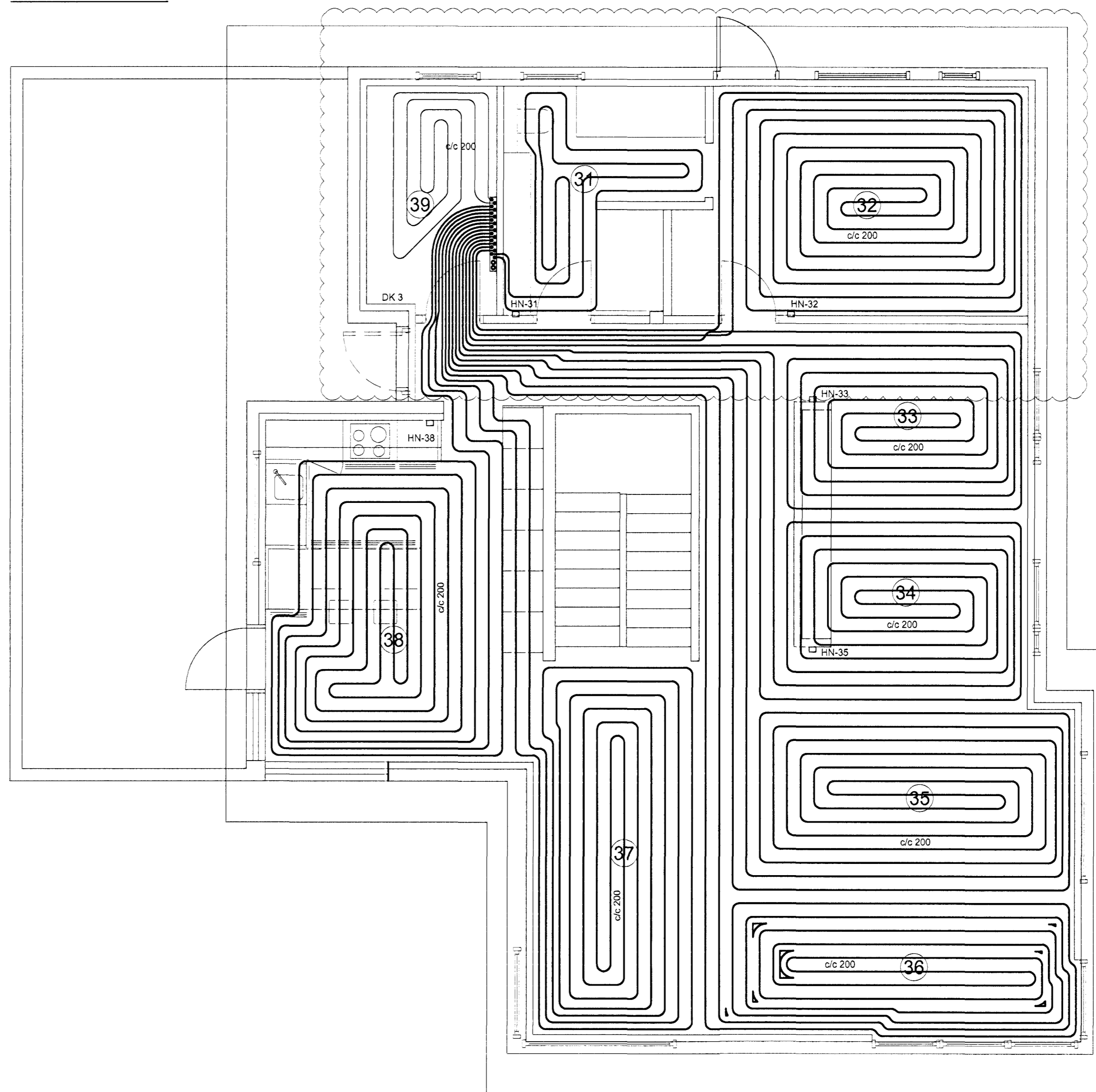

TILVÍSANIR:
ALMENNAR SKÝRINGAR SJÁ BL. NR. L1-A-1

B	19.09.11	GÖLFHITA BREYTT SAMKV. BREYTTUM INNRETTINGUM	KH	PH
A	02.07.08	GÖLFHITI FJARLEGGUÐUR UR STURTKULEFUM	DAG	DAG
BR	DAGS	BREYTING	REIKN	TEIKN

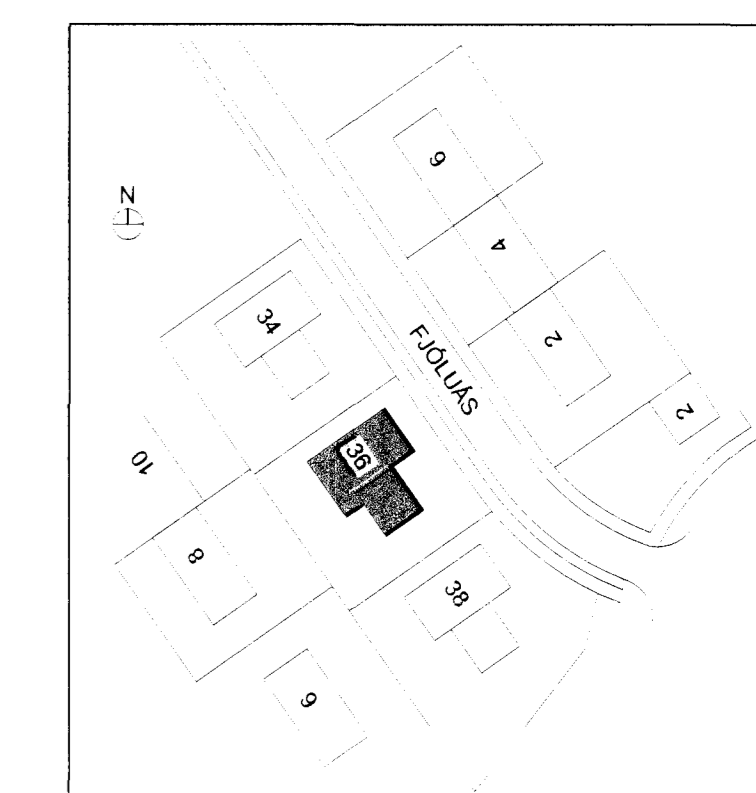

SM1 GÖLFHITALAGNIR 1. HÆÐ 1:10
DÆMIGERT ÞVERSNIÐ

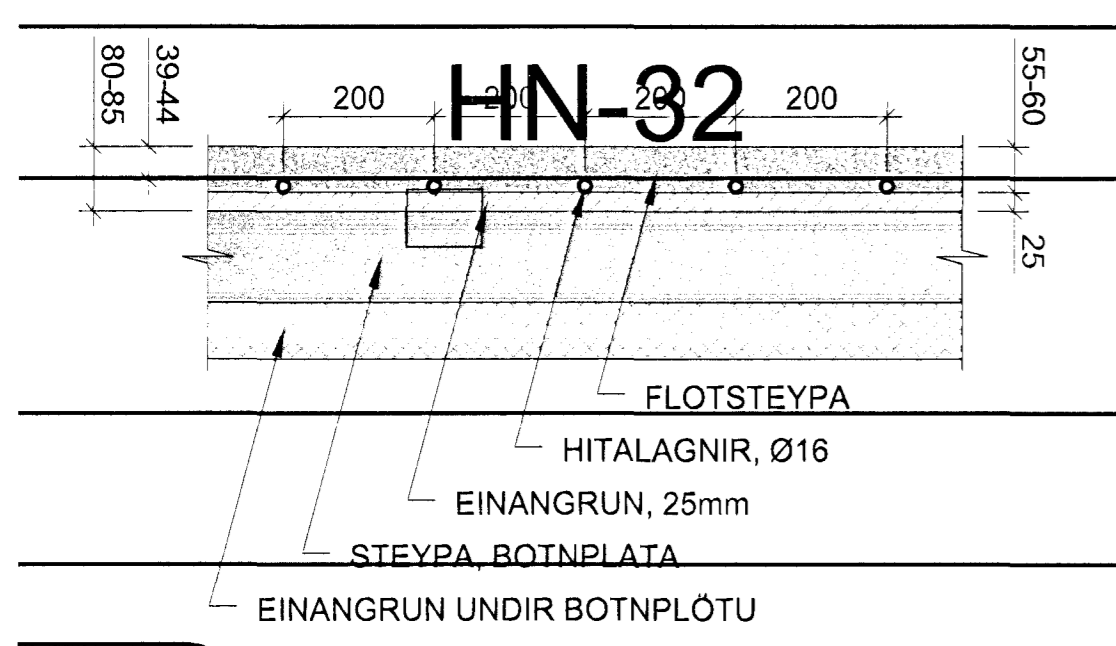

GÖLFHITALAGNIR, DREIFIKISTA 1

SLAUFNA NR	AFKÖST W	MILLIBIL cm	ÞVERMÁL mm	LENGD m	RENNSLI l/s	MÓTOR LOKI	HITA NEMI
11	300	20,0	16	29	0,007	ML 11	HN 11
12	880	20,0	16	101	0,021	ML 12	HN 12
13	420	20,0	16	36	0,010	ML 13	HN 13
14	500	20,0	16	44	0,012	ML 14	HN 14
15	760	20,0	16	87	0,018	ML 15	HN 15
16	1.000	20,0	16	75	0,024	ML 16	HN 16
		3.860		380	0,092		

GÖLFHITALAGNIR, DREIFIKISTA 2

SLAUFNA NR	AFKÖST W	MILLIBIL cm	ÞVERMÁL mm	LENGD m	RENNSLI l/s	MÓTOR LOKI	HITA NEMI
21	300	20,0	16	30	0,007	ML 21	HN 21
22	620	20,0	16	62	0,015	ML 22	HN 22
23	300	20,0	16	54	0,007	ML 23	HN 23
24	660	20,0	16	34	0,016	ML 24	HN 24
25	1.130	20,0	16	83	0,027	ML 25	HN 25
		3.010		263	0,072		

SM2 GÖLFHITALAGNIR 2. HÆÐ 1:10
DÆMIGERT ÞVERSNIÐ

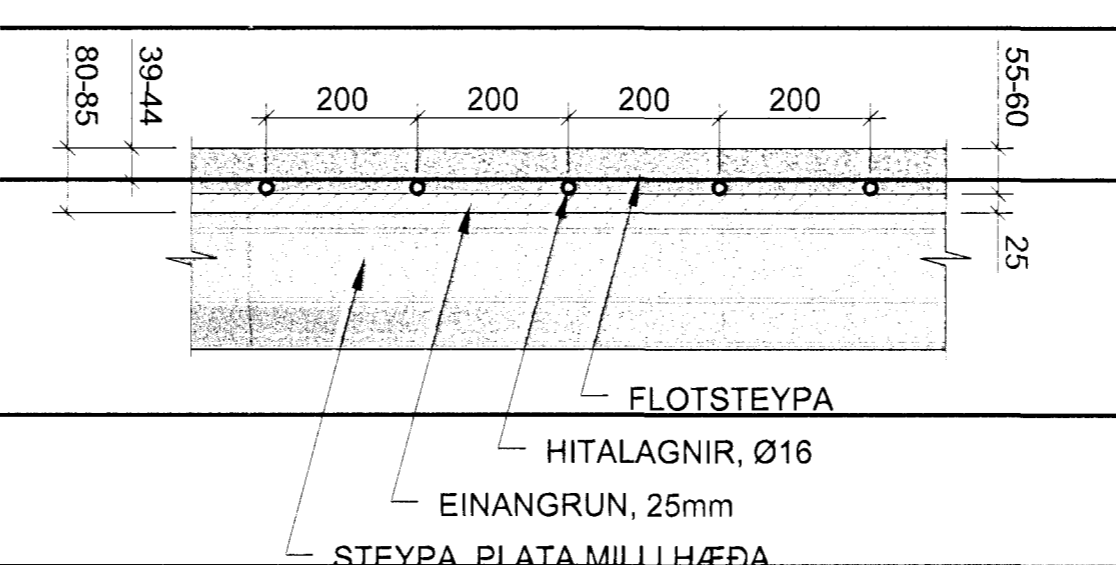

GÖLFHITALAGNIR, DREIFIKISTA 3

SLAUFNA NR	AFKÖST W	MILLIBIL cm	ÞVERMÁL mm	LENGD m	RENNSLI l/s	MÓTOR LOKI	HITA NEMI
31	950	20,0	16	74	0,023	ML 31	HN 31
32	1.240	20,0	16	103	0,030	ML 32	HN 32
33	620	20,0	16	63	0,015	ML 33	HN 33
34	680	20,0	16	73	0,016	ML 34	HN 33
35	1.420	20,0	16	94	0,034	ML 35	HN 35
36	1.410	20,0	16	93	0,034	ML 36	HN 35
37	1.390	20,0	16	92	0,033	ML 37	HN 35
38	1.900	20,0	16	89	0,045	ML 38	HN 38
		9.610		681	0,230		

SKÝRINGAR VIÐ GÖLFHITALÖGN:

- GÖLFHITALÖGN
- - - - - EINANGRUN GÖLFHITALÖGN
- HITANEMI Á VEGG

VSÓ RÁÐGJÖF

BORGARTÚN 23, 103 REYKJAVÍK, SM 355-9000, SMIRNÉF 565-8010, NETTANG 565-8018

FJÓLUÁS 36 - HAFNARFIRÐI

HITAKERFI	HANNADTEIKN	DAGI	DAGI
GÖLFHITI	YFRFARIS		
1.-2. HÆÐ	SAMÞYKKT		
GRUNNMYND	KT	300857-0909	
KVARNI: A1/1:50	REYKJAVÍK	02.04.2008	BR
VERUR:	TEIKN NR		
07159	L4-G1-1		B