

- gr.1. 3x1,5 Bilskúr.
- gr.2. 3x1,5 Anddyri + vs.
- gr.3. 3x1,5 Borðstofa.
- gr.4. 3x1,5 Stofa.
- gr.5. 3x1,5 Eldhús.
- gr.6. 3x1,5 Þvottahús + hjónaherbergi.
- gr.7. 3x1,5 Gangur + sjónvarpshol.
- gr.8. 3x1,5 Barnaherbergi.
- gr.9. 3x1,5 Baðherbergi + vinnuherbergi.
- gr.10. 3x1,5 Uppþvottavél.
- gr.11. 3x1,5 Ofn.
- gr.12. 3x1,5 Örbylgjuofn.
- gr.13. 3x1,5 Tenglar í eldhús.
- gr.14. 3x1,5 Tenglar í bilskúr.
- gr.15. 3x1,5 Tenglar í bilskúr.
- gr.16. 3x4 Helluborð.
- gr.17. 3x1,5 Þvottavél.
- gr.18. 3x1,5 Þurrkari.

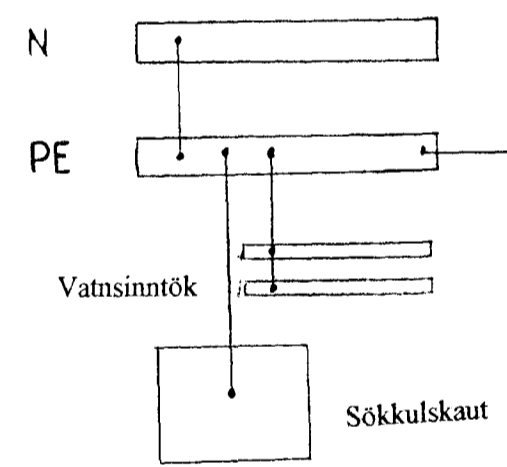

Að baðkari og sturtubotni 6

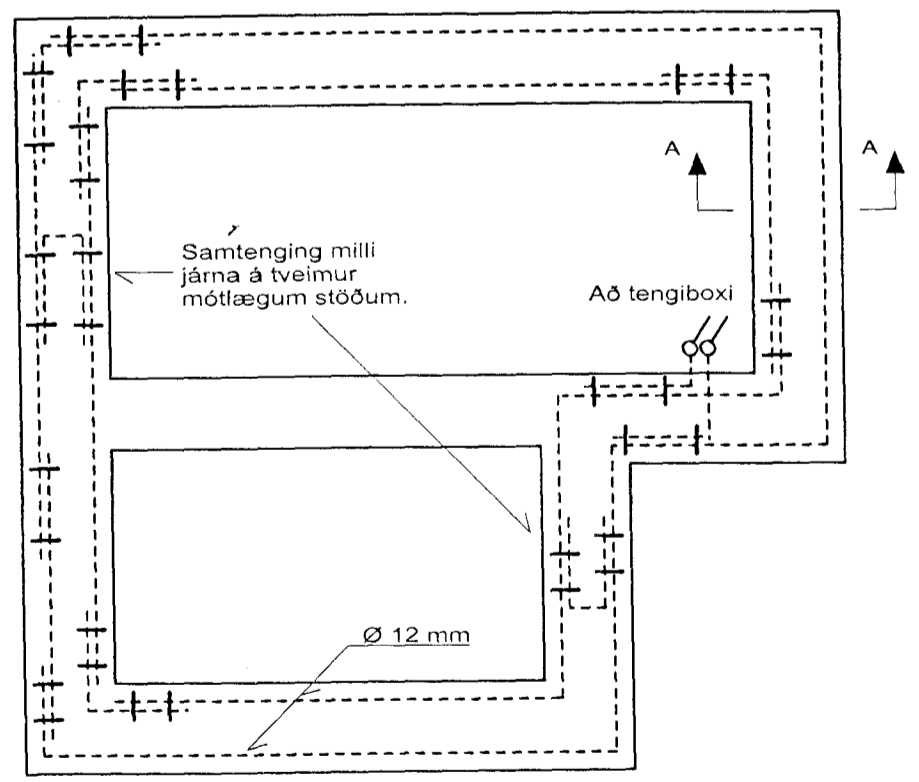

GRUNNMYND SÖKKULVEGGJA

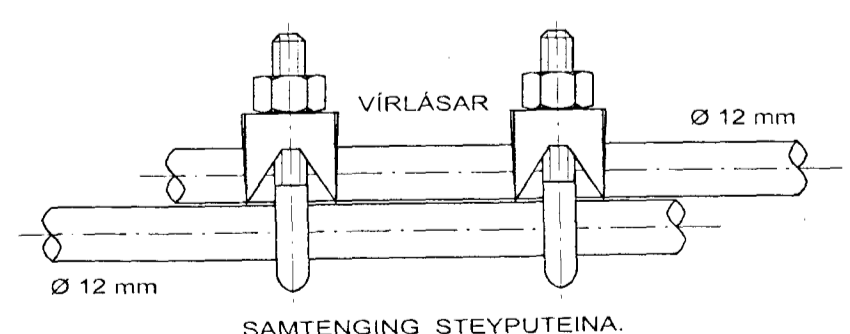
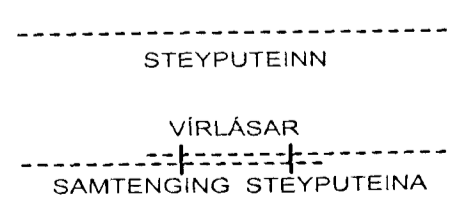

SAMTENGING STEYPUPEINA.

Setja skal tvo vírlása á hver samskeyti.

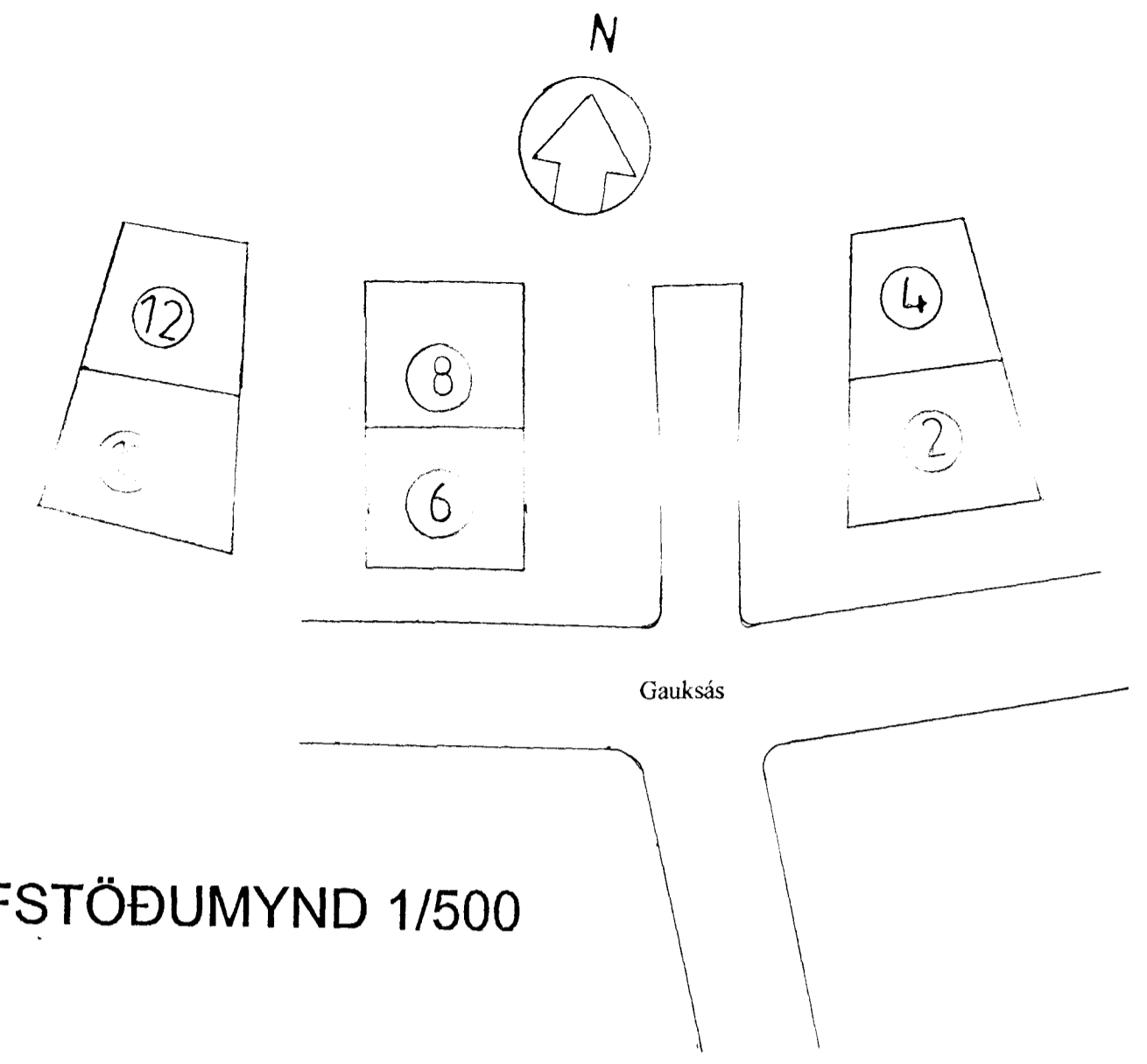

AFSTÖÐUMYND 1/500

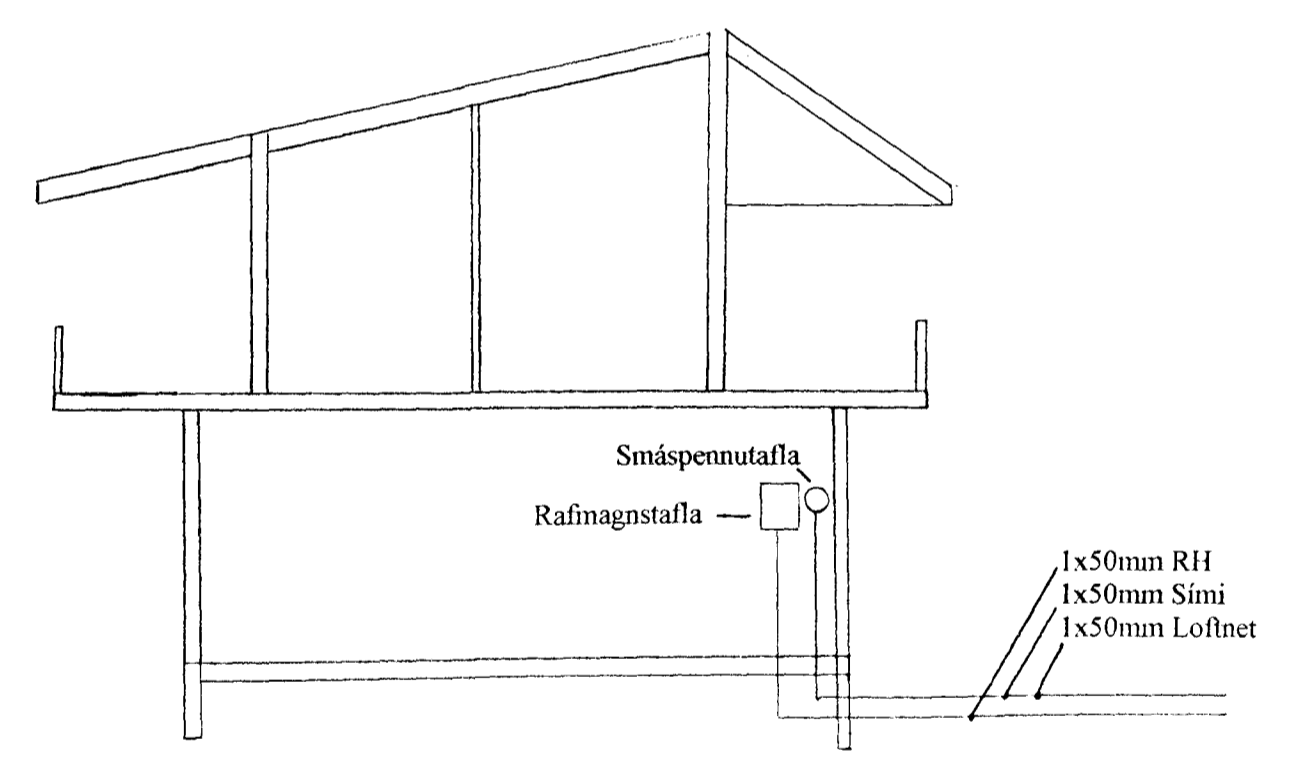

1:100 Inntakspípur 70 sm í jörð 3x50mm.

Gaukás 8 - Hafnarfirði.
 Einlínnumynd og snið.
 Teiknað: Gunnar Ingi Guðmundsson.
 MKV. 1:100. 1:500.
 Nóv.2000.