

SM1 Ø600 REGNVATNSBRUNNUR, 1:20  
MED VATNSLÁS

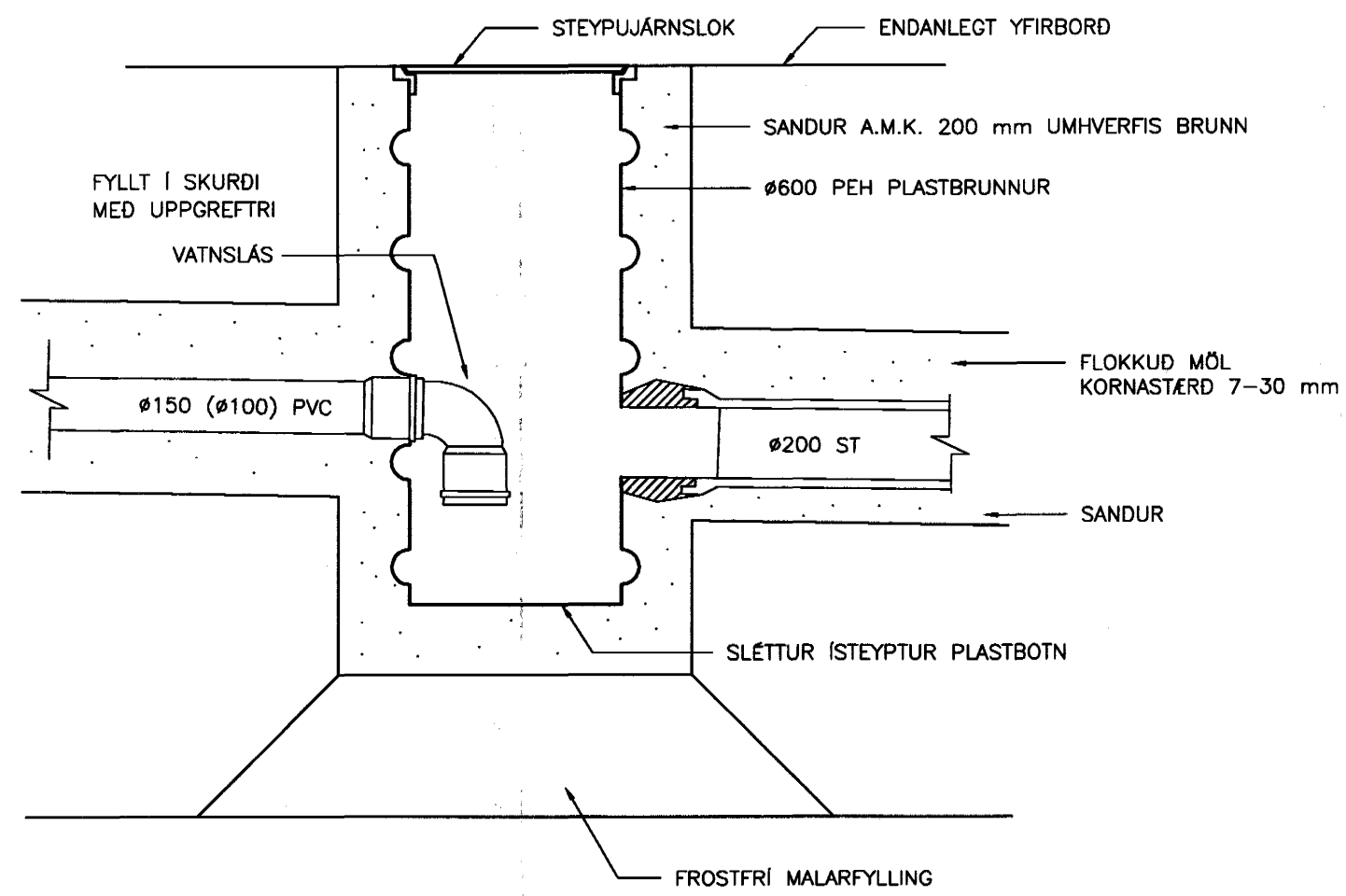

SM2 Ø600 SKOLPBRUNNUR 1:20

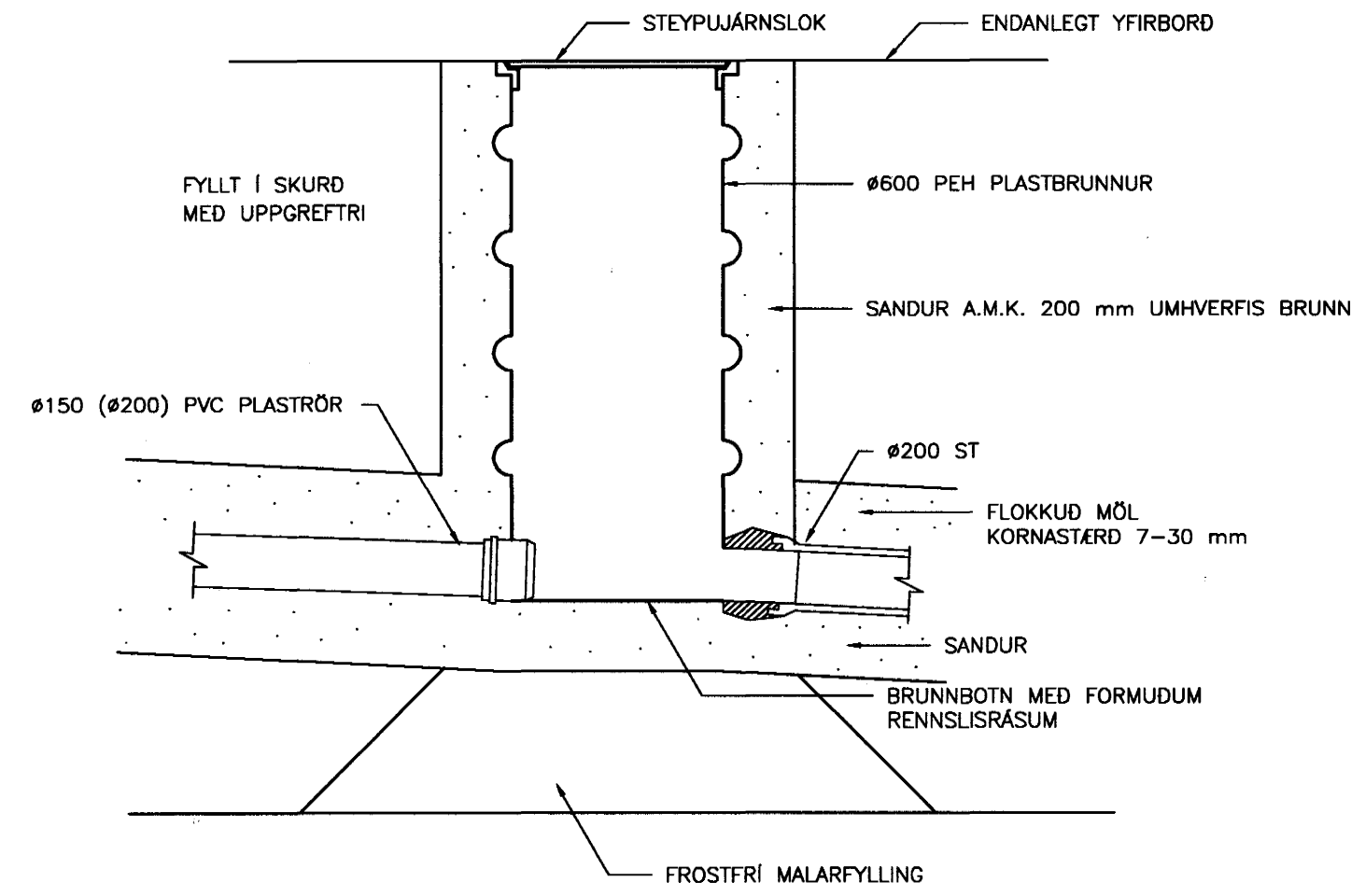

SM3 AFRENSLI Í GRJÓTPÚKK 1:20

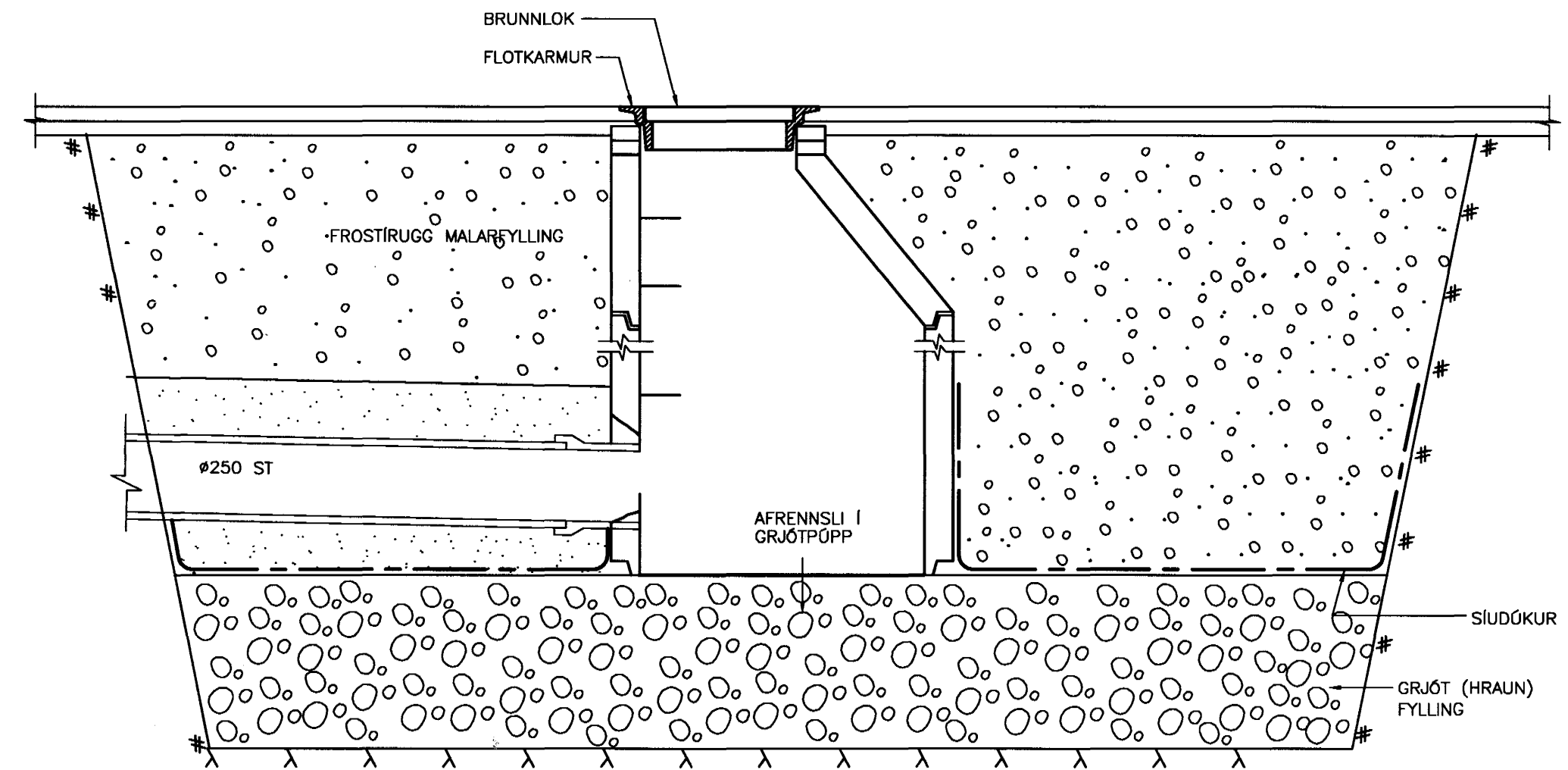

SM4 SKOLPBRUNNUR 1:20  
DEMIGERT ÞVERSNID

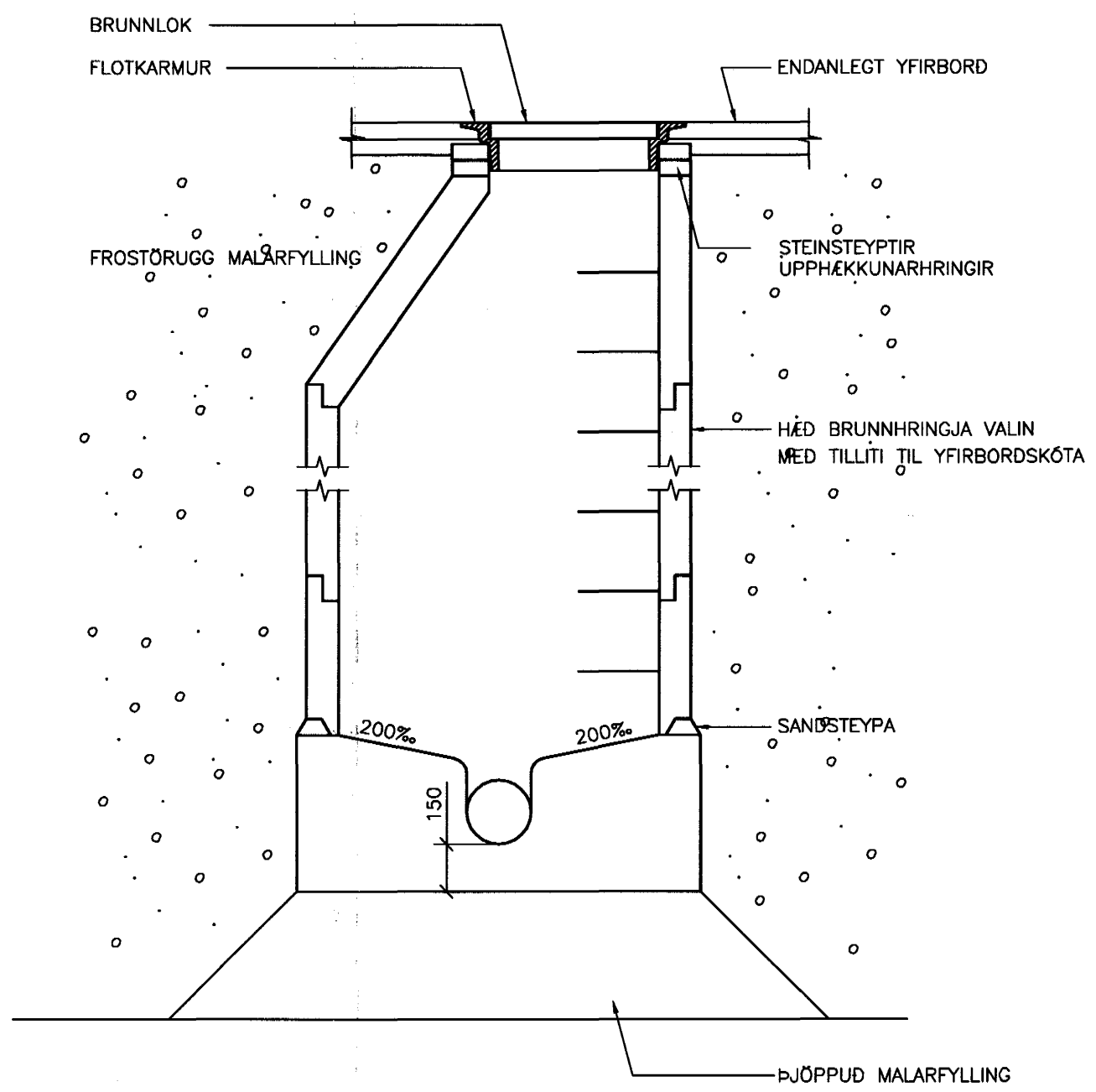

SM5 REGNVATNSBRUNNUR Ø1000 1:20  
DEMIGERT ÞVERSNID

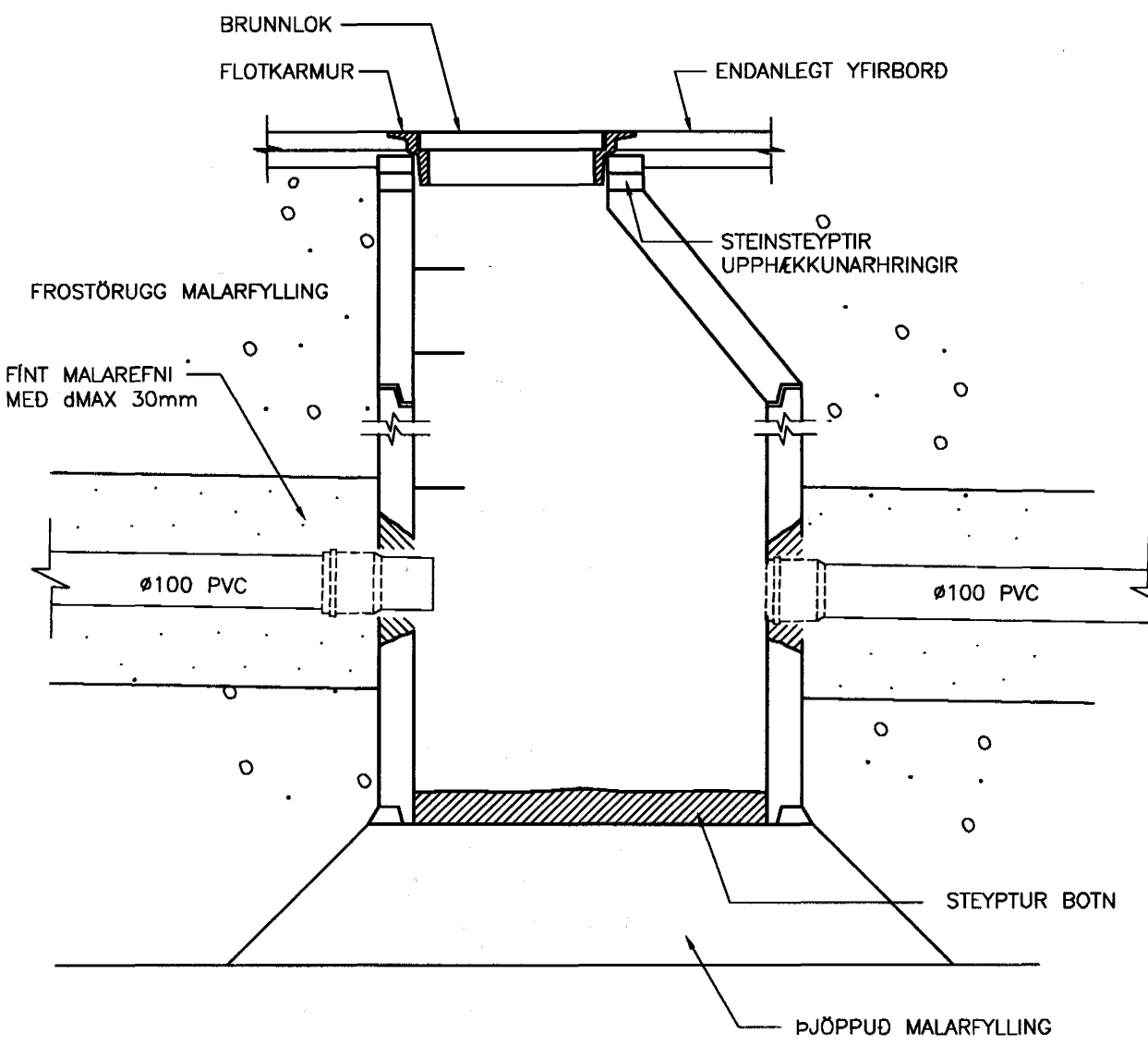

SM6 NIDURFALL Ø250 PLAST 1:20

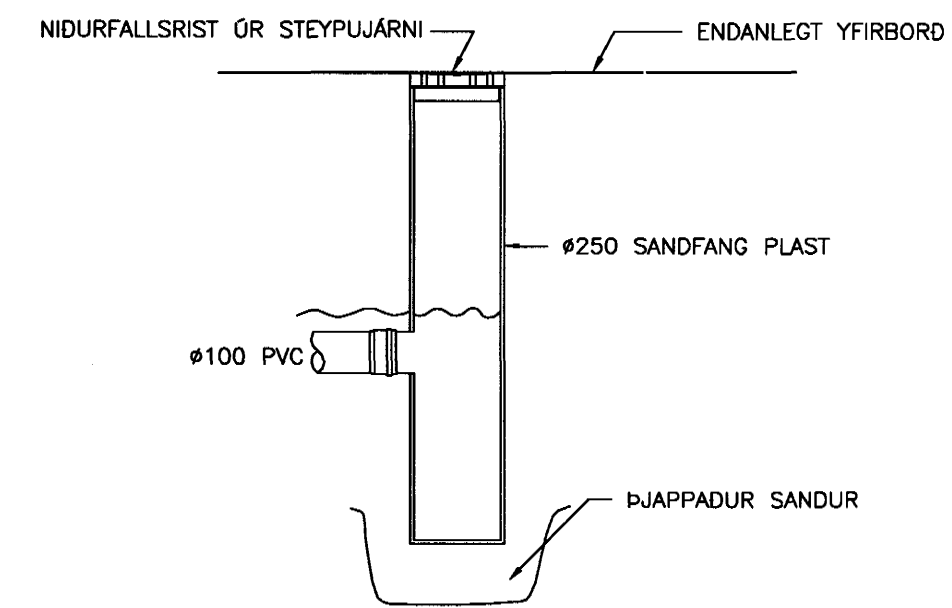

SM7 GÖT Í PLÖTU 1:20

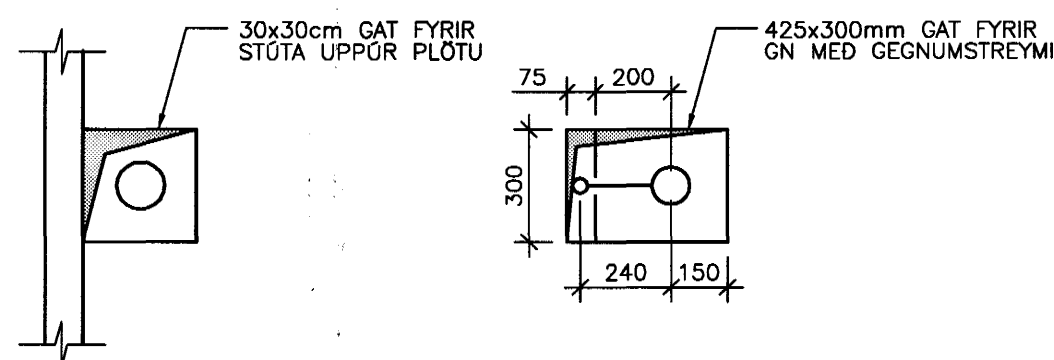

SM8 LÖGN GEGNUM UNDIRSTÖÐU, 1:20

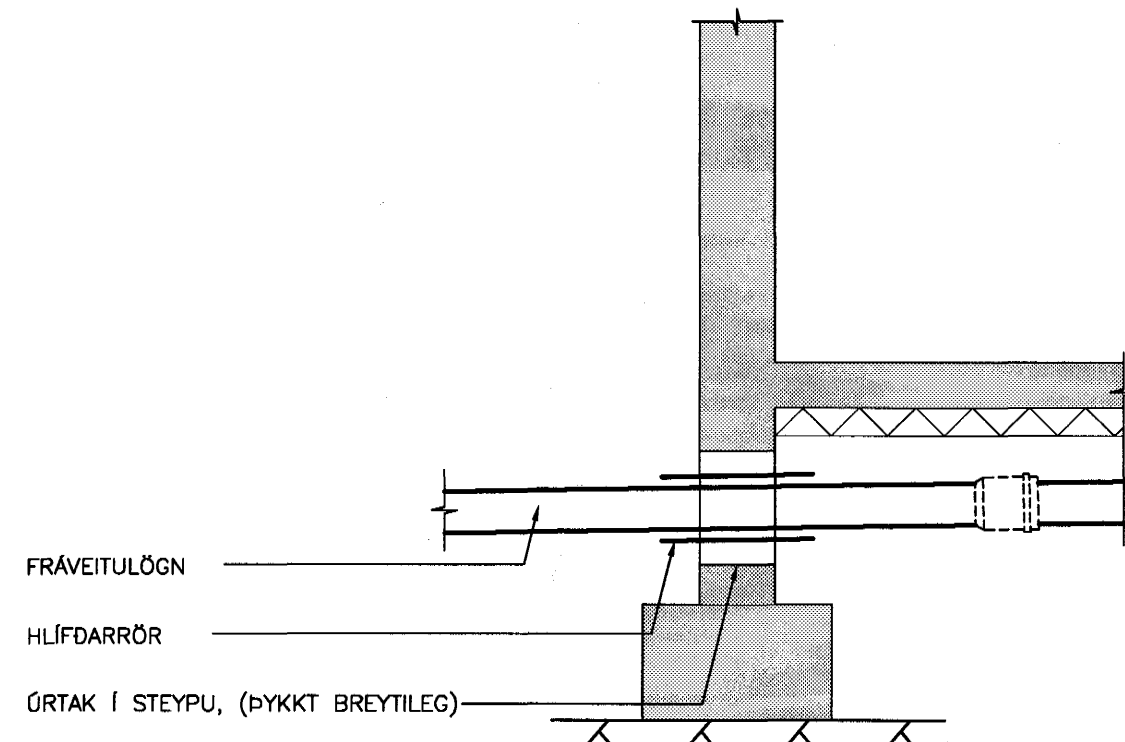

SM9 RESILÖGN, 1:20

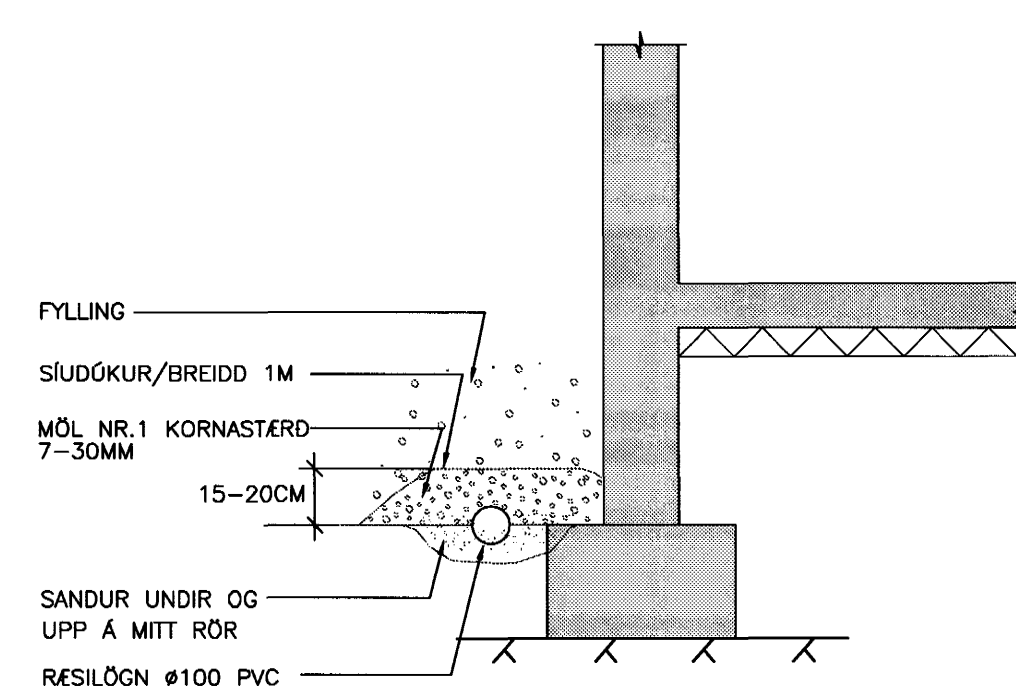

Byggingatúlltrúi Hamarjarðar  
Algreitt þann  
16 JULI 2004  
HÓ

TILVÍSANIR:  
ALMENNAR SKÝRINGAR . . . . . SJÁ BL. NR. A-1

38 071070-5069

BR. DAGS. BREYTING REKNI. TEKNI.

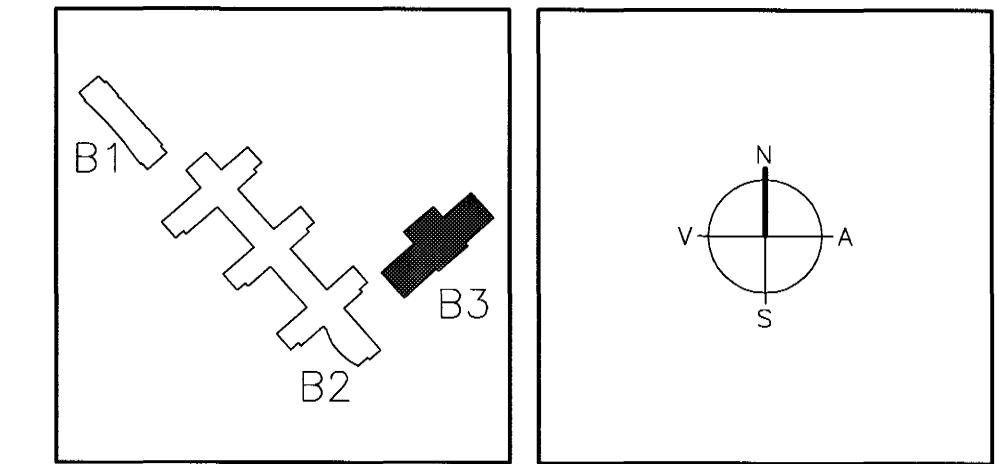

ARKITEKTAR  
BERGSTADASTRÆTI 10, RVK  
sími:551-1480, netfang:arkitekt@ishof.is

FINNUR BJÖRGVINSSON  
HILMAR ÞÓR BJÖRNSSON  
SIGRÍÐUR ÓLAFSDÓTTIR

LANDMÖTUN  
HANNAD/TEKNI. 042/042  
EINAR E. SÆMUNDSEN  
INGIBJÖRG KRISTJÁNSDÓTTIR  
MARGRÉT SIGURDÁRSDÓTTIR

VSÓ RÁÐGJÖF  
SÓLVANGSVEGUR 4  
LÆKJARKÓLI - ÍÞRÓTTAHÚS

PRÍFAKERFI  
LAGNIR Í GRUNNI  
SÉRMYNDIR OG SNID

HANNAD/TEKNI. 042/042  
ATH. EA  
SARÞYKKT Þorb. Kallan  
Kl. 230651 2307 330659-4488

KVARDI 1:20  
VERNRK. REYKJAVIK. 30.06.2004

REYKJAVIK. 30.06.2004

00258 B3-L1-SU-1