

N-1  
1 stk.

O-1  
1 stk.

P-1  
1 stk.

Gler í gluggum J-1, J-2, J-3, P-1 og K-1, L-1, M-1, N-1 og O-1 skal uppfylla eftirfarandi kröfur:  
 U-gildi: 1.2 W/m<sup>2</sup>K  
 G-gildi (solarenergy factor): 35-38 %  
 LT-gildi (light transmission): 65-70 %  
 LR-út-gildi (light reflection): ca 13 %  
 Gleríð skal vera glært

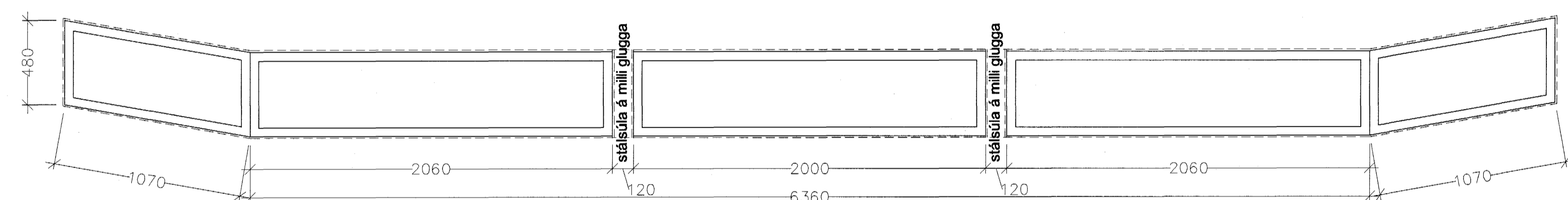

Q-1 hornluggi  
1 stk.

Q-3  
1 stk.

Q-2 hornluggi  
1 stk.

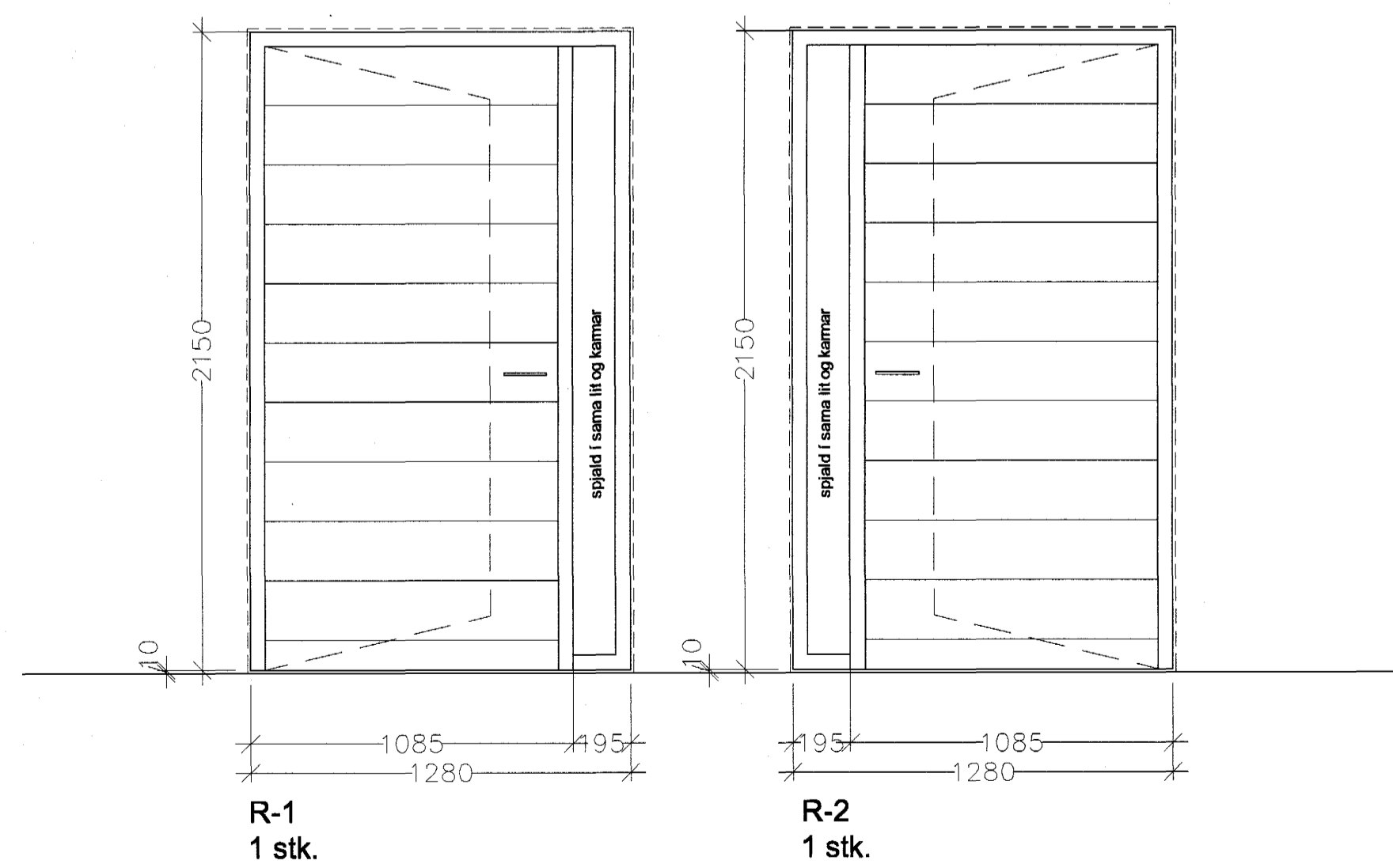

R-1  
1 stk.

R-2  
1 stk.

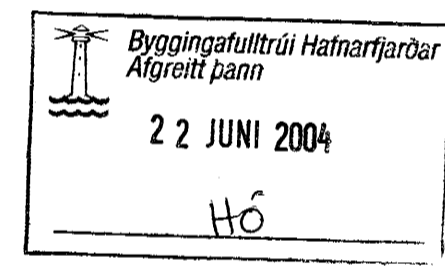

*St. M.U.'04*

BR.	DAGS.	BREYTING	REKNI.	TEKNI.

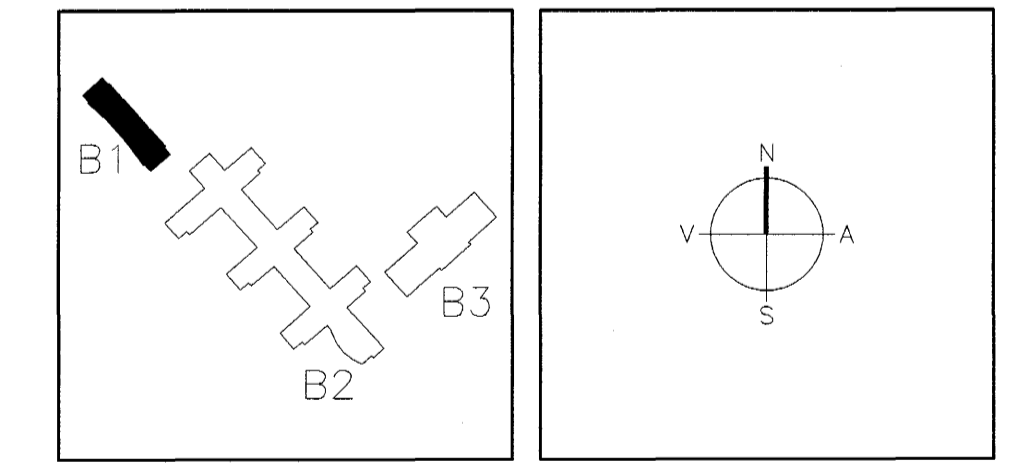

**ARKITEKTAR**  
 BERGSTADASTRÆTI 10, RVK.  
 sími 551-1460, netfang arkitekt@sholf.is

**FINNUR BJÖRGVINSSON**  
**HILMAR ÞÓR BJÖRNSSON**  
**SIGRÍÐUR ÓLAFSDÓTTIR**

**LANDMÓTUN**  
 EINAR E. SÆMUNDSEN  
 INGIBJÖRG KRISTJÁNSDÓTTIR  
 MARGRÉT SIGURDARDÓTTIR

**VSÓ**  
 VSÓ RÁÐGLJÓF  
 BORGARFOSI 20, 103 REYKJAVÍK, Sími 585-9000, Símbreyt 585-9010, Netfang vs@vs.is

**TJARNARBRAUT 30**  
**LEIKSKÓLINN HÖRÐUEVILLIR**

GLUGGAFIRLIT	HANNAÐ/TEKNI.	BR.
	ATH.	
	SAMÞYKKT	
	KT.	080208-1309
KVARDI 1:20	REYKJAVÍK	19.11.2001
VERKNI.	TEKNI. NR.	BR.

B1-A-VD-003