

Snið í stoðvegg og þak

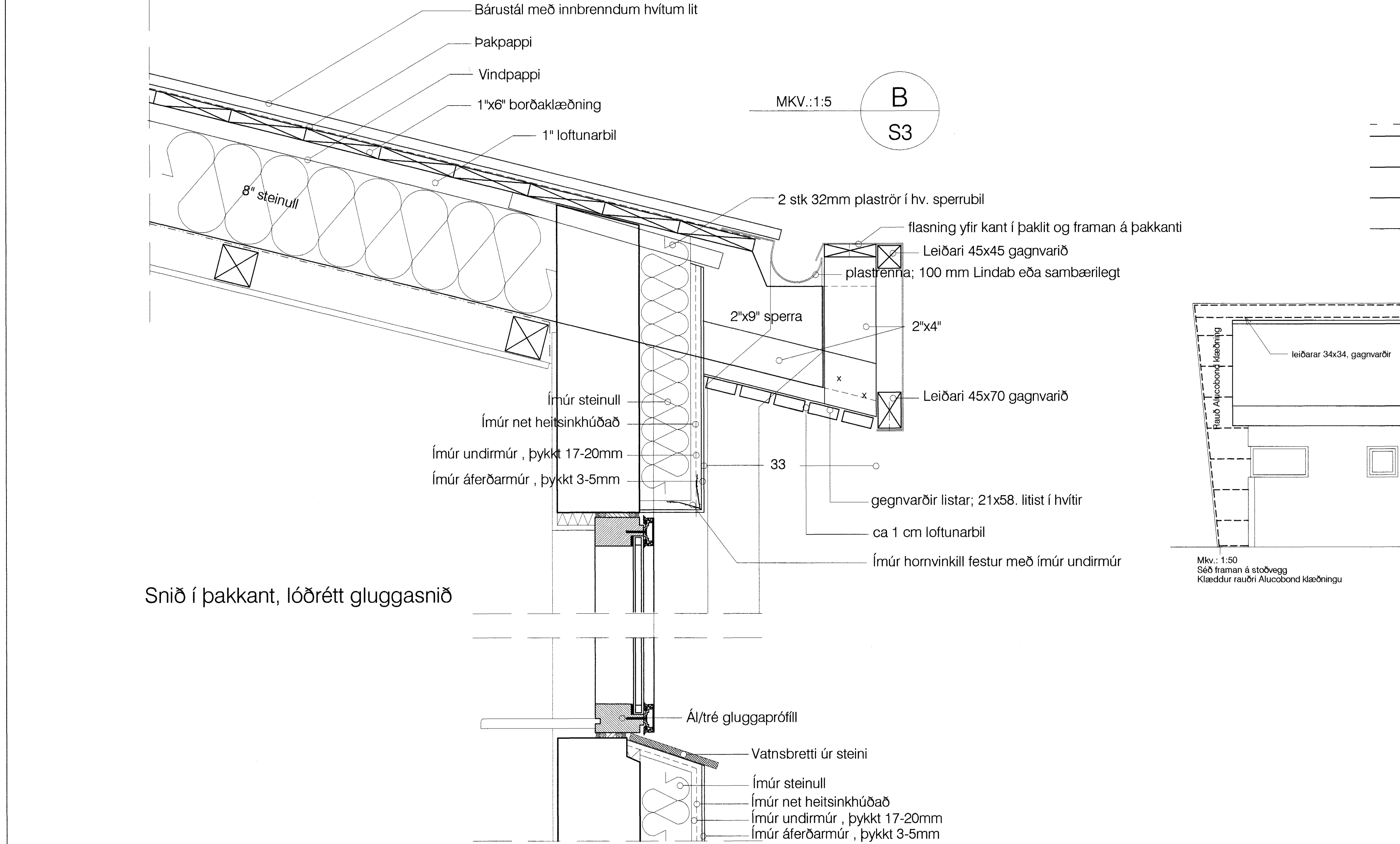

Snið í þakkant, lóðrétt gluggasnið

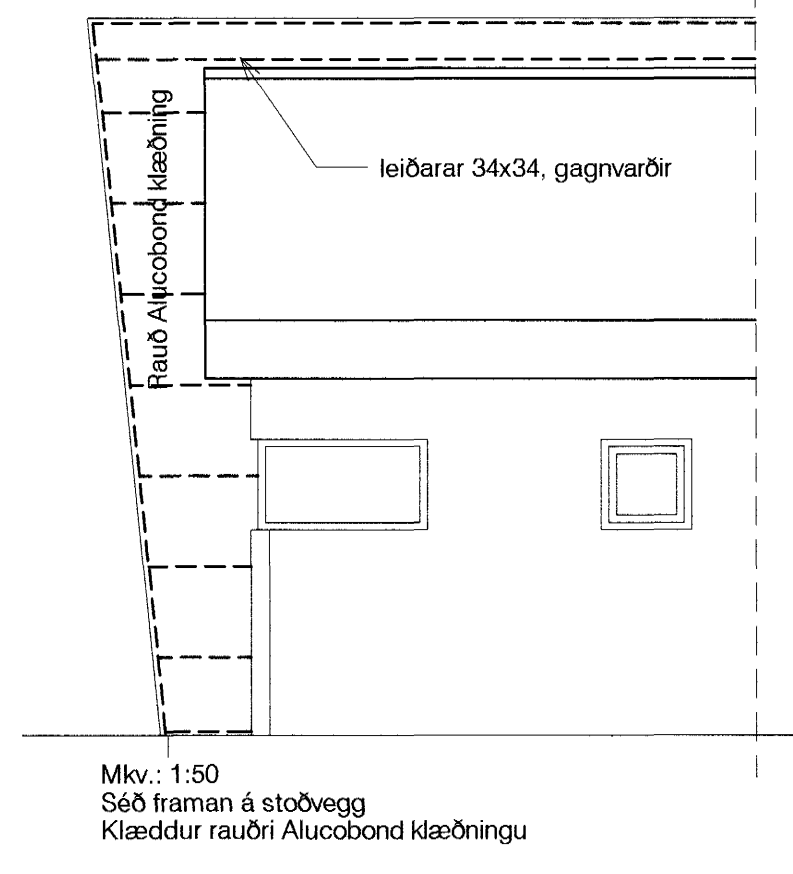
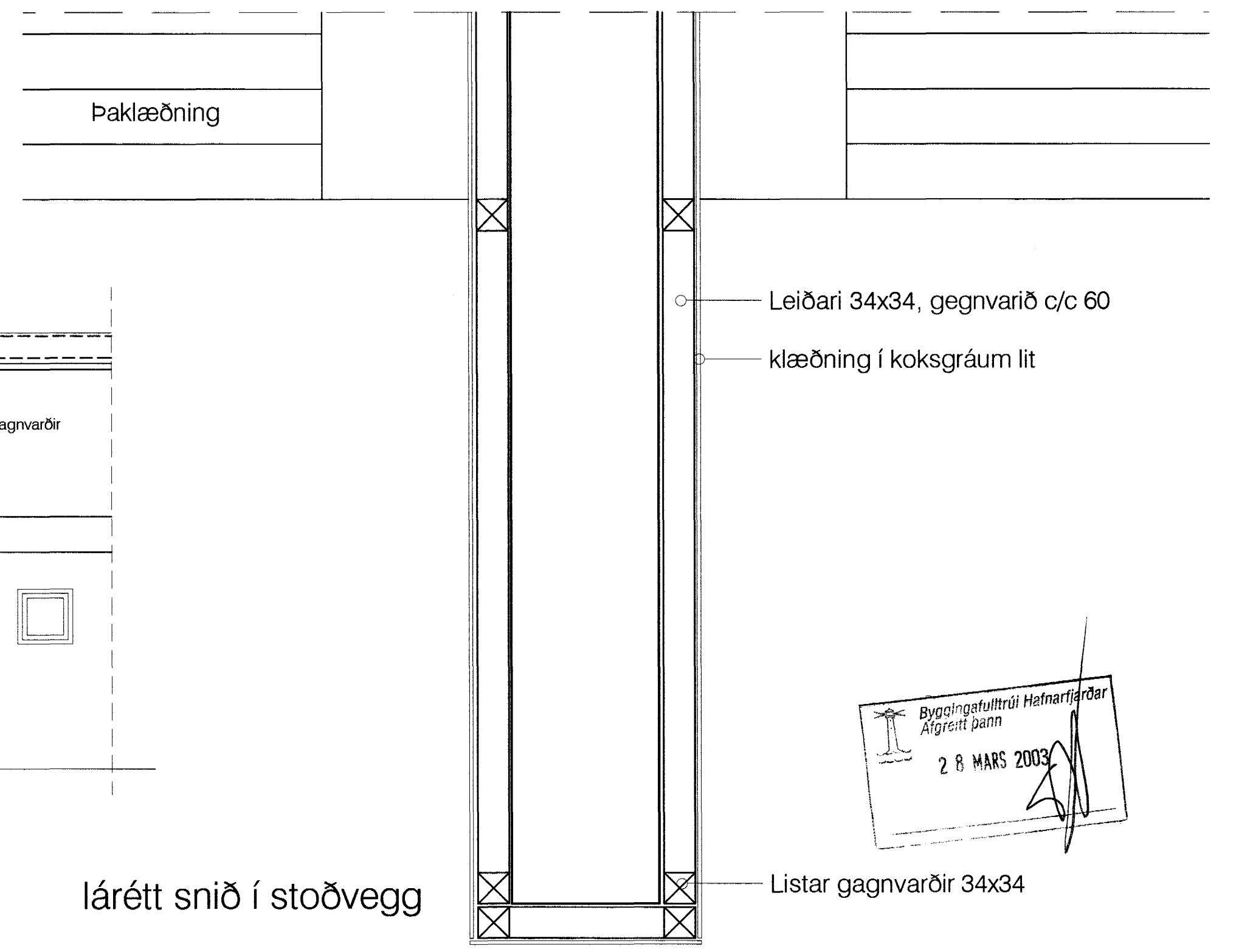
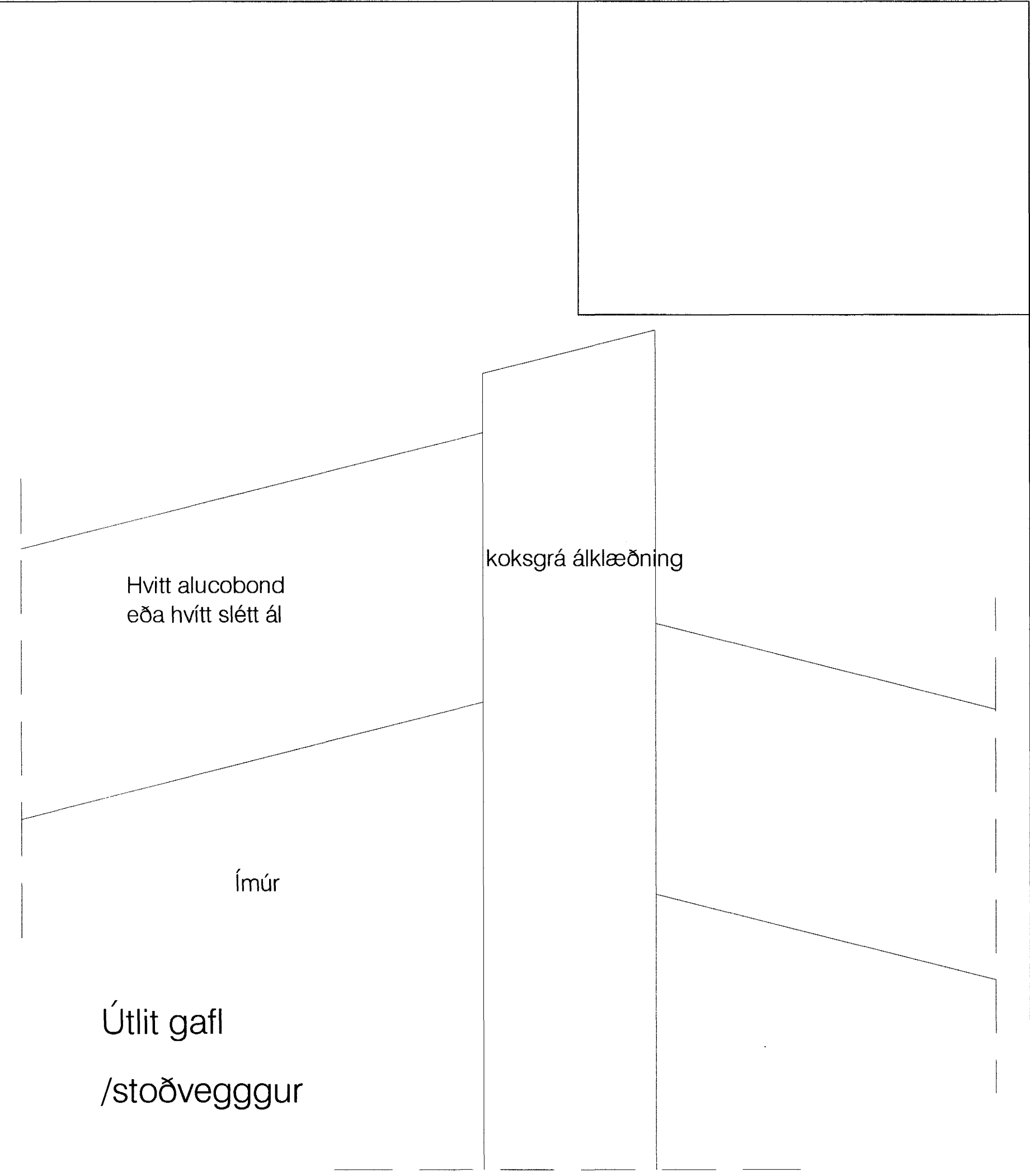

lárétt snið í stoðvegg

Byggingafulltrúi Helnarfirðir
 Afgreitt þann
 28 MARS 2003

Erluás 13
 Pakfrágangur og fl. 1:5, 1:50
 mars '03

S5 Guðmundur Gunnlaugsson, arkitekt FAÍ
 kt. 190554-3419
 Teiknistofan Archús ehf, Stórhófa 17,
 112 Reykjavík. s: 5677735-fax 5677736.
 kt. 631298-4439. gudmgar@islandia.is

br.

archús ehf