

A FATASKÁPUR 1 - TOPPSTYKKI
70/11 LÓDRÉTT SNID 1:1

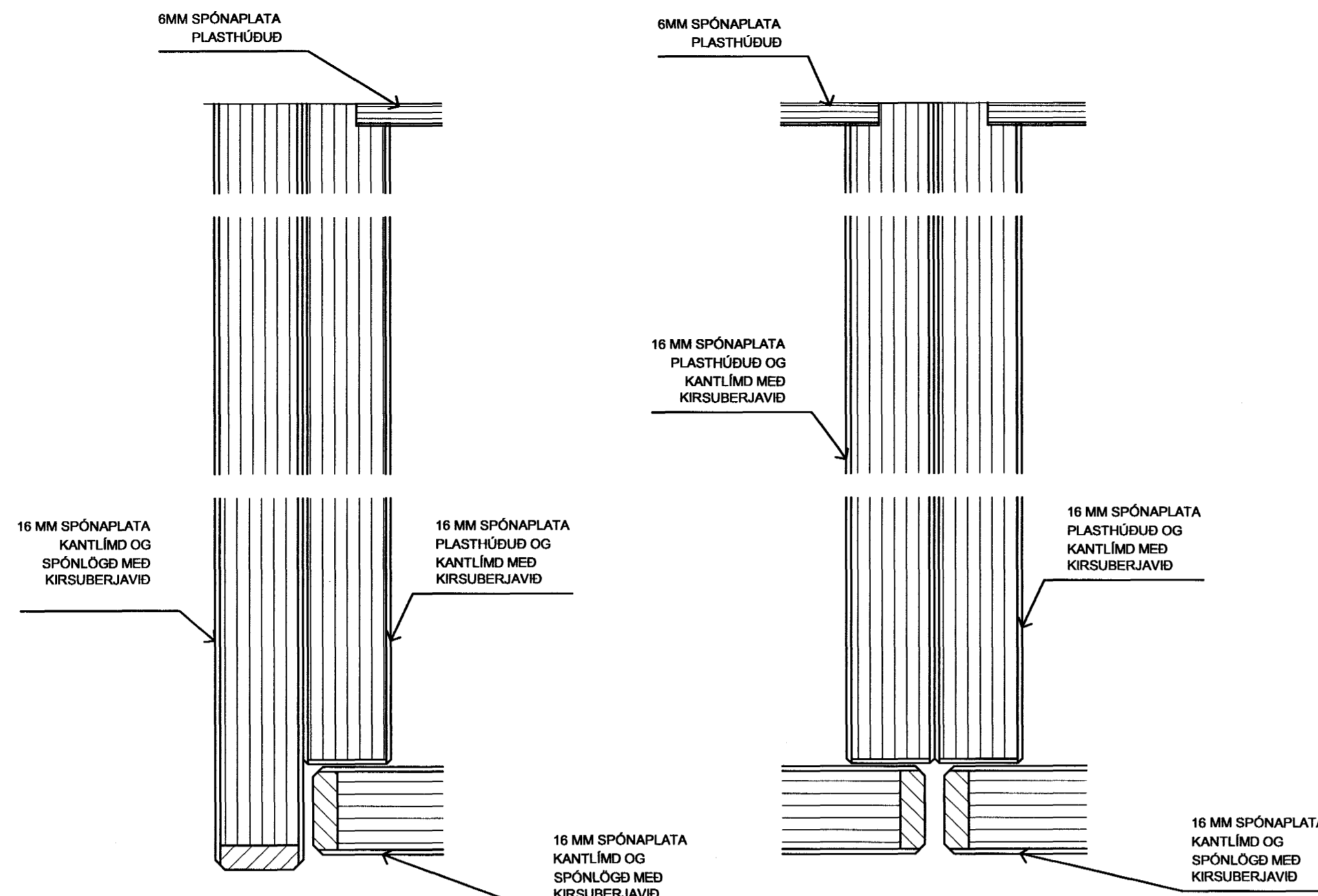

B FATASKÁPUR 1 - HLIÐARSTYKKI
70/11 LÁRÉTT SNID 1:1

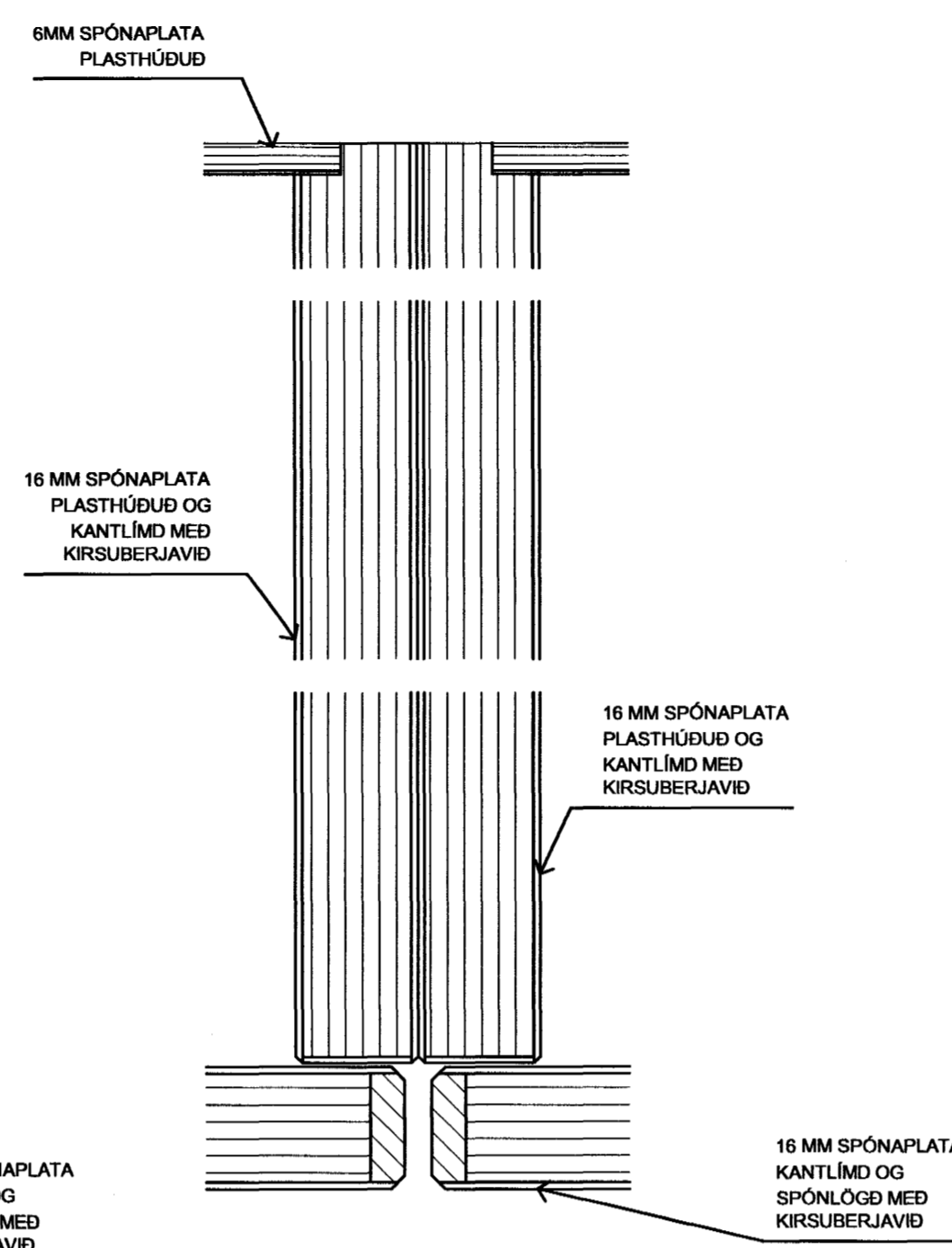

C FATASKÁPUR 1/2 - SAMSKYFTI
70/11 LÁRÉTT SNID 1:1

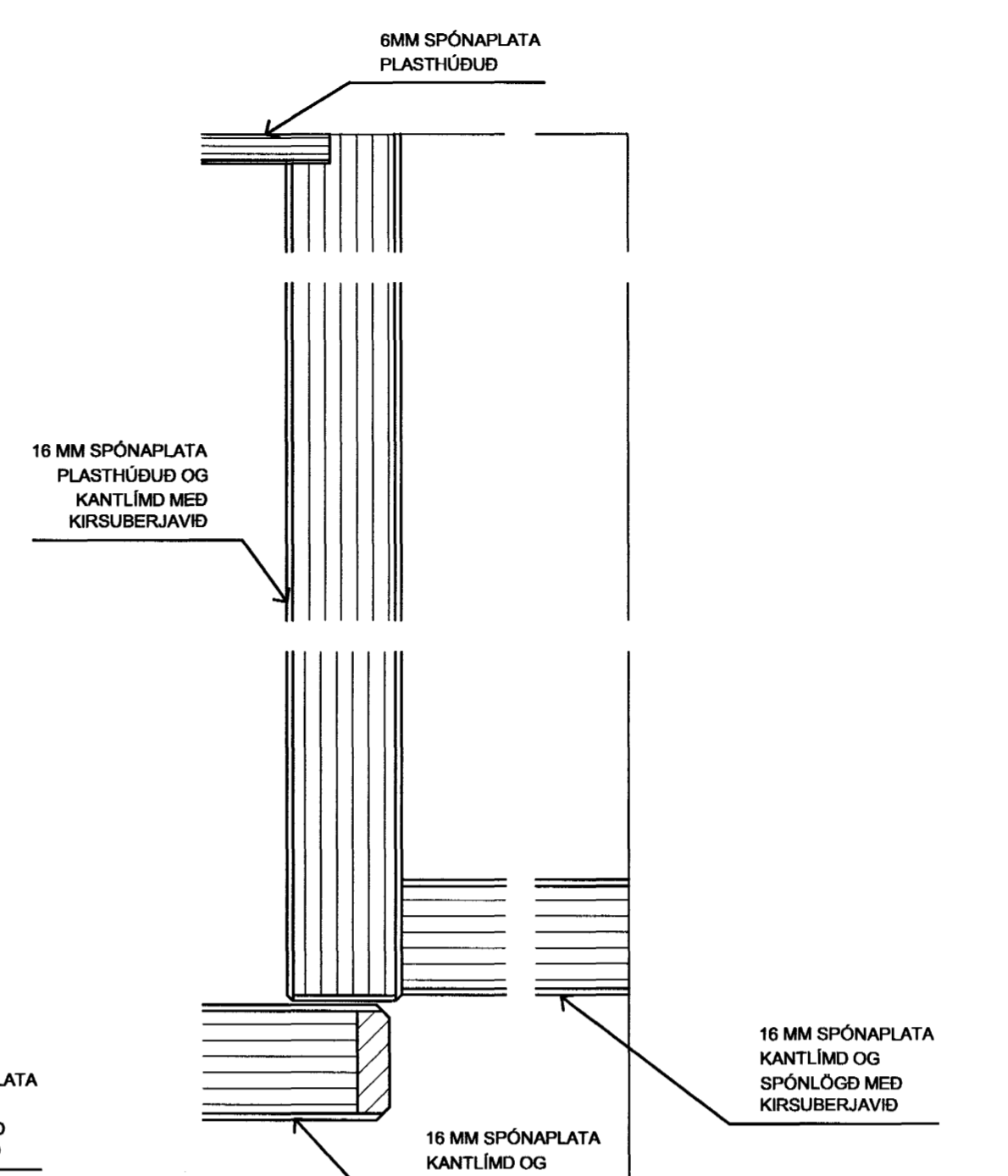

D FATASKÁPUR 1 - FRÁGANGUR V/LAGNA
70/11 LÁRÉTT SNID 1:1

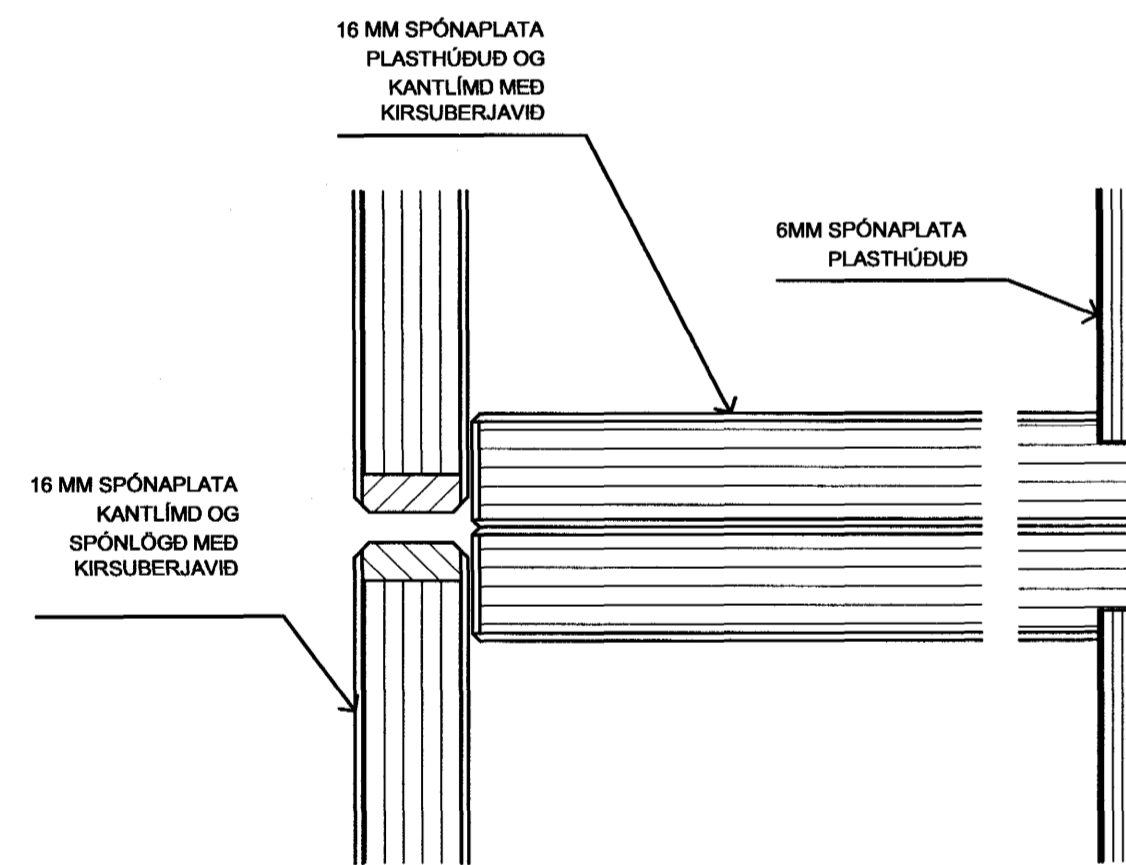

E FATASKÁPUR 1/2/3 - SAMSKYFTI
70/11 LÓDRÉTT SNID 1:1

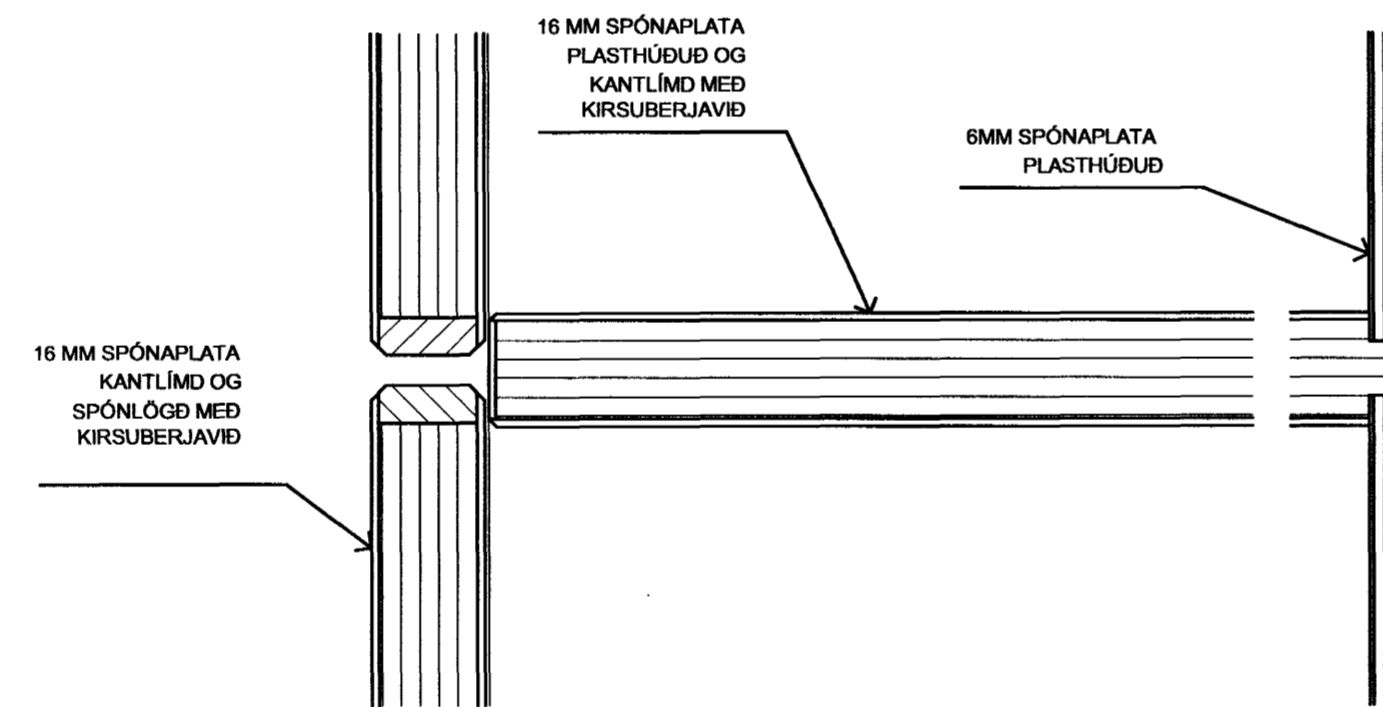

F FATASKÁPUR 2/3 - SAMSKYFTI
70/11 LÓDRÉTT SNID 1:1

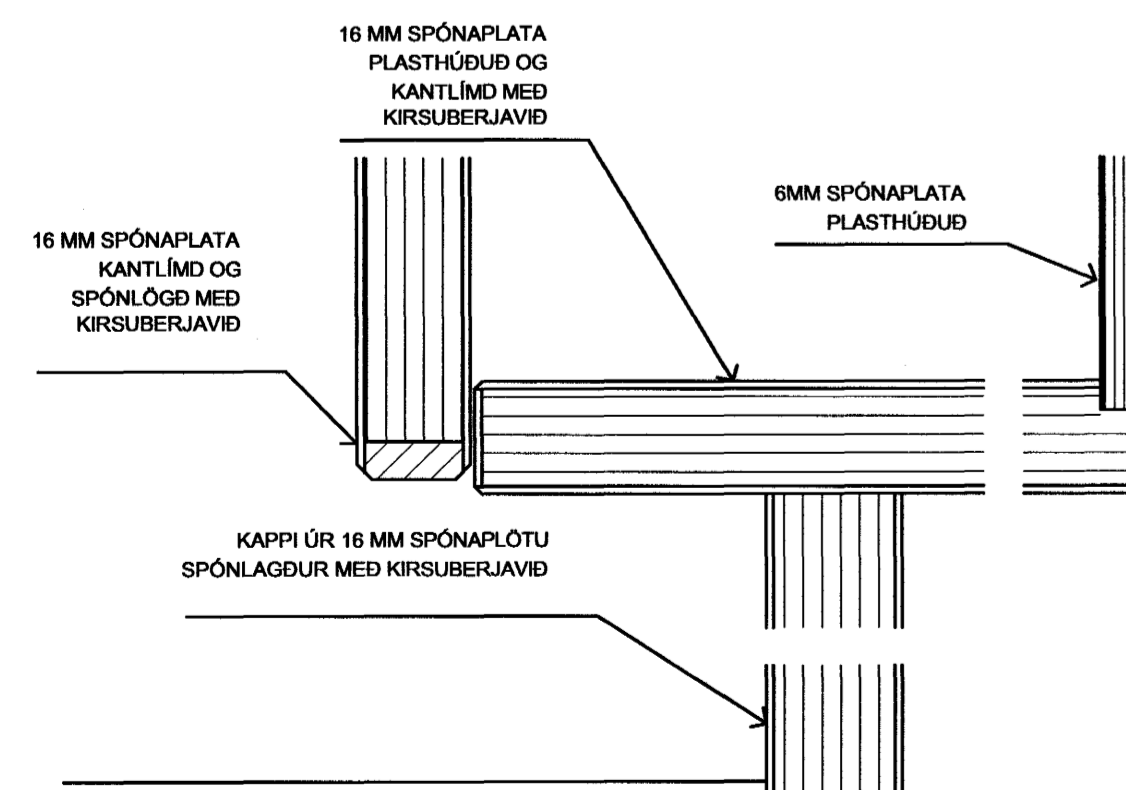

G FATASKÁPUR 1 - BOTNSTYKKI
70/11 LÓDRÉTT SNID 1:1

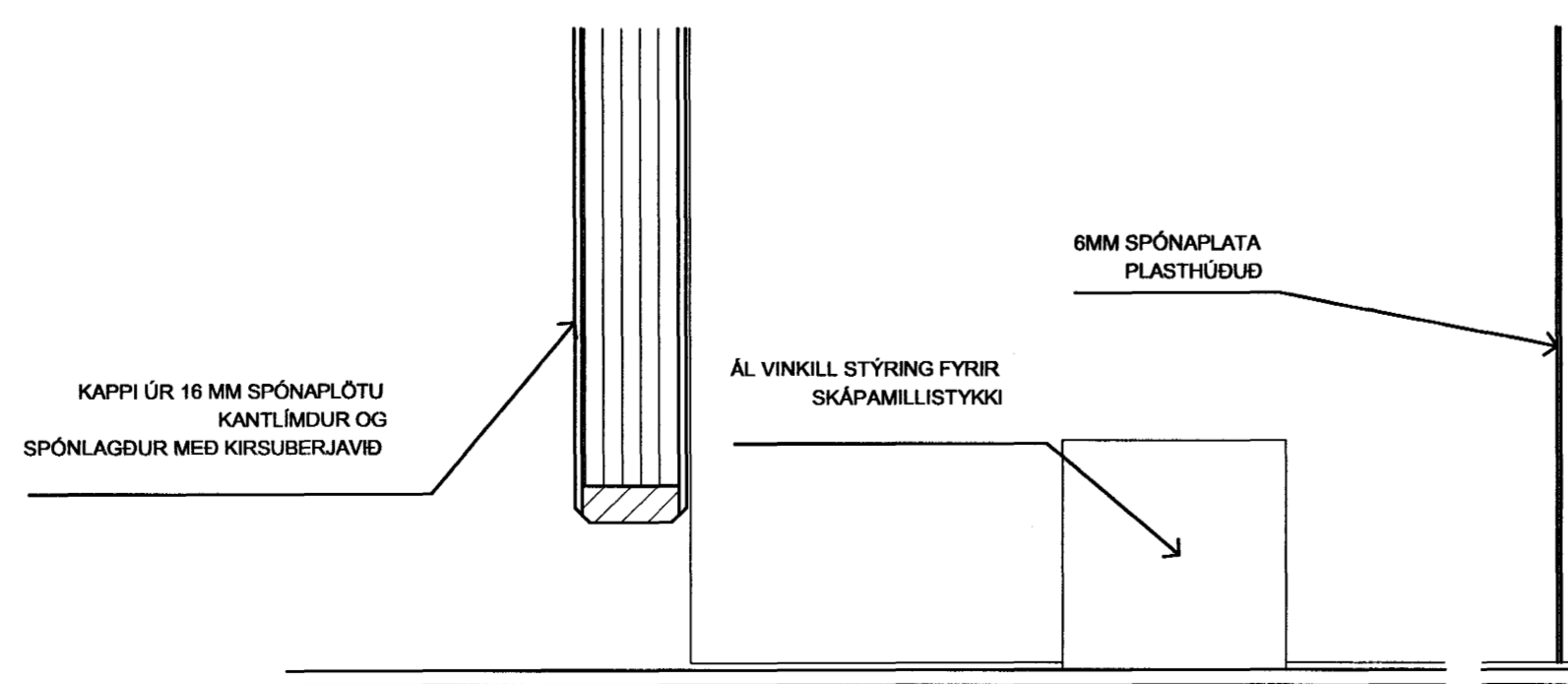

H FATASKÁPUR 2/3 - BOTNSTYKKI
70/11 LÓDRÉTT SNID 1:1

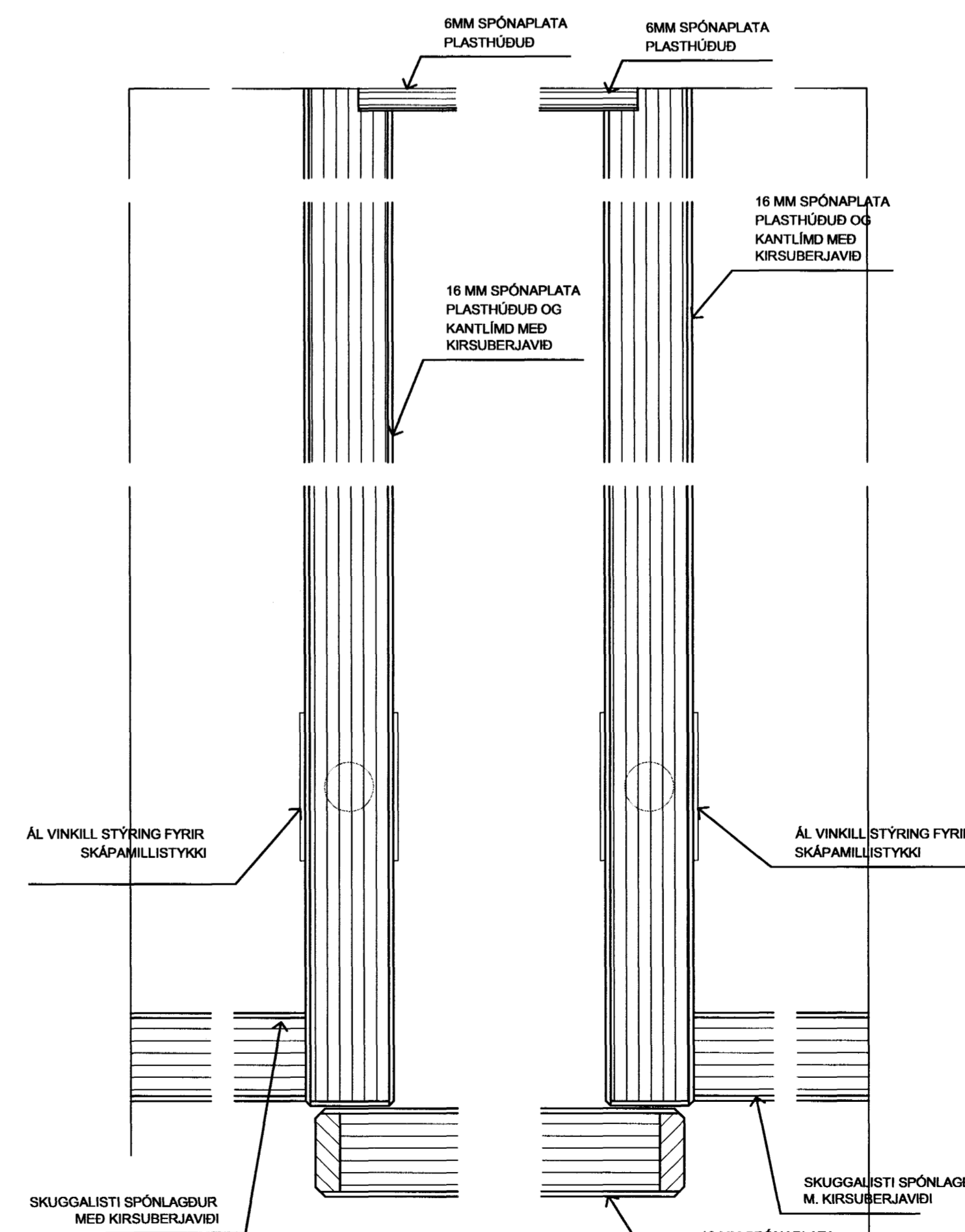

I FATASKÁPUR 2/3 - ENDASTYKKI
70/11 LÁRÉTT SNID 1:1

EFNI: Hurðir, sýnilegr hliðar, sökkull og hillur:

Kantlímt og spónlagt með við

Efni inni skápum:
16 mm plasthúðað hilluefni.

Lamir og skúffubrautir:
Grass, Blum eða sambærilegt.

Höldur úr ryðfriú burstuðu stáli, valið samráði við arkitekt.

Körfur: Elfa eða sambærilegt

Öll mál og aðstæður athugist á staðnum fyrir smíði.

TEIKNISTOFA
HALLDÓRS
GUDMUNDSSONAR
FAÍ
SKULATONI &
103 REYKJAVÍK
SÍMI 545 1600
FAX 545 1616

Kennitala byggingar: 70994-2468

HRAFNISTA - HAFNARFIRÐI
FJÖLBÝLISHÚS V / GARÐAVEG

HÚS 1 OG 2
SÉRMYNDIR FATA-/ KÚSTASKÁPA

Bygginguáttir HAFNARFIRÐAR
Ágúst þann
27. DES. 2001
VG

MÁL 1:1
DAG. 19.09.2001 70-11

BR. ATH. TEIKN. SK