

Grunnmynd 2.hæð  
mkv. 1: 100

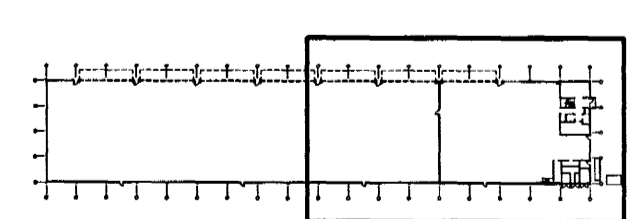
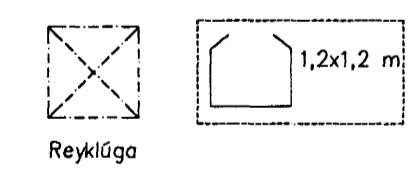

Byggingafræðingur  
Alfreitt Þann  
13 JAN. 2004  
Sigurbjartur Kalldórsson

Skýringar:  
Explanations:

**ARK ÍS ehf**  
arkitektar ráðgjafar

Aðalsteinn Snorason arkitekt fái 161161-2769  
Egill Guðmundsson arkitekt fái 270152-6869  
Gísli Gíslason arkitekt fái 160657-4809

Skólavörðustíg 11  
101 Reykjavík  
sími 511 2060  
fax 511 2066  
netfang arkis@ark.is

Fjöldi stúkkja Number of pieces	Hlutur Object	Atriði Item	Efni Material	ea.:stk Weight	total: í heild (kg) Þyngd	Athugasemdir Remarks
1	Hæð húss lækkuð um 200mm / kótum breytt					
Breyt. Rev.	Breyting Revision	Dagur Date	Samþ. Approved	Notk. heiml. Released		
Tilvitnir / Drawn		Samsættn. / Assembly		Tilvitnir og skráð / Checked and filed		

This drawing is the property of the Alcon Iceland Ltd. and handed out for personal use only. It may neither be copied nor made available to others without permission of the Alcon Iceland Ltd. The receiver is liable for any misuse.		Fjöldi stúkkja Number of pieces		Hlutur Object		Atriði Item		Efni Material		ea.:stk Weight		total: í heild (kg) Þyngd		Athugasemdir Remarks	
		IV III II I		Mhl.01 Víkurgata 3 / ál-og tekjageymsla		ARKÍS ehf		ALCAN PRIMARY METAL EUROPE		7510		7510		1	
				Grunnmynd 2. hæðar		Stráumsvið		IS-222 Hafnarforður		168529		1			