

SKÁLF HEIMMARI Ø 150 ST 300 o/oo  
 RENNIVATNS R. Ø 100 ST 3/0 o/oo

RENNIVATN Ø 400  
 RENNVÖK CA 41,80

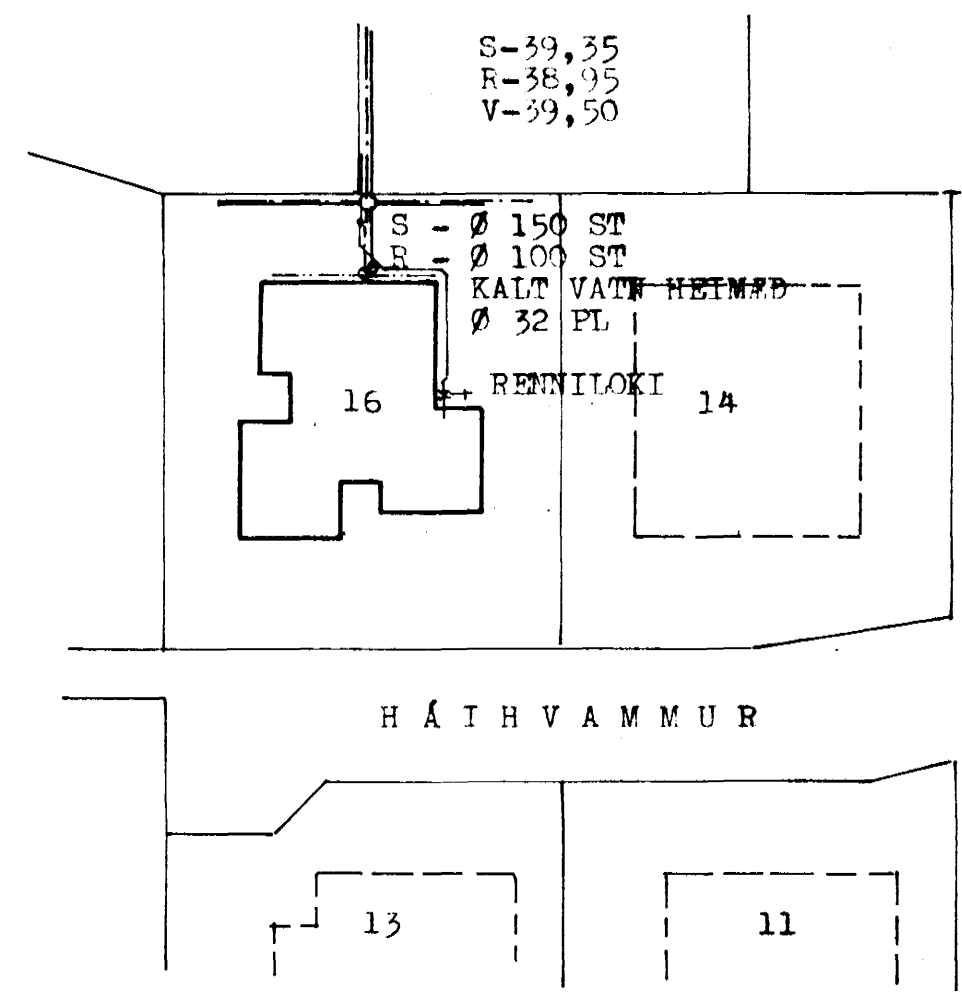
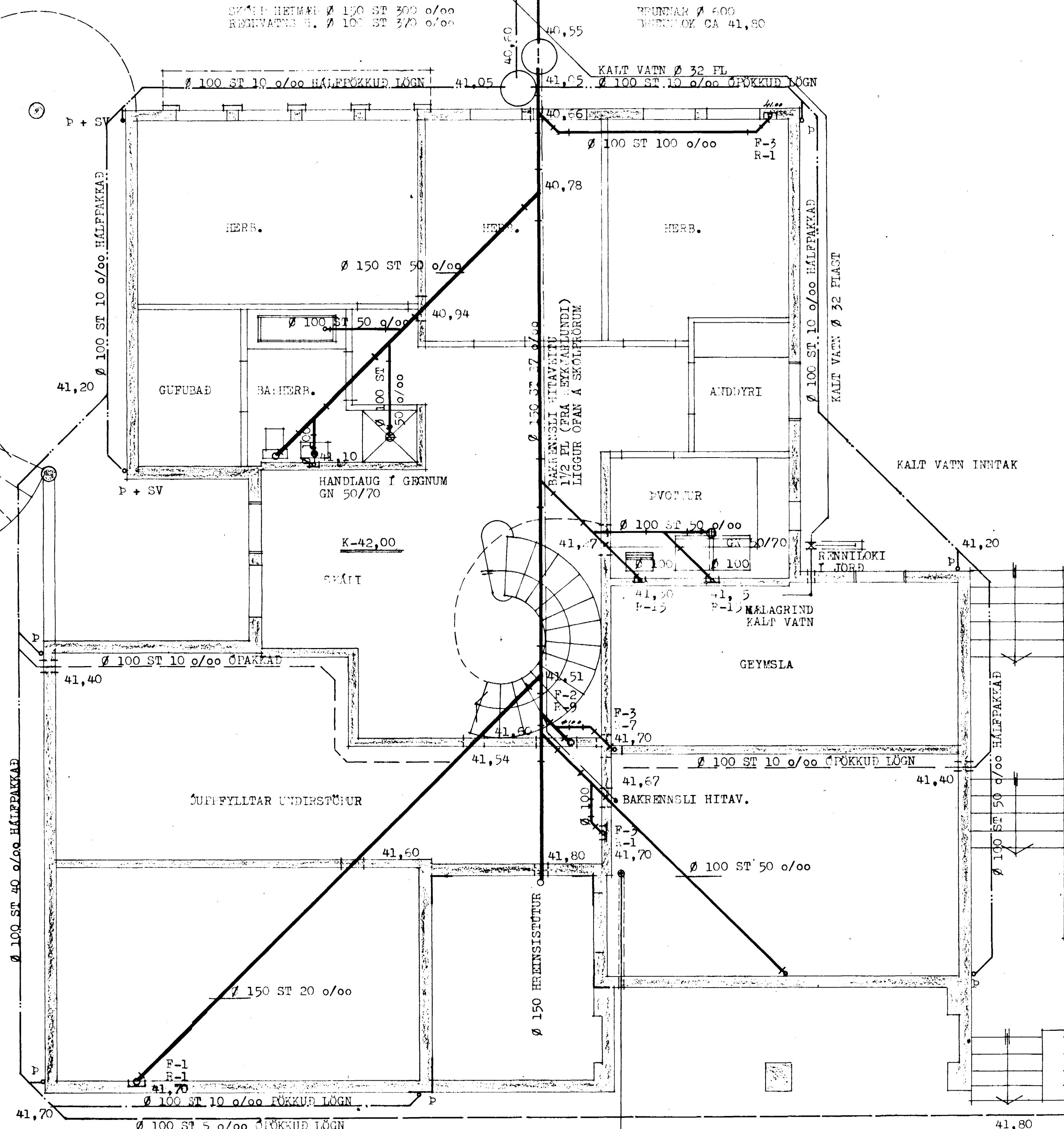

AFSTADA 1:500

VARÐANDI SKYR: INGAR  
 SJA BL. 4

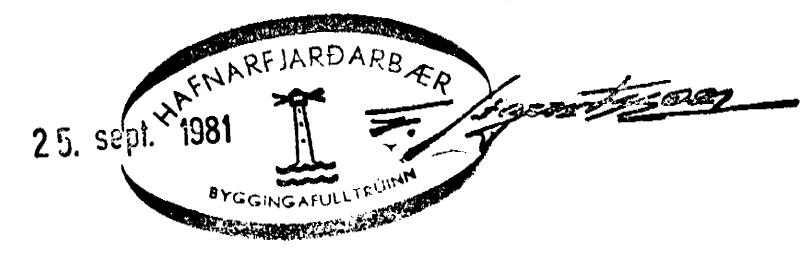

<b>STEINGRIMUR TH. ÞORLEIFSSON, MTFI</b>	
TEIKNISTOFA - ARMÚLA 5 - SIMI 3-22-44	
VERK: HÁI HVAMMUR NR. 16 HAFNARFJÆR	
MAL	1:50 - 1:500
DAGS	APRÍL-1981
BLAD	2
BREYTT	
FRÁRENNISLAGNIR GRUNNMYND JARHÉÐAR -AFSTADA -VATNSINNTAK <i>Steingrímur Þ. Þorleifsson</i>	