

G-12, 1 stk. Efri brún 2600 mm yfir gólfí.

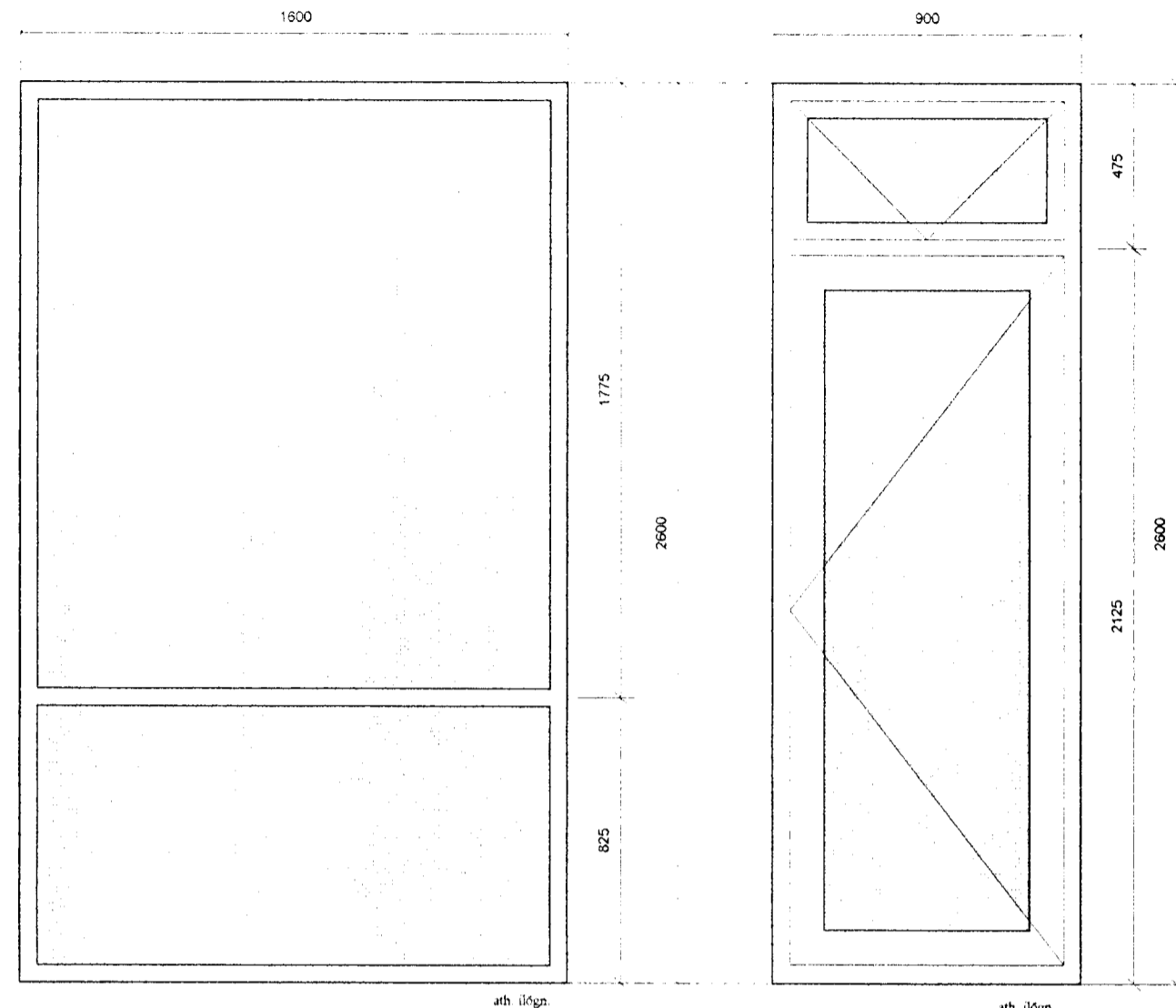

G-13, 1 stk. Efri brún 2600 mm yfir gólfí.

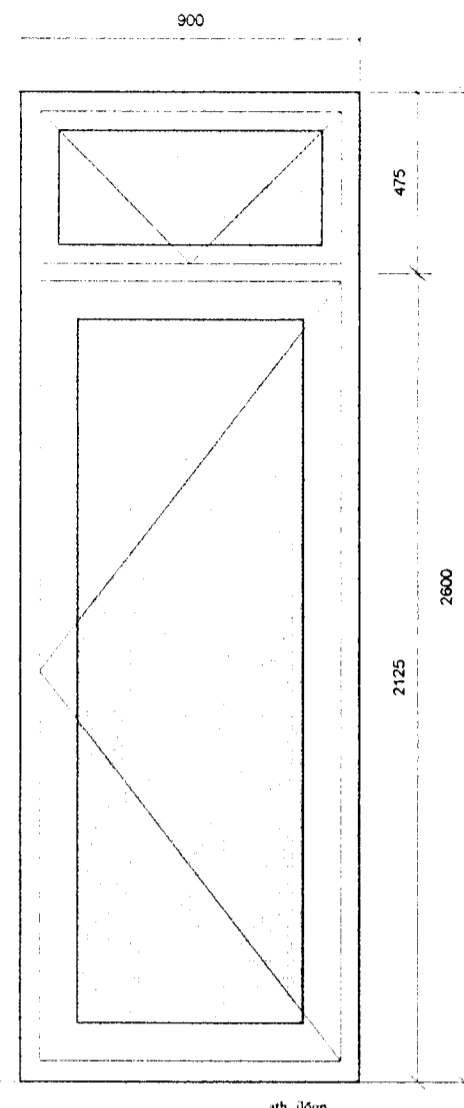

GH-3, 1 stk. Efri brún 2600 mm yfir gólfí.

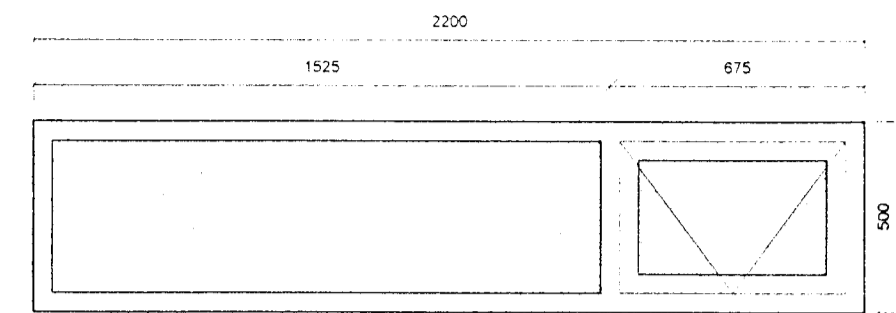

G-16, 1 stk. Efri brún 1600 mm yfir gólfí.

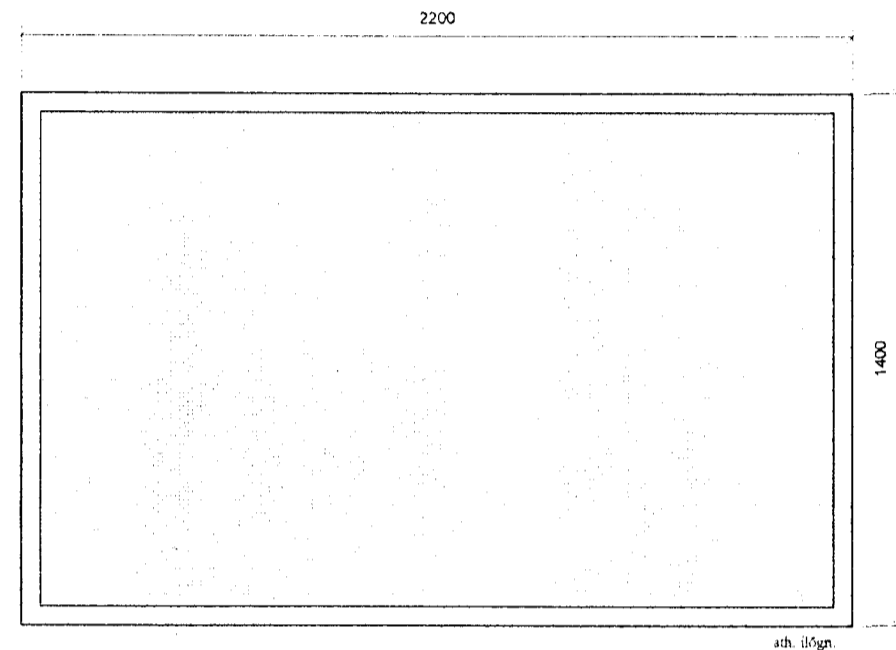

G-15, 1 stk. Efri brún 1400 mm yfir gólfí.

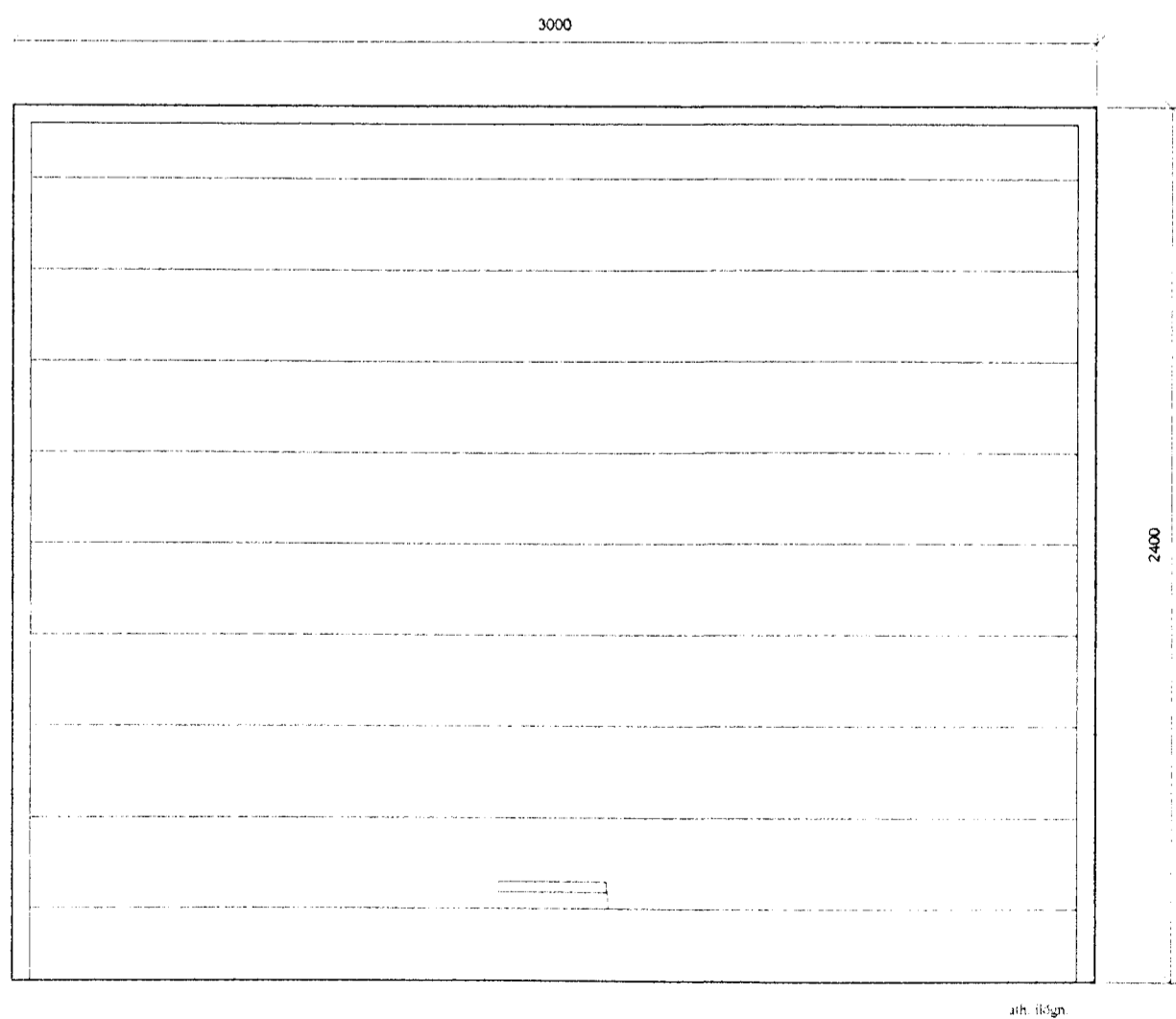

H-1, 1 stk. Efri brún 2400 mm yfir gólfí.

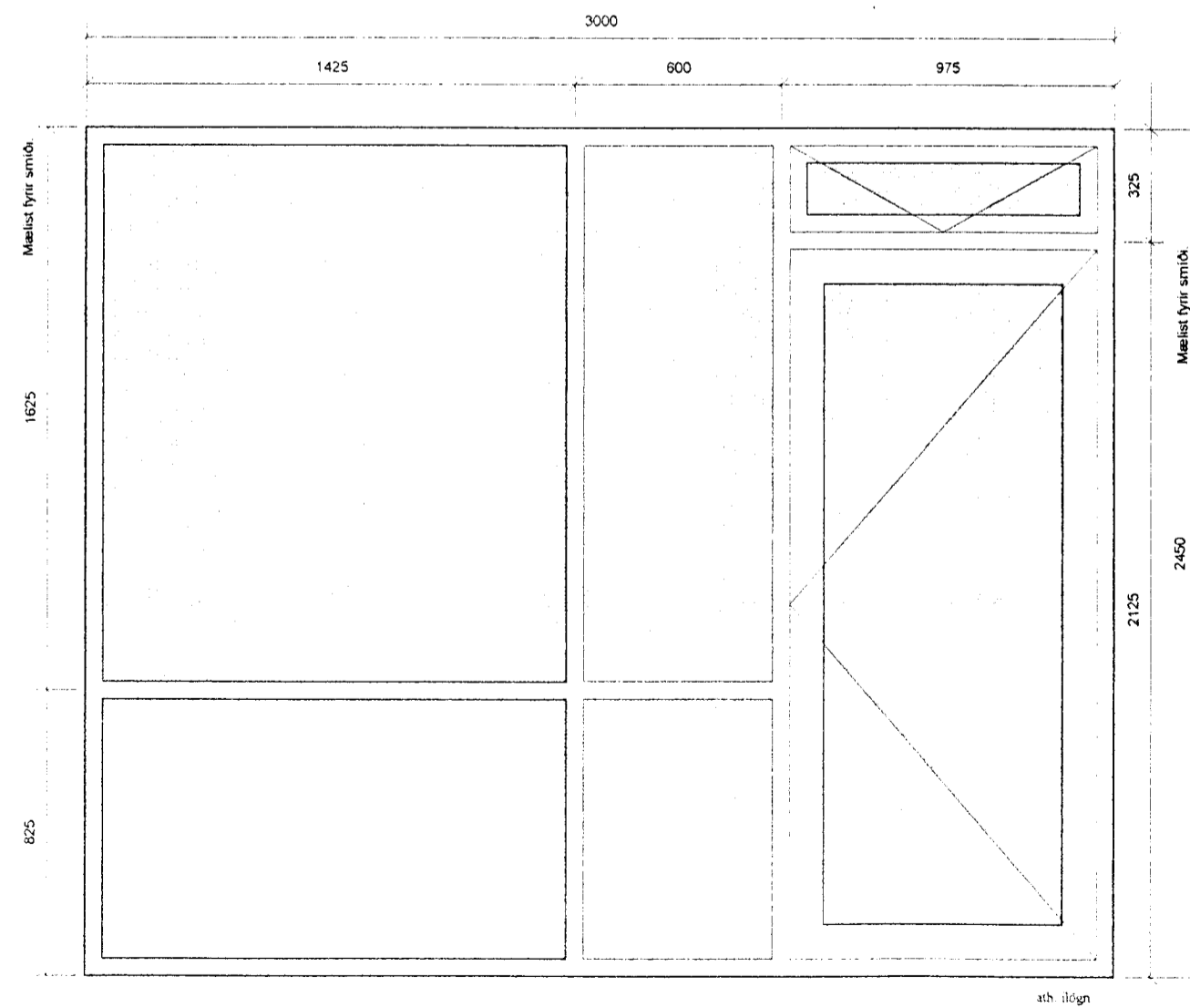

GH-2, 1 stk. Efri brún 2450 mm yfir gólfí.

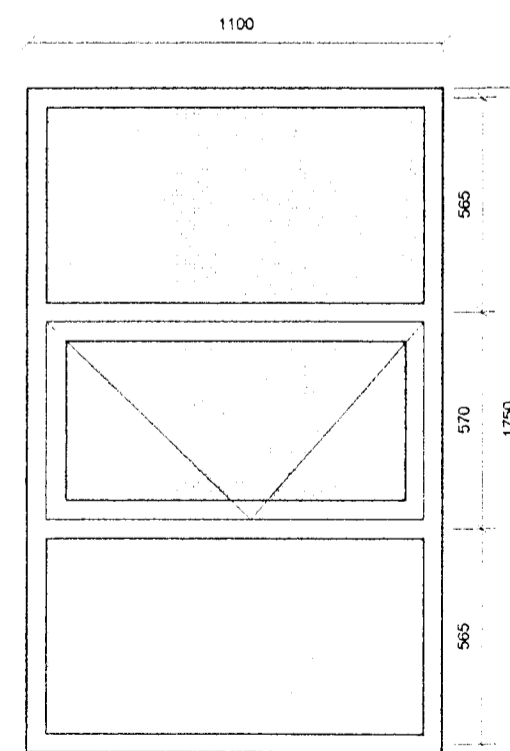

G-6, 3 stk. Efri brún 2150 mm yfir gólfí.

Sérupprættir vegna Hamrabýggða 14
Dagsetning aðaluppdráttá 16.06 1999

- * Öll mál athugist á staðnum
- * Mælið ekki af teikningunni
- * Misræmi milli teikninga tilkynnist arkitektum

Verk: Hamrabýggð 14

Teikning: Gluggar og gluggahurðir

Unnið fyrir: Henning Þorvaldsson

Mælikvarði: 1:20
Dagsetning: 08.07.99
Teiknað: GJ.GP.KR.GÓJ
Teikning nr: 9923-2001

Breytingar:

LANDNÁMSMENN
arkitektar Ingólfsstræti 8
101 Reykjavík s: 562 1669 f: 562 1695

Gunnlaugur Jónasson arkitekt FAÍ, 090462 2299
Gunnlaugur Ó. Johnson arkitekt FAÍ, 080657 7819

Gunnar Páll Kristinsson arkitekt, 260665 3679

Vinnustofa Ingólfsstræti 8,
Sími: 552-5299, Fax: 562-1695.

