

KVISTUR

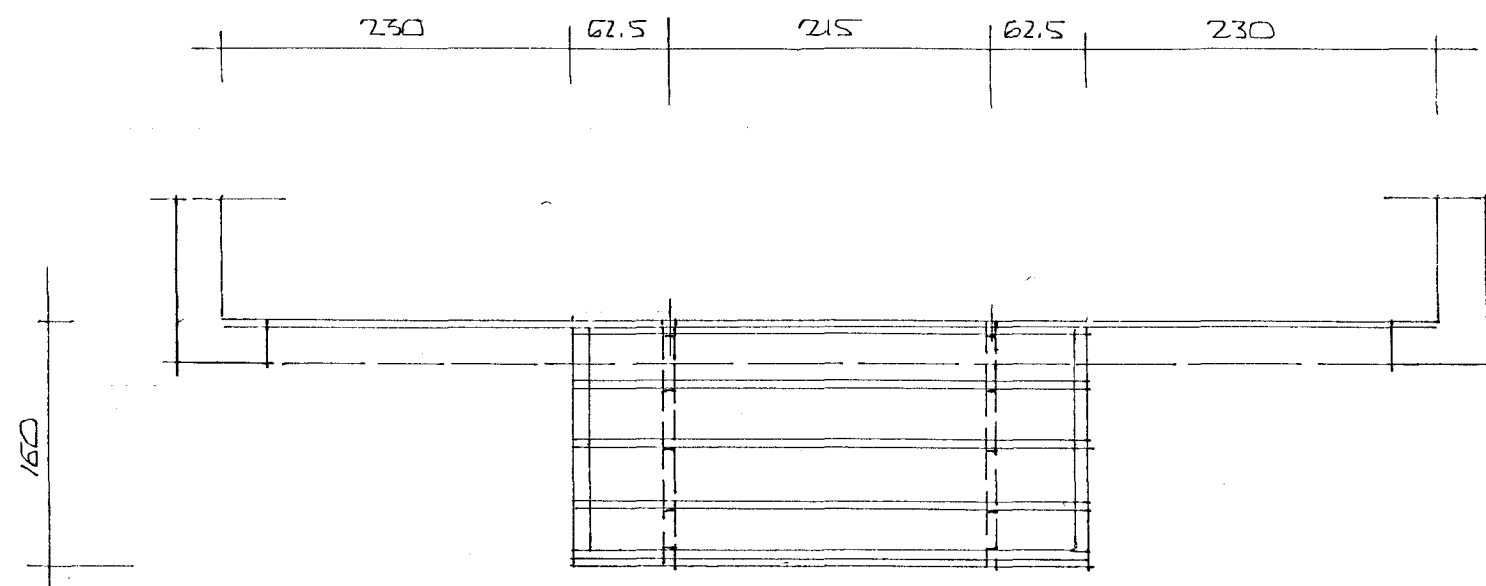

SVALIR, GRUNNMYND

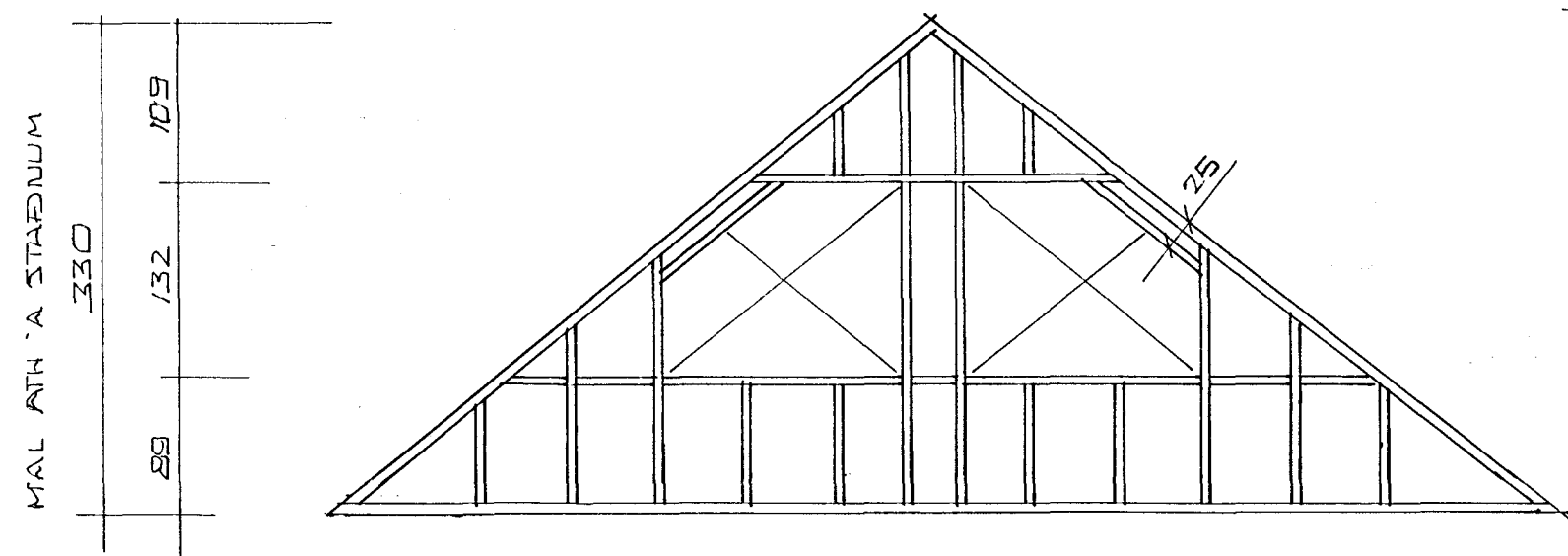

AUSTURGAFL

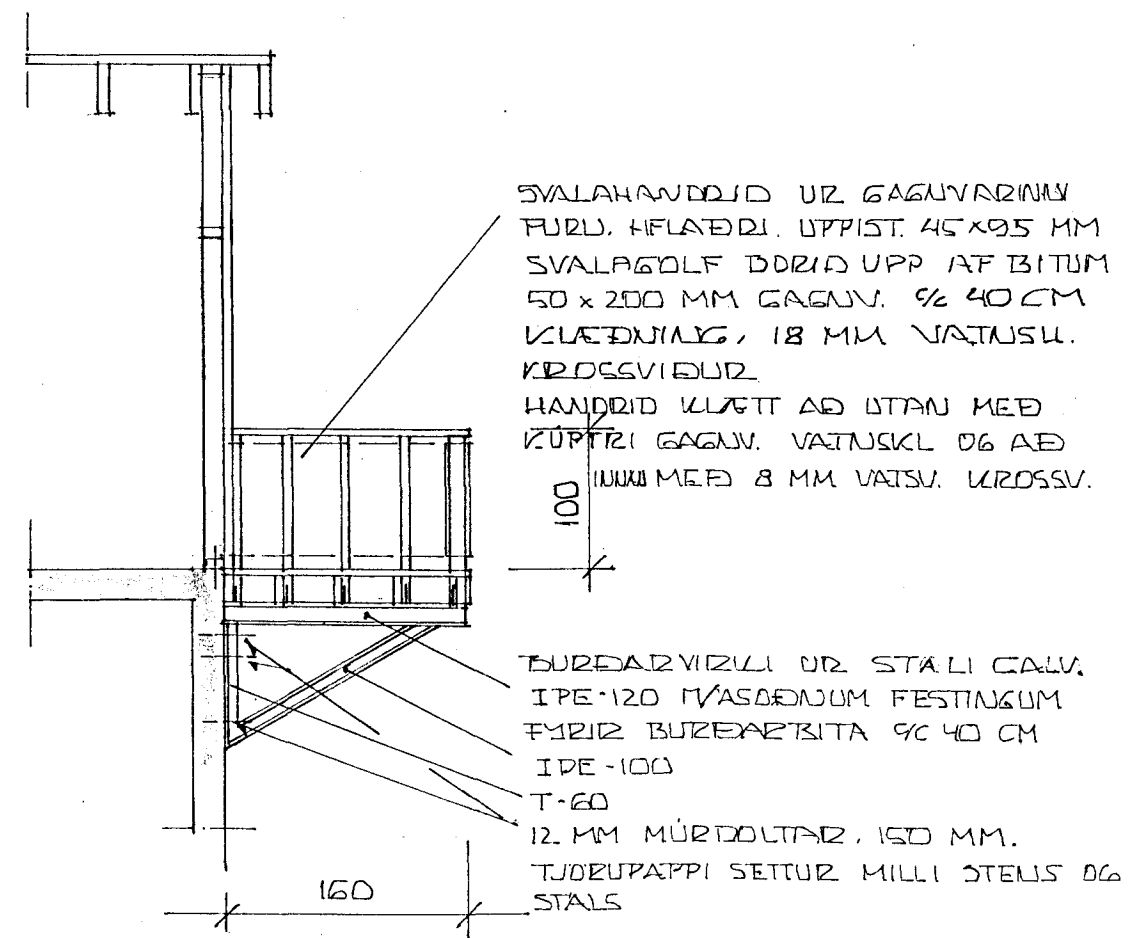

SVALIR OG SVALAHANDRIF

SVALAHANDRIF UR GAGNVARINUM
 FURU. HFLAÐRI. UPPIST 45x95 MM
 SVALAÐOLF DRIÐ UPP AF BITUM
 50 x 200 MM GAGN. 9/2 40 CM
 KLÆÐNING, 18 MM VATUSU.
 KRÖSVIDUR
 HANÐIÐ KLÆTT AÐ UTAN MEÐ
 KÚPFI GAGN. VATUSKL 06 AÐ
 1000 MEÐ 8 MM VATSU. KRÖSSV.

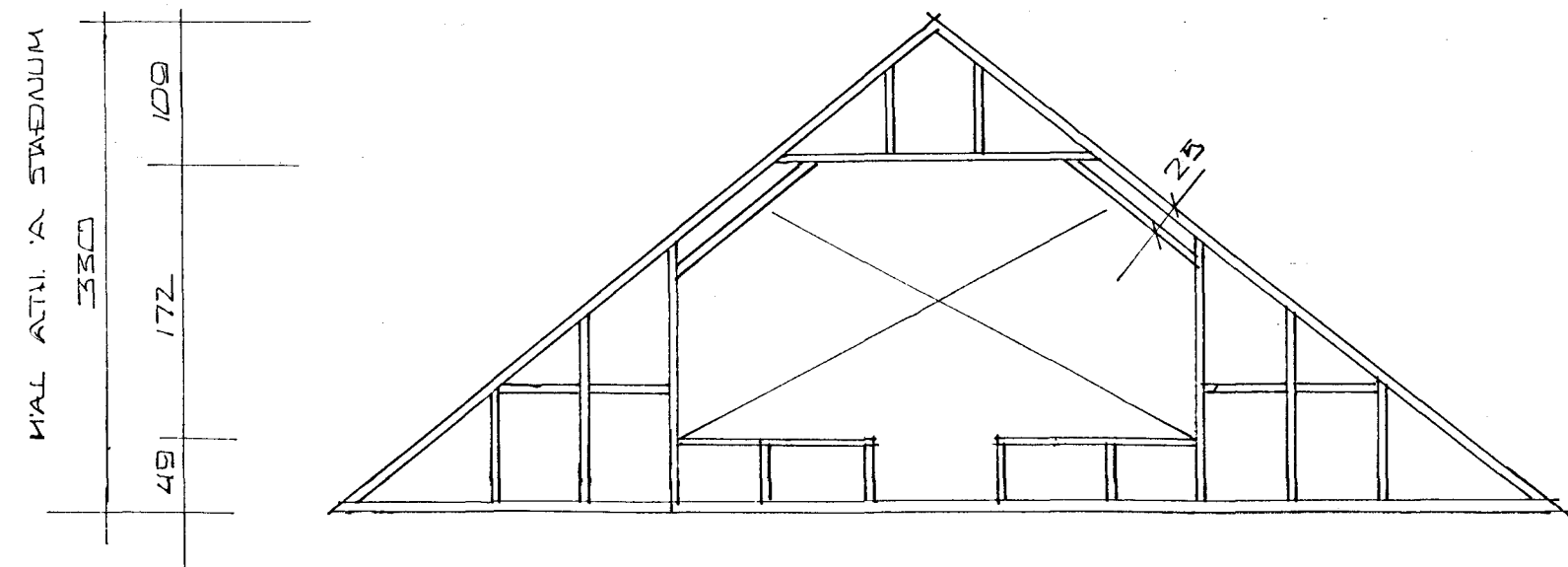

BURÐARVIRKI UR STALI CALV.
 IPE-120 MÍASÐANUM FESTINGUM
 FRIÐ BURÐARBITA 90 40 CM
 IPE-100
 T-60
 12 MM MÚRÐOLTAR, 150 MM.
 TUBERPAKKI SETTUR MILLI STELS OG
 STALS



VESTURGAFL

28 JUNI 1996

HS.

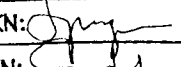
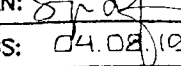
2	14.06.1996	GAFLVEGGUR A KVISTI STEKKADUR	  AF	Hannart SÍÐUMÚLA 1, 108 REYKJAVÍK S: 687317 FAX: 687320 KT.: 670686-1599	REIKN: 	VERK: Hólabraut 8, Hafnarfirði	BLAD: 201	
1	8.09.1995	FRAGANGUR SPEÐA VIKIST GYNDUR			TEIKN: 	DAGS: 04.08.1995	EFNI: Burðarvirki: Gaflar, kvistur og svalir	Mkv. 1:50/20
NR:	DAGS	BREYTING			SAMP:	NR:		