

Stærðir hússins:
 Grunnflötur hússins er: 600,0 m². br.
 Heildarrúmmál hússins er: 2.640,0 m³. br.

01-01 Grunnflötur: 90,0 m². br.
 Efra loft: 28,5 m². br.
 Samtals: 118,5 m². br.
 Rúmmál: 396,0 m³. br.

Samþykkt þann
 06 JAN. 1999
 Byggingatulltrúnni í Hafnarfirði
 Erlendur Hjalmarsson

Stærðir einstakra matshluta eru sem hér segir:

01-02 Grunnflötur: 60,0 m ² . br. Efra loft: 19,0 m ² . br. Samtals: 79,0 m ² . br. Rúmmál: 264,0 m ³ . br.	01-07 Grunnflötur: 60,0 m ² . br. Efra loft: 19,0 m ² . br. Samtals: 79,0 m ² . br. Rúmmál: 264,0 m ³ . br.	01-04 Grunnflötur: 60,0 m ² . br. Efra loft: 19,0 m ² . br. Samtals: 79,0 m ² . br. Rúmmál: 264,0 m ³ . br.	01-05 Grunnflötur: 120,0 m ² . br. Efra loft: 19,0 m ² . br. Samtals: 139,0 m ² . br. Rúmmál: 528,0 m ³ . br.	01-04 Grunnflötur: 60,0 m ² . br. Efra loft: 19,0 m ² . br. Samtals: 79,0 m ² . br. Rúmmál: 264,0 m ³ . br.	01-03 Grunnflötur: 60,0 m ² . br. Efra loft: 19,0 m ² . br. Samtals: 79,0 m ² . br. Rúmmál: 264,0 m ³ . br.	01-02 Grunnflötur: 90,0 m ² . br. Efra loft: 28,5 m ² . br. Samtals: 118,5 m ² . br. Rúmmál: 396,0 m ³ . br.
--	--	--	--	--	--	---

01-06 Grunnflötur: 60,0 m². br.
Efra loft: 19,0 m². br.
Samtals: 79,0 m². br.
Rúmmál: 264,0 m³. br.

01-05 Grunnflötur: 120,0 m². br.
Efra loft: 19,0 m². br.
Samtals: 139,0 m². br.
Rúmmál: 528,0 m³. br.

01-04 Grunnflötur: 60,0 m². br.
Efra loft: 19,0 m². br.
Samtals: 79,0 m². br.
Rúmmál: 264,0 m³. br.

01-03 Grunnflötur: 60,0 m². br.
Efra loft: 19,0 m². br.
Samtals: 79,0 m². br.
Rúmmál: 264,0 m³. br.

01-02 Grunnflötur: 90,0 m². br.
Efra loft: 28,5 m². br.
Samtals: 118,5 m². br.
Rúmmál: 396,0 m³. br.

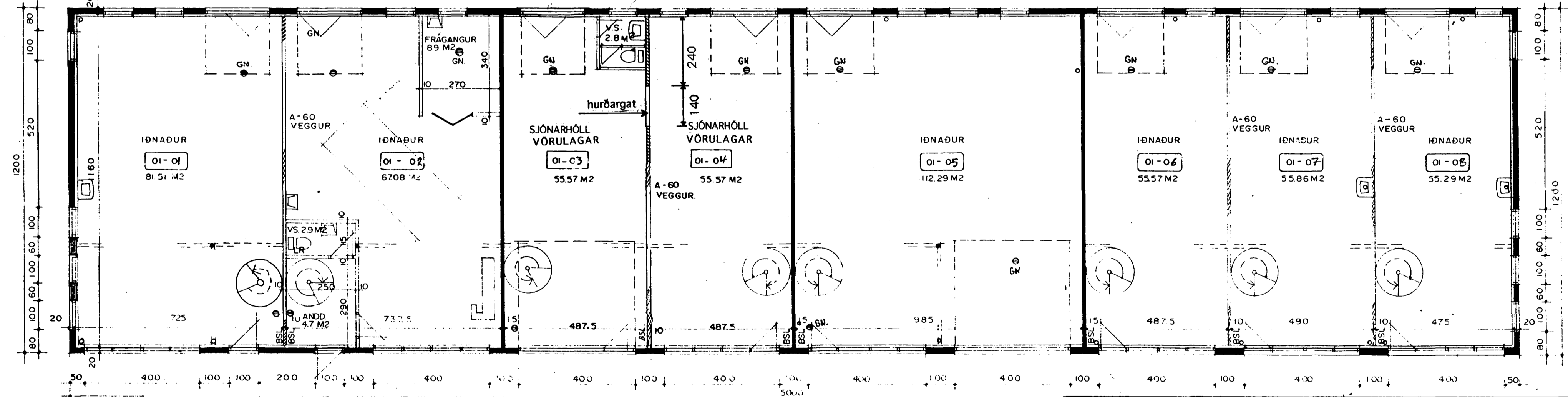
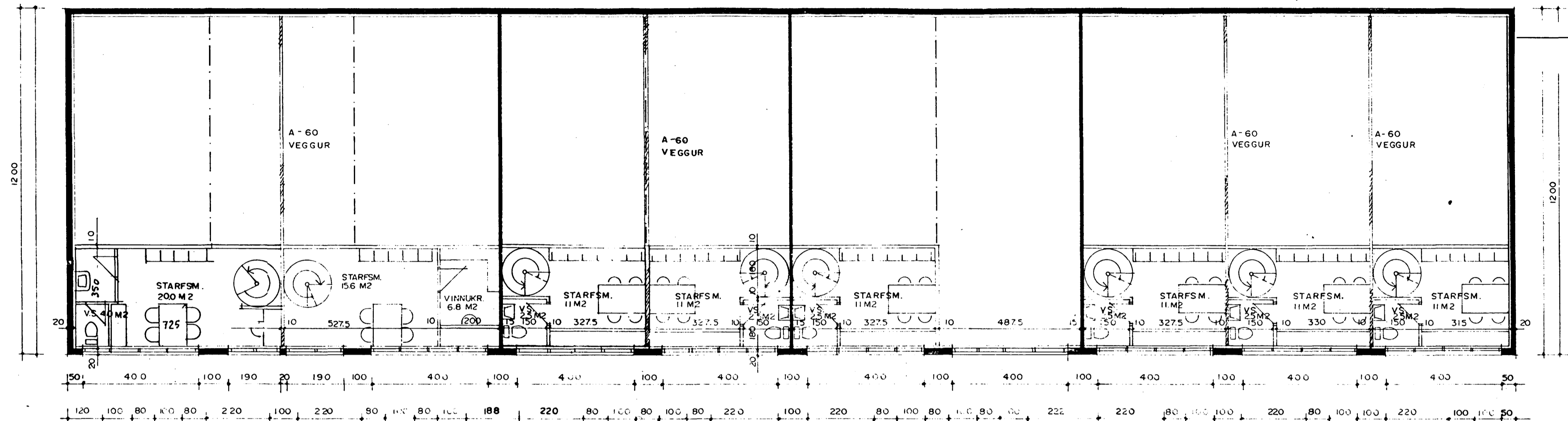

BREYTT Í DESEMBER 1998
 BREYTT TEIKNING FRÁ SIGURÐI ÞORVARDARSYNI BFÍ
 DAGS. MAÍ 1991 BR. NÓV. 1992
 HURÐARGAT Á MILLI EININGA 01-03 OG 01-04

TEIKNISTOFAN KVARDI	Verkefni HÓLSHRAUN 5 HAFNARFIRÐI	kvarði 1 : 100	verk.nr.
	Heiti GRUNNMYNDIR 1 OG 2 HÆÐ	dags. 28. DES. 98"	týpa nr.
		hönnun G.G.	teikn nr. A - 1
		teikn G.G.	

Hringbraut 17, 220 Hafnarfirði s. 52020