

ROOF INSULATION  
(SCALE 1/125)

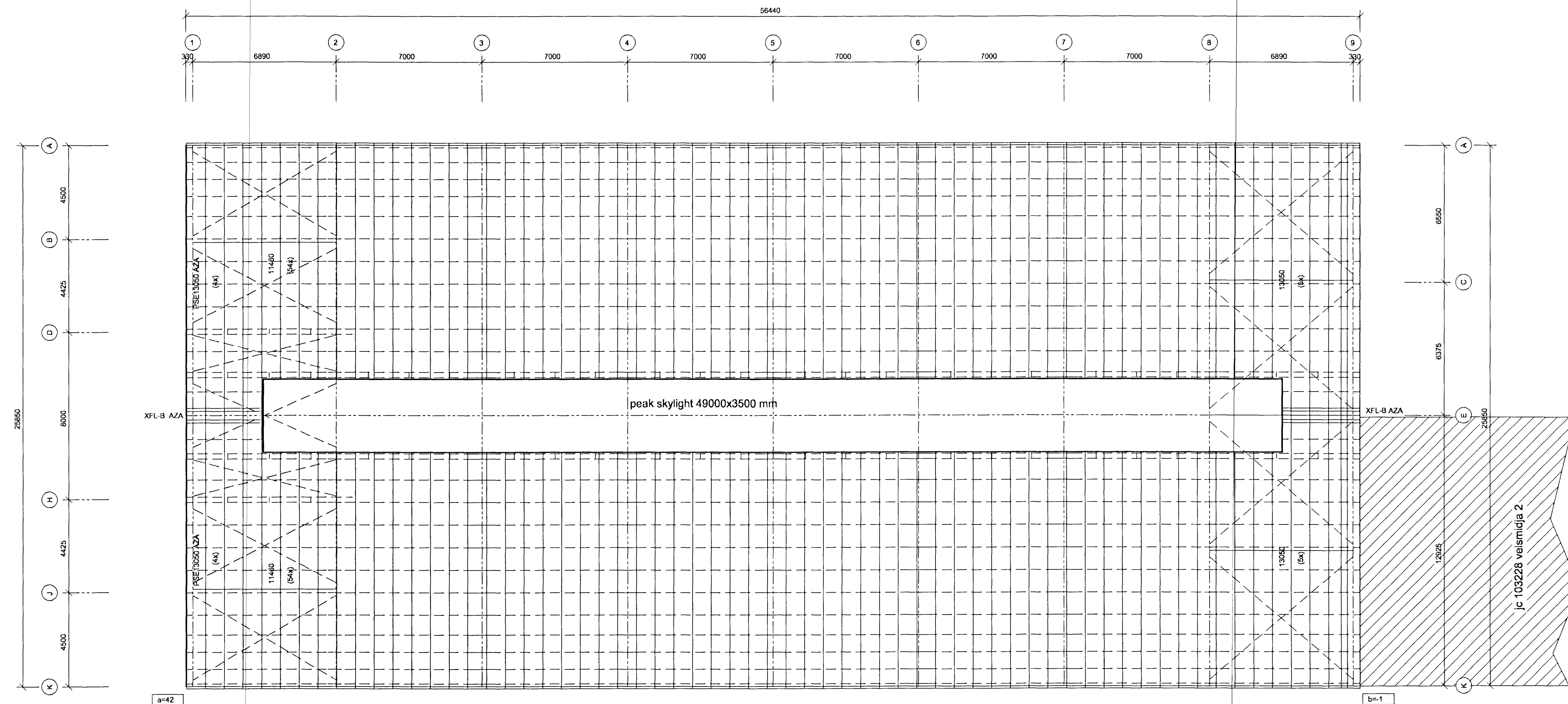

DOUBLE SKIN ROOF (LOWER SKIN)  
(SCALE 1/125)

ÚS OG RÁÐGJÖF ehf.  
ARKITEKTUR OG VEIÐFRÆÐISVEÐLA  
Kt. 510393-2529 - Vsk. 37.600  
Skúlagata 63 - 105 Reykjavík  
Sími 562-2120 - Fax 562-2190  
21. September 2002  
Jóni A. Samuelsen

FORM+RYMI  
Bryggjastígur 10, 101 Reykjavík  
15 APR. 2002  
VGE

- TECHNICAL NOTES
1. Drawings to read in conjunction with ASTRON technical manual
  2. All measures in millimeters
  3. \* = Field adapted
  4. Design of foundations by local engineer
  5. Applicable column reactions see chart "Foundation Reactions"
  6. Purlin spacings are rounded to mm and cannot be added
  7. Flange bracing installation per standard detail W1 chapter
  8. Field locate roof openings and accessories
  9. Compensation of panel tolerance currently during installation
  10. Unless noted differently:
    - 1) Purlin diaphragms - At peak (see W316, W326, W327)
      - Double purlins (see W311, W321)
    - 2) Wind bracing details, see chapter W2
    - 3) Roof stabilisation if necessary:
      - Purlin spacers (HSA, HSB, HSC, HSD, SEE W37 AND W38)
      - Sag rods (RSG...) see W6 and cross section
      - Tie straps (HC 250) see W7 chapter
  11. Field cut and adapt girts and panels shown in overlap with an accessory element

This design is Astron property, copying and manufacturing components according to these drawings or calculations is illegal.

DET: 5T19	J201	J203	L201	L202	L203	L204	L205
<p>ÍSHELLA 10</p> <p>PRD: VEISMIÐJA 1 - ICELAND</p> <p>BUILDING: AZM1 18.6% SPAN 25.850m EH7.822m L56.44m ALT:</p> <p>LOADS: LL/M/L/AdL: 100/165/30 (3a/Nm2)</p>							<p>4x 07/06/01</p> <p>Stalex EHF.</p> <p>TRANSMITTALS</p>
<p>NORMS: PRIM. AISI SEC. AISI</p> <p>MENBR - 18/19</p>							<p>103065</p> <p>RF-3</p> <p>DATE: 06/06/01</p> <p>ENG.: P.FAULTSCH</p> <p>DRAF: T.BRUEGGEMANN</p>
<p>ASTRON</p> <p>COMMERCIAL INTERTECH S.A. - P.O.Box152 - L-9202 DIEKIRCH-LUXEMBOURG - tel:352/802911</p>							