

VATNSLÖGN GRUNNMYND EFRI HÆDA 1:50

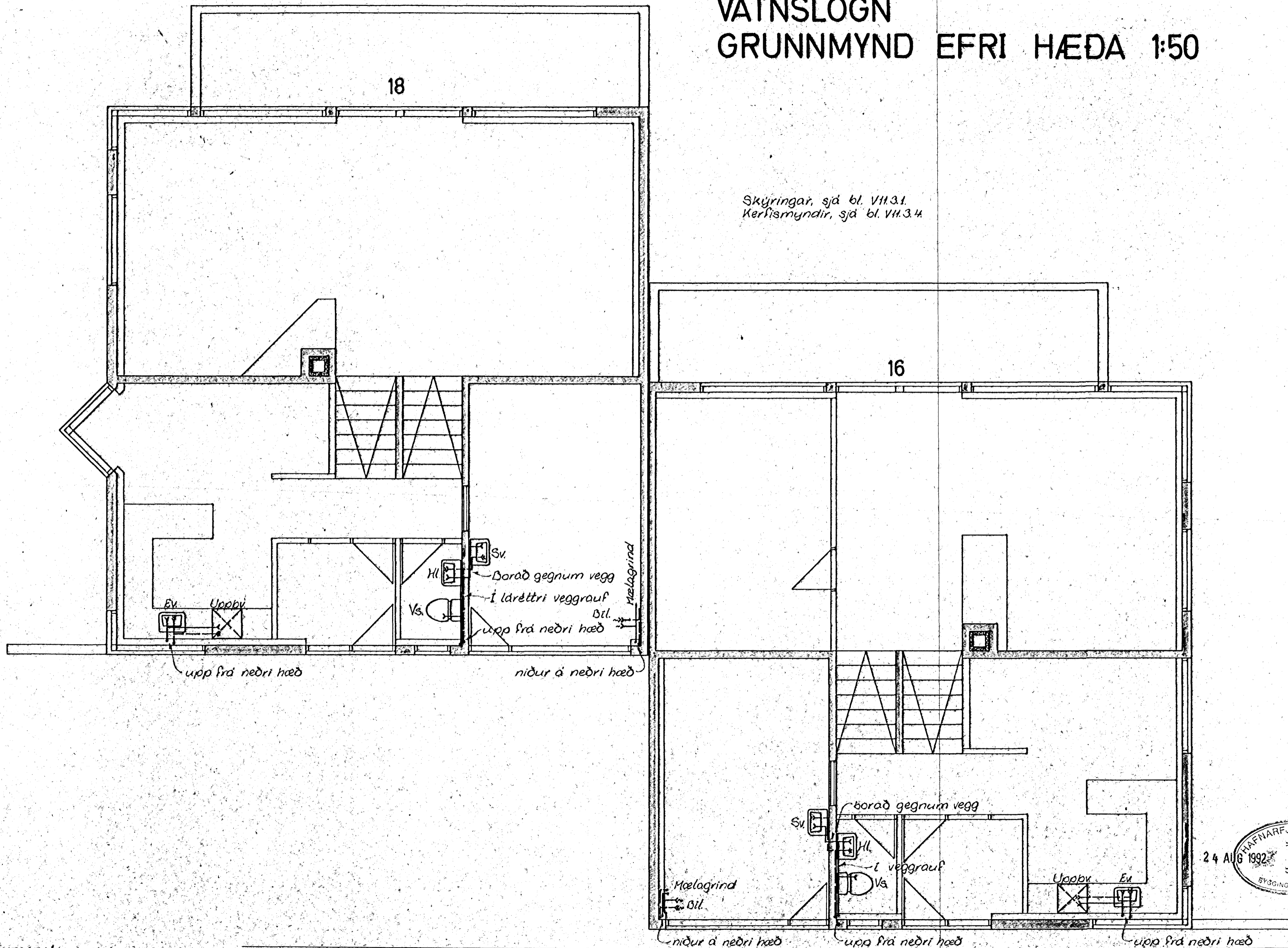

Skýringar, sjá bl. VII.3.1.
Kerfismyndir, sjá bl. VII.3.4.

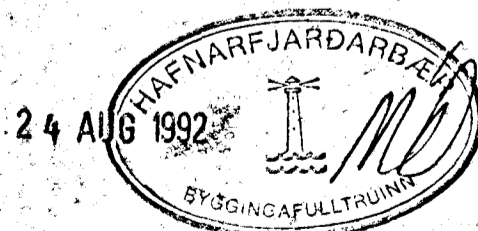

KRISTJÁN S. GUÐMUNDSSON
verkfræðingur FVFI
Snorrabraut 81 s 18293

Kristján S. Guðmundsson

VERKEFNI KLUKKUBERG 16-18 HAFNARFI.
HEITI VATNSLÖGN: GRUNNMYND EFRI HÆDA

M. 1:50
T. K.S.G.
R. K.S.G.
DAGS. DES. 91

NR. VII.3. 3