

Ser. lýkt á fundi bygginga-  
nefna nr. p. 10.8.1989  
BYGGINGAFULLTRÚINN  
Í HAFNARFIRÐI  
Eyjólfur Valgandsson

LÆKJARBERG

LÓÐ: 959,6 M<sup>2</sup>  
HÚS: 209,4 M<sup>2</sup>  
680 m<sup>3</sup>

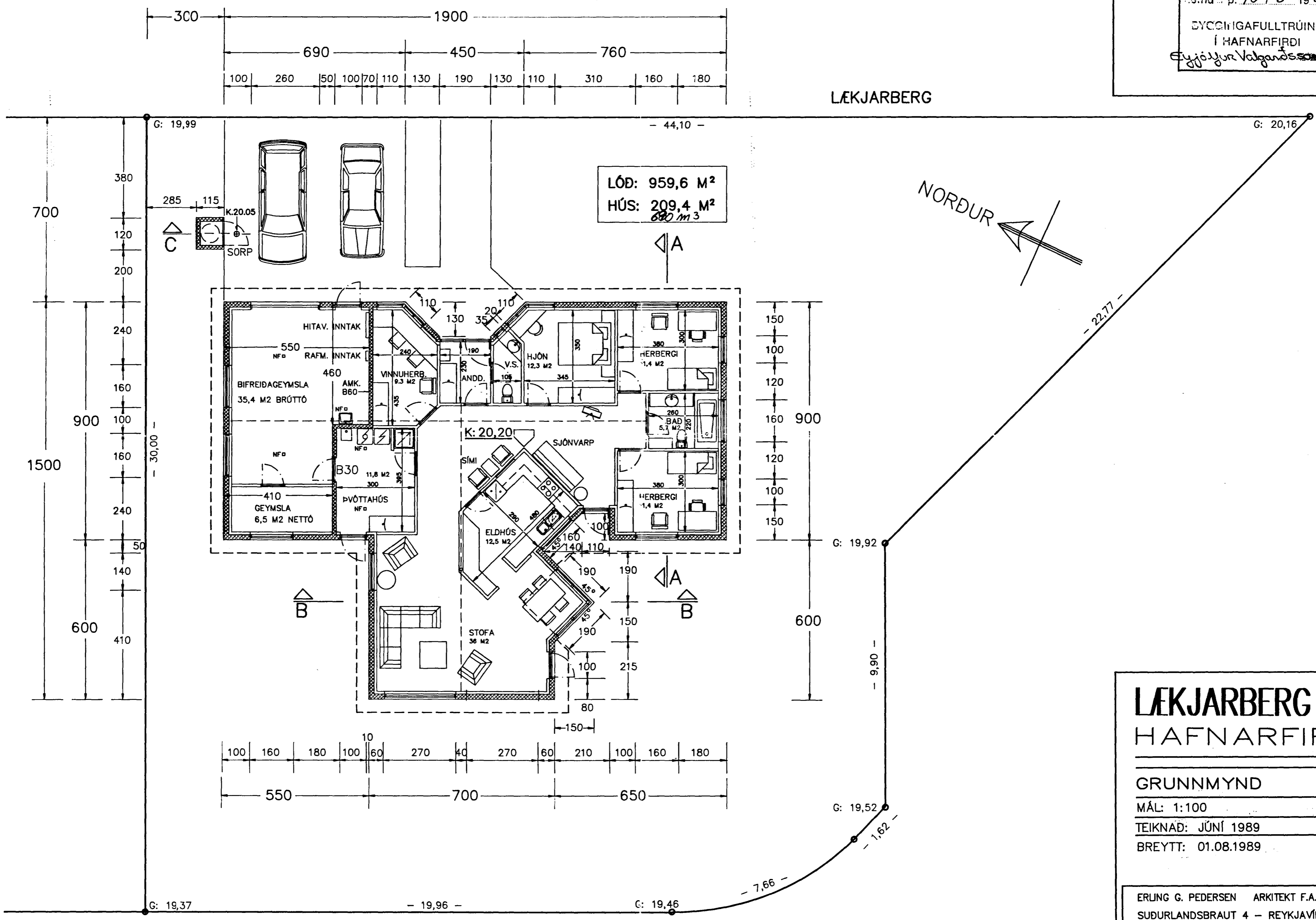
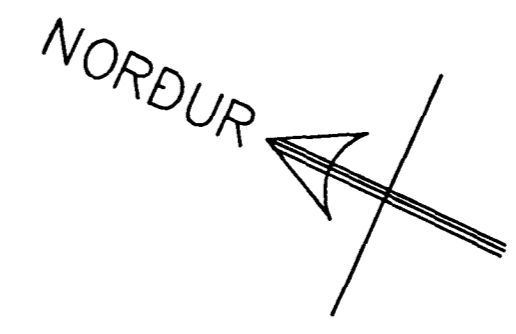

**LÆKJARBERG 28**  
**HAFNARFIRÐI**

GRUNNMYND  
MÁL: 1:100  
TEIKNAD: JÚNÍ 1989  
BREYTT: 01.08.1989

ERJUNG G. PEDERSEN ARKITEKT F.A.Í.  
SUBURLANDSBRAUT 4 - REYKJAVÍK

*Erjung G. Pedersen*