

PART-NO	PRIMARY FRAMING SIZE CHART			APPROX. SHIP LENGTH
	FLG THK X WD	WEB THK	DEPTH	
FL2CX7	9.52 X 127	4.8	306/836	4674
FL2RBX8	9.52 X 127	4.8	865/304	5138
FL2RBX9	7.94 X 127	3.4	302/636	4581
	9.52 X 127	4.8	637/304	4581
FL2CX10	9.52 X 127	4.8	306/811	4672
RBX5002	4.76 X 152	4.8	1646/1646	1646
RBX5007	4.76 X 152	4.8	1646/1646	1646

A325 BOLT CONNECTION CHART			
No	Qty	Diameter	Length
1	18	19	51
2	8	19	51
3	20	19	51

FRAME CLEARANCES
 Vertical Clearance Under Frame at FL2CX7 = 4474
 Vertical Clearance Under Frame at FL2CX10 = 4472
 Horizontal Clearance Between FL2CX7 & FL2CX10 = 17691
 Finished Floor Elevation = 10000 (Unless Otherwise Noted)
 All Dimensions are in millimeters [mm.] -Unless Noted

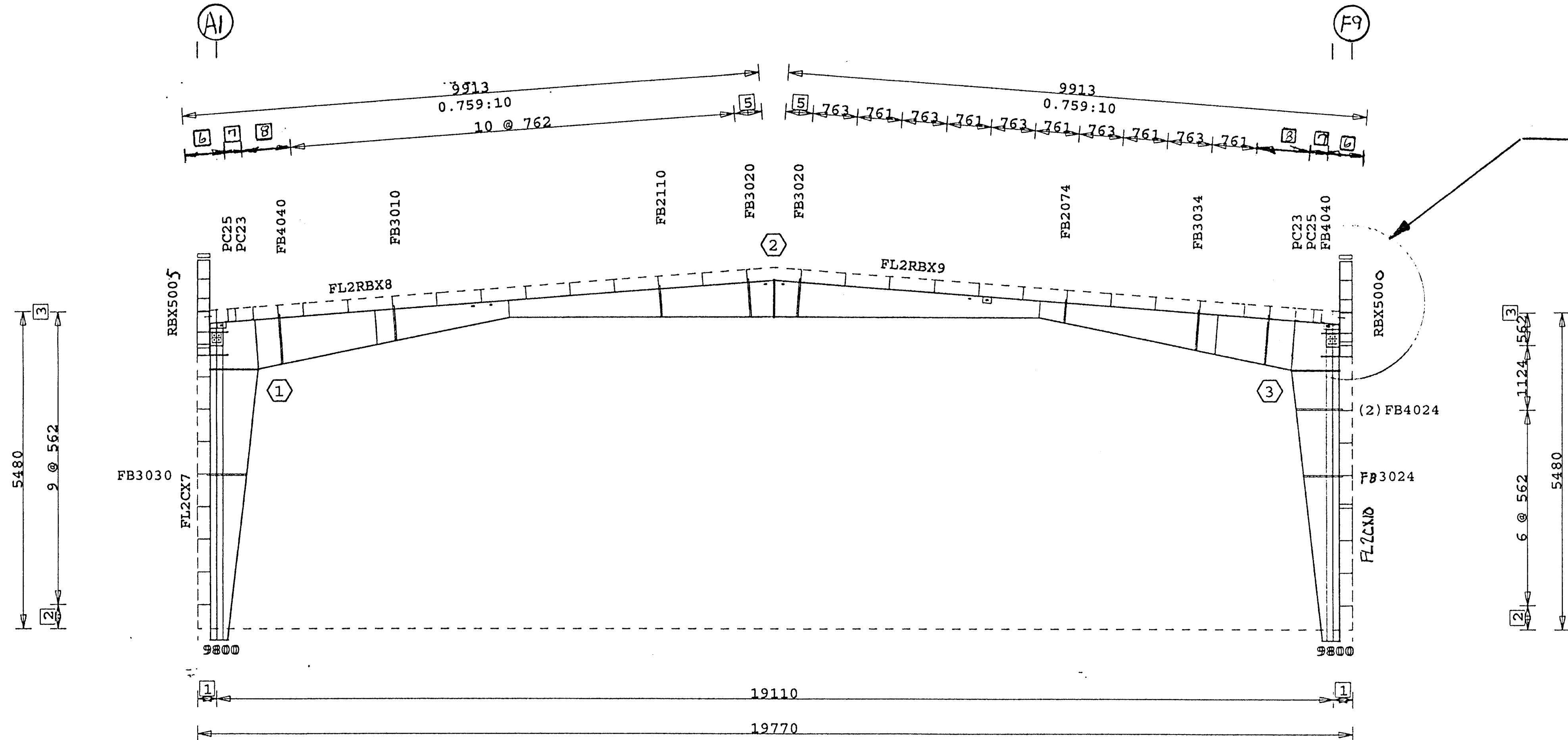
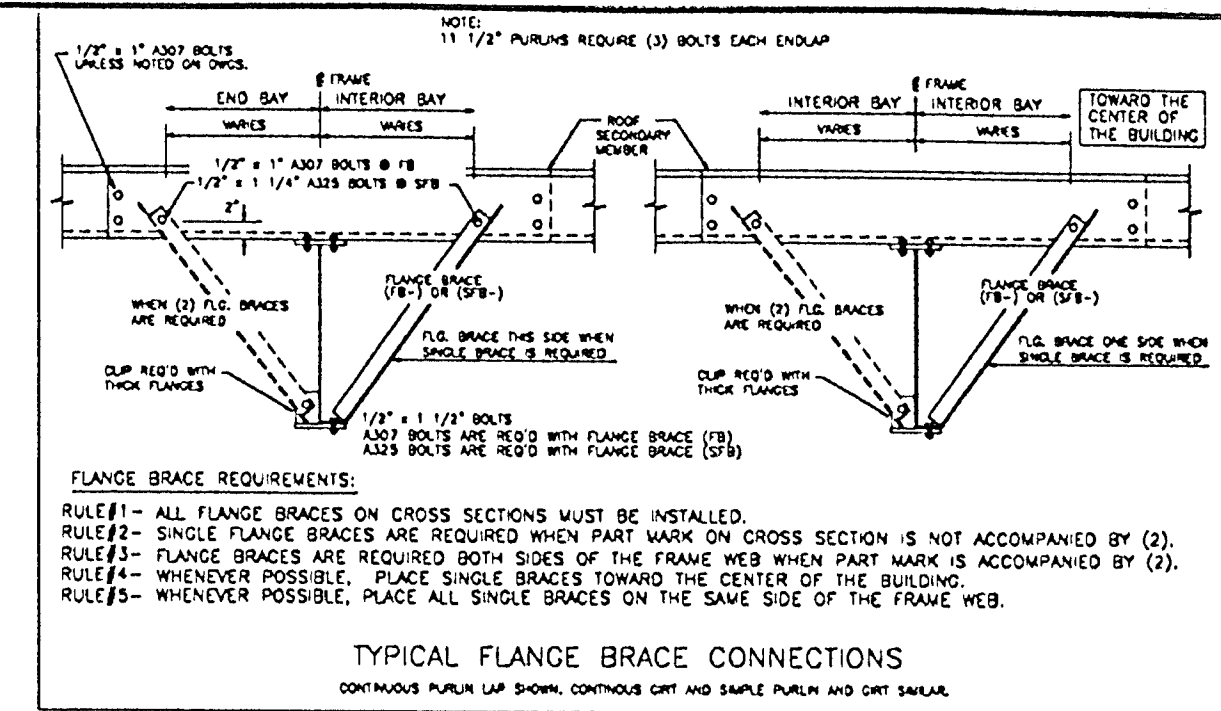

- 8 2 @ 433
- 7 3 @ 3
- 6 650
- 5 473
- 4 85
- 3 8
- 2 414
- 1 330

SEE A325 BOLT CONNECTION CHART

Elevation at Frame Line 2

Verkfræðistofa Norðurlands ehf.
 Hofsbót 4 600 Akureyri. kt. 560175-0869
 Eiríkur Jónsson byggingaverkfr.
 kt. 051045-4679

VERKFRÆÐISTOFA NORÐURLANDS ehf.

Byggingafráttir Hainarfarðar
 Algrett þenn
 20 MARS 2000
 Sigurbjartur Halldórsson

On: filesrv Projky: 38890 Bldg: 1 Plane: 9		This Drawing is Sealed only as to the Components furnished by VP Buildings		QUOTE # ME99012531-001		JOB # 70314-01-OE-	
1. A325 HIGH STRENGTH BOLTS SHALL BE TIGHTENED IN ACCORDANCE WITH THE NOVEMBER 13, 1985, ALLOWABLE STRESS DESIGN "SPECIFICATION FOR STRUCTURAL JOINTS USING ASTM A325 OR A490 BOLTS" SECTION 8. (d) (1) "TURN-OF-NUT TIGHTENING".		Building Code: 86MBMA		This Drawing, including the information hereon, remains the property of VP Buildings.		FRAME ELEVATION	
2. USE 1/2" DIA. A307 BOLTS FOR PURLIN TO FRAME, GIRT TO FRAME, AND GIRT TO CLIP CONNECTIONS UNLESS NOTED OTHERWISE. SEE JOB DETAILS FOR BOLT LENGTHS.		Live Ld (W/Trib Red) 102.5 kgsm		It is provided for Erecting the Building described in the applicable Purchase Order and shall not be modified, reproduced or used for any other purpose without prior Written Approval of VP Buildings.		REV DATE BY DESC. BUILDER	
3. INSTALLATION OF ADEQUATE TEMPORARY BRACING FOR USE UNTIL CONSTRUCTION IS COMPLETE, IS THE RESPONSIBILITY OF THE ERECTOR.		Coll. Ld (gravity): 24.4 kgsm		The General Contractor, and/or Erector is solely responsible for accurate, good Quality Workmanship in erecting this Building in conformance with this Drawing. Details referenced in this Drawing, all applicable VP Buildings Erection Details and all industry standards pertaining to proper erection, including the correct use of temporary bracing.		CUSTOMER Varco-Pruden Exports	
		Coll. Ld (uplift): 0.0 kgsm				LOCATION Sindri	
		Wind Speed: 170.6 kmph				PROJECT Sindri Workshop	
		Wind Exp. Cat.: C				BUILDING workshop 1	
		Ground Snow: 146.5 kgsm				SCALE NTS	
		Roof Snow: 102.5 kgsm				DATE 07/26/99	
		Snow Exp. Cat.: 3				TIME 07:43	
		Seismic Zone: 3				DRAW/CHECK D46	
		Building Use Cat.: 1				PAGE 5	
		Auxiliary Loads NONE				VP BUILDINGS VARCO-PRUDEN	