

PRIMARY FRAMING SIZE CHART					
PART-NO	FLG THK X WD	WEB THK	DEPTH	APPROX. SHIP	LENGTH
FL5CX22	6.35 X 178	4.2	179/811	4723	
FL5RBX23	6.35 X 127	4.2	814/329	5138	
	4.76 X 127	3.4	328/662	4581	
FL5RBX24	4.76 X 127	3.4	665/227	4581	
	7.94 X 127	4.8	230/918	5137	
FL5CX25	7.94 X 127	4.2	179/811	4623	
RBX5002	4.76 X 152	4.8	1646/1646	1646	
RBX5007	4.76 X 152	4.8	1646/1646	1646	

A325 BOLT CONNECTION CHART				
No	Qty	Diameter	Length	
1	18	19	44	
2	8	19	44	
3	20	19	44	

FRAME CLEARANCES
 Vertical Clearance Under Frame at FL5CX22 = 4513
 Vertical Clearance Under Frame at FL5CX25 = 4413
 Horizontal Clearance Between FL5CX22 & FL5CX25 = 17716
 Finished Floor Elevation = 10000 (Unless Otherwise Noted)
 All Dimensions are in millimeters [mm.] -Unless Noted

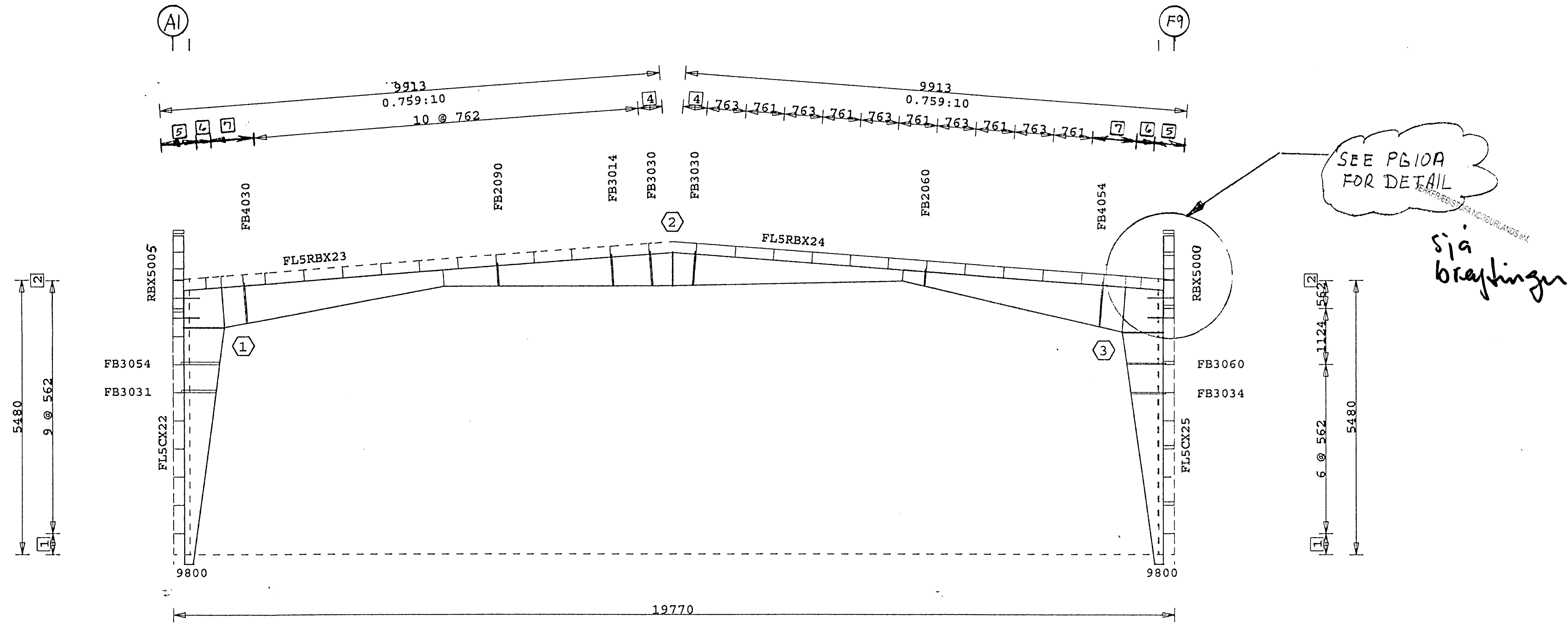
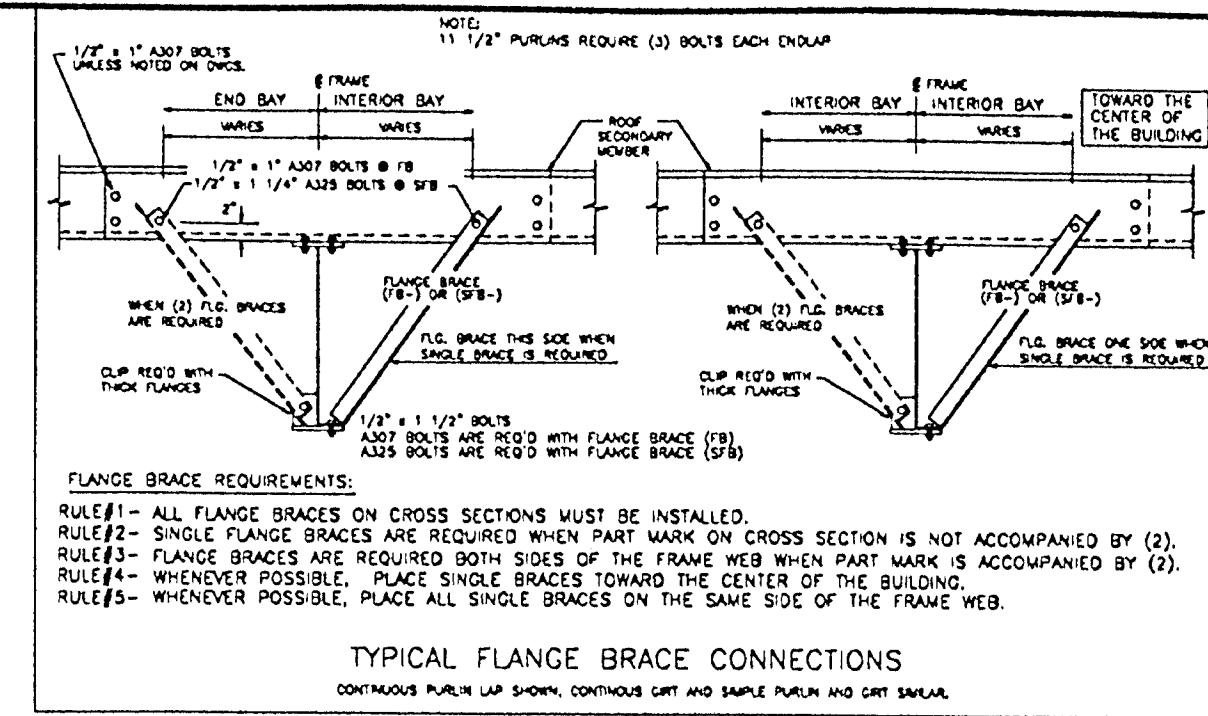

- 1 20433
- 2 303
- 3 613
- 4 473
- 5 85
- 6 8
- 7 414

SEE A325 BOLT CONNECTION CHART

Elevation at Frame Line 5

Verkfræðistofa Norðurlands ehf.
 Hoðsbót 4 600 Akureyri, kt. 560175-0869
 Eiríkur Jónsson byggingaverkfr.
 kt. 051045-4679

Bygginguulfrúli Hafnarjarðar
 Algrótt þann
 20 MARS 2000
 Sigurbjörgur Pálsson

On: filesrv Projky: 38890 Bldg: 1 Plane: 12		This Drawing is Sealed only as to the Components furnished by VP Buildings		Building Code: 86MBMA Live Ld(W/Trib Red): 102.5 kgsm Coll. Ld (gravity): 24.4 kgsm Coll. Ld (uplift): 0.0 kgsm Wind Speed: 170.6 kmph Wind Exp. Cat.: C Ground Snow: 146.5 kgsm Roof Snow: 102.5 kgsm Snow Exp. Cat.: 3 Seismic Zone: 3 Building Use Cat.: 1 Auxiliary Loads: NONE		This Drawing, including the information hereon, remains the property of VP Buildings. It is provided for Erecting the Building described in the applicable Purchase Order and shall not be modified, reproduced or used for any other purpose without prior Written Approval of VP Buildings. The General Contractor and/or Erector is solely responsible for accurate, good Quality Workmanship in erecting this Building in conformance with this Drawing. Details referenced in this Drawing are all applicable VP Buildings erection Details and all Industry Standards pertaining to proper erection, including the correct use of temporary bracing.		Frame Elevation REV DATE BY DESC. BUILDER Varco-Pruden Exports CUSTOMER Sindri LOCATION Iceland, PROJECT Sindri Workshop BUILDING workshop 1 SCALE NTS		QUOTE # ME99012531-001 ME9970314-01-0E JOB # 70314-01-0E DATE 07/26/99 TIME 07:43 DRAW/CHECK DHG PAGE 8	
---	--	--	--	--	--	--	--	--	--	--	--

- A325 HIGH STRENGTH BOLTS SHALL BE TIGHTENED IN ACCORDANCE WITH THE NOVEMBER 13, 1985, ALLOWABLE STRESS DESIGN "SPECIFICATION FOR STRUCTURAL JOINTS USING ASTM A325 OR A490 BOLTS" SECTION 8. (d) (1) "TURN-OF-NUT TIGHTENING".
- USE 1/2" DIA. A307 BOLTS FOR PURLIN TO FRAME, GIRT TO FRAME, AND GIRT TO CLIP CONNECTIONS UNLESS NOTED OTHERWISE. SEE JOB DETAILS FOR BOLT LENGTHS.
- INSTALLATION OF ADEQUATE TEMPORARY BRACING FOR USE UNTIL CONSTRUCTION IS COMPLETE, IS THE RESPONSIBILITY OF THE ERECTOR.