

PRIMARY FRAMING SIZE CHART					
PART-NO	FLG THK X WD	WEB THK	DEPTH	APPROX. SHIP LENGTH	
FL2CX5	9.52 X 127	4.8	306/811	4698	
FL2RBX6	9.52 X 127	4.8	840/279	5138	
FL2RBX7	7.94 X 127	3.4	277/610	4581	
	9.52 X 127	4.2	306/862	4423	
	9.52 X 127	6.3	864/867	737	
FL2CX8	9.52 X 127	4.8	306/786	4670	
RBX5001	4.76 X 152	4.8	1589/1589	1589	
RBX5008	4.76 X 152	4.8	1589/1589	1589	

A325 BOLT CONNECTION CHART				
No	Qty	Diameter	Length	
1	20	19	51	
2	8	19	51	
3	20	19	51	

FRAME CLEARANCES
 Vertical Clearance Under Frame at FL2CX5 = 4497
 Vertical Clearance Under Frame at FL2CX8 = 4470
 Horizontal Clearance Between FL2CX5 & FL2CX8 = 17742
 Finished Floor Elevation = 10000 (Unless Otherwise Noted)
 All Dimensions are in millimeters [mm.] -Unless Noted

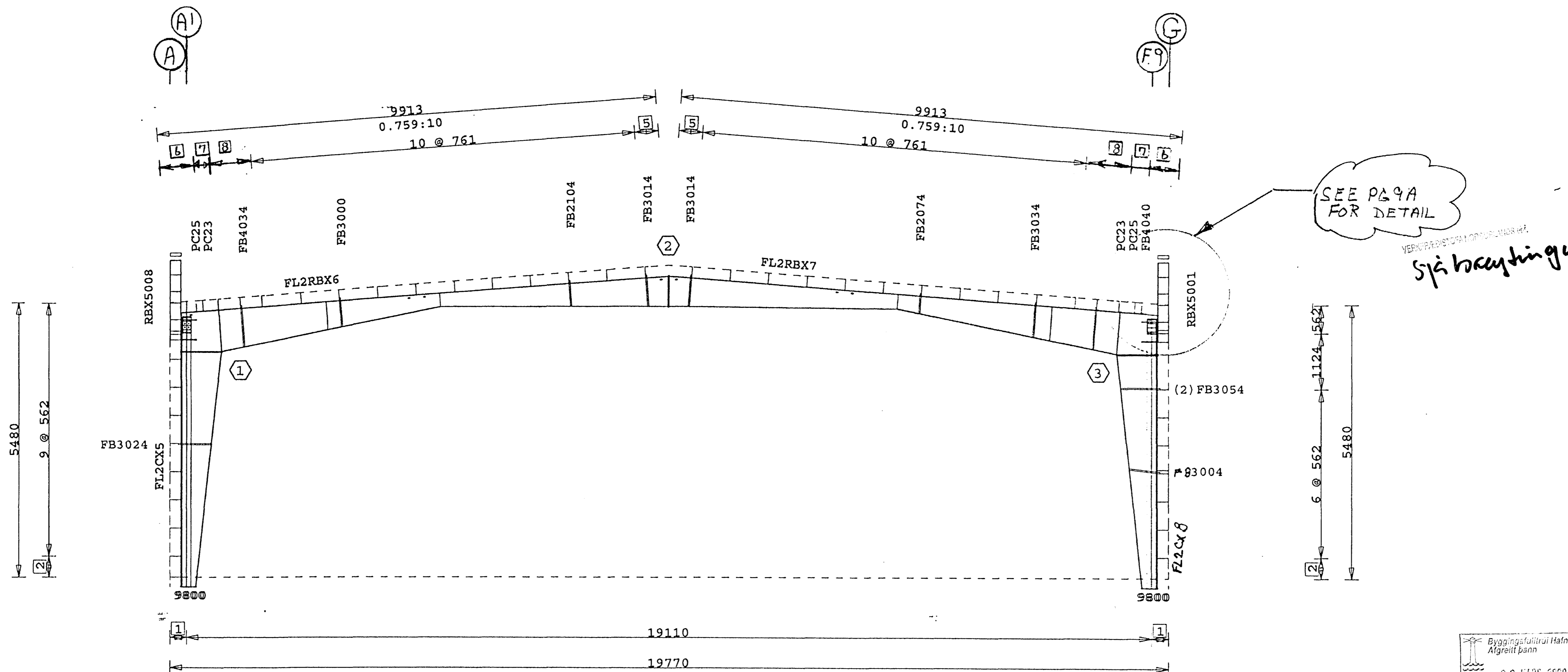
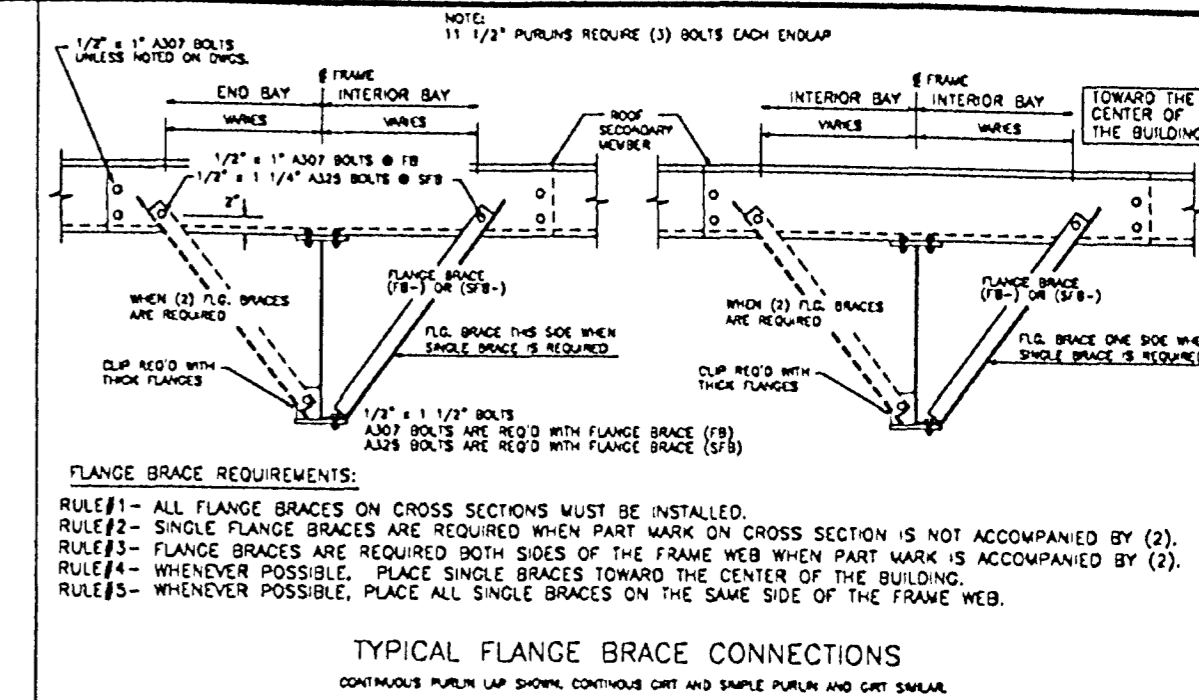

- 8 2 @ 433
- 7 302
- 6 650
- 5 474
- 4 86
- 2 414
- 1 330

SEE A325 BOLT CONNECTION CHART

Elevation at Frame Line 2

On: filesrv Projky: 38890 Bldg: 2 Plane: 9

This Drawing is Sealed only as to the Components furnished by VP Buildings

- A325 HIGH STRENGTH BOLTS SHALL BE TIGHTENED IN ACCORDANCE WITH THE NOVEMBER 13, 1985, ALLOWABLE STRESS DESIGN "SPECIFICATION FOR STRUCTURAL JOINTS USING ASTM A325 OR A490 BOLTS" SECTION 8. (d) (1) "TURN-OF-NUT TIGHTENING".
- USE 1/2" DIA. A307 BOLTS FOR PURLIN TO FRAME, GIRT TO FRAME, AND GIRT TO CLIP CONNECTIONS UNLESS NOTED OTHERWISE. SEE JOB DETAILS FOR BOLT LENGTHS.
- INSTALLATION OF ADEQUATE TEMPORARY BRACING FOR USE UNTIL CONSTRUCTION IS COMPLETE, IS THE RESPONSIBILITY OF THE ERECTOR.

Building Code:	86BMA
Live Ld (w/Trib Red):	102.5 kgsm
Coll. Ld (gravity):	24.4 kgsm
Coll. Ld (uplift):	0.0 kgsm
Wind Speed:	170.6 kmph
Wind Exp. Cat.:	C
Ground Snow:	146.5 kgsm
Roof Snow:	102.5 kgsm
Snow Exp. Cat.:	3
Seismic Zone:	3
Building Use Cat.:	1
Auxiliary Loads	NONE

This Drawing, including the information hereon, remains the property of VP Buildings.
 It is provided for Erecting the Building described in the applicable Purchase Order and shall not be modified, reproduced or used for any other purpose without prior Written Approval of VP Buildings.
 The General Contractor and/or Erector as solely responsible for accurate, good quality workmanship in erecting this building in conformance with this Drawing. Details referenced in this Drawing and all applicable VP Buildings Erection Details and all industry standards pertaining to proper erection, including the correct use of temporary bracing.

REV	DATE	BY	DESC.	BUILDER
				Varco-Pruden Exports
				CUSTOMER: Sindri
				LOCATION: Iceland,
				PROJECT: Sindri Workshop
				BUILDING: workshop 2

QUOTE # ME99012531-001 ME

JOB # 9970314-02-081

DATE 07/26/99

TIME 08:35

VP BUILDINGS
VARCO-PRUDEN

DRAW/CHECK DHG

PAGE 27

Byggingstúinnur Hafnarjarðar
 Algreitt þann
 20 MARS 2000
 Sigurbjartur Halldórsson

Verkfæðistofa Norðurlands ehf.
 Hofsbót 4 600 Akureyri. kt. 560175-0869
 Eiríkur Jónsson byggingaverkf.
 kt. 051045-4679

VERKFRÆÐISTOFA NORÐURLANDS ehf.