

PRIMARY FRAMING SIZE CHART					
PART-NO	FLG THK X WD	WEB THK	DEPTH	APPROX. SHIP START/END	LENGTH
CX9	9.52 X 127	4.8	306/836	4674	
FL5RBX18	9.52 X 127	4.8	865/279	5138	
FL5RBX19	7.94 X 127	3.4	277/661	4581	
	9.52 X 127	4.8	663/279	5138	
CX12	9.52 X 127	4.8	306/811	4672	
RBX5001	4.76 X 152	4.8	1589/1589	1589	
RBX5008	4.76 X 152	4.8	1589/1589	1589	

A325 BOLT CONNECTION CHART				
No	Qty	Diameter	Length	
1	18	19	51	
2	8	19	51	
3	18	19	51	

FRAME CLEARANCES
 Vertical Clearance Under Frame at CX9 = 4474
 Vertical Clearance Under Frame at CX12 = 4472
 Horizontal Clearance Between CX9 & CX12 = 17691
 Finished Floor Elevation = 10000 (Unless Otherwise Noted)
 All Dimensions are in millimeters [mm.] -Unless Noted

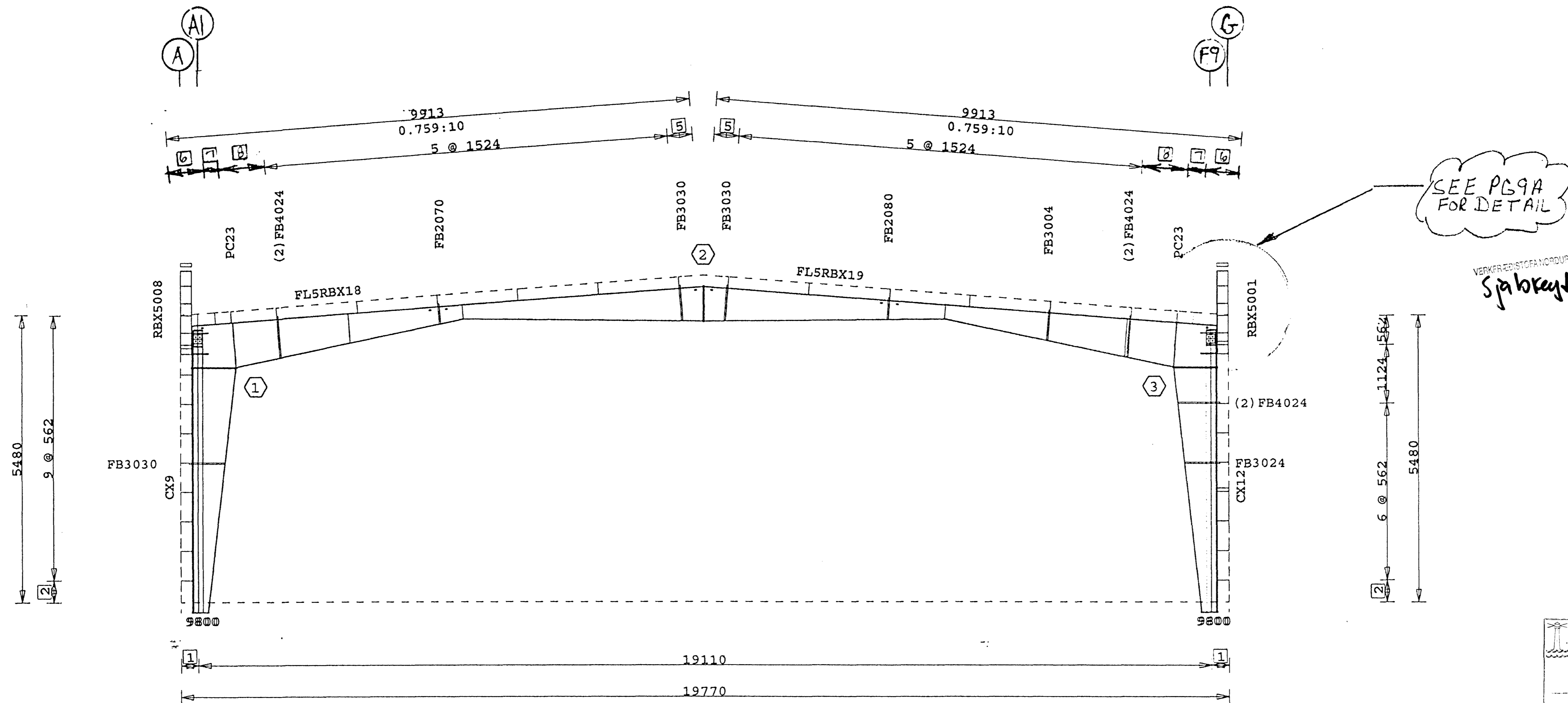
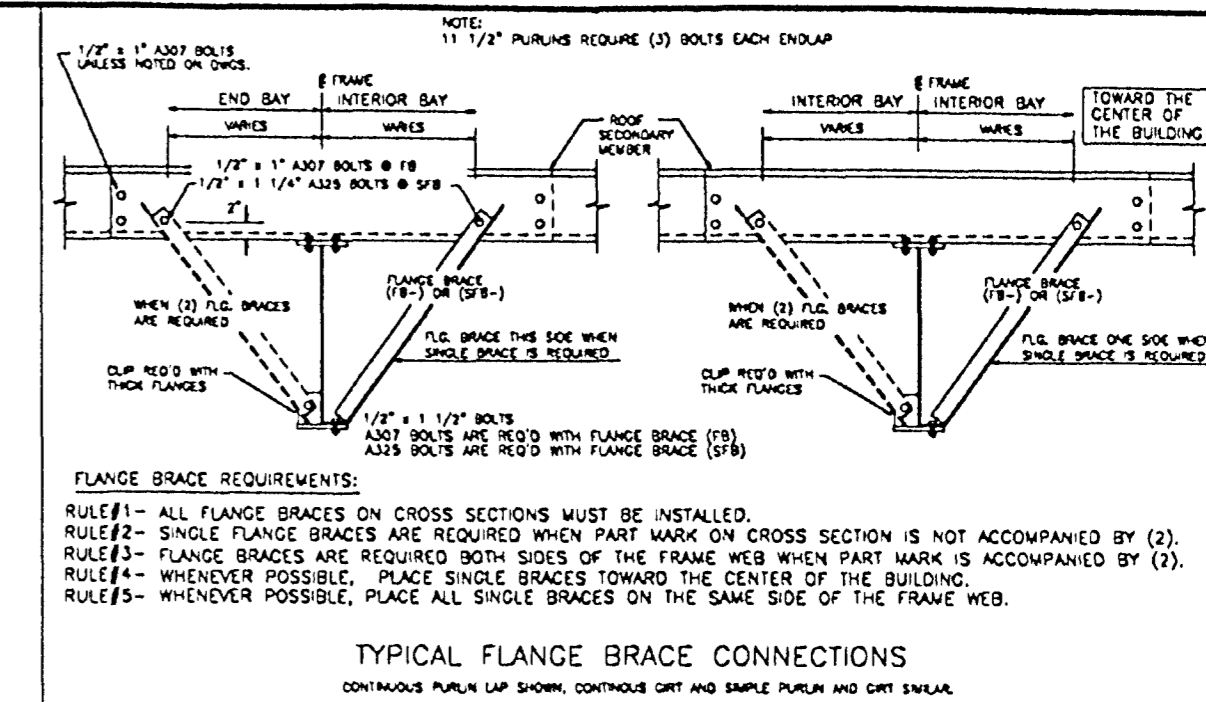

- 867
- 303
- 650
- 474
- 86
- 414
- 330

SEE A325 BOLT CONNECTION CHART

Elevation at Frame Line 5

On: filesrv Projky: 38890 Bldg: 2 Plane: 12

This Drawing is Sealed only as to the Components furnished by VP Buildings

- A325 HIGH STRENGTH BOLTS SHALL BE TIGHTENED IN ACCORDANCE WITH THE NOVEMBER 13, 1985, ALLOWABLE STRESS DESIGN "SPECIFICATION FOR STRUCTURAL JOINTS USING ASTM A325 OR A490 BOLTS" SECTION 8. (d) (1) "TURN-OF-NUT TIGHTENING".
- USE 1/2" DIA. A307 BOLTS FOR PURLIN TO FRAME, GIRT TO FRAME, AND GIRT TO CLIP CONNECTIONS UNLESS NOTED OTHERWISE. SEE JOB DETAILS FOR BOLT LENGTHS.
- INSTALLATION OF ADEQUATE TEMPORARY BRACING FOR USE UNTIL CONSTRUCTION IS COMPLETE, IS THE RESPONSIBILITY OF THE ERECTOR.

Building Code:	86MBMA	This Drawing, including the information hereon, remains the property of VP Buildings. It is provided for Erecting the Building described in the applicable Purchase Order and shall not be modified, reproduced or used for any other purpose without prior Written Approval of VP Buildings. The General Contractor and/or Erector is solely responsible for accurate, good quality workmanship in erecting this Building in conformance with this Drawing. Details referenced in this Drawing, all applicable VP Buildings Erection Details and all industry standards pertaining to proper erection, including the correct use of temporary bracing.
Live Ld (W/Trib Red)	102.5 kgsm	
Coll. Ld (gravity):	24.4 kgsm	
Coll. Ld (uplift):	0.0 kgsm	
Wind Speed:	170.6 kmph	
Wind Exp. Cat.:	C	
Ground Snow:	146.5 kgsm	
Roof Snow:	102.5 kgsm	
Snow Exp. Cat.:	3	
Seismic Zone:	3	
Building Use Cat.:	1	
Auxiliary Loads	NONE	

REV	DATE	BY	DESC.	BUILDER
				Varco-Pruden Exports
				CUSTOMER: Sindri
				LOCATION: Iceland,
				PROJECT: Sindri Workshop
				BUILDING: workshop 2

SCALE: NTS

QUOTE # ME99012531-001

VP BUILDINGS
VARCO-PRUDEN

DATE: 07/26/99
 TIME: 08:36
 DRAW/CHECK: DHG
 PAGE: 7

Bygginguáritun Hálfarfarbar
 Afgreitt þann
 20 MARS 2000
 Sigurbjartur Halldórsson

Verkfræðistofa Norðurlands ehf.
 Hofsbót 4 600 Akureyri, kt. 560175-0869
 Eiríkur Jónsson byggingaverkfr.
 kt. 051045-4679