

Sarþykkt á fundi bygginga-  
nefndar þ. 8.8.90  
BYGGINGAFULLTRÚINN  
HAFNARFIRÐI  
*Jos. Jónsson*

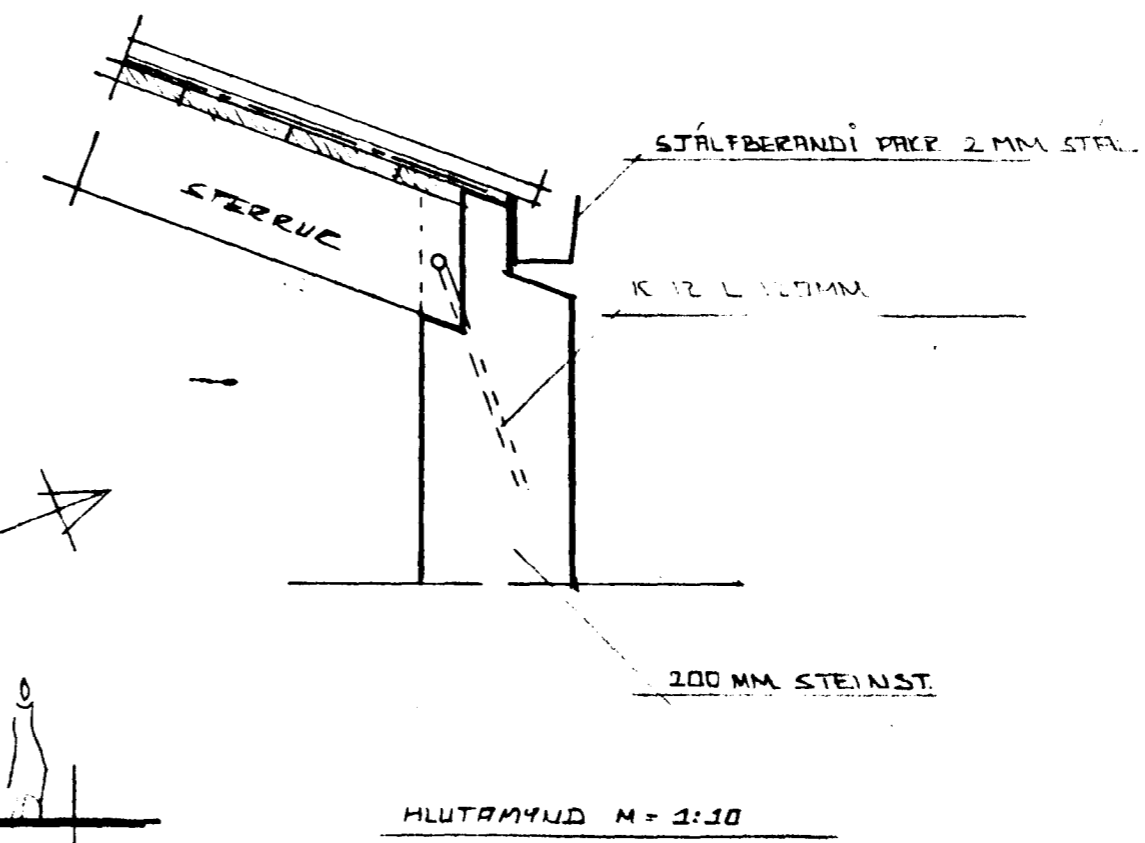

tifftopdf - www.rubisoftware.com - Demo Version

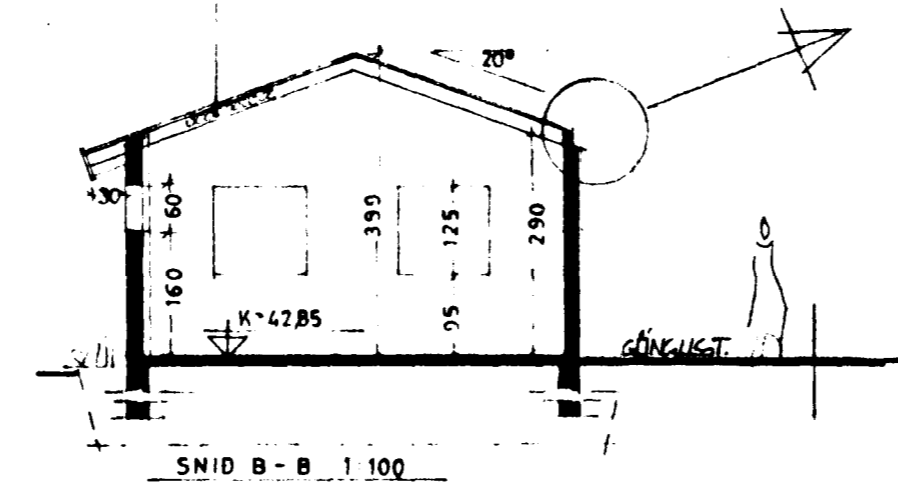
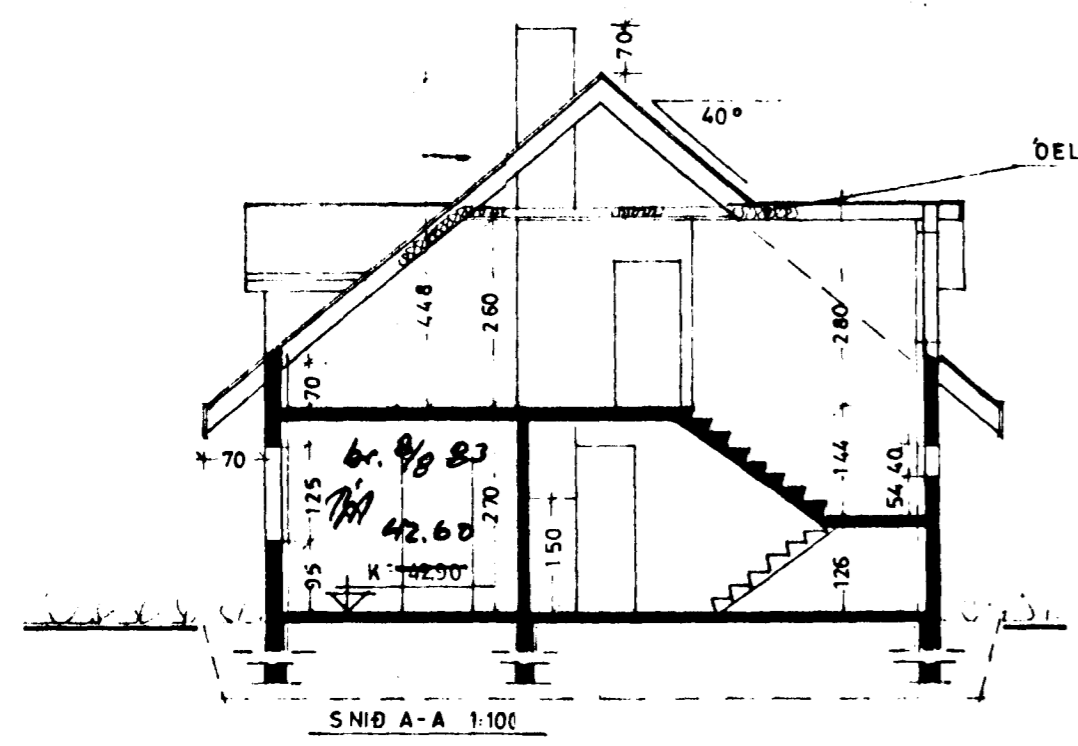
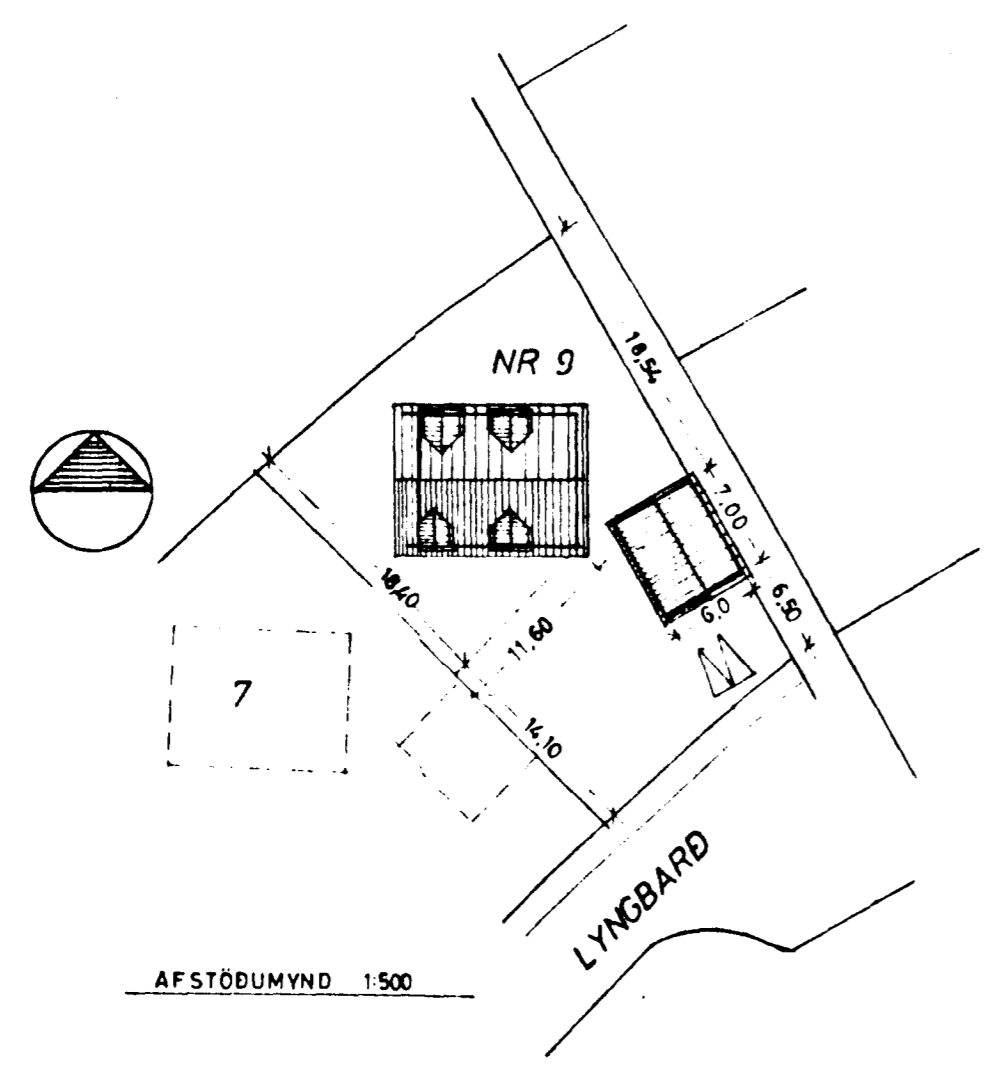

**SKYRINGAR**

GRUNNFLOTUR HUSS BRUTTO	98,25 m <sup>2</sup>
IBUÐ HÆÐ NETTO	76,67 -
IBUÐ RISI NETTO	63,56 -
IBUÐ SAMTALS NETTO	140,23 -
BÍFR GEYMSLA BRUTTO	42,00 -
- - NETTO	34,56 -
RUMMÁL HUSS	544,11 m <sup>3</sup>
RUMMÁL BÍFR. GEYMSLU	144,70 -
RUMMÁL SAMTALS	688,81 m <sup>3</sup>
KÖLNUNARTÖLUR:	
VEGGIR MEDALTAL K-GILDI	1,00
GOLF	0,40
PAK	0,30
EINGRUN	
UTVEGGIR	3' PLAST
GOLF	2' - 25-30 KG
PAK	5' GLERULL
UNDIRSTÖÐUR 50cm NIÐUR MED 2 PLASTI	
HUSIÐ ER STEINSTEYPT MED HRAUNAFERÐ AÐ UTAN OG	
MÁLMLÆÐNING Á ÞAKI	

5670-0090-01

22. 20. 07. 90  
 22. JULI 1990 ERL. MÁTRUM A.T.T. 24

**KVARDI** Teiknistofa Bolholti 6, 3.h. Reykjavík Sími (91) 82414

VERKEFNI	LYNGBARD 9, HAFNARFIRÐI	KVARDI 1:100 1:500	VERK NR. 8235
		DAGS. FEB 83	TÝPA NR. R-14
HEITI	AFSTÖÐUMYND SNID SKYRINGAR	HÖNNUN RI GG	TEIKN NR.
		TEIKN. RI	REIKN. RI

A-3

*Jos. Gunnarsson*

